

OFFICIAL RECORD
Requested By:
MARQUIS TITLE & ESCROW INC

Douglas County - NV
Werner Christen - Recorder
Page: 1 Of 3 Fee: 16.00
BK-0905 PG-00208 RPTT: # 3



Assessor's Parcel No.: 1420-34-810-034

RPTT: \$ _____ or Exempt # 3

Recording Requested by:

Marquis Title & Escrow, Inc.
1520 U.S. Highway 395 North
Gardnerville, NV 89410

Escrow Number: 250399SL

TITLE OF DOCUMENT: Deed

This document is being re-recorded to correct vesting

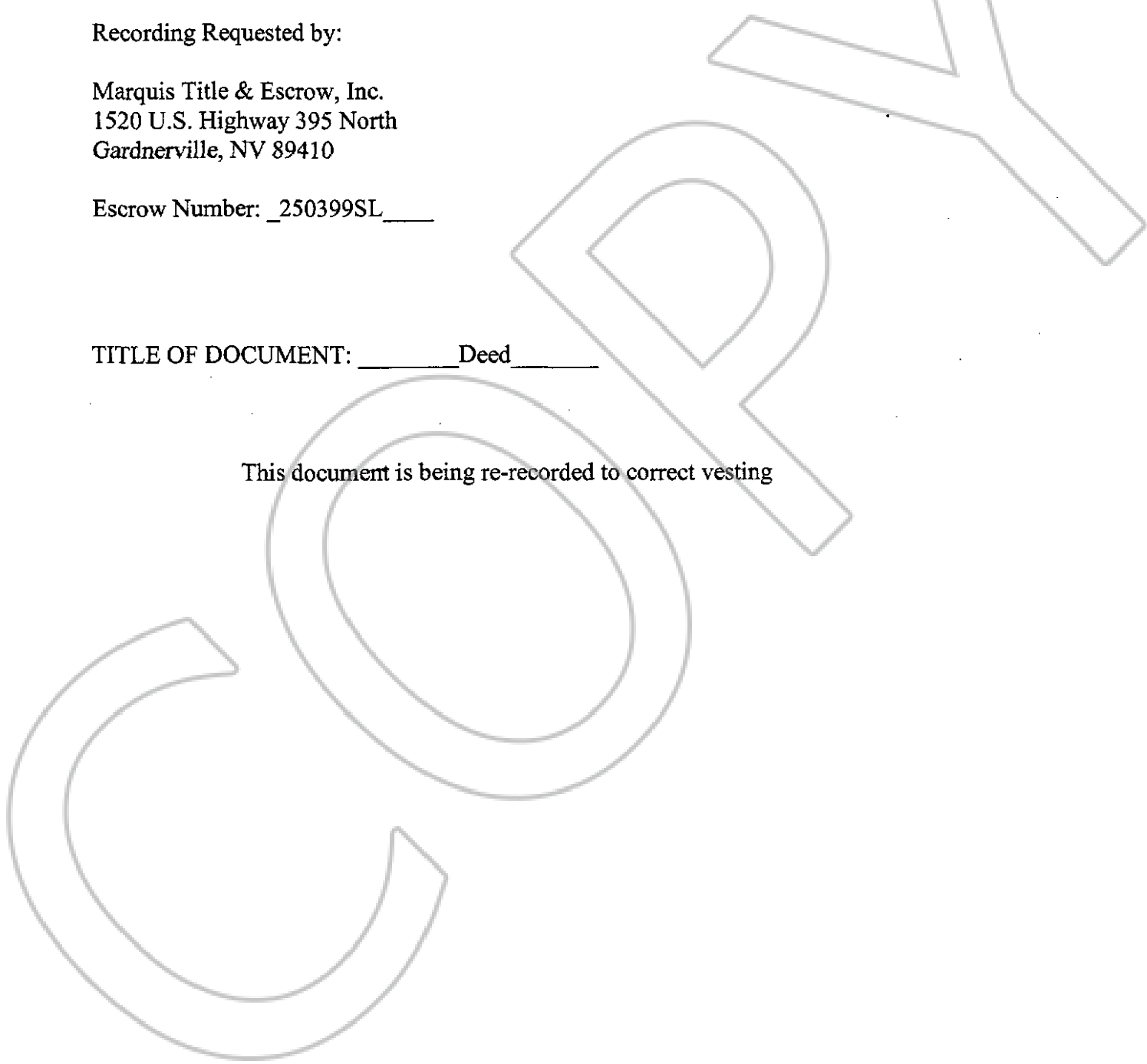

OFFICIAL RECORD

Requested By:
MARQUIS TITLE & ESCROW INC

Recording Requested By
MARQUIS TITLE & ESCROW, INC.
A.P. NO. 1420-34-810-034
Escrow No. 250399SL
R.P.T.T. \$.00

Douglas County - NV
Werner Christen - Recorder
Page: 1 Of 2 Fee: 15.00
BK-0805 PG- 8083 RPTT: # 5



WHEN RECORDED MAIL TO and
MAIL TAX STATEMENT TO:
JEFFREY DANIEL ADAMS
2636 Squires Street
Minden, NV 89423

GRANT, BARGAIN and SALE DEED

FOR A VALUABLE CONSIDERATION, receipt of which is hereby acknowledged,

LYNETTE ADAMS and JEFFREY DANIEL ADAMS, wife and husband as joint tenants

do(es) hereby GRANT, BARGAIN and SELL to

JEFFREY DANIEL ADAMS and LYNN ADAMS, ^{husband and wife as joint tenants}
~~wife and husband as joint tenants~~

the real property situate in the County of Washoe, State of Nevada, described as follows:

SEE EXHIBIT "A" ATTACHED HERETO AND MADE A PART HEREOF

TOGETHER with all tenements, hereditaments and appurtenances, including easements and water rights, if any, thereto belonging or appertaining, and any reversions, remainders, rents, issues or profits thereof.

Dated: 8/12/05

Lynette Adams
By: LYNETTE ADAMS

Jeffrey Daniel Adams
By: JEFFREY DANIEL ADAMS

STATE OF NEVADA
COUNTY OF DOUGLAS

This instrument was acknowledged before me on 8-12-05 by
Lynette Adams and Jeffrey Daniel Adams

L. Currer
Notary Public

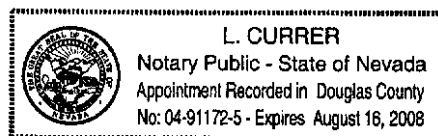
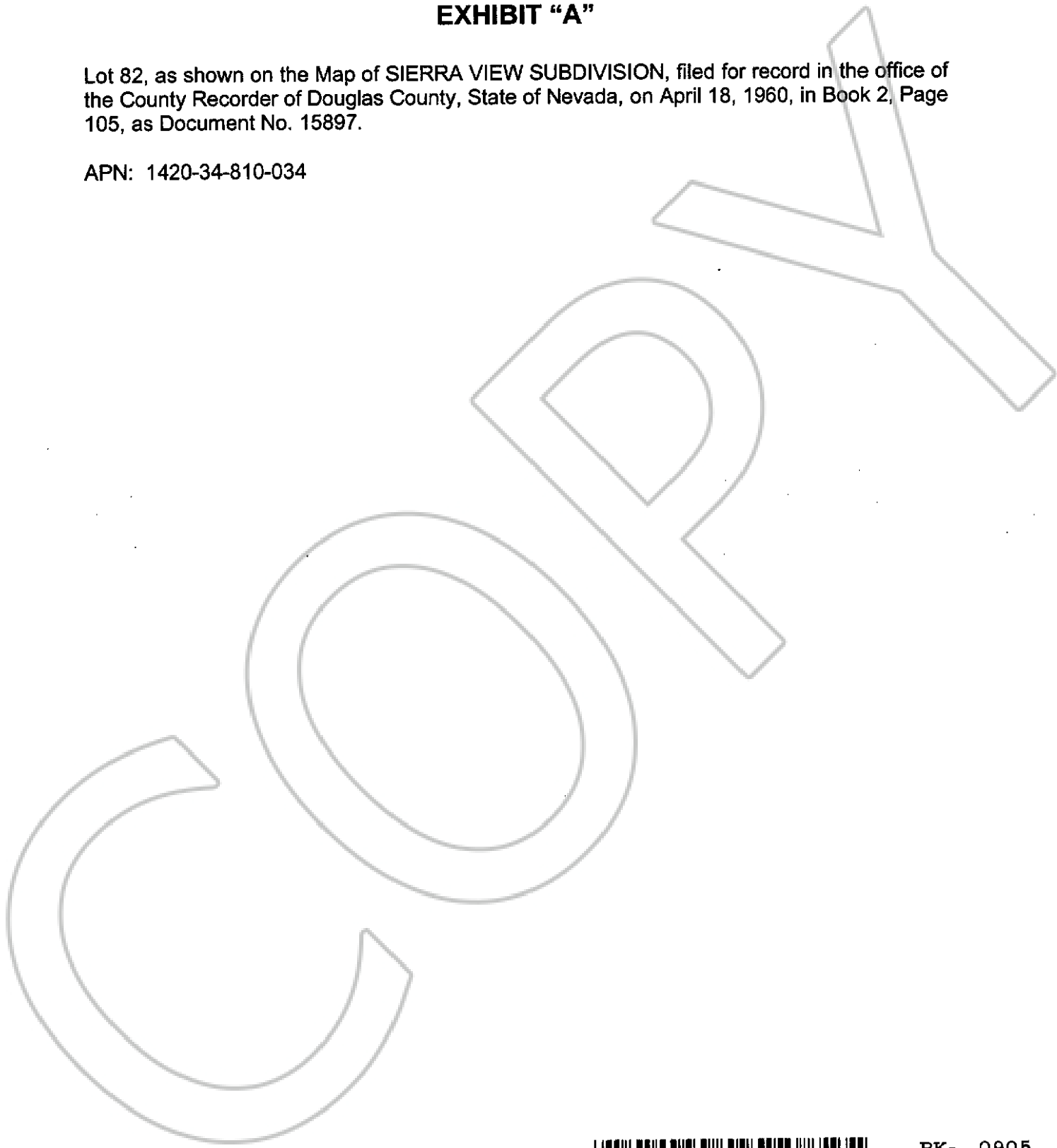

EXHIBIT "A"

Lot 82, as shown on the Map of SIERRA VIEW SUBDIVISION, filed for record in the office of the County Recorder of Douglas County, State of Nevada, on April 18, 1960, in Book 2, Page 105, as Document No. 15897.

APN: 1420-34-810-034



0654037 Page: 3 Of 3

BK- 0905
PG- 210
09/01/2005



0652519 Page: 2 Of 2

BK- 0805
PG- 8084
08/17/2005