

LINE DATA TABLE

LINE	BEARING	DISTANCE	NOTE
L1	N 42°31'00" W	178.75'	(R1)
	N 42°37'52" W	178.81'	(M)
L2	N 27°26'00" W	251.48'	(R1)
L3	N 28°02'20" E	236.69'	(R1)
L4	N 11°30'00" W	113.65'	(R1)
L5	N 09°55'55" W	90.03'	(R1)

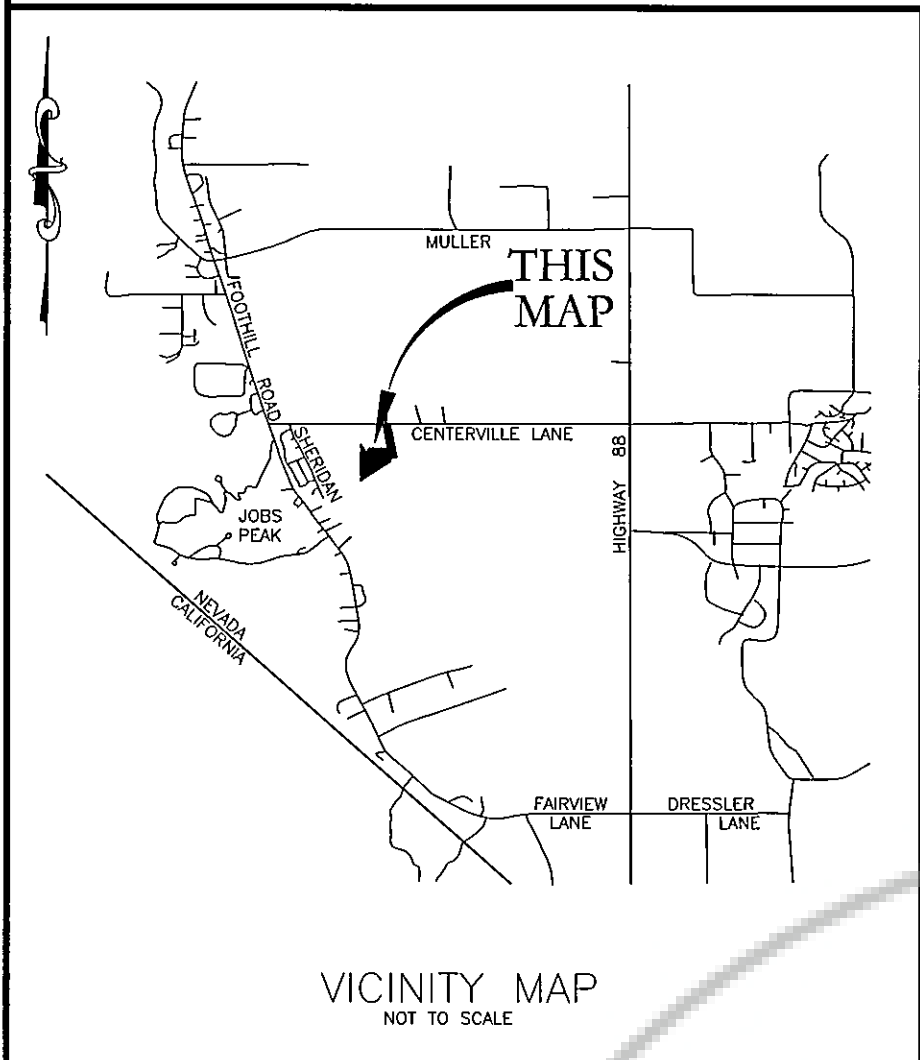

LEGEND

- SET 5/8" REBAR AND CAP, PLS 3209
- ▲ FOUND 3/4" IRON PIPE WITH WOOD PLUG AND TACK, NO TAG
- FOUND 1/2" IRON PIPE, RE 446
- FOUND 1 1/2" IRON PIPE WITH WOOD PLUG AND TACK, NO TAG
- FOUND 6" IRON PIPE FENCE POST, NO TAG
- △ CALCULATED POINT NOTHING SET OR FOUND
- X X X FOUND MONUMENT AS NOTED.
- (R1) INDICATES RECORD INFORMATION PER DOCUMENT No. 64581
- (R2) INDICATES RECORD INFORMATION PER DOCUMENT No. 193174
- (M) INDICATES MEASURED INFORMATION

NOTE

THIS MAP IS NOT IN CONFLICT WITH THE PROVISIONS OF NRS CHAPTER 278. IT IS A SURVEY TO SET CORNERS OF AN EXISTING PARCEL.

BASIS OF BEARINGS

THE BEARING N 89°52'00" W FOR THE NORTH LINE OF SECTION 14, TOWNSHIP 12 NORTH, RANGE 19 EAST, M.D.B. & M. AS SHOWN ON (R1) WAS USED AS THE BASIS OF BEARINGS FOR THIS MAP.

SURVEYOR'S CERTIFICATE

I, DAVID D. WINCHELL, A PROFESSIONAL LAND SURVEYOR LICENSED IN THE STATE OF NEVADA, CERTIFY THAT:

1. THIS IS A TRUE AND ACCURATE REPRESENTATION OF THE LANDS SURVEYED UNDER MY SUPERVISION AT THE INSTANCE OF DONALD S. AND KRISTINA FORRESTER.
2. ALSO A PORTION OF NORTHWEST 1/4 OF SECTION 14, TOWNSHIP 12 NORTH, RANGE 19 EAST M.D.B. & M. AND THE SURVEY WAS COMPLETED ON OCTOBER 7th, 2005.
3. THIS PLAT COMPLIES WITH THE APPLICABLE STATE STATUES AND ANY LOCAL ORDINANCES.
4. THE MONUMENTS DEPICTED ON THIS PLAT ARE OF THE CHARACTER SHOWN AND OCCUPY THE POSITIONS INDICATED.

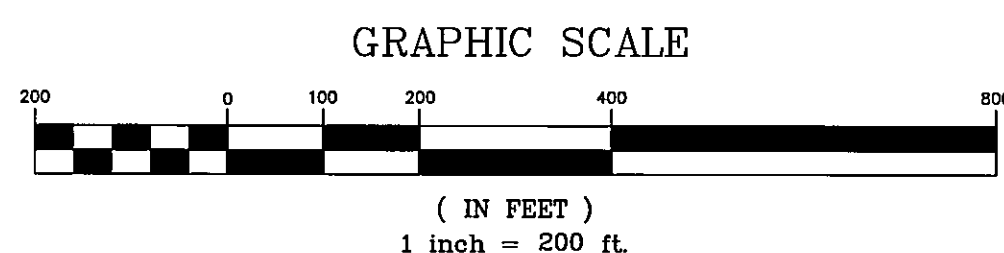

WESTERN
ENGINEERING & SURVEYING SERVICES
3032 SILVER SAGE DRIVE
CARSON CITY, NEVADA 89701
(775) 884-3200 FAX (775) 884-3211

DAVID D. WINCHELL
P.L.S. 3209
10/14/05
DATE

COUNTY RECORDER'S CERTIFICATE:
FILED THIS 14th DAY OF October, 2005, AT 59 MINUTES PAST 10 O'CLOCK A.M. IN BOOK 1005, AT PAGE 6506, DOCUMENT NUMBER 457826

RECORDED AT THE REQUEST OF DONALD S. AND KRISTINA FORRESTER.
Barbara Clark, Deputy
DOUGLAS COUNTY RECORDER

AMENDED RECORD OF SURVEY FOR DONALD S. AND KRISTINA FORRESTER

BEING ADJUSTED PARCEL H OF THE RECORD OF SURVEY SUPPORTING A BOUNDARY LINE ADJUSTMENT FOR GERALD F. WHITMIRE, PER DOCUMENT NUMBER 193174, OFFICIAL RECORDS OF DOUGLAS COUNTY.

ALSO BEING A PORTION OF NORTHWEST 1/4 OF SECTION 14, TOWNSHIP 12 NORTH, RANGE 19 EAST, M.D.B. & M.

DOUGLAS COUNTY NEVADA
SHEET 1 OF 1 SHEETS