

OFFICIAL RECORD

Requested By:

ALEXANDER SMITH

Douglas County - NV  
Werner Christen - Recorder

Page: 1 of 2 Fee: 15.00  
BK-0306 PG-5817 RPTT: 0.00



APN: 1420-07-211-007

Recording requested by and mail documents and tax statements to:

Your Name Alexander R. Smith

Your Address 3521 shawnee dr

City/State/Zip CANSON CITY, NV. 89705

# DECLARATION OF HOMESTEAD

CHECK ONE  Head of Family  Single, Married or Widowed  Multiple single persons  
 Married (filing joint declaration)  By Husband (filing for benefit of both)  By Wife (filing for benefit of both)

CHECK ONE  House  Mobile Home  Condominium Unit  Other

Name on title of property: ALBERT ANDERSON R. SMITH

do individually and severally certify and declare that the following named person(s) is/are residing on the land premises (or mobile home, condominium unit, townhouse):

located at (street address) 3521 SHAWNEE DR City of \_\_\_\_\_

County of DOUGLAS State of Nevada, and more particularly described as follows:

**(PLEASE SEE ATTACHED LEGAL DESCRIPTION)**

I/We claim the land and premises herein above described, together with the dwelling house thereon, and its appurtenances, or the described mobile home as a Homestead. [check one]

No current Declaration of Homestead is on file.

This Declaration of Homestead constitutes an abandonment of the former Declaration recorded on 1/1.

In Witness Whereof, I/We have hereunto set my hand/our hands on 03/16/06

Alexander R. Smith  
Signature of Declarant

\_\_\_\_\_  
Signature of Declarant

Alexander R. Smith  
Print or type name here

\_\_\_\_\_  
Print or type name here

STATE OF NEVADA  
COUNTY OF Douglas

On this 16th day of March, 20 06, personally appeared before me, a Notary Public Alexander R. Smith personally known to me to be the person(s) whose name(s) is subscribed to the above instrument who acknowledged that he executed this instrument. Witness my hand and official seal.

Lorraine Diederichsen  
Notary Public

My commission expires: April 15, 2007

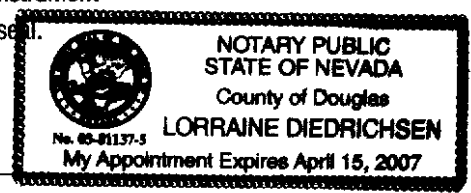

**EXHIBIT "A"  
LEGAL DESCRIPTION**

Order No.: 050500444

The land referred to herein is situated in the State of Nevada,  
County of DOUGLAS, described as follows:

Lot 16, as shown on the map of VALLEY VIEW SUBDIVISION,  
filed in the Office of the County Recorder of Douglas  
County, Nevada, on November 12, 1958, as Document No. 13793.

Assessors Parcel No. 1420-07-211-007

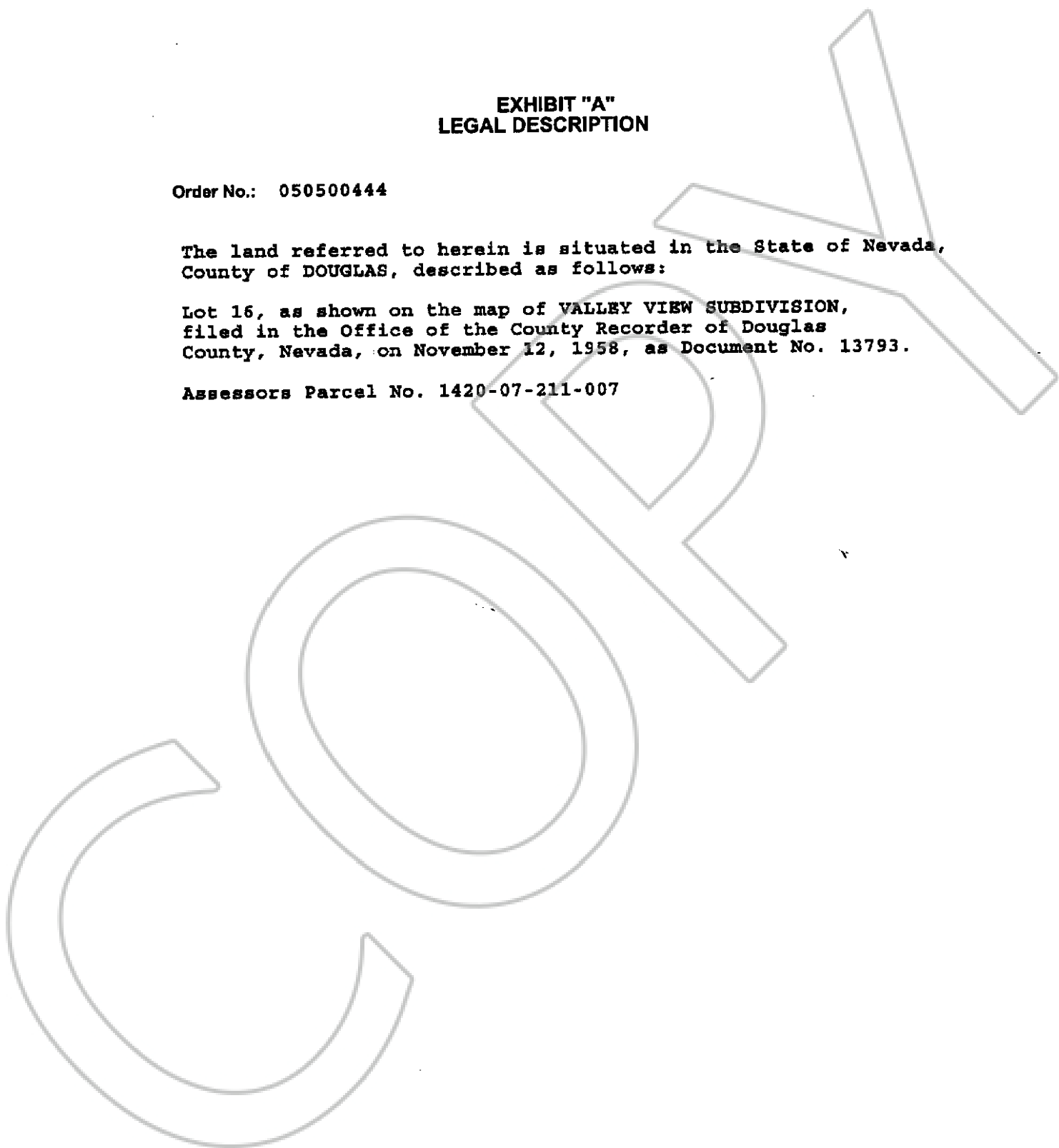

0643253 Page: 2 Of 2

BK- 0505  
PG- 147  
05/02/2005



0670014 Page: 2 Of 2

BK- 0306  
PG- 5818  
03/16/2006