

Assessor's Parcel Number: 1318-23-602-012

Recording Requested By:

Name: Vasu R. Devan

Address: 4 Crow Canyon Ct.

City/State/Zip San Ramon, CA 94583

R.P.T.T.: \$0,, (#3)

Douglas County - NV  
Werner Christen - Recorder  
Page: 1 Of 3 Fee: 16.00  
BK-0306 PG-13257 RPTT: # 3



Grant Deed  
(Title of Document)

*Deed being rerecorded to show the correct RPTT amount.*

This page added to provide additional information required by NRS 111.312 Sections 1-2. (Additional recording fee applies)

*This cover page must be typed or legibly hand printed.*

OFFICIAL RECORD  
Requested By:  
FIRST AMERICAN TITLE COMPANY

RECORDING REQUESTED BY:

Chicago Title Company  
Escrow No.: 06-59801048-JY  
Locate No.: CAIND0000-7701-5598-  
Title No.:

When Recorded Mail Document  
and Tax Statement To:

Vasu R. Devan  
4 Crow Canyon Court  
San Ramon, CA 94583

Douglas County - NV  
Werner Christen - Recorder  
Page: 1 Of 2 Fee: 16.00  
BK-0306 PG-4935 RPTT: 3705.00



#2262488-WS

APN: 1318-23-602-012

GRANT DEED

The undersigned grantor(s) declare(s) ~~\$3798.00~~ <sup>\$2,710.00</sup>  
Documentary transfer tax is \$ ~~3798.00~~ City Transfer Tax is \$

- computed on full value of property conveyed, or
- computed on full value less value of liens or encumbrances remaining at time of sale,
- Unincorporated Area City of **Stateline**,

FOR A VALUABLE CONSIDERATION, receipt of which is hereby acknowledged, SHANBAGAM PROPERTIES, L.P., a California Corporation

hereby GRANT(S) to VASU DEVAN, a married man, as his sole and seperate property  
the following described real property in the City of **Stateline**, County of **Douglas**, State of **Nevada**:

DATED: March 3, 2006

STATE OF CALIFORNIA )  
COUNTY OF Contra Costa )  
ON 3 March 2006 before me,  
E. Wright, Notary Public  
(here insert name and title of the officer), personally  
appeared M.R. Raghavan

\_\_\_\_\_  
~~VASU DEVAN~~ M. R. RAGHAVAN  
\_\_\_\_\_  
\_\_\_\_\_  
\_\_\_\_\_

personally known to me (or proved to me on the basis of satisfactory evidence) to be the person(s) whose name(s) is/are subscribed to the within instrument and acknowledged to me that he/she/they executed the same in his/her/their authorized capacity(ies), and that by his/her/their signature(s) on the instrument the person(s), or the entity upon behalf of which the person(s) acted, executed the instrument.

Witness my hand and official seal.

Signature

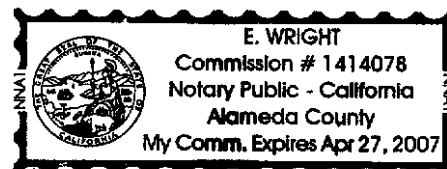



MAIL TAX STATEMENTS AS DIRECTED ABOVE

**EXHIBIT 'A'**

File No.: **801-2262488 (WS)**  
Property: **378 Summit Drive, Stateline, NV 89449**

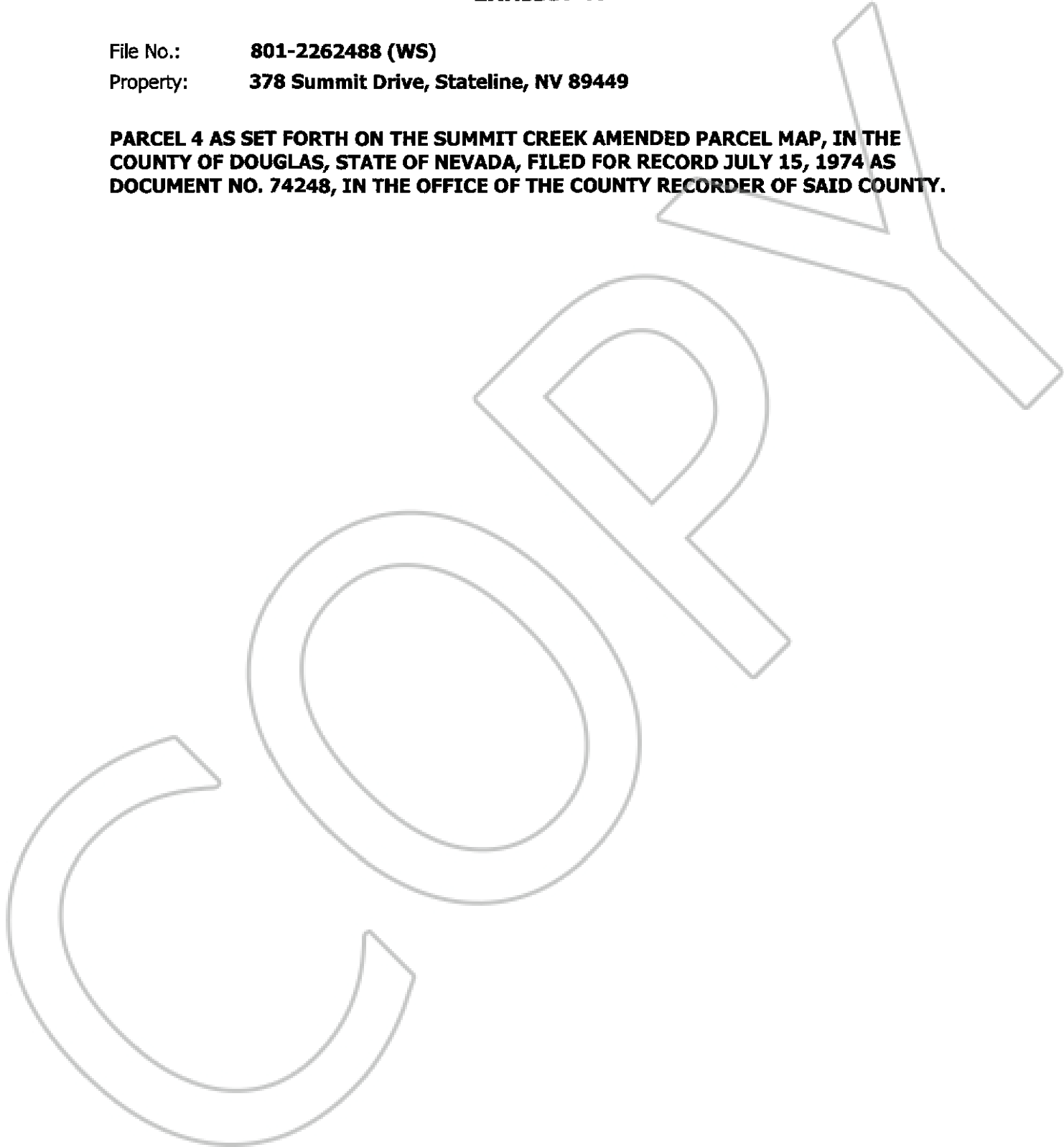
**PARCEL 4 AS SET FORTH ON THE SUMMIT CREEK AMENDED PARCEL MAP, IN THE COUNTY OF DOUGLAS, STATE OF NEVADA, FILED FOR RECORD JULY 15, 1974 AS DOCUMENT NO. 74248, IN THE OFFICE OF THE COUNTY RECORDER OF SAID COUNTY.**



  
0671652 Page: 3 Of 3 BK- 0306  
PG- 13259  
03/31/2006

  
0669868 Page: 2 Of 2 BK- 0306  
PG- 4936  
03/14/2006