

-18

DOC # 0674495  
05/09/2006 03:00 PM Deputy: KLJ  
OFFICIAL RECORD  
Requested By:  
GRUBB & ELLIS

APN: 1320-07-002-016

**WHEN RECORDED, MAIL TO:**

John Pinjuv  
Grubb & Ellis  
5555 Kietzke Lane, Suite 200  
Reno, NV 89511

Douglas County - NV  
Werner Christen - Recorder  
Page: 1 of 5 Fee: 18.00  
BK-0506 PG-3827 RPTT: 0.00



**Deed Restriction**

This Deed Restriction is made as of the \_\_\_ day of May, 2006, by and between Ray-Matt, LLC, a Nevada Limited Liability Company ("Ray-Matt"); and Douglas County, a political subdivision of the State of Nevada (the "County"), with reference to the following facts and is as follows:

A. Ray-Matt is the owner of that certain real property situate in Douglas County, Nevada, more particularly described in **Exhibit "A"** hereto (the "Property").

B. In connection with the development of the Property, the County has requested that Ray-Matt place a deed restriction on the Property for the benefit of the residents of the County.

NOW, THEREFORE, for valuable consideration, Ray-Matt hereby covenants and agrees with the County, for the benefit of the residents of the County, that the use of individual sewage disposal systems on the Property shall be limited to alternative treatment systems and installation of such alternative treatment systems must be approved and permitted by the Nevada Bureau of Health Protection Services before a building permit may be obtained. The provisions of this document shall be binding upon the successors and assigns of Ray-Matt and shall be deemed to run with the Property as covenants running with the land or as equitable servitudes, as the case may be, and shall constitute a burden on the Property for the benefit of the residents of the County.

[Signature Page Follows.]

IN WITNESS WHEREOF this Deed Restriction is executed as of the date first written above.

**RAY-MATT, LLC,  
A Nevada Limited Liability Company**

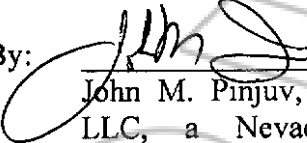
By:   
John M. Pinjuv, Member of Ray-Matt, LLC, a Nevada Limited Liability Company

By:   
Deborah L. Pinjuv, Member of Ray-Matt, LLC, a Nevada Limited Liability Company

By: J & D PINJUV REVOCABLE LIVING TRUST, Member of Ray-Matt, LLC, a Nevada Limited Liability Company

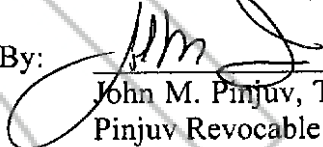
By:   
John M. Pinjuv, Trustee of J & D Pinjuv Revocable Living Trust

By:   
Deborah L. Pinjuv, Trustee of J & D Pinjuv Revocable Living Trust



STATE OF NEVADA )  
 ) ss.  
County of WASHOE )

This instrument was acknowledged before me on May 8, 2006, by John M. Pinjuv, as a Member of Ray-Matt, LLC, a Nevada Limited Liability Company.



*Esther M. Hopkins*  
Notary Public  
My Commission Expires: 1-10-10

STATE OF NEVADA )  
 ) ss.  
County of WASHOE )

This instrument was acknowledged before me on May 8, 2006, by Deborah L. Pinjuv, as a Member of Ray-Matt, LLC, a Nevada Limited Liability Company.

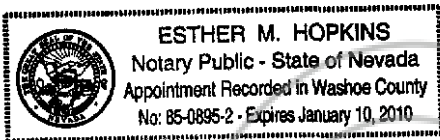

*Esther M. Hopkins*  
Notary Public  
My Commission Expires: 1-10-10

STATE OF NEVADA )  
 ) ss.  
County of WASHOE )

This instrument was acknowledged before me on May 8, 2006, by John M. Pinjuv, as Trustee of J & D Pinjuv Revocable Living Trust.

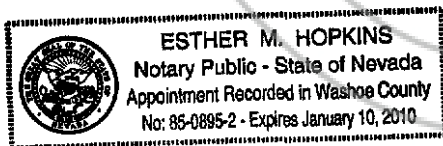

*Esther M. Hopkins*  
Notary Public  
My Commission Expires: 1-10-10



STATE OF NEVADA        )  
                                  ) ss.  
County of WASHOE     )

This instrument was acknowledged before me on May 8, 2006, by Deborah L. Pinjuv, as Trustee of J & D Pinjuv Revocable Living Trust.

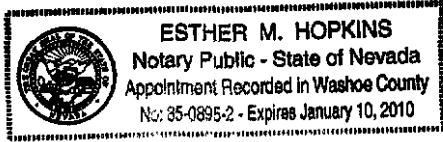

*Esther M. Hopkins*  
Notary Public  
My Commission Expires: 1-10-10



Exhibit "A"

Legal Description of the Property

The land referred to herein is situated in the State of Nevada,  
County of DOUGLAS, described as follows:

Parcel 4-A-1, as set forth on that certain Parcel Map LDA  
#04-060 for Duncan M. and Mary S. Getty, recorded April 1,  
2005, in Book 0405, Page 438, as Instrument No. 640704,  
Official Records of Douglas County, Nevada.

NEW APN 1320-07-002-016

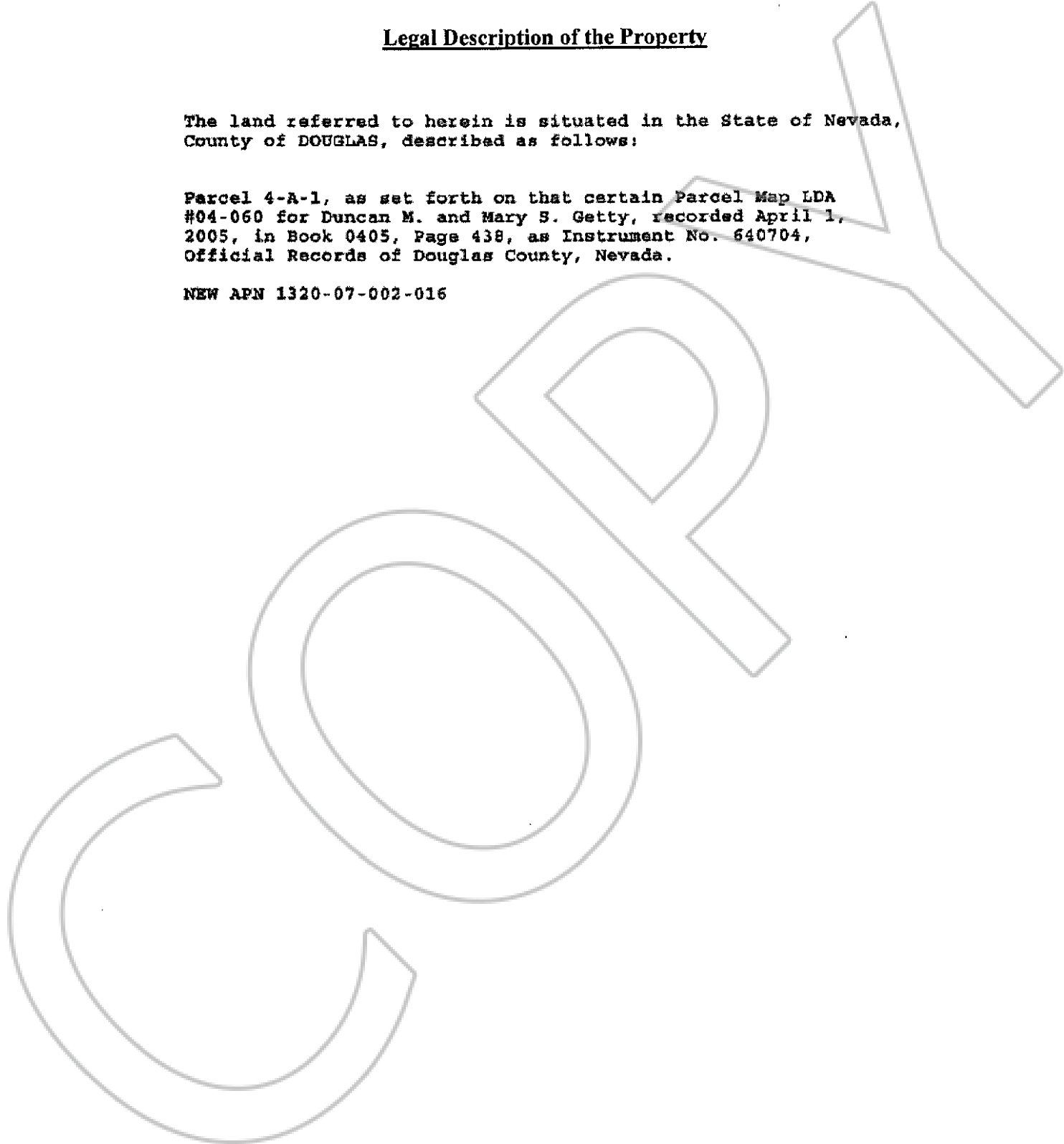

::ODMA\PCDOCS\HLR\NODOCS\536534\1

