

OFFICIAL RECORD

Requested By:

STEWART TITLE OF DOUGLAS

COUNTY

Douglas County - NV

Werner Christen - Recorder

Page: 1 Of 5 Fee: 18.00

BK-0506 PG-12398 RPTT: # 3



APN: 1220-06-002-009 & 010
R.P.T.T. #3
ORDER NO. 060500768
Mail tax statements same as below

WHEN RECORDED MAIL TO:
Mr. & Mrs. Todd Gansberg
1037 Waterloo Lane
Gardnerville, NV 89460

**BOUNDARY LINE ADJUSTMENT
GRANT, BARGAIN, SALE DEED**

THIS INDENTURE WITNESSETH: TODD GANSBERG AND JULIE GANSBERG, husband and wife, in consideration of \$10.00, the receipt of which is hereby acknowledged, does hereby Grant, Bargain Sell and Convey to TODD GANSBERG AND JULIE GANSBERG, husband and wife as joint tenants, AND TO THE HEIRS AND ASSIGNS OF SUCH Grantee forever, all that real property situated in the County of Douglas, State of Nevada, bounded and described as follows:

SEE EXHIBIT "A" ATTACHED HERETO AND MADE A PART HEREOF

THIS DEED IS PLACED OF RECORD FOR THE PURPOSE OF FACILITATING A BOUNDARY LINE ADJUSTMENT BETWEEN EXISTING PARCELS OF LAND, AS FURTHER DEPICTED AND SET FORTH ON THAT CERTAIN RECORD OF SURVEY IN SUPPORT OF BOUNDARY LINE ADJUSTMENT, RECORDED CONCURRENTLY HEREWITH.

TODD GANSBERG

JULIE GANSBERG

STATE OF NEVADA } ss.
COUNTY OF DOUGLAS }

This instrument was acknowledged before me on May 18, 2006
By, Todd and Julie Gansberg

Signature Linda M. Biaggi
Notary Public

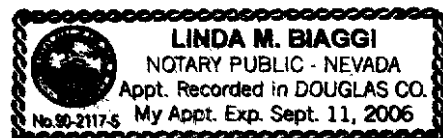

**DESCRIPTION
ADJUSTED PARCEL 1A
(A.P.N. 1220-06-002-009)**

All that real property situate in the County of Douglas, State of Nevada, described as follows:

A parcel of land located within a portion of the Southeast one-quarter (SE $\frac{1}{4}$) of Section 6, Township 12 North, Range 20 East, Mount Diablo Meridian, more particularly described as follows:

Commencing at the east one-quarter (E $\frac{1}{4}$) corner of Section 6, T.12N., R.20E., M.D.M. as shown on the Map of Division into Large Parcels for Todd and Julie Gansberg recorded February 14, 2005 in the office of Recorder, Douglas County, Nevada as Document No. 636657, a found 1" spike in asphalt, said point also being the northeast corner of Parcel 1A as shown on said Map of Division into Large Parcels, the POINT OF BEGINNING;

thence along the east line of said Section 6, along the westerly right-of-way of Waterloo Lane, South 01°00'22" East, 2142.62 feet;

thence South 88°59'38" West, 1457.88 feet to a point on the westerly boundary of Parcel 1B as shown on said Map of Division into Large Parcels;

thence along said westerly boundary of Parcel 1B, North 00°31'06" West, 657.97 feet to the northwest corner of said Parcel 1B, said point also being the southwest corner of said Parcel 1A;

thence along the westerly boundary of said Parcel 1A, the following courses:

North 04°16'55" West, 550.32 feet;

North 47°57'54" West, 251.10 feet;

North 23°45'39" West, 70.94 feet;

North 12°55'49" West, 242.51 feet;

North 32°50'02" West, 177.10 feet;

North 00°42'21" West, 330.00 feet to the northwest corner of said Parcel

1A, said point falling on the southerly right-of-way of said Waterloo Lane;

thence along said southerly right-of-way of Waterloo Lane, along the northerly boundary of said Parcel 1A, North 89°35'44" East, 1836.55 feet to the POINT OF BEGINNING, containing 78.29 acres, more or less.

The Basis of Bearing of this description is North 01°00'22" West, the easterly line of the Southeast one-quarter of Section 6, T.12N., R.20E., M.D.M., also the westerly right-of-way of Waterloo Lane as shown on the Record of Survey to Support a Boundary Line



Adjustment for Chris H. and Ellen H. Gansberg, and Todd and Julie Gansberg recorded May 11, 1998 in the office of Recorder, Douglas County, Nevada in Book 598, at Page 1827, as Document No. 439309.

Note: Refer this description to your title company
Before incorporating into any legal document.

Prepared By: R.O. ANDERSON ENGINEERING, INC.
P.O. Box 2229
Minden, Nevada 89423

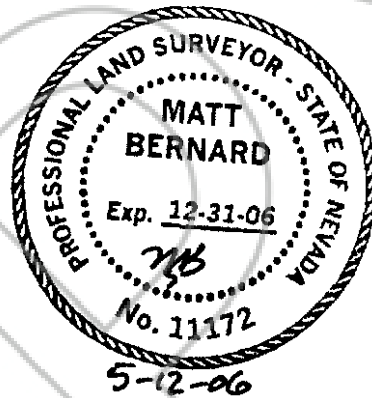

**DESCRIPTION
ADJUSTED PARCEL 1B
(A.P.N. 1220-06-002-010)**

All that real property situate in the County of Douglas, State of Nevada, described as follows:

A parcel of land located within a portion of the Southeast one-quarter (SE $\frac{1}{4}$) of Section 6 and the North one-half of the Northeast one-quarter (N $\frac{1}{2}$ NE $\frac{1}{4}$) of Section 7, Township 12 North, Range 20 East, Mount Diablo Meridian, more particularly described as follows:

Commencing at the east one-quarter (E $\frac{1}{4}$) corner of Section 6, T.12N., R.20E., M.D.M. as shown on the Map of Division into Large Parcels for Todd and Julie Gansberg recorded February 14, 2005 in the office of Recorder, Douglas County, Nevada as Document No. 636657, a found 1" spike in asphalt, said point also being the northeast corner of Parcel 1A as shown on said Map of Division into Large Parcels;

thence along the east line of said Section 6, along the westerly right-of-way of Waterloo Lane, South 01°00'22" East, 2142.62 feet to the POINT OF BEGINNING;
thence continuing along said east line of Section 6, along said westerly right-of-way of Waterloo Lane, South 01°00'22" East, 457.13 feet;
thence along the boundary of Parcel 1B as shown on said Map of Division into Large Parcels, the following courses:

South 88°59'38" West, 65.33 feet;
South 00°13'43" East, 210.72 feet;
South 89°46'17" West, 644.73 feet;
North 05°55'59" East, 160.72 feet;
South 89°37'13" West, 768.66 feet;
North 00°31'06" West, 491.17 feet;

thence leaving said boundary of Parcel 1B, North 88°59'38" East, 1457.88 feet to a point on said westerly right-of-way of Waterloo Lane, the POINT OF BEGINNING, containing 19.00 acres, more or less.

The Basis of Bearing of this description is North 01°00'22" West, the easterly line of the Southeast one-quarter of Section 6, T.12N., R.20E., M.D.M., also the westerly right-of-way of Waterloo Lane as shown on the Record of Survey to Support a Boundary Line Adjustment for Chris H. and Ellen H. Gansberg, and Todd and Julie Gansberg recorded May 11, 1998 in the office of Recorder, Douglas County, Nevada in Book 598, at Page 1827, as Document No. 439309.

Note: Refer this description to your title company
Before incorporating into any legal document.

Prepared By:

R.O. ANDERSON ENGINEERING, INC.
P.O. Box 2229
Minden, Nevada 89423

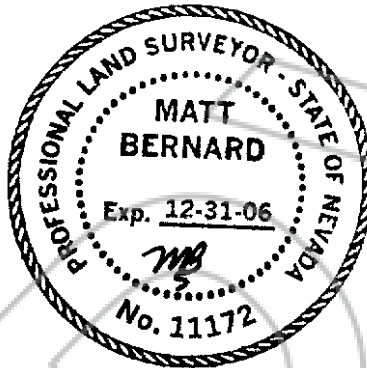

5-12-06

