

OFFICIAL RECORD

Requested By:

STEWART TITLE OF DOUGLAS

COUNTY

Douglas County - NV

Werner Christen - Recorder

Page: 1 Of 5 Fee: 18.00

BK-0506 PG-12404 RPTT: # 3



APN: 1319-22-000-009 & 1319-00-002-001

R.P.T.T. #3

ORDER NO. 030501426 & 030502917

Mail tax statements same as below

WHEN RECORDED MAIL TO:

Teig Family Investments, LLC, etc

1974 Foothill Rd.

Minden, NV 89423

**BOUNDARY LINE ADJUSTMENT
GRANT, BARGAIN, SALE DEED**

THIS INDENTURE WITNESSETH: TEIG FAMILY INVESTMENTS, LLC, a Nevada Limited Liability Company as to 77% interest and ROGER G. TEIG AND GAIL P. TEIG Trustees of the TEIG FAMILY 1995 TRUST, UNDER THE TRUST AGREEMENT DATED NOVEMBER 30, 1995 as to 23% interest, in consideration of \$10.00, the receipt of which is hereby acknowledged, does hereby Grant, Bargain Sell and Convey to TEIG FAMILY INVESTMENTS, LLC, a Nevada Limited Liability Company as to 77% interest and ROGER G. TEIG AND GAIL P. TEIG Trustees of the TEIG FAMILY 1995 TRUST, UNDER THE TRUST AGREEMENT DATED NOVEMBER 30, 1995 as to 23% interest, AND TO THE HEIRS AND ASSIGNS OF SUCH Grantee forever, all that real property situated in the County of Douglas, State of Nevada, bounded and described as follows:

SEE EXHIBIT "A" ATTACHED HERETO AND MADE A PART HEREOF

THIS DEED IS PLACED OF RECORD FOR THE PURPOSE OF FACILITATING A BOUNDARY LINE ADJUSTMENT BETWEEN EXISTING PARCELS OF LAND, AS FURTHER DEPICTED AND SET FORTH ON THAT CERTAIN RECORD OF SURVEY IN SUPPORT OF BOUNDARY LINE ADJUSTMENT, RECORDED CONCURRENTLY HERewith.

TEIG FAMILY INVESTMENTS, LLC

Roger G. Teig - Manager

by: ROGER G. TEIG, Manager

Gail P. Teig Manager

GAIL P. TEIG, Manager

Roger G. Teig - Trustee

ROGER G. TEIG, TRUSTEE

Gail P. Teig Trustee

GAIL P. TEIG, TRUSTEE

STATE OF NEVADA } ss.
COUNTY OF DOUGLAS }

This instrument was acknowledged before me on 5/18/06,
By, ROGER G. TEIB

GAIL P. TEIB

Signature Linda S. Hamilton
Notary Public

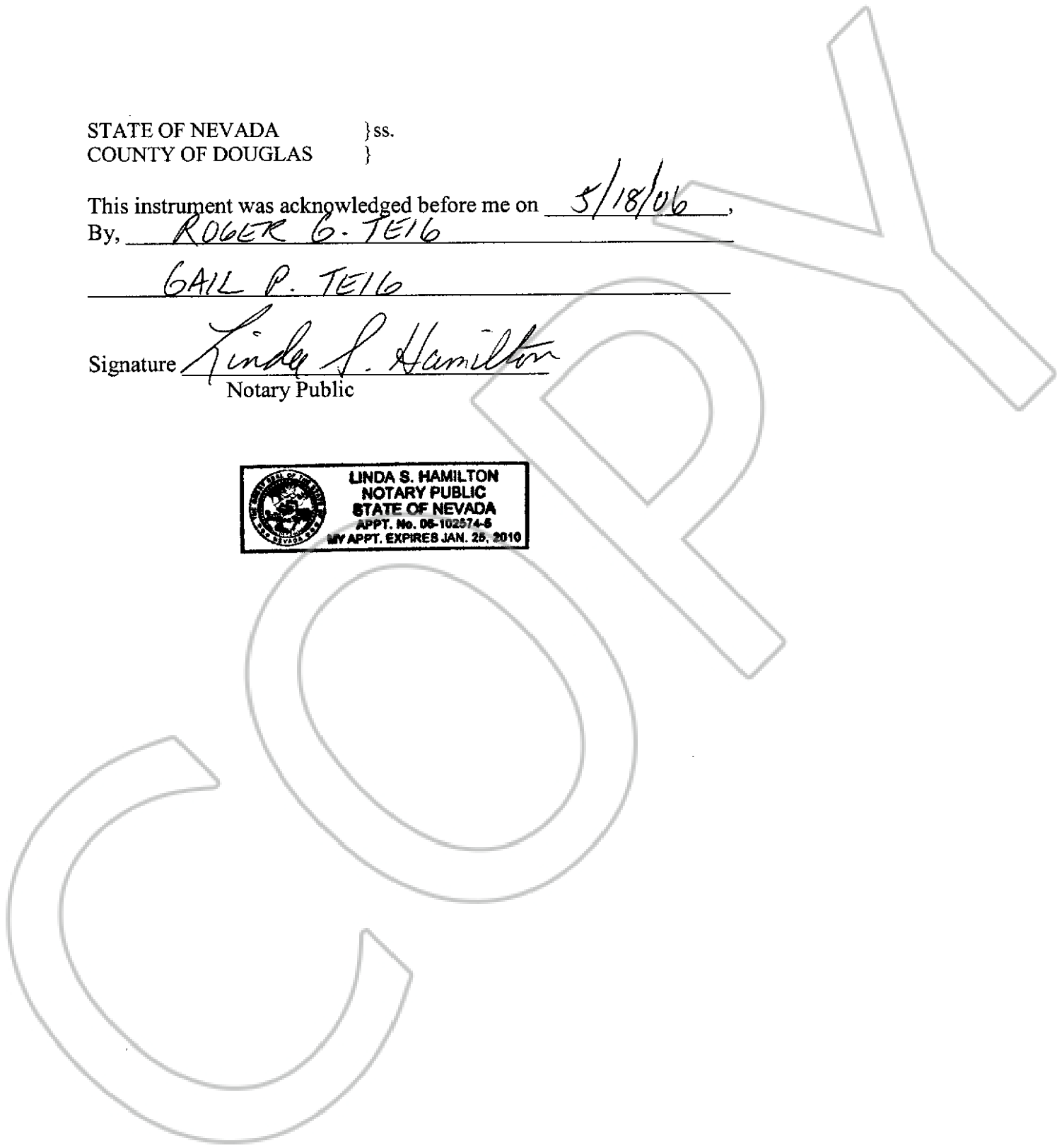
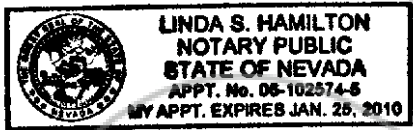

**DESCRIPTION
ADJUSTED PARCEL 4
(A.P.N. 1319-22-000-009)**

All that real property situate in the County of Douglas, State of Nevada, described as follows:

A parcel of land located within a portion of the Southwest one-quarter (SW1/4) of Section 22, Township 13 North, Range 19 East, Mount Diablo Meridian, more particularly described as follows:

Commencing at the southwest corner of Parcel 4 as shown on the Map of Division into Large Parcels for Teig Family Ltd. Partnership and Pamela Lyn Niehoff recorded August 8, 1996 in Book 896, at Page 1541, as Document No. 393888,

thence along the southerly line of said Parcel 4, South 89°24'54" East, 1047.63 feet to a point on the westerly right-of-way of Foothill Road as shown on said Map of Division into Large Parcels;

thence along said westerly right-of-way of Foothill Road, North 11°33'00" East, 1044.61 feet to the POINT OF BEGINNING;

thence leaving said westerly right-of-way of Foothill Road, North 89°57'45" West, 795.49 feet;

thence North 00°02'15" East, 927.01 feet to a point on the north line of said Southwest one-quarter (SW1/4) of Section 22;

thence along said north line of the Southwest one-quarter (SW1/4) of Section 22, South 89°57'45" East, 1017.66 feet to a point on said westerly right-of-way of Foothill Road, said point also being the northeast corner of said Parcel 4;

thence along said westerly right-of-way of Foothill Road, along the arc of a curve to the left, non tangent to the preceding course, having a radius of 1040.00 feet, central angle of 14°24'03" , arc length of 261.39 feet, and radial bearing of South 64°02'57" East;

thence continuing along said westerly right-of-way of Foothill Road, South 11°33'00" West, 694.05 feet to the POINT OF BEGINNING, containing 19.00 acres, more or less.

The Basis of Bearing for this description is South 89°57'45" East, the north line of said Southwest one-quarter of Section 22 as shown on the Map of Division into Large Parcels for Teig Family Ltd. Partnership and Pamela Lyn Niehoff recorded August 8, 1996 as Document No. 393888.

Note: Refer this description to your title company before incorporating into any legal document.

Prepared By: R.O. ANDERSON ENGINEERING, INC.
P.O. Box 2229
Minden, Nevada 89423

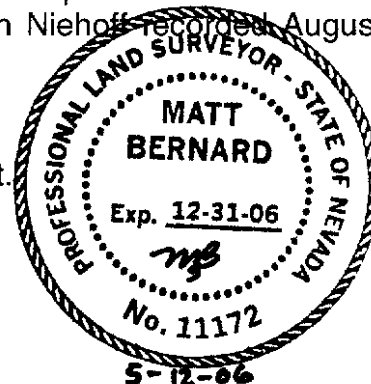

**DESCRIPTION
ADJUSTED PARCEL 1
(A.P.N. 1319-00-002-001)**

All that real property situate in the County of Douglas, State of Nevada, described as follows:

A parcel of land located within a portion of the Northeast one-quarter of the Southeast one-quarter (NE1/4SE1/4) and the Southeast one-quarter of the Northeast one-quarter (SE1/4NE1/4) of Section 21 and the Southwest one-quarter (SW1/4) of Section 22, Township 13 North, Range 19 East, Mount Diablo Meridian, more particularly described as follows:

Commencing at the southwest corner of Parcel 4 as shown on the Map of Division into Large Parcels for Teig Family Ltd. Partnership and Pamela Lyn Niehoff recorded August 8, 1996 in Book 896, at Page 1541, as Document No. 393888, the POINT OF BEGINNING;

thence along the westerly line of said Parcel 4, North 00°02'15" East, 889.14 feet to the southeast corner of Parcel 1 as shown on said Map of Division into Large Parcels;

thence along the southerly line of said Parcel 1, North 58°17'39" West, 2107.77 feet to a point on the east one-sixteenth (E1/16) line of said Section 21;

thence along said E1/16 line, North 00°14'30" East, 1260.58 feet to the northeast one-sixteenth (NE1/16) corner of said Section 21;

thence along the north one-sixteenth (N1/16) line of said Section 21, South 89°56'38" East, 1307.94 feet to the north one-sixteenth (N1/16) corner of said Section 21;

thence along the east line of said Southeast one-quarter of the Northeast one-quarter (SE1/4NE1/4) of Section 21, South 00°08'58" West, 1315.27 feet to the east one-quarter (E1/4) corner of said Section 21;

thence along the north line of said Southwest one-quarter (SW1/4) of Section 22, South 89°57'45" East, 944.63 feet;

thence South 00°02'15" West, 927.01 feet,

thence South 89°57'45" East, 795.49 feet to a point on the westerly right-of-way of Foothill Road as shown on said Map of Division into Large Parcels;

thence along said westerly right-of-way of Foothill Road, South 11°33'00" West, 1044.61 feet to the southeast corner of said Parcel 4;

thence along the southerly line of said Parcel 4, North 89°24'54" West, 1047.63 feet to the POINT OF BEGINNING, containing 96.79 acres, more or less.

The Basis of Bearing for this description is South 89°57'45" East, the north line of said Southwest one-quarter of Section 22 as shown on the Map of Division into Large



0944-007-03

05/04/06

Page 2 of 2

Parcels for Teig Family Ltd. Partnership and Pamela Lyn Niehoff recorded August 8, 1996 as Document No. 393888.

Note: Refer this description to your title company before incorporating into any legal document.

Prepared By: R.O. ANDERSON ENGINEERING, INC.
P.O. Box 2229
Minden, Nevada 89423

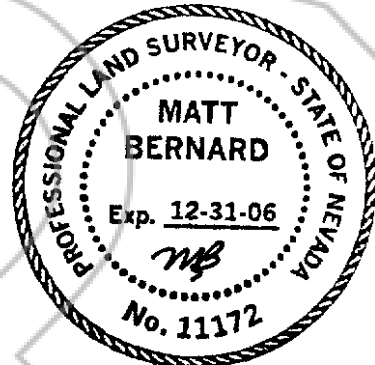

5-12-06

