

Douglas County - NV
Werner Christen - Recorder
Page: 1 of 3 Fee: 16.00
BK-0806 PG- 6760 RPTT: # 7



APN# 1318-10-413-001
11 digit number may be obtained at:
<http://sandgate.co.clark.nv.us/cicsAssessor/ownr.htm>

QUITCLAIM DEED

Type of Document
(Example: Declaration of Homestead, Quit Claim Deed, etc.)

Recording requested by:

FERRUZZO & FERRUZZO, LLP

Return to:

Name JIM LHOTKA and JANIS CAROL LHOTKA

Address 406 Alta Vista Way

City/State/Zip Laguna Beach, CA 92651

This page added to provide additional information required by NRS 111.312 Sections 1-2
(An additional recording fee of \$1.00 will apply.)

This cover page must be typed or printed clearly in black ink only.

A.P.N. #1318-10-413-001

RECORDING REQUESTED BY:
FERRUZZO & WORTHE, LLP
3737 Birch Street, Suite 400
Newport Beach, CA 92660

**AND WHEN RECORDED MAIL TO
MAIL TAX STATEMENTS TO:**

JIM LHOTKA and
JANIS CAROL LHOTKA, Trustees
406 Alta Vista Way
Laguna Beach, CA 92651

SPACE ABOVE THIS LINE FOR RECORDERS USE.

Grant Deed The undersigned Grantor(s) declare(s) under penalty of perjury that the following is true and correct.
There is no consideration for this transfer: RPTT is \$0.

QUITCLAIM DEED

JANIS LHOTKA, a married woman as her sole and separate property, hereinafter referred to as "Grantors," hereby remises, releases and quitclaims to JIM LHOTKA AND JANIS CAROL LHOTKA, TRUSTEES OF THE JIM AND JAN LHOTKA FAMILY TRUST, UDT, DATED July 23, 2006, all of her right, title and interest in and to the following real property located at 644 North Martin, Zephyr Cove, Douglas County, Nevada, and described as: (APN 1318-10-413-001)

See Exhibit "A" attached hereto and incorporated herein by reference.

Subject to all exceptions, covenants, conditions, restrictions, liens and encumbrances thereon.

Dated: July 23, 2006

Janis Lhotka
JANIS LHOTKA

State of CA) ss.
County of Orange)

On July 23, 2006, before me, Bianca Pegues, Notary Public, personally appeared JANIS LHOTKA, personally known to me or (proved to me on the basis of satisfactory evidence) to be the person whose name is subscribed to the within instrument, and acknowledged that she executed the same in her authorized capacity, and that by her signature on the instrument the person or the entity upon behalf of which the person acted, executed the instrument.

WITNESS my hand and official seal.
Bianca N Pegues

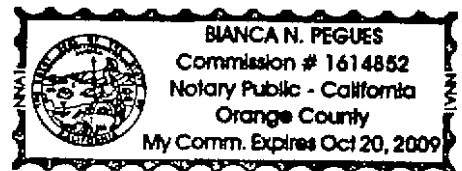

MAIL TAX STATEMENTS AS INDICATED ABOVE.

0682474 Page: 2 Of 3 08/17/2006
BK- 0806
PG- 6761

EXHIBIT "A"

The land referred to herein is situated in the State of Nevada, County of Douglas described as follows:

Lot 81, as shown on the official map of ZEPHYR KNOLLS SUBDIVISION UNIT NO. 4, filed in the office of the County Recorder of Douglas County, Nevada on October 14, 1957, as Document No. 12699.

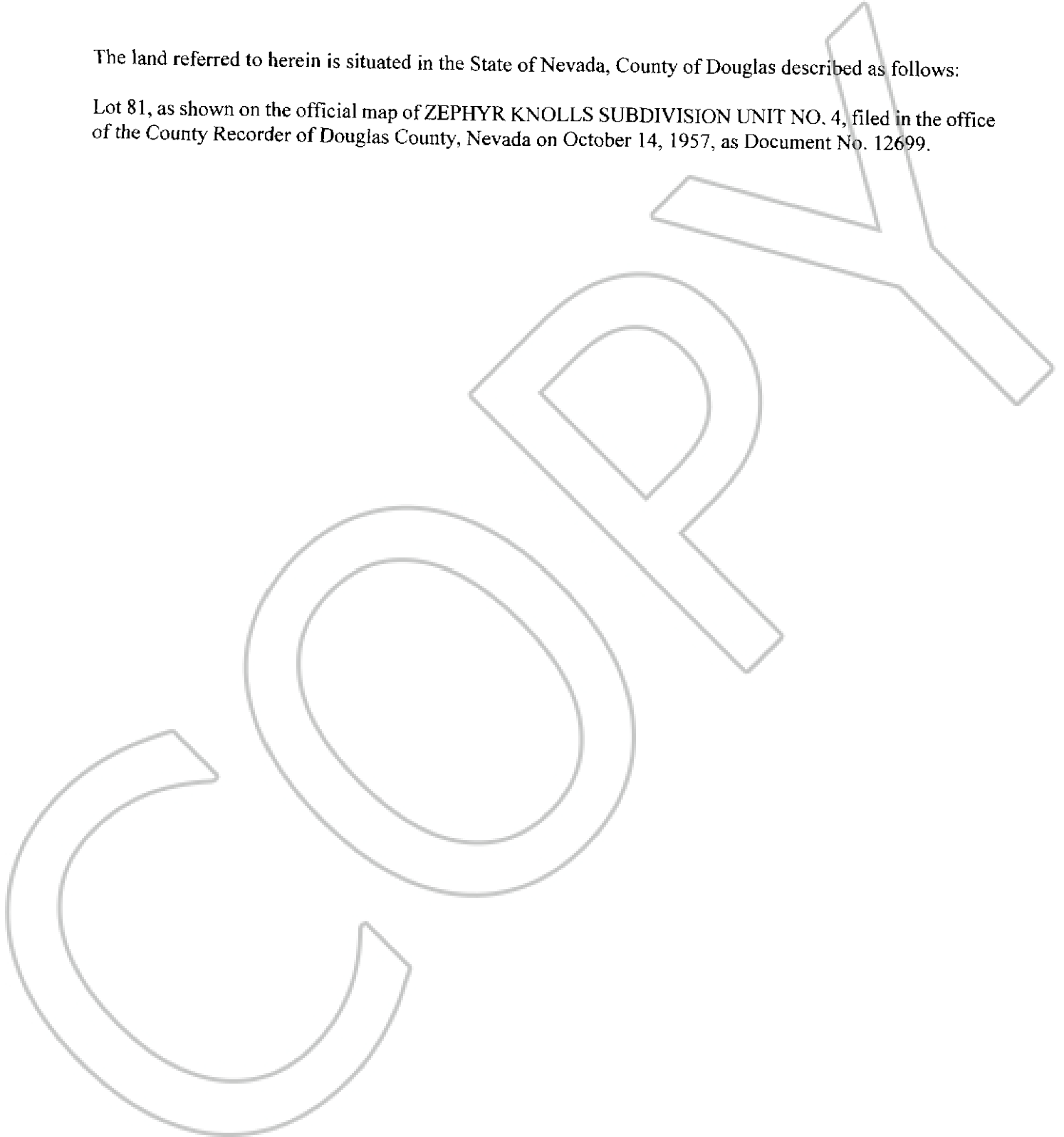

BK- 0806
PG- 6762
0682474 Page: 3 Of 3 08/17/2006