

① 2h

DOC # 0685769
10/05/2006 10:30 AM Deputy: PK

OFFICIAL RECORD
Requested By:
HEATON & DOESCHER LTD

A.P.N. 1419-04-000-006
1419-04-000-005
1419-04-000-003
1419-04-000-004
1419-04-000-002
1419-04-000-008

Douglas County - NV
Werner Christen - Recorder
Page: 1 Of 9 Fee: 22.00
BK-1006 PG- 1242 RPTT: 0.00



When Recorded Return To:
Scott J. Heaton, Esq.
Heaton, Ltd.
Post Office Box 605
Carson City, Nevada 89702

ABANDONMENT OF NON-EXCLUSIVE EASEMENT



ABANDONMENT OF NON-EXCLUSIVE EASEMENT

THIS ABANDONMENT OF NON-EXCLUSIVE EASEMENT is entered into this 3rd day of October, 2006, by and between H. DUANE CARPENTER and ANN C. CARPENTER, husband and wife (herein "CARPENTER"), JENNIFER K. CRAWLEY and BARBARA K. ALEXANDER, Trustee of the BARBARA K. ALEXANDER 1983 TRUST (herein "CRAWLEY and ALEXANDER"), JAMES W. ALEXANDER, Trustee of the JAMES W. ALEXANDER 1993 LIVING TRUST and BARBARA K. ALEXANDER, Trustee of the BARBARA K. ALEXANDER 1993 LIVING TRUST (herein "ALEXANDER and ALEXANDER"), MICHAEL L. MASLOW (herein "MASLOW"), and CLEAR CREEK, LLC (herein "CLEAR CREEK"), and their successors and assigns, all of said parties collectively referred to as "the Property Owners".

The Property Owners have an interest, either as owner or encumbrancer, in the real estate described as Assessor Parcel Numbers 1419-04-000-006, 1419-04-000-005, 1419-04-000-003, 1419-04-000-004, 1419-04-000-002, and 1419-04-000-008, more particularly described in Exhibit "A", attached hereto, and by this reference incorporated herein.

The Property Owners are desirous of abandoning the existing common roadway and any prescriptive and non-exclusive easement rights in connection with said common roadway which is described in Exhibit "B", attached hereto and by this reference incorporated herein and intend to relocate said roadway and grant a new non-exclusive easement for a roadway over, across, through and to the above-described properties for the benefit of each of them. In this regard, the existing non-exclusive easement

described in Exhibit "B" is hereby abandoned by the Property Owners.

H. Duane Carpenter
H. DUANE CARPENTER

Ann C. Carpenter
ANN C. CARPENTER

Jennifer K. Crawley
JENNIFER K. CRAWLEY (as to an undivided 50% interest as tenants in common)

Barbara K. Alexander TTE
BARBARA K. ALEXANDER, Trustee of the BARBARA K. ALEXANDER 1983 TRUST (as to an undivided 50% interest as tenants in common)

James W. Alexander
JAMES W. ALEXANDER, Trustee of the JAMES W. ALEXANDER 1993 LIVING TRUST (as tenants in common)

Barbara K. Alexander TTE
BARBARA K. ALEXANDER, Trustee of the BARBARA K. ALEXANDER 1993 LIVING TRUST (as tenants in common)

Michael L. Maslow
MICHAEL L. MASLOW

CLEAR CREEK, LLC

By [Signature]

STATE OF NEVADA)
) SS.
CARSON CITY)

On SEPT 6, 2006, before me, a notary public, personally appeared H. DUANE CARPENTER, personally known to me to be the person whose name is subscribed to the above instrument who acknowledged that he executed the instrument.

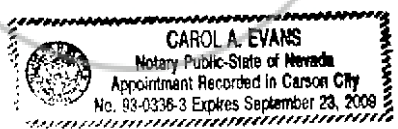

Carol A. Evans
Notary Public

STATE OF NEVADA)
) ss.
CARSON CITY)

On SEPT 6, 2006, before me, a notary public, personally appeared ANN C. CARPENTER, personally known to me to be the person whose name is subscribed to the above instrument who acknowledged that she executed the instrument.



Carol A. Evans
Notary Public

STATE OF NEVADA
) ss.
)

On 08/30/2006, before me, a notary public, personally appeared M. DUANE CARPENTER, personally known to me to be the person whose name is subscribed to the above instrument who acknowledged that he executed the instrument.

Notary Public

STATE OF NEVADA)
) ss.
CARSON CITY)

On 08/30/2006, 2006, before me, a notary public, personally appeared JENNIFER K. CRAWLEY, personally known to me to be the person whose name is subscribed to the above instrument who acknowledged that she executed the instrument.

Brian Howard
Notary Public

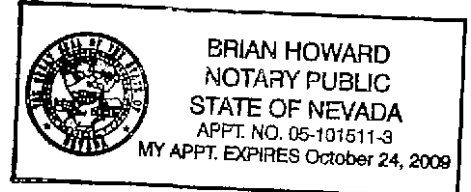

STATE OF NEVADA)
) ss.
)

On August 22nd, 2006, before me, a notary public, personally appeared BARBARA K. ALEXANDER, Trustee of the BARBARA K. ALEXANDER 1983 TRUST, personally known to me to be the person whose name is subscribed to the above instrument who acknowledged that she executed the instrument.

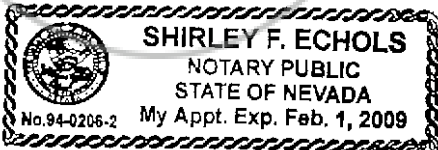

Shirley F Echols
Notary Public

STATE OF NEVADA)
)
) ss.
)

On August 22, 2006, before me, a notary public, personally appeared JAMES W. ALEXANDER, Trustee of the JAMES W. ALEXANDER 1993 LIVING TRUST, personally known to me to be the person whose name is subscribed to the above instrument who acknowledged that he executed the instrument.

Shirley F. Echols
Notary Public **SHIRLEY F. ECHOLS**
NOTARY PUBLIC
STATE OF NEVADA
No. 94-0208-2 My Appt. Exp. Feb. 1, 2009

STATE OF NEVADA)
)
) ss.
)

On August 22nd, 2006, before me, a notary public, personally appeared BARBARA K. ALEXANDER, Trustee of the BARBARA K. ALEXANDER 1993 LIVING TRUST, personally known to me to be the person whose name is subscribed to the above instrument who acknowledged that she executed the instrument.

Shirley F. Echols
Notary Public

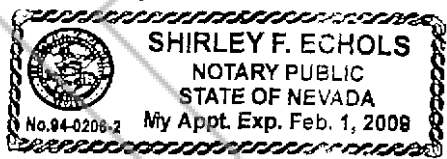

California
STATE OF ~~NEVADA~~)
)
) ss.
)
San Diego

On 8-16, 2006, before me, a notary public, personally appeared MICHAEL L. MASLOW, personally known to me to be the person whose name is subscribed to the above instrument who acknowledged that he executed the instrument.

M L Maslow
Notary Public

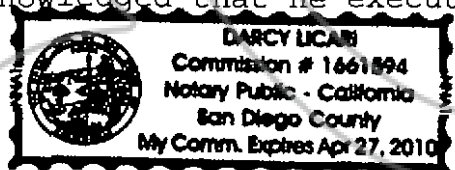

STATE OF NEVADA)
)
) ss.
)
CARSON CITY

On October 3, 2006, before me, a notary public, personally appeared John Serpa, Manager of CLEAR CREEK, LLC, and in his capacity as such, acknowledged that he executed the instrument.

Wendy A. McMARTIN
Notary Public

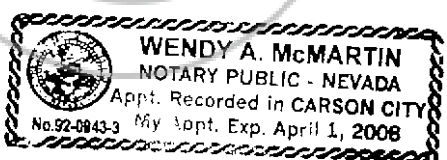

EXHIBIT A

CARPENTER

APN: 1419-04-000-006

All that certain real property situate in the County of Douglas, State of Nevada, described as follows:

A parcel of land located in the Northeast Quarter of the Northeast Quarter of Section 4, Township 14 North, Range 19 East, M.D.B. & M, described as follows:

BEGINNING at the Northwest corner of said Northeast Quarter of the Northeast Quarter of Section 4, from which the Northeast corner of said Section 4 bears North $89^{\circ}45'47''$ East, 1326.96 feet; thence South $0^{\circ}47'33''$ West, 655.14 feet; thence North $89^{\circ}37'57''$ East, 1324.95 feet; thence North $0^{\circ}58'25''$ East, 49.36 feet; thence along the highway right of way line of old Highway 50, North $58^{\circ}04'00''$ West, 92.62 feet; thence on a curve to the left with a radius of 760.00 feet, through an angle of $24^{\circ}16'$ for a length of 321.89 feet; thence North $82^{\circ}20'00''$ West, 210.25 feet; thence on a curve to the right with a radius of 840.00 feet, through an angle of $38^{\circ}26'$ for a length of 563.46 feet; thence North $43^{\circ}54'00''$ West, 225.18 feet; thence South $89^{\circ}45'57''$ West, 79.80 feet to the point of beginning.

CRAWLEY

APN 1419-04-000-005

The real property situate in the County of Douglas, State of Nevada, described as follows:

The North $\frac{1}{2}$ of the Northwest $\frac{1}{4}$ of the Northeast $\frac{1}{4}$ of Section 4, Township 14 North, Range 19 East, M.D.B.&M.

Reference is made to the Parcel Map filed December 24, 1974 as File No. 76834 and to the Record of Survey filed November 2, 2001 as File No. 526863.

ALEXANDER

APN 1419-04-000-003

All that real property in the County of Douglas, State of Nevada, being Assessor's Parcel Number 15-030-08, specifically described as: All that certain lot, piece or parcel of land located within Section 4, Township 14 North, Range 19 East, M.D.B. & M., Douglas County, Nevada and being further described as follows:

Parcel 1, as set forth on Parcel Map for JAMES W. ALEXANDER and BARBARA K. ALEXANDER and CHARLES M. SCHOTT JR., filed for record in the office of the County Recorder of Douglas County, Nevada on May 3, 1993, in Book 593, of Official Records at Page 152, as Document No. 306156.

ALEXANDER

APN 1419-04-000-004

All that certain lot, piece or parcel of land situate in the County of Douglas, State of Nevada, described as follows:

Being all of Parcel 2 as shown on the Parcel Map for ROBERT ROGERS, et ux, filed for record in the office of the County Recorder of Douglas County, Nevada, on December 5, 1974, In Book 1274 of Official Records at Page 243, as File No. 76834 and a Portion of the Southeast $\frac{1}{4}$ of the Northwest, $\frac{1}{4}$ of Section 4, Township 14 North, Range 19 East and being more particularly described as follows:

BEGINNING at the Southeast Corner of Parcel 1 as shown on said Parcel Map, thence from said point of beginning, South $0^{\circ}36'40''$ West 658.19 feet to the Southeast corner of said Parcel 2; thence South $43^{\circ}01'50''$ West 400.00 feet; thence South $55^{\circ}14'02''$ West, 595.00 feet; thence North $26^{\circ}46'45''$ West 320.00 feet; thence North $32^{\circ}42'47''$ East 325.00 feet; thence North $64^{\circ}19'30''$ West 150.00 feet to a point on the Southerly boundary of said Parcel 2; thence South $89^{\circ}29'58''$ East 457.42 feet to the Southwest corner of said Parcel 2; thence along the Westerly boundary of said Parcel 2 North $0^{\circ}25'47''$ East 661.22 feet to the Northwest corner thereof; thence along the Northerly boundary of said Parcel 2 North $89^{\circ}37'57''$ East 1324.95 feet to the POINT OF BEGINNING.

MASLOW

APN 1419-04-000-002

All that real property situated in the County of Douglas, State of Nevada described as follows:

Parcel 1 as set forth on Parcel Map filed for record December 5, 1974, in Book 1274 Page 243, Document No. 76834, Official Records of Douglas County State of Nevada, said parcel being the North $\frac{1}{2}$ of the Northeast $\frac{1}{4}$ of the Northwest $\frac{1}{4}$ of Section 4, Township 14, North, Range 19 East M.D.B. & M.



CLEAR CREEK RANCH LLC

APN 1419-04-000-008

The land referred to herein is situated in the State of Nevada, County of DOUGLAS, described as follows:

Parcel 2 as set forth in the certain Map of Division in to Large Parcels # LDA 99-076 for the Estate of Harry R. Schneider being a portion of Sections 2, 3, 4, 9, 10 & 15 Township 14 North, Range 19 East, M.D.B. & M., filed for record in the Office of the County Recorder of Douglas County, State of Nevada on January 24, 2000, in Book 0100, at Page 3481, as Document No. 484935 and further imposed on that certain Record of Survey for Prim Holdings, Inc. recorded June 16, 2000 in Book 0600, Page 3610 as Document No. 494257.

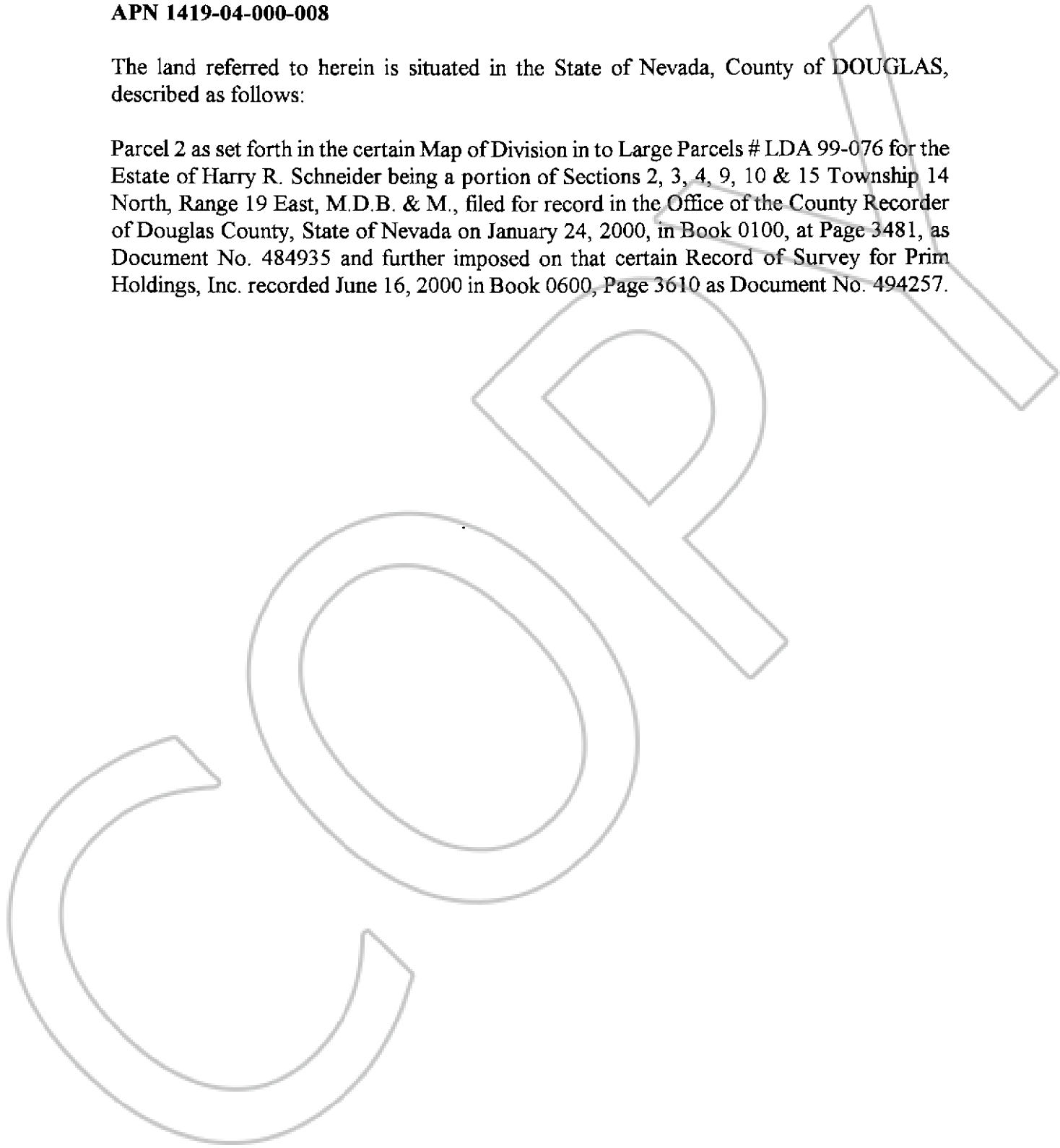

Exhibit "B"
Abandonment of existing Non-Exclusive Easement

Description:

That certain roadway commonly referred to as JEFFREY PINE LANE, located within the Northeast ¼ of Section 4, Township 14 North, Range 19 East, M.D.B.&M., in the County of Douglas, State of Nevada, referenced as follows:

- A portion of JEFFREY PINE LANE initially referenced in that certain Grant Bargain and Sale Deed from Harry R. Schneider to Robert G. Rogers, et al, recorded on December 30, 1971 in book 95 page 172-A as document no. 57137-A of the Official Records of Douglas County, Nevada.
- A portion of JEFFREY PINE LANE referenced in that certain Grant Bargain and Sale Deed from Harry R. Schneider to Robert G. Rogers, et al, recorded on June 29, 1972 in book 102 page 534 as document no. 60362 of the Official Records of Douglas County, Nevada.
- A portion of JEFFREY PINE LANE referenced in that certain Grant Bargain and Sale Deed from Robert G. Rogers, et al, to Robert H. Thomas, recorded on June 29, 1972 in book 102 page 536 as document no. 60363 of the Official Records of Douglas County, Nevada.
- JEFFREY PINE LANE depicted on PARCEL MAP OWNERS ROBERT & JANE ROGERS, recorded on February 5, 1974 as document number 76834, identified thereon as ROAD EASEMENT and ACCESS EASEMENT.
- A portion of JEFFREY PINE LANE referenced in that certain EASEMENT AGREEMENT by and between ANNA MARIE THORKILDSEN, as Trustee of the ORIN THORKILDSEN and ANNA THORKILDSEN FAMILY TRUST, CHARLES SCHOTT, JAMES W. ALEXANDER and BARBARA K. ALEXANDER, recorded on January 25, 1993 in book 193 page 3546, as document no. 238096 of the Official Records of Douglas County, Nevada.
- A portion of JEFFREY PINE LANE depicted on PARCEL MAP FOR JAMES W. ALEXANDER, BARBARA K. ALEXANDER and CHARLES M. SCHOTT JR., recorded on May 3, 1993 in book 593 page 152, document no. 306156 of the Official Records of Douglas County, Nevada.
- JEFFREY PINE LANE depicted on RECORD OF SURVEY FOR THE BARBARA K. ALEXANDER LIVING TRUST and THE JAMES W. ALEXANDER LIVING TRUST, recorded on November 2, 2001 in book 1101 page 440, document no. 526893 of the Official Records of Douglas County, Nevada.