

17  
RETURN TO:  
Minden-Gardnerville Sanitation District  
Post Office Box 568  
Minden, NV 89423

APN 1320-27-001-010

DOC # 0689960  
12/04/2006 02:02 PM Deputy: SD  
**OFFICIAL RECORD**  
Requested By:  
MINDEN GARDNERVILLE  
SANITATION DISTRICT  
Douglas County - NV  
Werner Christen - Recorder  
Page: 1 Of 4 Fee: 17.00  
BK-1206 PG- 852 RPTT: 0.00



## GRANT OF EASEMENT

This indenture, made and entered into this 21<sup>st</sup> day of November, 2006, by and between BENTLY PRESSURIZED BEARING COMPANY, hereinafter referred to as Grantor, and the MINDEN-GARDNERVILLE SANITATION DISTRICT, hereinafter referred to as Grantee,

### WITNESSETH

That for and in consideration of the sum of One Dollar (\$1.00), lawful money of the United States of America, (and other good and valuable consideration), the Grantor hereby grants to the Grantee, its successors and assigns, a permanent easement 20 feet wide for the installation and maintenance of a sewer line, together with other necessary or convenient appurtenances connected therewith, across, over, and upon the following described lands and premises, situate in the County of Douglas, State of Nevada:

See Attached Legal Description

Together with the right of ingress and egress to and from the said easement and the right to use existing roads for the purpose of constructing, inspecting, repairing, maintaining said sewer line and appurtenances.

Grantor agrees that no buildings or structures shall be placed upon, over, or under said easement, now or hereafter without the express approval of the Grantee, except that said parcel may be improved and used for street, road, landscape, or driveway purposes, insofar as such use does not interfere with its use by Grantee for the purposes for which this easement is granted.

It is further agreed that the Grantee shall be responsible for damage to personal property or improvements of Grantor by reason of Grantee's operation, maintenance, repair or improvements of said sewer lines.

*Donald E Bently*

Donald E. Bently  
Chairman and CEO  
Bently Pressurized Bearing Company



STATE OF Nevada )  
 ) SS  
COUNTY OF Douglas )

On the 21<sup>st</sup> day of NOVEMBER, 2006, personally appeared before me, a Notary Public, Donald E. Bently, who acknowledged to me that he/she/they executed the above instrument.

*Theresa Lether*  
Notary Public

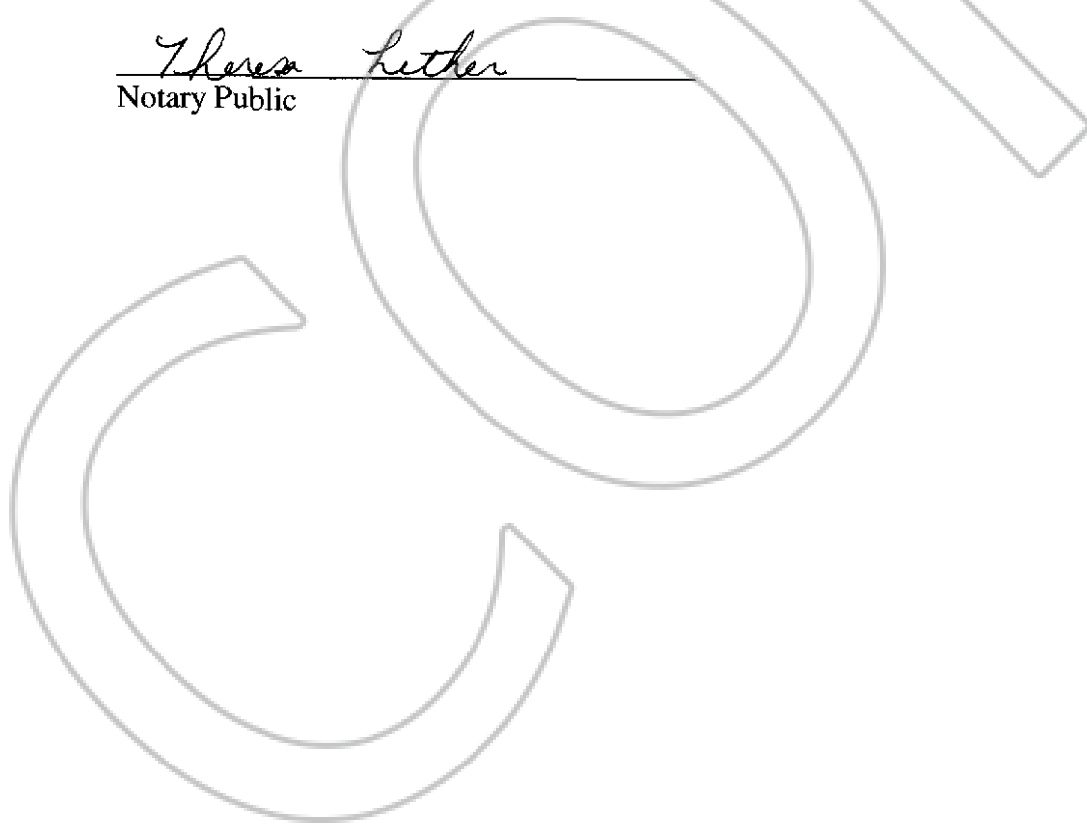

**DESCRIPTION  
SEWER EASEMENT  
(APN 1320-27-001-010)**

All that real property situate in the County of Douglas, State of Nevada, described as follows:

A twenty-foot wide (20') strip of land for sanitary sewer easement purposes, located within a portion of Section 27, Township 13 North, Range 20 East, Mount Diablo Meridian, more particularly described as follows:

Commencing at the intersection of Buckeye Road and Vector Drive, as shown on Final Map No. 1013 of Bently Science Park, recorded December 12, 1995 in the office of Recorder, Douglas County, Nevada as Document No. 376672;

thence North 22°44'49" West, 76.22 feet to the northeasterly end of a curve return on the west right-of-way line of Vector Drive and the north right-of-way line of Buckeye Road as shown on said Map, the POINT OF BEGINNING;

thence along the arc of said curve, concave to the northwest, having a radius of 20.00 feet, central angle of 10°23'35", arc length of 3.63 feet, and chord bearing and distance of South 05°37'47" West, 3.62 feet;

thence non-tangent to the preceding curve, North 89°29'43" West, 395.33 feet;

thence South 00°30'17" West, 16.42 feet, to the north right-of-way line of Buckeye Road;

thence along said right-of-way line, North 89°29'43" West, 20.00 feet;

thence North 00°30'17" East, 36.42 feet;

thence South 89°29'43" East, 415.63 feet, to the west right-of-way line of Vector Drive;

thence along the west right-of-way line of Vector Drive, South 00°25'59" West, 16.39 feet to the POINT OF BEGINNING, containing 8,641 square feet, more or less.

The Basis of Bearing of this description is North 89°29'43" West, the south line of Block "C", coincident with the north right-of-way line of Buckeye Road, as shown on said Map.

Note: Refer this description to your title company before incorporating into any legal document.

Prepared By: R.O. ANDERSON ENGINEERING, INC.  
P.O. Box 2229  
Minden, Nevada 89423

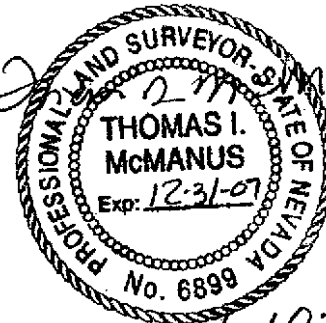

S:\Projects\0138-028\LEGAL 10-06\0138-028 SEWER ESMT10-06.leg.doc

11-10-06

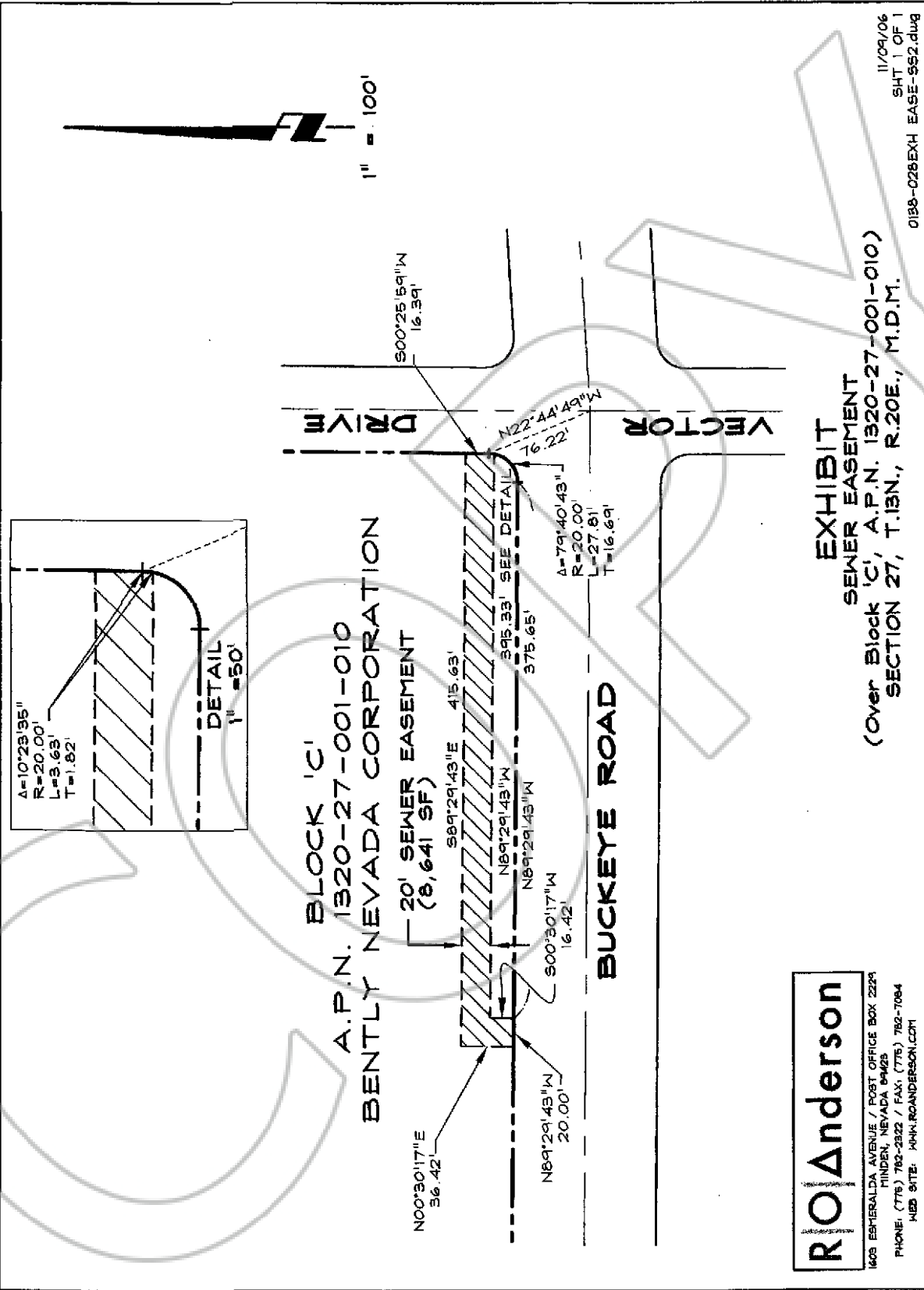

**ROAnderson**  
 1408 ESHERALDA AVENUE / POST OFFICE BOX 2224  
 HENDER, NEVADA 89425  
 PHONE: (775) 762-2322 / FAX: (775) 762-7084  
 WEB SITE: [WWW.ROANDERSON.COM](http://WWW.ROANDERSON.COM)

**EXHIBIT**  
**SEWER EASEMENT**  
**(Over Block 'C', A.P.N. 1320-27-001-010)**  
**SECTION 27, T.13N., R.20E., M.D.M.**

11/09/06  
 SH1 OF 1  
 0138-028EXH EASE-552.dwg