

15
DOC # 0691881
12/29/2006 03:05 PM Deputy: DW

OFFICIAL RECORD

Requested By:
THERESA D ANNAS

APN: 1420-35-201-301

RPTT \$ 0.00

When Recorded Return to:

Theresa Annas
✓ 1678 Sierra View Court
Minden, NV 89423

Mail Tax Statements to:
SAME AS ABOVE

Douglas County - NV
Werner Christen - Recorder

Page: 1 Of 2 Fee: 15.00
BK-1206 PG-11404 RPTT: # 5



SPACE ABOVE FOR RECORDERS USE

Grant, Bargain, Sale Deed

THIS INDENTURE WITNESSETH: That THERESA ANNAS and GARY ANNAS, WIFE AND HUSBAND AS JOINT TENANTS

In consideration of \$10.00, the receipt of which is hereby acknowledged, do(es) hereby Grant, Bargain, Sell and Convey to THERESA D. ANNAS, a married woman as her sole and separate property

all that real property situated in the City of Minden, County Douglas, State of Nevada, described as follows:

See Exhibit A attached hereto and made a part hereof.

Together with all and singular the tenements, hereditaments and appurtenances thereunto belonging or in anywise appertaining.

Witness my/our hand(s) this 28TH day of December, 2006.

THERESA ANNAS

GARY ANNAS

STATE OF NEVADA
COUNTY OF DOUGLAS

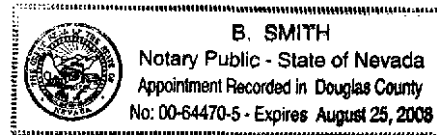

This instrument was acknowledged before me on 12/29/06 _____,
by Theresa Annas & Gary Annas

NOTARY PUBLIC

SPACE BELOW FOR RECORDER

Exhibit A

Parcel 1 as set forth on that certain Parcel Map for Scott M. & Raymond M. Smith filed for record in the Office of the County Recorder May 31, 1991, Book 591, Page 4480, Document No. 251748, Official Records of Douglas County, Nevada.

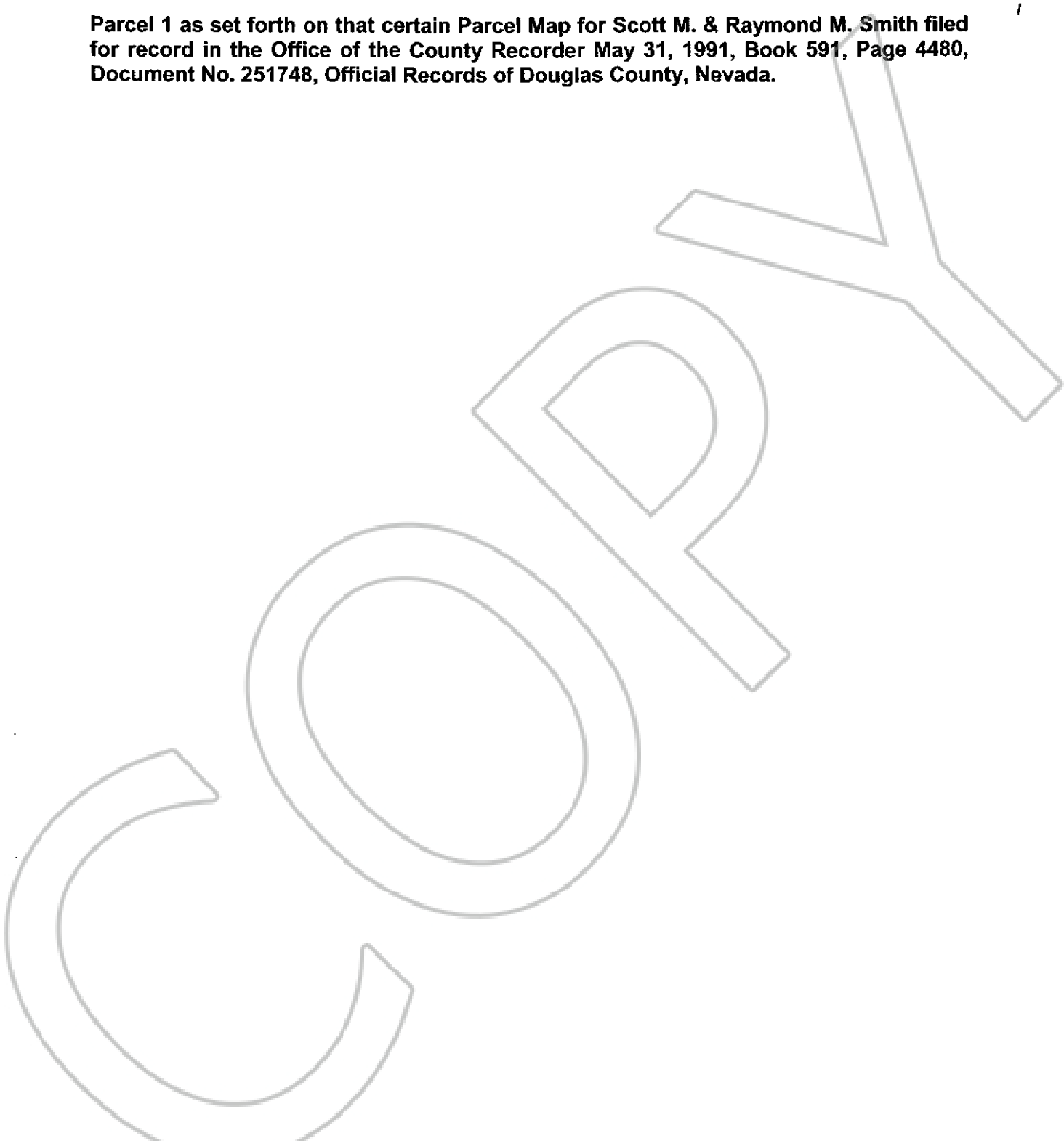

SPACE BELOW FOR RECORDER
