

The undersigned hereby affirms that this document does not contain a Social Security Number.

Print Name Under Signature:

Douglas County - NV  
Werner Christen - Recorder  
Page: 1 of 3 Fee: 16.00  
BK-0207 PG-00055 RPTT: 0.00

When Recorded Return To:  
✓ Bob Sanfilippo  
R.O. Box 2365  
Stateline, NV



Assessor Parcel Number: 0800 07 440-110  
1318-24-410-012

### DECLARATION OF HOMESTEAD

Check One:

- Married (filing joint declaration)
- Head of Family
- By Husband (filing for joint benefit or both)
- Single, Married or Widowed
- By Wife (filing joint benefit or both)
- Multiple Single Persons
- Other: \_\_\_\_\_

A: Check One

- Regular Home Dwelling/Manufactured Home
- Condominium Unit
- Other

Name on Title of Property: Sanfilippo, Robert R. + Diana L.

Do individually or severally certify and declare as follows:

We are now residing on the land, premises (or manufactured home) located in the City of: Stateline  
County of: Douglas, State of Nevada, and more particularly described as follows:

(Set forth legal description and commonly known street address OR manufactured home description)  
418 Kingsbury Grade Stateline NV; (off 12 of Kingsbury Pine)

B: \_\_\_\_\_ I/We claim the land and premises hereinabove described, together with the dwelling house thereon, and its appurtenances, or the described manufactured home as a Homestead.

In Witness, Whereof, I/We have hereunto set my hand/our hands this \_\_\_\_\_ day of \_\_\_\_\_ 20\_\_\_\_\_.

Robert R. Sanfilippo \_\_\_\_\_  
Signature Signature  
Robert R. Sanfilippo \_\_\_\_\_  
Print Name here Print Name here

*Signing in Counter part*

STATE OF NEVADA  
COUNTY OF Douglas

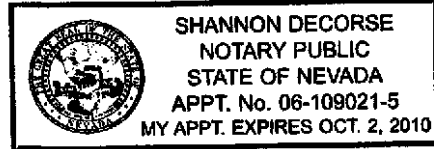

This instrument was acknowledged before me on \_\_\_\_\_  
Robert Ralph Sanfilippo  
Person(s) appearing before notary  
Shannon Decorse My commission expires: 2-10-2010  
(Signature of notarial officer)

The undersigned hereby affirms that this document does not contain a Social Security Number.

Print Name Under Signature: \_\_\_\_\_

When Recorded Return To:  
Diana Brown  
P.O. Box 3058  
State Line, NV. 89449

Assessor Parcel Number: 0000-07-440-126

### DECLARATION OF HOMESTEAD

Check One:

- Married (filing joint declaration)
- Head of Family
- By Husband (filing for joint benefit or both)
- Single, Married or Widowed
- By Wife (filing joint benefit or both)
- Multiple Single Persons
- Other: \_\_\_\_\_

A: Check One

- Regular Home Dwelling/Manufactured Home
- Condominium Unit
- Other \_\_\_\_\_

Name on Title of Property: Sanfilippo, Roberto R. + Diana L.

Do individually or severally certify and declare as follows: \_\_\_\_\_

we are now residing on the land, premises (or manufactured home) located in the City of: State Line

County of: Douglas, State of Nevada, and more particularly described as follows:

(Set forth legal description and commonly known street address OR manufactured home description)  
418 Kingsbury Grave; Lot 12 of Kingsbury Blvd

B: \_\_\_\_\_ I/We claim the land and premises hereinabove described, together with the dwelling house thereon, and its appurtenances, or the described manufactured home as a Homestead.

In Witness, Whereof, I/We have hereunto set my hand/our hands this 1st day of February 2007.

Diana L. Brown Sanfilippo  
Signature

Signature

Diana Brown-Sanfilippo  
Print Name here

Print Name here

STATE OF NEVADA  
COUNTY OF Douglas

This instrument was acknowledged before me on \_\_\_\_\_

Diana Brown-Sanfilippo  
Person(s) appearing before notary

[Signature]  
(Signature of notarial officer)

My commission expires: 10/10

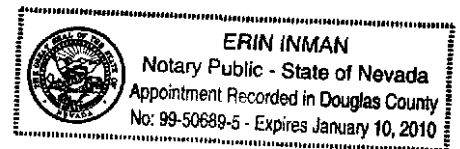

CONSULT AN ATTORNEY IF YOU DOUBT THIS FORM'S FITNESS FOR YOUR PURPOSE. This form provided as a courtesy to the taxpayer by: Douglas County Recorder's Office. The Recorder's Office assumes no liability for the completion of the Homestead Declaration.  
NOTE: Please leave 1" margins blank.

EXHIBIT B  
GRANT, BARGAIN, SALE DEED

APN: 7-440-12  
#12 Katherine Court  
Stateline, NV 89449

Lot 12, as shown on the Amended Map of Kingsbury Pines filed in the Office of the County Recorder of Douglas County, Nevada, on May 2, 1979, as Document No. 32082.

TOGETHER WITH an Easement over Lot A (Common Area) as set forth in Sections 1 and 2 of Article II of the Covenants, Conditions and Restrictions recorded October 4, 1978 in Book 1078 of Official Records at Page 319, File No. 26006 and re-recorded October 20, 1979, in Book 1078 of Official Records at Page 1652 both of Douglas County, State of Nevada.

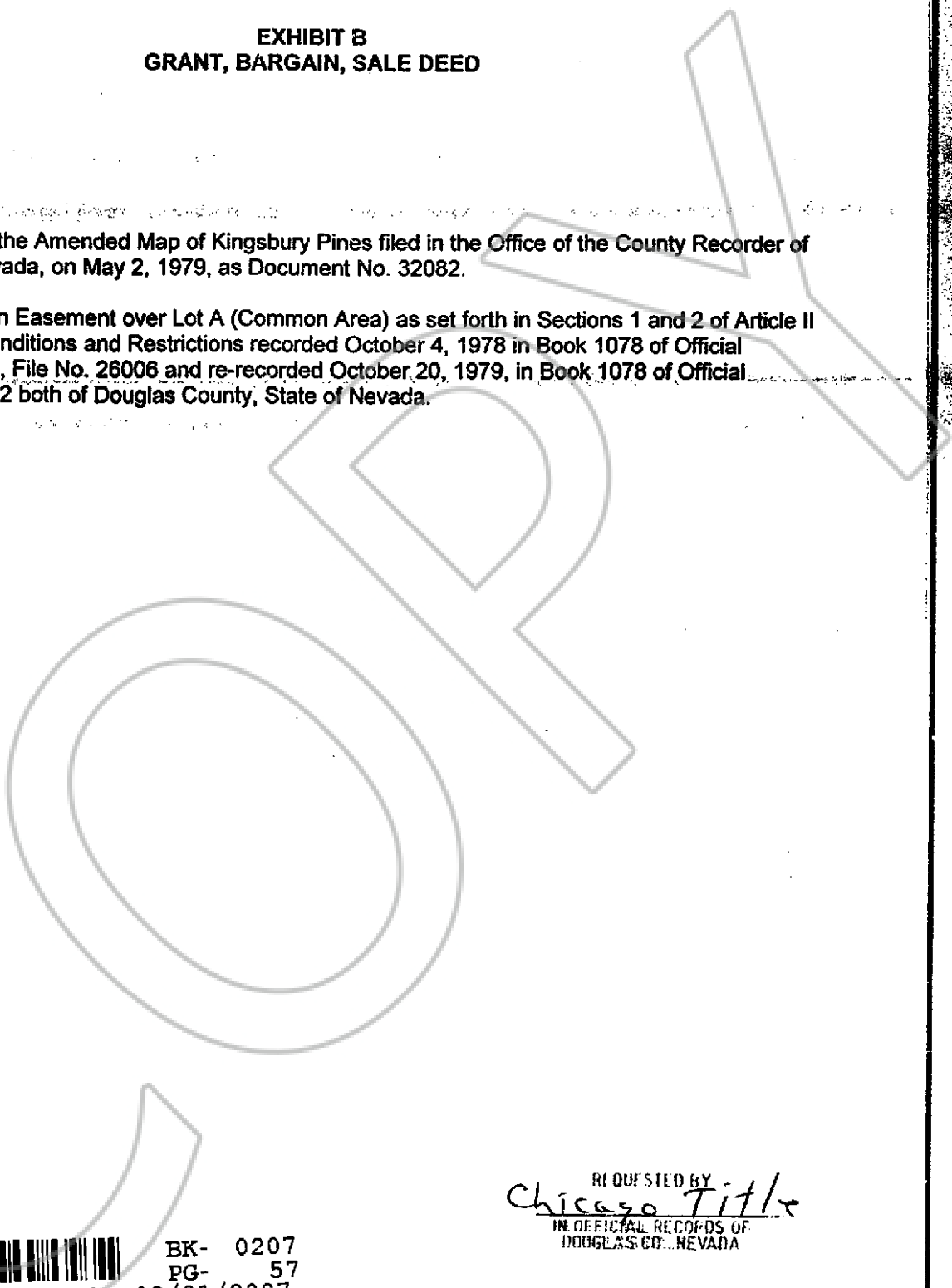

0694169 Page: 3 of 3

BK- 0207  
PG- 57  
02/01/2007

0474277  
BK0899PG2054

EXHIBIT B

REQUESTED BY  
*Chicago Title*  
IN OFFICIAL RECORDS OF  
DOUGLAS CO., NEVADA

'99 AUG 11 P3:08

CLERK, CLERK  
RECORDER  
10 PAID *K2* DEPUTY