

OFFICIAL RECORD

Requested By:

LOUANN M DEBERRY

The undersigned hereby affirms that this document does not contain a Social Security Number.

Louann DeBerry
Print Name Under Signature:

Douglas County - NV
Werner Christen - Recorder

Page: 1 Of 2 Fee: 15.00
BK-0207 PG-02779 RPTT: 0.00



When Recorded Return To:
✓ Louann DeBerry
Box 1128
Minden NV 89423

Assessor Parcel Number: 1420-29-602-022

DECLARATION OF HOMESTEAD

Check One:

- Married (filing joint declaration)
- Head of Family
- By Husband (filing for joint benefit or both)
- Single, Married or Widowed
- By Wife (filing joint benefit or both)
- Multiple Single Persons
- Other: _____

A: Check One

- Regular Home Dwelling/Manufactured Home
- Condominium Unit
- Other

Name on Title of Property: Louann M. DeBerry *A married woman as her sole and separate property.*

Do individually or severally certify and declare as follows:

Is/are now residing on the land, premises (or manufactured home) located in the City of: Minden

County of: Douglas, State of Nevada, and more particularly described as follows:

(Set forth legal description and commonly known street address OR manufactured home description)

1130 San Marcos Circle, Minden NV 89423
"see Exhibit A"

B: I/We claim the land and premises hereinabove described, together with the dwelling house thereon, and its appurtenances, or the described manufactured home as a Homestead.

In Witness, Whereof, I/We have hereunto set my hand/our hands this 8 day of FEB 2007.

Louann DeBerry
Signature
Louann M DeBerry
Print Name here

Signature

Print Name here

STATE OF NEVADA
COUNTY OF Douglas

This instrument was acknowledged before me on Feb 8, 2007

Person(s) appearing before notary: Louann DeBerry

Louann DeBerry
(Signature of notarial officer) My commission expires: April 15, 2007

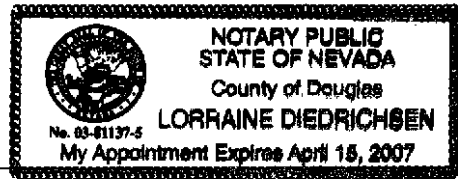

EXHIBIT "A"

LEGAL DESCRIPTION

ESCROW NO.: 060700885

The land referred to herein is situated in the State of Nevada, County of Douglas described as follows:

Lot 299, in Block C, as shown on the Final Map #PD99-02-08 of SARATOGA SPRINGS ESTATES UNIT 8, A PLANNED DEVELOPMENT, filed in the Office of the Douglas County Recorder on October 18, 2004, as Document No. 626992.

ASSESSOR'S PARCEL NO. 1420-29-612-022

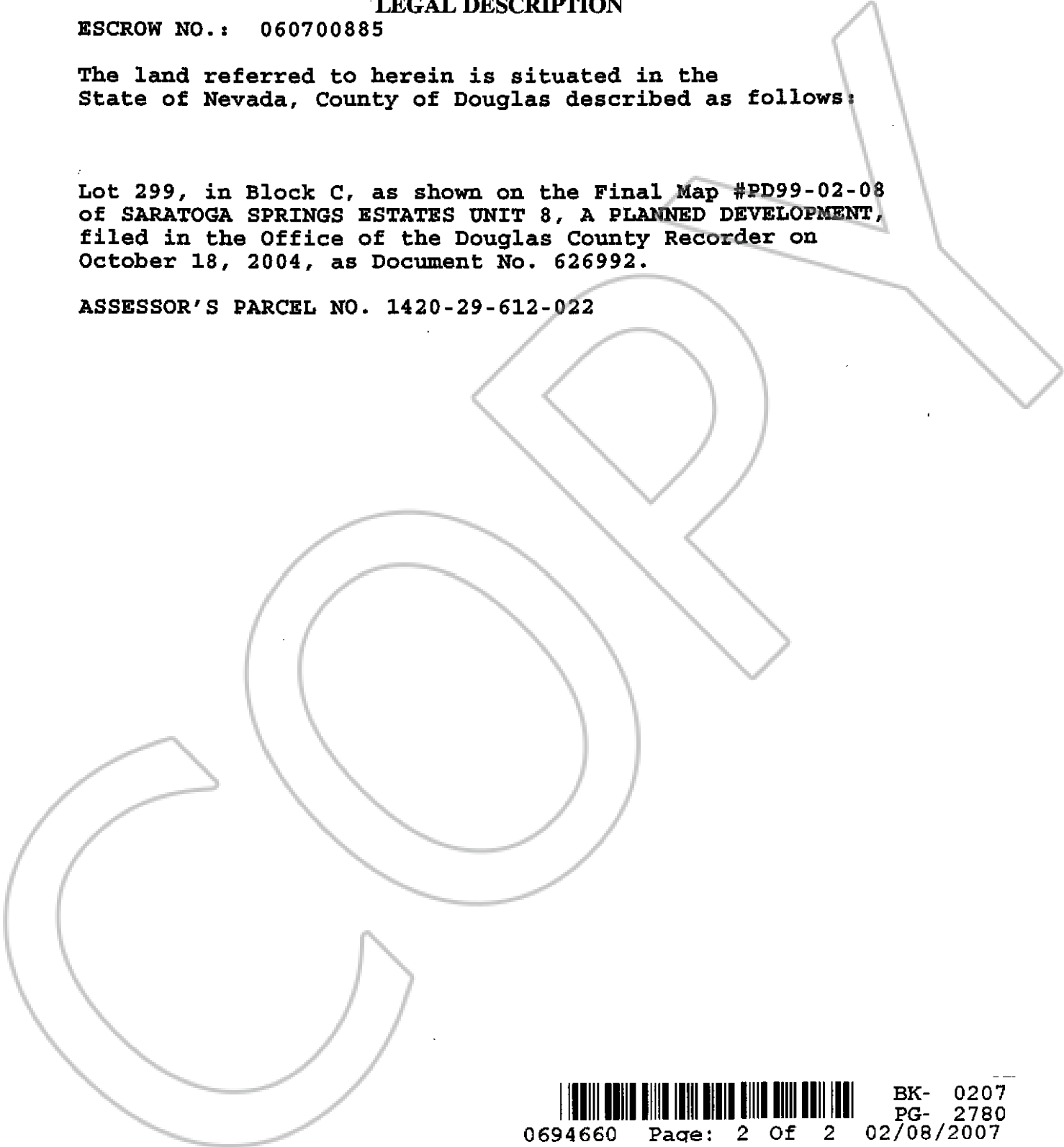

0694660 Page: 2 Of 2 02/08/2007

BK- 0207
PG- 2780



0678252 Page: 2 Of 2 06/28/2006

BK- 0606
PG- 9765