

OFFICIAL RECORD

Requested By:

JEANETTE & JOHN JENSEN

The undersigned hereby affirms that this document does not contain a Social Security Number.

Jeanette L. Jensen
Print Name Under Signature: Jeanette L. Jensen

When Recorded Return To:

✓ 1011 Silver Ranch Dr.
Gardnerville, NV 89460

Assessor Parcel Number: 1220-09-410-017

Douglas County - NV
Werner Christen - Recorder

Page: 1 Of 2 Fee: 15.00
BK-0407 PG-4862 RPTT: 0.00



DECLARATION OF HOMESTEAD

Check One:

- Married (filing joint declaration)
- Head of Family
- By Husband (filing for joint benefit or both)
- Single, Married or Widowed
- By Wife (filing joint benefit or both)
- Multiple Single Persons
- Other: _____

A: Check One

- Regular Home Dwelling/Manufactured Home
- Condominium Unit
- Other _____

Name on Title of Property: John T. + Jeanette L. Jensen as Joint Tenants

Do individually or severally certify and declare as follows: _____

Is/are now residing on the land, premises (or manufactured home) located in the City of: Gardnerville

County of: Douglas, State of Nevada, and more particularly described as follows:

(Set forth legal description and commonly known street address OR manufactured home description)

Attach Exhibit "A"

B: _____ I/We claim the land and premises hereinabove described, together with the dwelling house thereon, and its appurtenances, or the described manufactured home as a Homestead.

In Witness, Whereof, I/We have hereunto set my hand/our hands this 16th day of April 2007.

John T. Jensen
Signature
John T. Jensen
Print Name here

Jeanette L. Jensen
Signature
Jeanette L. Jensen
Print Name here

STATE OF NEVADA _____
COUNTY OF DOUGLAS

This instrument was acknowledged before me on April 16th 2007

Jeanette L. Jensen only
Person(s) appearing before notary

Debra S York
(Signature of notarial officer) My commission expires: 7/14/2010

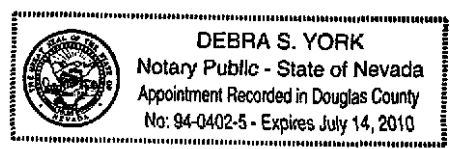

EXHIBIT "A"

LEGAL DESCRIPTION

ESCROW NO.: 060301412

The land referred to herein is situated in the State of Nevada, County of Douglas described as follows:

Lot 17, as shown on the Final Map of SILVERANCH UNIT 1-A, filed for record in the office of the County Recorder of Douglas County, State of Nevada, on January 3, 1994, in Book 194, Page 256, as Document No. 326668.

Assessors Parcel No. 1220-09-410-017

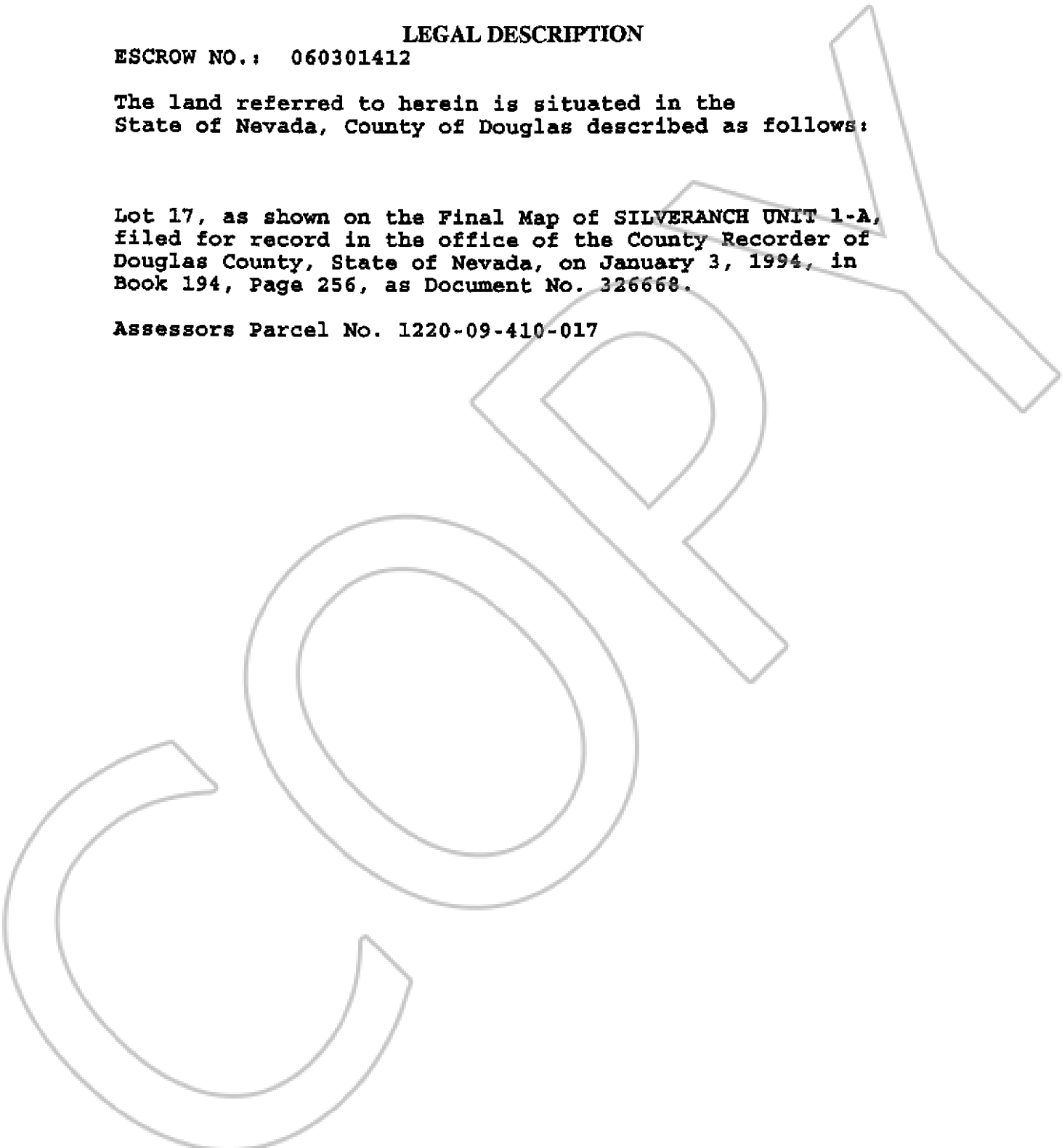

 BK- 0407
PG- 4863
0699250 Page: 2 Of 2 04/16/2007

 BK- 0806
PG- 8782
0682825 Page: 2 Of 2 08/22/2006