

54-
Assessor's Parcel Number: 1419-26-001-019
1419-26-001-020

Recording Requested By: R.O. Anderson Eng

Name: R.O. Anderson Engineering

Address: 1603 Esmeralda Ave

City/State/Zip Minden, NV 89423

Real Property Transfer Tax:

DOC # **0704686**
07/09/2007 02:31 PM Deputy: PK
OFFICIAL RECORD
Requested By:
RO ANDERSON ENGINEERING

Douglas County - NV
Werner Christen - Recorder
Page: 1 Of 41 Fee: 54.00
BK-0707 PG-2326 RPTT: 0.00



\$ _____

Grant of Slope and Private Storm Drainage
Easements and Temporary License
(Title of Document)

This page added to provide additional information required by NRS 111.312 Sections 1-2. (Additional recording fee applies)

This cover page must be typed or legibly hand printed.

Grant of Slope and Private Storm Drainage Easements and Temporary License [4]
A.P.N. 1419-26-001-019 and 1419-26-001-020

Recorded at the request of, and
after recording please return to:
Davidon Development Corp.
1600 South Main Street, Suite 150
Walnut Creek, CA 94596

**GRANT OF SLOPE AND PRIVATE STORM DRAINAGE EASEMENTS AND
TEMPORARY LICENSE**

MDA Enterprises, Inc., a Nevada corporation ("*MDA*") and Four Creeks Visalia, L.P., a California limited partnership ("*Four Creeks*") hereby grant certain easements upon the terms and conditions set forth below:

RECITALS

A. MDA is the owner of real property located in Douglas County, Nevada, commonly known as A.P.N. 1419-26-001-019 Adjusted Parcel 13 (the "*MDA Property*"); likewise, Four Creeks is the owner of real property located in Douglas County, Nevada, commonly known as A.P.N. 1419-26-001-020 Adjusted Remainder Parcel 1 (the "*Four Creeks Property*," together with the MDA Property, the "*Property*"). The Property is further described in the attached Exhibit A.

B. A development has been or is currently in the process of being constructed on or near the Property (the "*Development*").

C. Douglas County has approved the Development, but has required as a condition of such approval the granting of certain slope and private storm drainage easements.

D. In furtherance of satisfying the foregoing condition, MDA and Four Creeks desire to grant an easement over and upon a portion of the Property as more particularly described and depicted in the attached Exhibit B (the "*Easement Areas*") in accordance with the terms and conditions set forth below.

GRANT OF EASEMENTS AND TEMPORARY LICENSE

1. Grant of Easements. MDA and the successors and assigns of MDA in ownership of the MDA Property, hereby grant to Montaña Homeowners' Association, a Nevada non-profit corporation (the "*Association*"), perpetual non-exclusive easements, in, on, under and over the Easement Areas for the maintenance, repair and replacement of certain private storm drainage improvements within the Easement Areas, and for any other work necessary to maintain drainage

slopes within the Easement Areas, and for storm drainage for the Benefited Property (defined below), together with rights of access to and from the Easement Areas to accomplish the foregoing purposes (the "Easements"). Four Creeks grants an easement for storm drainage in, on, over and under the Four Creeks Property, but only in those areas established for drainage, including earthen drainage channels and storm drains designed to receive water from the adjacent MDA Property (the "Four Creeks Easement"). The Easements and the Four Creeks Easement shall benefit and be appurtenant to the property described in the attached Exhibit C (the "Benefited Property").

2. Grant of License. MDA further grants a temporary license to Davidon Development Corp., a Nevada corporation, to enter upon the Easement Areas to construct private storm drainage improvements and related storm drainage slopes (the "License"). The License shall expire upon the earlier of the completion of the foregoing improvements or December 31, 2007.

3. Affirmation of Maintenance Responsibilities. By signing below, the Association agrees to the maintenance responsibilities delegated to it in connection with the Easements, including that the Association shall, at its sole expense, maintain any improvements to the Easement Areas in a good and workmanlike manner at all times.

MDA Enterprises, Inc.,
a Nevada Corporation

By: 
Mario Antoci
Its: President
Date: 6/26/07

STATE OF NEVADA }
COUNTY OF DOUGLAS }

This instrument was acknowledged before me on June 26, 2007 by Mario Antoci as President of MDA Enterprises, Inc., a Nevada corporation.

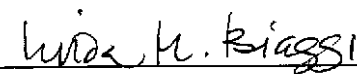
Notary Public

{Additional signatures follow on next page.}

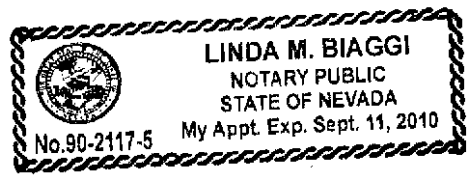

Four Creeks Visalia, L.P.
a California limited partnership

By: [Signature]

Its: X VICE PRESIDENT

Date: X July 1, 2007

STATE OF NEVADA }

COUNTY OF DOUGLAS }

This instrument was acknowledged before me on _____ by _____ as _____ of Four Creeks Visalia, a California limited partnership.

Notary Public

Montaña Homeowners' Association,
a Nevada non-profit corporation

By: X [Signature]

Its: X President

Date: X June 26, 2007

STATE OF NEVADA }

COUNTY OF DOUGLAS }

This instrument was acknowledged before me on June 26, 2007 by Chip L. Bowley as President of Montaña Homeowners' Association, a Nevada non-profit corporation.

[Signature]
Notary Public

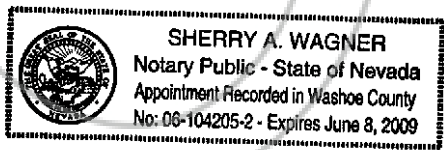

CALIFORNIA ALL-PURPOSE ACKNOWLEDGMENT

State of California)
) SS.
County of Contra Costa)

On July 2, 2007 before me, Linda J. Allen, Notary Public, personally appeared DENNIS J. RAZZARI, personally known to me to be the person whose name is subscribed to the within instrument and acknowledged to me that he executed the same in his authorized capacity, and that by his signature on the instrument the person, or the entity upon behalf of which the person acted, executed the instrument.

WITNESS my hand and official seal.

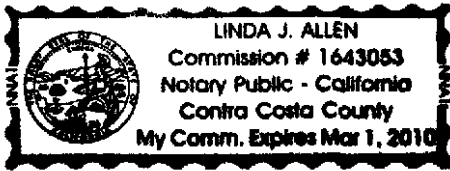

[Signature]

Notary Public

OPTIONAL

Though the data below is not required by law, it may prove valuable to persons relying on the document and could prevent fraudulent reattachment to this form.

Capacity claimed by signer:

VICE PRESIDENT

Signer is representing:

DAVIDON CORPORATION,
the General Partner of
Four Creeks Visalia, L.P.

EXHIBIT A

Legal Description

COPY



**DESCRIPTION
ADJUSTED PARCEL 13
(Adjusted APN 1419-26-001-015)**

All that real property situate in the County of Douglas, State of Nevada, described as follows:

A parcel of land located within portions of Section 26 and 27, Township 14 North, Range 19 East, Mount Diablo Meridian, more particularly described as follows:

Commencing at the northeast corner of Section 26, T.14N., R.19E., M.D.M., a found 1985 BLM aluminum cap, the POINT OF BEGINNING;

thence along the east line of the Northeast one-quarter of said Section 26, South 00°04'53" East, 2649.58 feet to the east one-quarter corner of said Section 26, a found 1985 BLM aluminum cap;

thence along the east line of the Southeast one-quarter of said Section 26, South 00°17'12" East, 238.23 feet;

thence WEST, 280.50 feet;

thence South 16°28'39" West, 455.86 feet;

thence South 48°32'24" West, 727.00 feet;

thence South 79°10'05" West, 171.38 feet;

thence South 65°39'14" West, 100.28 feet;

thence South 23°25'42" West, 143.74 feet;

thence North 66°34'18" West, 203.42 feet;

thence North 37°09'27" West, 169.17 feet;

thence WEST, 177.25 feet;

thence North 51°25'17" West, 137.89 feet;

thence South 38°34'43" West, 40.00 feet to a point on the boundary of Adjusted Parcel 13 as shown on the Record of Survey to Support a Boundary Line Adjustment for Genoa Land Investors, LLC, Genoa Developer Associates, LLC, MDA Enterprises, Inc. and Incomparable Holding Co. et al recorded June 30, 2005 in the office of Recorder, Douglas County, Nevada as Document No. 648319;

thence along said boundary of Adjusted Parcel 13, the following courses:

South 38°34'43" West, 32.08 feet;

Along the arc of a tangent curve to the right having a radius of 15.00 feet, central angle of 90°00'00", arc length of 23.56 feet, and chord bearing and distance of South 83°34'43" West, 21.21 feet;

North 51°25'17" West, 190.93 feet;

Along the arc of a tangent curve to the left having a radius of 230.00 feet,

central angle of $30^{\circ}15'37''$, arc length of 121.47 feet, and chord bearing and distance of North $66^{\circ}33'06''$ West, 120.07 feet;

North $81^{\circ}40'54''$ West, 182.42 feet;

Along the arc of a tangent curve to the right having a radius of 15.00 feet, central angle of $90^{\circ}00'00''$, arc length of 23.56 feet, and chord bearing and distance of North $36^{\circ}40'54''$ West, 21.21 feet;

North $08^{\circ}19'06''$ East, 5.00 feet;

Along the arc of a tangent curve to the right having a radius of 220.00 feet, central angle of $65^{\circ}00'00''$, arc length of 249.58 feet, and chord bearing and distance of North $40^{\circ}49'06''$ East, 236.41 feet;

North $73^{\circ}19'06''$ East, 18.42 feet;

South $59^{\circ}11'21''$ East, 205.22 feet;

North $75^{\circ}10'35''$ East, 160.00 feet;

South $66^{\circ}48'56''$ East, 122.30 feet;

Along the arc of a tangent curve to the left having a radius of 480.00 feet, central angle of $56^{\circ}36'25''$, arc length of 474.23 feet, and chord bearing and distance of North $84^{\circ}52'52''$ East, 455.17 feet;

North $45^{\circ}22'49''$ East, 186.42 feet;

Along the arc of a tangent curve to the left having a radius of 480.00 feet, central angle of $10^{\circ}51'52''$, arc length of 91.02 feet, and chord bearing and distance of North $28^{\circ}45'02''$ East, 90.88 feet;

North $23^{\circ}19'06''$ East, 100.00 feet;

Along the arc of a tangent curve to the right having a radius of 520.00 feet, central angle of $16^{\circ}12'35''$, arc length of 147.11 feet, and chord bearing and distance of North $31^{\circ}25'24''$ East, 146.63 feet;

South $54^{\circ}20'40''$ East, 55.29 feet;

North $35^{\circ}39'20''$ East, 75.00 feet;

North $54^{\circ}20'40''$ West, 44.72 feet;

Along the arc of a non-tangent curve to the left having a radius of 480.00 feet, central angle of $45^{\circ}28'26''$, arc length of 380.96 feet, and chord bearing and distance of North $26^{\circ}03'19''$ East, 371.04 feet;

Along the arc of a reverse curve to the right having a radius of 520.00 feet, central angle of $24^{\circ}40'56''$, arc length of 224.01 feet, and chord bearing and distance of North $15^{\circ}39'34''$ East, 222.28 feet;

Along the arc of a reverse curve to the left having a radius of 610.00 feet, central angle of $56^{\circ}02'16''$, arc length of 596.61 feet, and chord bearing and distance of North $00^{\circ}01'06''$ West, 573.11 feet;

North $28^{\circ}56'26''$ East, 245.31 feet;

North $26^{\circ}54'31''$ East, 195.00 feet;

Along the arc of a tangent curve to the right having a radius of 250.00 feet, central angle of $45^{\circ}13'25''$, arc length of 197.33 feet, and chord bearing and



distance of North 49°31'13" East, 192.24 feet;
North 72°07'56" East, 185.22 feet;
North 17°52'04" West, 759.81 feet;
South 57°07'56" West, 473.11 feet;
Along the arc of a tangent curve to the left having a radius of 400.00 feet,
central angle of 32°39'55", arc length of 228.05 feet, and chord bearing and
distance of South 36°22'56" West, 224.97 feet;
South 20°02'59" West, 59.39 feet;
South 23°38'38" East, 101.01 feet;
South 26°15'56" West, 190.53 feet;
Along the arc of a non-tangent curve to the left having a radius of 760.00
feet, central angle of 22°52'34", arc length of 303.44 feet, and chord bearing and
distance of South 28°33'06" West, 301.43 feet;
Along the arc of a tangent curve to the right having a radius of 240.00
feet, central angle of 12°43'07", arc length of 53.28 feet, and chord bearing and
distance of South 23°28'22" West, 53.17 feet;
South 33°37'29" West, 60.00 feet;
Along the arc of a non-tangent curve to the left having a radius of 450.00
feet, central angle of 28°24'51", arc length of 223.16 feet, and chord bearing and
distance of North 70°34'56" West, 220.88 feet;
South 32°55'35" West, 194.06 feet;
South 14°40'58" West, 107.86 feet;
South 44°30'42" West, 118.22 feet;

thence leaving said boundary of Adjusted Parcel 13, South 42°25'09" West,
76.38 feet;

thence South 03°13'19" East, 42.20 feet;
thence South 19°01'17" West, 50.13 feet;
thence South 46°39'54" West, 63.65 feet;
thence South 07°39'35" West, 112.15 feet;
thence South 34°38'02" West, 89.02 feet;
thence South 48°04'29" West, 77.05 feet;
thence South 17°18'10" West, 49.80 feet;
thence South 44°29'22" West, 31.27 feet;
thence South 80°50'26" West, 43.42 feet;
thence North 68°20'30" West, 77.86 feet;
thence South 62°03'47" West, 104.73 feet;
thence South 39°06'18" West, 58.79 feet;
thence South 12°25'57" East, 65.04 feet;
thence South 02°49'53" West, 39.01 feet;
thence South 07°21'14" West, 72.67 feet;

thence South 18°10'54" West, 71.77 feet;
 thence South 10°56'54" West, 138.28 feet;
 thence South 08°10'42" East, 73.66 feet;
 thence South 17°29'55" East, 63.65 feet;
 thence South 12°35'42" East, 40.89 feet;
 thence South 05°08'12" East, 41.64 feet;
 thence South 06°16'54" West, 44.27 feet;
 thence South 18°15'51" West, 42.66 feet;
 thence South 31°37'18" West, 25.17 feet;
 thence South 48°27'32" West, 22.08 feet;
 thence South 62°59'11" West, 88.26 feet;
 thence South 30°41'27" West, 64.24 feet;
 thence South 38°02'05" West, 54.31 feet;
 thence South 43°38'20" West, 89.05 feet;
 thence South 52°07'52" West, 96.77 feet;
 thence South 65°24'33" West, 72.88 feet to a point on the boundary of said

Adjusted Parcel 13;

thence along said boundary of Adjusted Parcel 13, the following courses:

Along the arc of a non-tangent curve to the right having a radius of 705.00 feet, central angle of 10°31'14", arc length of 129.45 feet, and chord bearing and distance of North 66°18'03" West, 129.27 feet;

North 61°02'26" West, 131.36 feet;

South 24°52'01" West, 75.19 feet;

North 65°39'24" West, 174.24 feet;

South 24°20'36" West, 162.52 feet;

South 65°39'24" East, 246.20 feet;

South 24°20'36" West, 75.82 feet;

South 51°56'07" West, 670.00 feet;

South 38°03'53" East, 121.52 feet;

South 51°55'58" West, 587.60 feet;

Along the arc of a tangent curve to the left having a radius of 1030.00 feet, central angle of 07°02'56", arc length of 126.72 feet, and chord bearing and distance of South 48°24'30" West, 126.64 feet;

South 44°53'02" West, 121.21 feet;

North 45°06'58" West, 135.24 feet;

South 51°15'37" West, 301.87 feet;

North 45°06'58" West, 21.93 feet;

Along the arc of a tangent curve to the left having a radius of 180.00 feet, central angle of 24°25'37", arc length of 76.74 feet, and chord bearing and

distance of North 57°19'47" West, 76.16 feet;

North 69°32'35" West, 193.91 feet;

North 20°27'25" East, 520.00 feet;

North 28°31'47" East, 339.01 feet;

North 45°07'09" West, 118.68 feet;

South 44°52'51" West, 166.69 feet;

Along the arc of a non-tangent curve to the left having a radius of 61.50 feet, central angle of 163°21'59", arc length of 175.35 feet, and chord bearing and distance of South 63°59'17" West, 121.71 feet;

Along the arc of a reverse curve to the right having a radius of 15.00 feet, central angle of 38°09'07", arc length of 9.99 feet, and chord bearing and distance of South 01°22'51" West, 9.80 feet;

South 20°27'25" West, 306.01 feet;

Along the arc of a tangent curve to the right having a radius of 120.00 feet, central angle of 60°00'00", arc length of 125.66 feet, and chord bearing and distance of South 50°27'25" West, 120.00 feet;

Along the arc of a reverse curve to the left having a radius of 80.00 feet, central angle of 75°39'31", arc length of 105.64 feet, and chord bearing and distance of South 42°37'39" West, 98.13 feet;

Along the arc of a reverse curve to the right having a radius of 120.00 feet, central angle of 41°24'35", arc length of 86.73 feet, and chord bearing and distance of South 25°30'11" West, 84.85 feet;

South 46°12'29" West, 22.61 feet;

Along the arc of a tangent curve to the right having a radius of 15.00 feet, central angle of 90°00'00", arc length of 23.56 feet, and chord bearing and distance of North 88°47'31" West, 21.21 feet;

North 43°47'31" West, 129.48 feet;

South 46°12'29" West, 60.00 feet;

South 43°47'31" East, 200.46 feet;

Along the arc of a tangent curve to the left having a radius of 180.00 feet, central angle of 25°45'04", arc length of 80.90 feet, and chord bearing and distance of South 56°40'03" East, 80.22 feet;

South 69°32'35" East, 174.89 feet;

Along the arc of a tangent curve to the right having a radius of 25.00 feet, central angle of 89°03'51", arc length of 38.86 feet, and chord bearing and distance of South 25°00'40" East, 35.07 feet;

South 19°31'16" West, 135.80 feet;

South 76°39'18" West, 281.81 feet;

North 58°47'44" West, 370.94 feet;

North 43°54'17" West, 170.09 feet;

North 45°59'09" West, 257.68 feet to a point on the easterly line of Jacks



Valley Road;

Along said easterly line of Jacks Valley Road, North $21^{\circ}17'11''$ East, 3383.63 feet;

Continuing along said easterly line of Jacks Valley Road, along the arc of a tangent curve to the left having a radius of 2630.00 feet, central angle of $09^{\circ}12'33''$, arc length of 422.72 feet, and chord bearing and distance of North $16^{\circ}40'55''$ East, 422.27 feet;

South $36^{\circ}57'04''$ East, 559.28 feet;

South $33^{\circ}56'22''$ East, 896.96 feet;

North $83^{\circ}57'55''$ East, 46.80 feet;

North $14^{\circ}27'34''$ East, 175.84 feet;

North $30^{\circ}30'18''$ East, 128.95 feet;

North $47^{\circ}52'54''$ East, 112.46 feet;

North $63^{\circ}21'49''$ East, 85.24 feet;

North $80^{\circ}15'10''$ East, 87.19 feet;

South $66^{\circ}58'22''$ East, 73.31 feet;

Along the arc of a non-tangent curve to the right having a radius of 250.00 feet, central angle of $66^{\circ}43'24''$, arc length of 291.14 feet, and chord bearing and distance of South $41^{\circ}29'30''$ East, 274.96 feet;

South $08^{\circ}07'48''$ East, 601.77 feet;

South $78^{\circ}07'48''$ East, 68.40 feet;

North $31^{\circ}52'12''$ East, 303.36 feet;

thence leaving said boundary of Adjusted Parcel 13 along the arc of a tangent curve to the left having a radius of 61.50 feet, central angle of $100^{\circ}28'05''$, arc length of 107.84 feet, and chord bearing and distance of North $18^{\circ}21'51''$ West, 94.55 feet;

North $14^{\circ}54'09''$ East, 135.87 feet;

North $48^{\circ}28'01''$ East, 129.67 feet;

South $85^{\circ}33'15''$ East, 136.39 feet;

North $77^{\circ}50'28''$ East, 158.26 feet to a point on said boundary of Adjusted Parcel 13;

thence along said boundary of Adjusted Parcel 13, the following courses:

North $32^{\circ}22'17''$ East, 79.96 feet;

North $45^{\circ}00'16''$ East, 68.09 feet;

North $57^{\circ}21'00''$ East, 77.47 feet;

North $62^{\circ}20'56''$ East, 128.14 feet;

EAST, 78.31 feet;

North $41^{\circ}30'06''$ East, 46.05 feet;

North $85^{\circ}29'04''$ East, 31.47 feet;



South 45°51'46" East, 47.88 feet;
North 32°55'35" East, 260.59 feet;

thence leaving said boundary of Adjusted Parcel 13 and continuing North 32°55'35" East, 30.99 feet to a point on said boundary of Adjusted Parcel 13;

thence along said boundary of Adjusted Parcel 13, the following courses:

North 15°11'12" West, 240.72 feet;
North 09°02'13" East, 221.05 feet;
North 20°35'43" East, 511.70 feet;
North 09°12'15" East, 37.66 feet;
North 02°24'49" East, 126.19 feet;

Along the arc of a tangent curve to the left having a radius of 555.00 feet, central angle of 44°30'58", arc length of 431.21 feet, and chord bearing and distance of North 18°07'24" West, 420.44 feet to a point on the north line of said Northeast one-quarter of Section 26;

Along said north line, North 89°23'01" East, 1363.99 feet to the POINT OF BEGINNING, (containing 243.71 acres, more or less).

EXCEPTING THEREFROM the following parcel of land (known as Adjusted Parcel 14):

All that real property situate in the County of Douglas, State of Nevada, described as follows:

A parcel of land located within a portion of Section 26, Township 14 North, Range 19 East, Mount Diablo Meridian, more particularly described as follows:

Commencing at the southwesterly corner of Adjusted Parcel 13 as shown on the Record of Survey to Support a Boundary Line Adjustment for Genoa Land Investors, LLC, Genoa Developer Associates, LLC, MDA Enterprises, Inc. and Incomparable Holding Co. et al recorded June 30, 2005 in the office of Recorder, Douglas County, Nevada as Document No. 648319, a point on the easterly right-of-way of Jacks Valley Road;

thence along said easterly right-of-way of Jacks Valley Road, North 21°17'11" East, 2092.29 feet to a point on the southerly line of a 50-foot non-exclusive private access easement as recorded December 31, 1996 in said office of Recorder in Book 1296, at Page 4911, as Document No. 403934;

thence along said southerly line of private access easement, South 57°24'21" East, 385.07 feet to a point on the boundary of Adjusted Parcel 14 as shown on said Record of Survey, Document No. 648319, the POINT OF BEGINNING:

thence along the boundary of said Adjusted Parcel 14, the following courses:

North 26°23'05" East, 1033.27 feet;
North 83°19'32" East, 94.64 feet;
South 28°22'32" East, 311.42 feet;
South 17°15'57" East, 774.92 feet;
South 37°01'19" East, 167.99 feet;
South 24°23'07" West, 315.15 feet;
South 65°36'53" East, 165.00 feet;
South 24°23'07" West, 45.00 feet;
South 65°36'53" East, 205.00 feet;
South 24°23'07" West, 305.56 feet;
North 57°20'21" West, 585.93 feet;
North 59°14'14" West, 87.21 feet;

Along the arc of a tangent curve to the right having a radius of 125.00 feet, central angle of 21°57'15", arc length of 47.90 feet, and chord bearing and distance of North 48°15'37" West, 47.60 feet;

South 68°02'52" West, 733.74 feet;
North 61°20'53" West, 110.54 feet;
North 23°52'20" East, 837.66 feet;
North 57°24'21" West, 61.94 feet to the POINT OF BEGINNING, (containing

30.48, acres, more or less).

ADJUSTED PARCEL 13 CONTAINING 213.23 acres, more or less.

The Basis of Bearing of this description is North 89°23'01" East, the north line of the Northeast one-quarter of Section 26, T.14N., R.19E., M.D.M. as shown on the Record of Survey to Support a Boundary Line Adjustment for Genoa Land Investors, LLC, Genoa Developer Associates, LLC, MDA Enterprises, Inc. and Incomparable Holding Co. et al recorded June 30, 2005 in the office of Recorder, Douglas County, Nevada as Document No. 648319.

Note: Refer this description to your title company before incorporating into any legal document.

Prepared By: R.O. ANDERSON ENGINEERING, INC.
P.O. Box 2229
Minden, Nevada 89423

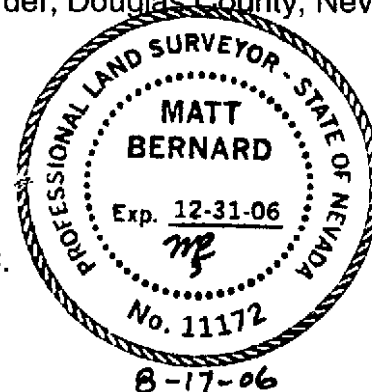

S:\Projects\1163-021\Legal descriptions\1163-021Adj Par 13.leg.doc

**DESCRIPTION
ADJUSTED REMAINDER PARCEL 1
(Adjusted APN 1419-26-001-016)**

All that real property situate in the County of Douglas, State of Nevada, described as follows:

A parcel of land located within a portion of Section 26, Township 14 North, Range 19 East, Mount Diablo Meridian, more particularly described as follows:

Commencing at the northeast corner of Section 26, T.14N., R.19E., M.D.M., a found 1985 BLM aluminum cap;

thence South 37°59'07" West, 691.34 feet to the northeasterly corner of Adjusted Remainder Parcel 1 as shown on the Record of Survey to Support a Boundary Line Adjustment for Genoa Land Investors, LLC, Genoa Developer Associates, LLC, MDA Enterprises, Inc., and Incomparable Holding Company, LLC et al, recorded June 30, 2005 in the office of Recorder, Douglas County, Nevada as Document No. 648319, the POINT OF BEGINNING;

thence along the boundary of said Adjusted Remainder Parcel 1, the following courses:

South 17°52'04" East, 759.81 feet;

South 72°07'56" West, 185.22 feet;

Along the arc of a tangent curve to the left having a radius of 250.00 feet, central angle of 45°13'25", arc length of 197.33 feet, and chord bearing and distance of South 49°31'13" West, 192.24 feet;

South 26°54'31" West, 195.00 feet;

South 28°56'26" West, 245.31 feet;

Along the arc of a non-tangent curve to the right having a radius of 610.00 feet, central angle of 56°02'16", arc length of 596.61 feet, and chord bearing and distance of South 00°01'06" East, 573.11 feet;

Along the arc of a reverse curve to the left having a radius of 520.00 feet, central angle of 24°40'56", arc length of 224.01 feet, and chord bearing and distance of South 15°39'34" West, 222.28 feet;

Along the arc of a reverse curve to the right having a radius of 480.00 feet, central angle of 45°28'26", arc length of 380.96 feet, and chord bearing and distance of South 26°03'19" West, 371.04 feet;

South 54°20'40" East, 44.72 feet;

South 35°39'20" West, 75.00 feet;

North 54°20'40" West, 55.29 feet;



Along the arc of a non-tangent curve to the left having a radius of 520.00 feet, central angle of $16^{\circ}12'35''$, arc length of 147.11 feet, and chord bearing and distance of South $31^{\circ}25'24''$ West, 146.63 feet;

South $23^{\circ}19'06''$ West, 100.00 feet;

Along the arc of a tangent curve to the right having a radius of 480.00 feet, central angle of $10^{\circ}51'52''$, arc length of 91.02 feet, and chord bearing and distance of South $28^{\circ}45'02''$ West, 90.88 feet;

South $45^{\circ}22'49''$ West, 186.42 feet;

Along the arc of a non-tangent curve to the right having a radius of 480.00 feet, central angle of $56^{\circ}36'25''$, arc length of 474.23 feet, and chord bearing and distance of South $84^{\circ}52'52''$ West, 455.17 feet;

North $66^{\circ}48'56''$ West, 122.30 feet;

South $75^{\circ}10'35''$ West, 160.00 feet;

North $59^{\circ}11'21''$ West, 205.22 feet;

South $73^{\circ}19'06''$ West, 18.42 feet;

Along the arc of a tangent curve to the left having a radius of 220.00 feet, central angle of $65^{\circ}00'00''$, arc length of 249.58 feet, and chord bearing and distance of South $40^{\circ}49'06''$ West, 236.41 feet;

South $08^{\circ}19'06''$ West, 5.00 feet to a point on the northeasterly terminus of Cloudburst Canyon Drive as shown on the Final Subdivision Map for Canyon Creek Meadows, Phase 1 recorded February 11, 2004 in said office of Recorder as Document No. 604356;

thence along said northerly terminus of Cloudburst Canyon Drive, North $81^{\circ}40'54''$ West, 60.00 feet;

thence along the northerly line of Common Area 3 as shown on said Final Subdivision Map for Canyon Creek Meadows, Phase 1, North $81^{\circ}35'49''$ West, 15.00 feet;

thence continuing along said northerly line of Common Area 3, along the arc of a tangent curve to the right having a radius of 705.00 feet, central angle of $10^{\circ}34'32''$, arc length of 130.13 feet, and chord bearing and distance of North $76^{\circ}50'56''$ West, 129.94 feet;

thence North $65^{\circ}24'33''$ East, 72.88 feet;

thence North $52^{\circ}07'52''$ East, 96.77 feet;

thence North $43^{\circ}38'20''$ East, 89.05 feet;

thence North $38^{\circ}02'05''$ East, 54.31 feet;

thence North $30^{\circ}41'27''$ East, 64.24 feet;

thence North $62^{\circ}59'11''$ East, 88.26 feet;

thence North $48^{\circ}27'32''$ East, 22.08 feet;

thence North $31^{\circ}37'18''$ East, 25.17 feet;

thence North 18°15'51" East, 42.66 feet;
thence North 06°16'54" East, 44.27 feet;
thence North 05°08'12" West, 41.64 feet;
thence North 12°35'42" West, 40.89 feet;
thence North 17°29'55" West, 63.65 feet;
thence North 08°10'42" West, 73.66 feet;
thence North 10°56'54" East, 138.28 feet;
thence North 18°10'54" East, 71.77 feet;
thence North 07°21'14" East, 72.67 feet;
thence North 02°49'53" East, 39.01 feet;
thence North 12°25'57" West, 65.04 feet;
thence North 39°06'18" East, 58.79 feet;
thence North 62°03'47" East, 104.73 feet;
thence South 68°20'30" East, 77.86 feet;
thence North 80°50'26" East, 43.42 feet;
thence North 44°29'22" East, 31.27 feet;
thence North 17°18'10" East, 49.80 feet;
thence North 48°04'29" East, 77.05 feet;
thence North 34°38'02" East, 89.02 feet;
thence North 07°39'35" East, 112.15 feet;
thence North 46°39'54" East, 63.65 feet;
thence North 19°01'17" East, 50.13 feet;
thence North 03°13'19" West, 42.20 feet;
thence North 42°25'09" East, 76.38 feet;

thence continuing along the boundary of said Adjusted Remainder Parcel 1, the following courses:

North 44°30'42" East, 118.22 feet;

North 14°40'58" East, 107.86 feet;

North 32°55'35" East, 194.06 feet;

Along the arc of a non-tangent curve to the right having a radius of 450.00 feet, central angle of 28°24'51", arc length of 223.16 feet, and chord bearing and distance of South 70°34'56" East, 220.88 feet;

North 33°37'29" East, 60.00 feet;

Along the arc of a tangent curve to the left having a radius of 240.00 feet, central angle of 12°43'07", arc length of 53.28 feet, and chord bearing and distance of North 23°28'22" East, 53.17 feet;

Along the arc of a reverse curve to the right having a radius of 760.00 feet, central angle of 22°52'34", arc length of 303.44 feet, and chord bearing and distance of North 28°33'06" East, 301.43 feet;

North 26°15'56" East, 190.53 feet;
North 23°38'38" West, 101.01 feet;
North 20°02'59" East, 59.39 feet;
Along the arc of a tangent curve to the right having a radius of 400.00 feet, central angle of 32°39'55", arc length of 228.05 feet, and chord bearing and distance of North 36°22'56" East, 224.97 feet;
North 57°07'56" East, 473.11 feet to the POINT OF BEGINNING,
containing 62.38 acres, more or less.

The Basis of Bearing of this description is North 89°23'01" East, the north line of the Northeast one-quarter of Section 26, T.14N., R.19E., M.D.M. as shown on the Final Subdivision Map for Canyon Creek Meadows, Phase 1, recorded February 11, 2004 in the office of Recorder, Douglas County, Nevada as Document No. 604356.

Note: Refer this description to your title company before incorporating into any legal document.

Prepared By: R.O. ANDERSON ENGINEERING, INC.
P.O. Box 2229
Minden, Nevada 89423

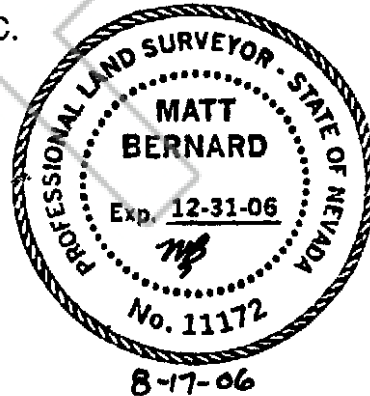
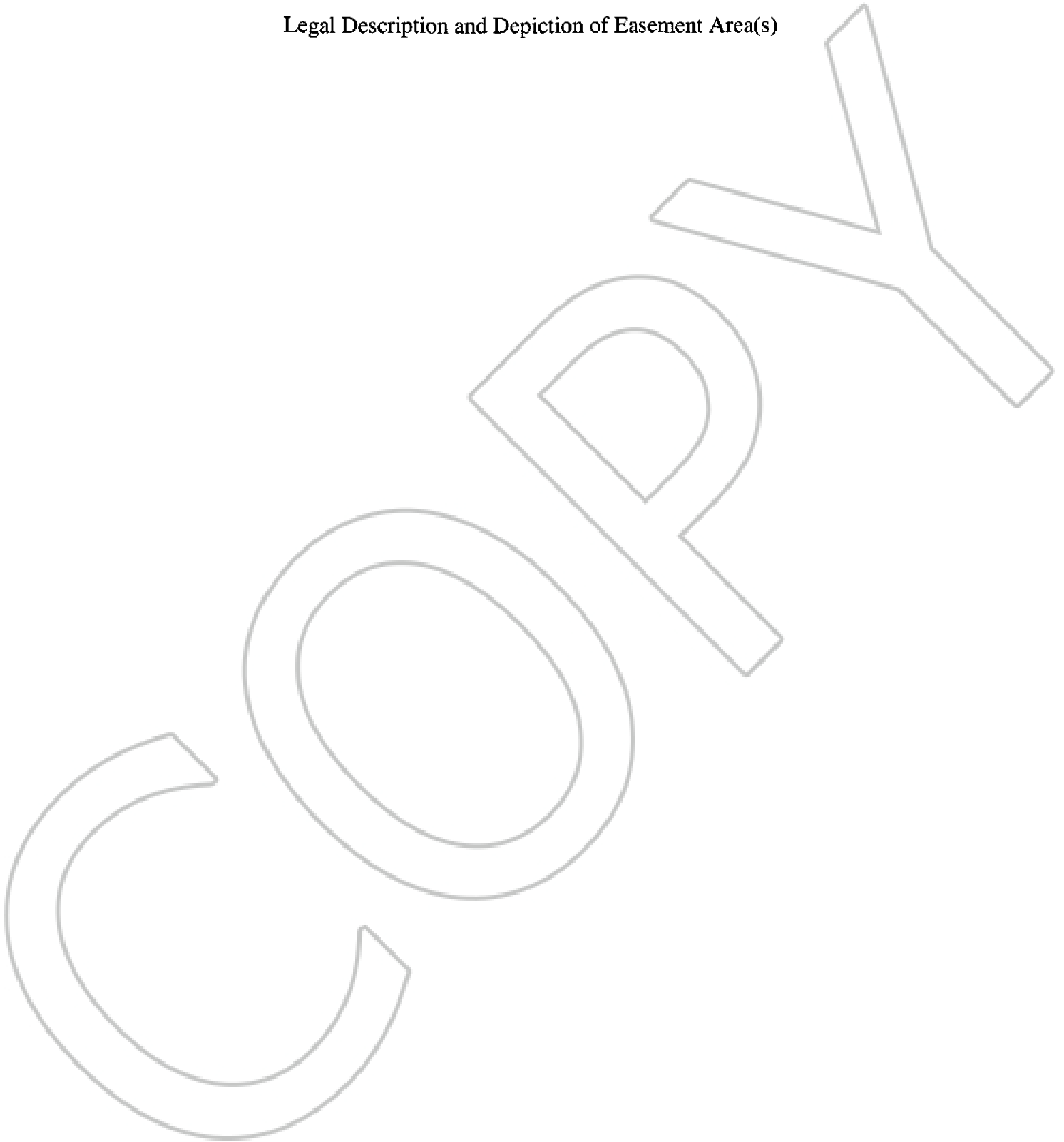

EXHIBIT B

Legal Description and Depiction of Easement Area(s)



DESCRIPTION
SLOPE AND PRIVATE STORM DRAINAGE EASEMENTS
(APN 1419-26-001-019 Parcel 13)

All that real property situate in the County of Douglas, State of Nevada, described as follows:

A twenty-five-foot wide (25') strip of land for slope and private storm drainage purposes located within a portion of Section 26, Township 14 North, Range 19 East, Mount Diablo Meridian, more particularly described as follows:

Commencing at the most northeasterly angle point in the boundary of Adjusted Remainder Parcel 1 as shown on the Record of Survey to Support a Boundary Line Adjustment for Genoa Land Investors, LLC, MDA Enterprises, Inc. and Four Creeks Visalia, L.P. recorded June 12, 2007 in the office of Recorder, Douglas County, Nevada as Document No. 702844 from which the northeast corner of Section 26, T.14N., R.19E., M.D.M. bears North 37°59'07" East, 691.34 feet, the POINT OF BEGINNING;

thence along the northwesterly boundary of said Adjusted Remainder Parcel 1, the following three courses:

South 57°07'56" West, 473.11 feet;

Along the arc of a non-tangent curve to the left having a radius of 400.00 feet, central angle of 32°39'55", arc length of 228.05 feet, and chord bearing and distance of South 36°22'56" West, 224.97 feet;

South 20°02'59" West, 63.30 feet, more or less, to a point on the easterly line of a private drainage easement and restricted use area as shown on the Final Subdivision Map for Canyon Creek Meadows, Phase 1, recorded February 11, 2004 in said office of Recorder as Document No. 604356;

thence along said easterly line of a private drainage easement and restricted use area, North 28°19'57" West, 33.44 feet, more or less;

thence along a line 25-foot northwesterly of and parallel with said northwesterly boundary of Adjusted Remainder Parcel 1, the following three courses:

North 20°02'59" East, 41.09 feet;

Along the arc of a curve to the right having a radius of 425.00 feet, central angle of 32°47'50", arc length of 243.28 feet, and chord bearing and distance of North 36°26'54" East, 239.97 feet;

North 57°07'56" East, 480.75 feet;



thence South 17°52'04" East, 25.88 feet to the POINT OF BEGINNING,
containing 19,120 square feet, more or less.

TOGETHER WITH a strip of land for slope and private storm drainage purposes
located within a portion of Section 26, Township 14 North, Range 19 East, Mount
Diablo Meridian, more particularly described as follows:

Commencing at the most northeasterly angle point in the boundary of Adjusted
Remainder Parcel 1 as shown on the Record of Survey to Support a Boundary Line
Adjustment for Genoa Land Investors, LLC, MDA Enterprises, Inc. and Four Creeks
Visalia, L.P. recorded June 12, 2007 in the office of Recorder, Douglas County, Nevada
as Document No. 702844 from which the northeast corner of Section 26, T.14N.,
R.19E., M.D.M. bears North 37°59'07" East, 691.34 feet;

thence along the northwesterly boundary of said Adjusted Remainder Parcel 1,
the following five courses:

South 57°07'56" West, 473.11 feet;

Along the arc of a non-tangent curve to the left having a radius of 400.00
feet, central angle of 32°39'55", arc length of 228.05 feet, and chord bearing and
distance of South 36°22'56" West, 224.97 feet;

South 20°02'59" West, 59.39 feet;

South 23°38'38" East, 101.01 feet;

South 26°15'56" West, 190.53 feet to the POINT OF BEGINNING;

thence continuing along said northwesterly boundary of Adjusted Remainder
Parcel 1, the following two courses:

Along the arc of a non-tangent curve to the left having a radius of 760.00
feet, central angle of 22°52'34", arc length of 303.44 feet, and chord bearing and
distance of South 28°33'06" West, 301.43 feet;

Along the arc of a reverse curve having a radius of 240.00 feet, central
angle of 12°43'07", arc length of 53.28 feet, and chord bearing and distance of
South 23°28'22" West, 53.17 feet;

thence along the arc of a non-tangent curve to the left having a radius of 510.00



feet, central angle of 27°24'55", arc length of 244.03 feet, and chord bearing and distance of North 70°04'59" West, 241.71 feet to a common angle point on the easterly boundary of Adjusted Parcels 16 and 17 as shown on said Record of Survey;

thence along said easterly boundary of said Adjusted Parcel 17, North 32°55'35" East, 22.28 feet;

thence along the arc of a non-tangent curve to the right having a radius of 530.00 feet, central angle of 23°22'20", arc length of 216.20 feet, and chord bearing and distance of South 71°01'17" East, 214.70 feet;

thence along the arc of a curve to the left lying 25-feet northwesterly of and parallel with said northwesterly line of Adjusted Remainder Parcel 1, having a radius of 215.00 feet, central angle of 07°05'49", arc length of 26.63 feet, and chord bearing and distance of North 20°39'44" East, 26.62 feet;

thence along the arc of a reverse curve lying 25-feet northwesterly of and parallel with said northwesterly line of Adjusted Remainder Parcel 1, having a radius of 785.00 feet, central angle of 23°20'57", arc length of 319.90 feet, and chord bearing and distance of North 28°47'17" East, 317.70 feet;

thence South 35°27'34" East, 25.80 feet to the POINT OF BEGINNING, containing 13,394 square feet, more or less.

TOGETHER WITH a strip of land for slope and private storm drainage purposes located within a portion of Section 26, Township 14 North, Range 19 East, Mount Diablo Meridian, more particularly described as follows:

Commencing at the most northeasterly angle point in the boundary of Adjusted Remainder Parcel 1 as shown on the Record of Survey to Support a Boundary Line Adjustment for Genoa Land Investors, LLC, MDA Enterprises, Inc. and Four Creeks Visalia, L.P. recorded June 12, 2007 in the office of Recorder, Douglas County, Nevada as Document No. 702844 from which the northeast corner of Section 26, T.14N., R.19E., M.D.M. bears North 37°59'07" East, 691.34 feet;

thence along the northwesterly boundary of said Adjusted Remainder Parcel 1, the following nine courses:

South 57°07'56" West, 473.11 feet;

Along the arc of a non-tangent curve to the left having a radius of 400.00 feet, central angle of 32°39'55", arc length of 228.05 feet, and chord bearing and distance of South 36°22'56" West, 224.97 feet;



South 20°02'59" West, 59.39 feet;
South 23°38'38" East, 101.01 feet;
South 26°15'56" West, 190.53 feet;

Along the arc of a non-tangent curve to the left having a radius of 760.00 feet, central angle of 22°52'34", arc length of 303.44 feet, and chord bearing and distance of South 28°33'06" West, 301.43 feet;

Along the arc of a reverse curve having a radius of 240.00 feet, central angle of 12°43'07", arc length of 53.28 feet, and chord bearing and distance of South 23°28'22" West, 53.17 feet;

South 33°37'29" West, 60.00 feet;

Along the arc of a non-tangent curve to the left having a radius of 450.00 feet, central angle of 28°24'51", arc length of 223.16 feet, and chord bearing and distance of North 73°26'30" West, 177.09 feet to an angle point in said northwesterly boundary of Adjusted Remainder Parcel 1, the POINT OF BEGINNING;

thence continuing along said northwesterly boundary of Adjusted Remainder Parcel 1, the following three courses:

South 32°55'35" West, 194.06 feet;
South 14°40'58" West, 107.86 feet;
South 44°30'42" West, 85.77 feet;

thence North 88°48'16" West, 46.91 feet;
thence North 01°11'44" East, 30.00 feet;
thence South 88°48'16" East, 47.71 feet;
thence North 44°30'42" East, 58.07 feet;
thence North 14°40'58" East, 79.59 feet;
thence North 09°16'28" East, 20.41 feet to a common angle point in the boundary of Adjusted Parcel 13 and 16 as shown on said Record of Survey;
thence along the easterly boundary of said Adjusted Parcel 16, North 32°55'35" East, 192.25 feet;

thence along the arc of a non-tangent curve to the right having a radius of 450.00 feet, central angle of 02°55'00", arc length of 22.91 feet, and chord bearing and distance of South 86°14'52" East, 22.91 feet to the POINT OF BEGINNING, containing 8,823 square feet, more or less.



The Basis of Bearing of this description is North 89°23'01" East, the north line of the Northeast one-quarter of Section 26, T.14N., R.19E., M.D.M. as shown on the Record of Survey to Support a Boundary Line Adjustment for Genoa Land Investors, LLC, Genoa Developer Associates, LLC, MDA Enterprises, Inc. and Incomparable Holding Co. et al recorded June 30, 2005 in the office of Recorder, Douglas County, Nevada as Document No. 648319.

Note: Refer this description to your title company before incorporating into any legal document.

Prepared By: R.O. ANDERSON ENGINEERING, INC.
P.O. Box 2229
Minden, Nevada 89423

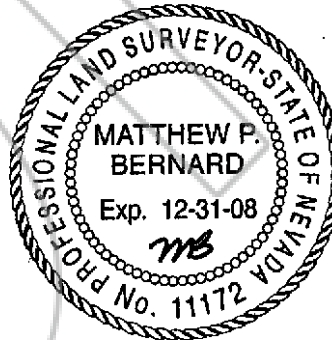

6-26-07

SCALE: 1" = 200'

ADJUSTED PARCEL 13
 1419-26-001-019
 MDA ENTERPRISES, INC.
 213.23 ACRES

ADJUSTED PARCEL 17
 1419-26-001-017
 FOUR CREEKS
 VISALIA, L.P.
 77.67 ACRES

ADJUSTED REMAINDER PARCEL 1
 1419-26-001-020
 FOUR CREEKS VISALIA, L.P.
 62.38 ACRES

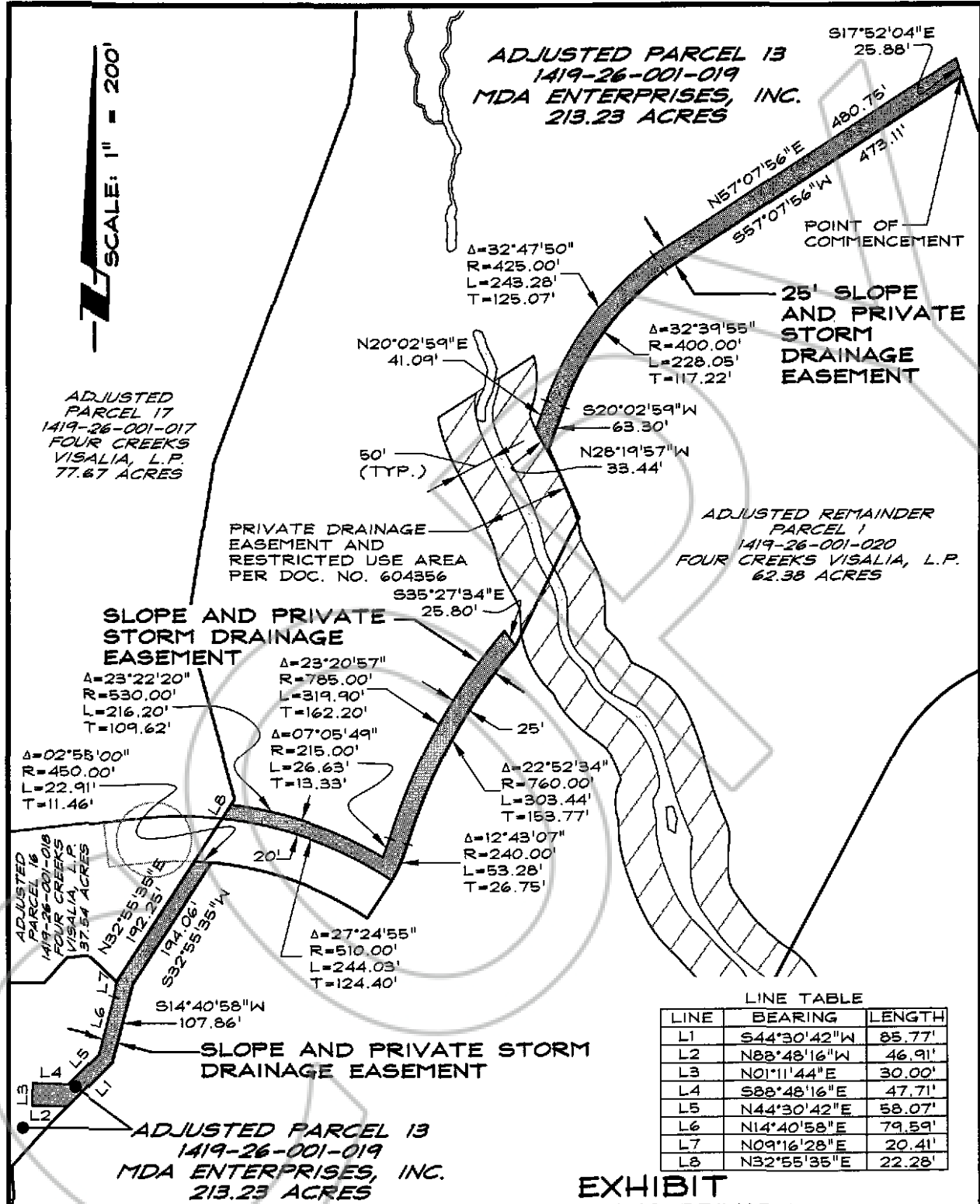

LINE TABLE

LINE	BEARING	LENGTH
L1	S44°30'42"W	85.77'
L2	N88°48'16"W	46.91'
L3	N01°11'44"E	30.00'
L4	S88°48'16"E	47.71'
L5	N44°30'42"E	58.07'
L6	N14°40'58"E	79.59'
L7	N09°16'28"E	20.41'
L8	N32°55'35"E	22.28'

EXHIBIT
 SLOPE AND PRIVATE
 STORM DRAINAGE EASEMENTS
 (Over Parcel 13, A.P.N. 1419-26-001-019)
 SECTION 26, T.14N., R.19E., M.D.M.

RO Anderson
 1603 ESMEERALDA AVENUE / POST OFFICE BOX 2229
 MINDEN, NEVADA 89423
 PHONE: (775) 782-2322 / FAX: (775) 782-7084
 WEB SITE: WWW.ROANDERSON.COM

REVISED 06/25/07
 08/24/06
 SHT 1 OF 1
 1308-002EXH-SLOPE-PRIV DRAIN-Par 13.dwg

EXHIBIT C

Legal Description of Benefited Property
Adjusted Parcel 13, Adjusted Parcel 16 and Adjusted Parcel 17



**DESCRIPTION
ADJUSTED PARCEL 13
(Adjusted APN 1419-26-001-015)**

All that real property situate in the County of Douglas, State of Nevada, described as follows:

A parcel of land located within portions of Section 26 and 27, Township 14 North, Range 19 East, Mount Diablo Meridian, more particularly described as follows:

Commencing at the northeast corner of Section 26, T.14N., R.19E., M.D.M., a found 1985 BLM aluminum cap, the POINT OF BEGINNING;

thence along the east line of the Northeast one-quarter of said Section 26, South 00°04'53" East, 2649.58 feet to the east one-quarter corner of said Section 26, a found 1985 BLM aluminum cap;

thence along the east line of the Southeast one-quarter of said Section 26, South 00°17'12" East, 238.23 feet;

thence WEST, 280.50 feet;

thence South 16°28'39" West, 455.86 feet;

thence South 48°32'24" West, 727.00 feet;

thence South 79°10'05" West, 171.38 feet;

thence South 65°39'14" West, 100.28 feet;

thence South 23°25'42" West, 143.74 feet;

thence North 66°34'18" West, 203.42 feet;

thence North 37°09'27" West, 169.17 feet;

thence WEST, 177.25 feet;

thence North 51°25'17" West, 137.89 feet;

thence South 38°34'43" West, 40.00 feet to a point on the boundary of Adjusted Parcel 13 as shown on the Record of Survey to Support a Boundary Line Adjustment for Genoa Land Investors, LLC, Genoa Developer Associates, LLC, MDA Enterprises, Inc. and Incomparable Holding Co. et al recorded June 30, 2005 in the office of Recorder, Douglas County, Nevada as Document No. 648319;

thence along said boundary of Adjusted Parcel 13, the following courses:

South 38°34'43" West, 32.08 feet;

Along the arc of a tangent curve to the right having a radius of 15.00 feet, central angle of 90°00'00", arc length of 23.56 feet, and chord bearing and distance of South 83°34'43" West, 21.21 feet;

North 51°25'17" West, 190.93 feet;

Along the arc of a tangent curve to the left having a radius of 230.00 feet,

central angle of $30^{\circ}15'37''$, arc length of 121.47 feet, and chord bearing and distance of North $66^{\circ}33'06''$ West, 120.07 feet;

North $81^{\circ}40'54''$ West, 182.42 feet;

Along the arc of a tangent curve to the right having a radius of 15.00 feet, central angle of $90^{\circ}00'00''$, arc length of 23.56 feet, and chord bearing and distance of North $36^{\circ}40'54''$ West, 21.21 feet;

North $08^{\circ}19'06''$ East, 5.00 feet;

Along the arc of a tangent curve to the right having a radius of 220.00 feet, central angle of $65^{\circ}00'00''$, arc length of 249.58 feet, and chord bearing and distance of North $40^{\circ}49'06''$ East, 236.41 feet;

North $73^{\circ}19'06''$ East, 18.42 feet;

South $59^{\circ}11'21''$ East, 205.22 feet;

North $75^{\circ}10'35''$ East, 160.00 feet;

South $66^{\circ}48'56''$ East, 122.30 feet;

Along the arc of a tangent curve to the left having a radius of 480.00 feet, central angle of $56^{\circ}36'25''$, arc length of 474.23 feet, and chord bearing and distance of North $84^{\circ}52'52''$ East, 455.17 feet;

North $45^{\circ}22'49''$ East, 186.42 feet;

Along the arc of a tangent curve to the left having a radius of 480.00 feet, central angle of $10^{\circ}51'52''$, arc length of 91.02 feet, and chord bearing and distance of North $28^{\circ}45'02''$ East, 90.88 feet;

North $23^{\circ}19'06''$ East, 100.00 feet;

Along the arc of a tangent curve to the right having a radius of 520.00 feet, central angle of $16^{\circ}12'35''$, arc length of 147.11 feet, and chord bearing and distance of North $31^{\circ}25'24''$ East, 146.63 feet;

South $54^{\circ}20'40''$ East, 55.29 feet;

North $35^{\circ}39'20''$ East, 75.00 feet;

North $54^{\circ}20'40''$ West, 44.72 feet;

Along the arc of a non-tangent curve to the left having a radius of 480.00 feet, central angle of $45^{\circ}28'26''$, arc length of 380.96 feet, and chord bearing and distance of North $26^{\circ}03'19''$ East, 371.04 feet;

Along the arc of a reverse curve to the right having a radius of 520.00 feet, central angle of $24^{\circ}40'56''$, arc length of 224.01 feet, and chord bearing and distance of North $15^{\circ}39'34''$ East, 222.28 feet;

Along the arc of a reverse curve to the left having a radius of 610.00 feet, central angle of $56^{\circ}02'16''$, arc length of 596.61 feet, and chord bearing and distance of North $00^{\circ}01'06''$ West, 573.11 feet;

North $28^{\circ}56'26''$ East, 245.31 feet;

North $26^{\circ}54'31''$ East, 195.00 feet;

Along the arc of a tangent curve to the right having a radius of 250.00 feet, central angle of $45^{\circ}13'25''$, arc length of 197.33 feet, and chord bearing and



distance of North 49°31'13" East, 192.24 feet;

North 72°07'56" East, 185.22 feet;

North 17°52'04" West, 759.81 feet;

South 57°07'56" West, 473.11 feet;

Along the arc of a tangent curve to the left having a radius of 400.00 feet, central angle of 32°39'55", arc length of 228.05 feet, and chord bearing and distance of South 36°22'56" West, 224.97 feet;

South 20°02'59" West, 59.39 feet;

South 23°38'38" East, 101.01 feet;

South 26°15'56" West, 190.53 feet;

Along the arc of a non-tangent curve to the left having a radius of 760.00 feet, central angle of 22°52'34", arc length of 303.44 feet, and chord bearing and distance of South 28°33'06" West, 301.43 feet;

Along the arc of a tangent curve to the right having a radius of 240.00 feet, central angle of 12°43'07", arc length of 53.28 feet, and chord bearing and distance of South 23°28'22" West, 53.17 feet;

South 33°37'29" West, 60.00 feet;

Along the arc of a non-tangent curve to the left having a radius of 450.00 feet, central angle of 28°24'51", arc length of 223.16 feet, and chord bearing and distance of North 70°34'56" West, 220.88 feet;

South 32°55'35" West, 194.06 feet;

South 14°40'58" West, 107.86 feet;

South 44°30'42" West, 118.22 feet;

thence leaving said boundary of Adjusted Parcel 13, South 42°25'09" West, 76.38 feet;

thence South 03°13'19" East, 42.20 feet;

thence South 19°01'17" West, 50.13 feet;

thence South 46°39'54" West, 63.65 feet;

thence South 07°39'35" West, 112.15 feet;

thence South 34°38'02" West, 89.02 feet;

thence South 48°04'29" West, 77.05 feet;

thence South 17°18'10" West, 49.80 feet;

thence South 44°29'22" West, 31.27 feet;

thence South 80°50'26" West, 43.42 feet;

thence North 68°20'30" West, 77.86 feet;

thence South 62°03'47" West, 104.73 feet;

thence South 39°06'18" West, 58.79 feet;

thence South 12°25'57" East, 65.04 feet;

thence South 02°49'53" West, 39.01 feet;

thence South 07°21'14" West, 72.67 feet;



thence South 18°10'54" West, 71.77 feet;
thence South 10°56'54" West, 138.28 feet;
thence South 08°10'42" East, 73.66 feet;
thence South 17°29'55" East, 63.65 feet;
thence South 12°35'42" East, 40.89 feet;
thence South 05°08'12" East, 41.64 feet;
thence South 06°16'54" West, 44.27 feet;
thence South 18°15'51" West, 42.66 feet;
thence South 31°37'18" West, 25.17 feet;
thence South 48°27'32" West, 22.08 feet;
thence South 62°59'11" West, 88.26 feet;
thence South 30°41'27" West, 64.24 feet;
thence South 38°02'05" West, 54.31 feet;
thence South 43°38'20" West, 89.05 feet;
thence South 52°07'52" West, 96.77 feet;
thence South 65°24'33" West, 72.88 feet to a point on the boundary of said
Adjusted Parcel 13;

thence along said boundary of Adjusted Parcel 13, the following courses:

Along the arc of a non-tangent curve to the right having a radius of 705.00 feet, central angle of 10°31'14", arc length of 129.45 feet, and chord bearing and distance of North 66°18'03" West, 129.27 feet;

North 61°02'26" West, 131.36 feet;
South 24°52'01" West, 75.19 feet;
North 65°39'24" West, 174.24 feet;
South 24°20'36" West, 162.52 feet;
South 65°39'24" East, 246.20 feet;
South 24°20'36" West, 75.82 feet;
South 51°56'07" West, 670.00 feet;
South 38°03'53" East, 121.52 feet;
South 51°55'58" West, 587.60 feet;

Along the arc of a tangent curve to the left having a radius of 1030.00 feet, central angle of 07°02'56", arc length of 126.72 feet, and chord bearing and distance of South 48°24'30" West, 126.64 feet;

South 44°53'02" West, 121.21 feet;
North 45°06'58" West, 135.24 feet;
South 51°15'37" West, 301.87 feet;
North 45°06'58" West, 21.93 feet;

Along the arc of a tangent curve to the left having a radius of 180.00 feet, central angle of 24°25'37", arc length of 76.74 feet, and chord bearing and



distance of North 57°19'47" West, 76.16 feet;

North 69°32'35" West, 193.91 feet;

North 20°27'25" East, 520.00 feet;

North 28°31'47" East, 339.01 feet;

North 45°07'09" West, 118.68 feet;

South 44°52'51" West, 166.69 feet;

Along the arc of a non-tangent curve to the left having a radius of 61.50 feet, central angle of 163°21'59", arc length of 175.35 feet, and chord bearing and distance of South 63°59'17" West, 121.71 feet;

Along the arc of a reverse curve to the right having a radius of 15.00 feet, central angle of 38°09'07", arc length of 9.99 feet, and chord bearing and distance of South 01°22'51" West, 9.80 feet;

South 20°27'25" West, 306.01 feet;

Along the arc of a tangent curve to the right having a radius of 120.00 feet, central angle of 60°00'00", arc length of 125.66 feet, and chord bearing and distance of South 50°27'25" West, 120.00 feet;

Along the arc of a reverse curve to the left having a radius of 80.00 feet, central angle of 75°39'31", arc length of 105.64 feet, and chord bearing and distance of South 42°37'39" West, 98.13 feet;

Along the arc of a reverse curve to the right having a radius of 120.00 feet, central angle of 41°24'35", arc length of 86.73 feet, and chord bearing and distance of South 25°30'11" West, 84.85 feet;

South 46°12'29" West, 22.61 feet;

Along the arc of a tangent curve to the right having a radius of 15.00 feet, central angle of 90°00'00", arc length of 23.56 feet, and chord bearing and distance of North 88°47'31" West, 21.21 feet;

North 43°47'31" West, 129.48 feet;

South 46°12'29" West, 60.00 feet;

South 43°47'31" East, 200.46 feet;

Along the arc of a tangent curve to the left having a radius of 180.00 feet, central angle of 25°45'04", arc length of 80.90 feet, and chord bearing and distance of South 56°40'03" East, 80.22 feet;

South 69°32'35" East, 174.89 feet;

Along the arc of a tangent curve to the right having a radius of 25.00 feet, central angle of 89°03'51", arc length of 38.86 feet, and chord bearing and distance of South 25°00'40" East, 35.07 feet;

South 19°31'16" West, 135.80 feet;

South 76°39'18" West, 281.81 feet;

North 58°47'44" West, 370.94 feet;

North 43°54'17" West, 170.09 feet;

North 45°59'09" West, 257.68 feet to a point on the easterly line of Jacks



Valley Road;

Along said easterly line of Jacks Valley Road, North 21°17'11" East, 3383.63 feet;

Continuing along said easterly line of Jacks Valley Road, along the arc of a tangent curve to the left having a radius of 2630.00 feet, central angle of 09°12'33", arc length of 422.72 feet, and chord bearing and distance of North 16°40'55" East, 422.27 feet;

South 36°57'04" East, 559.28 feet;

South 33°56'22" East, 896.96 feet;

North 83°57'55" East, 46.80 feet;

North 14°27'34" East, 175.84 feet;

North 30°30'18" East, 128.95 feet;

North 47°52'54" East, 112.46 feet;

North 63°21'49" East, 85.24 feet;

North 80°15'10" East, 87.19 feet;

South 66°58'22" East, 73.31 feet;

Along the arc of a non-tangent curve to the right having a radius of 250.00 feet, central angle of 66°43'24", arc length of 291.14 feet, and chord bearing and distance of South 41°29'30" East, 274.96 feet;

South 08°07'48" East, 601.77 feet;

South 78°07'48" East, 68.40 feet;

North 31°52'12" East, 303.36 feet;

thence leaving said boundary of Adjusted Parcel 13 along the arc of a tangent curve to the left having a radius of 61.50 feet, central angle of 100°28'05", arc length of 107.84 feet, and chord bearing and distance of North 18°21'51" West, 94.55 feet;

North 14°54'09" East, 135.87 feet;

North 48°28'01" East, 129.67 feet;

South 85°33'15" East, 136.39 feet;

North 77°50'28" East, 158.26 feet to a point on said boundary of Adjusted

Parcel 13;

thence along said boundary of Adjusted Parcel 13, the following courses:

North 32°22'17" East, 79.96 feet;

North 45°00'16" East, 68.09 feet;

North 57°21'00" East, 77.47 feet;

North 62°20'56" East, 128.14 feet;

EAST, 78.31 feet;

North 41°30'06" East, 46.05 feet;

North 85°29'04" East, 31.47 feet;

South 45°51'46" East, 47.88 feet;
North 32°55'35" East, 260.59 feet;

thence leaving said boundary of Adjusted Parcel 13 and continuing North 32°55'35" East, 30.99 feet to a point on said boundary of Adjusted Parcel 13;

thence along said boundary of Adjusted Parcel 13, the following courses:

North 15°11'12" West, 240.72 feet;
North 09°02'13" East, 221.05 feet;
North 20°35'43" East, 511.70 feet;
North 09°12'15" East, 37.66 feet;
North 02°24'49" East, 126.19 feet;

Along the arc of a tangent curve to the left having a radius of 555.00 feet, central angle of 44°30'58", arc length of 431.21 feet, and chord bearing and distance of North 18°07'24" West, 420.44 feet to a point on the north line of said Northeast one-quarter of Section 26;

Along said north line, North 89°23'01" East, 1363.99 feet to the POINT OF BEGINNING, (containing 243.71 acres, more or less).

EXCEPTING THEREFROM the following parcel of land (known as Adjusted Parcel 14):

All that real property situate in the County of Douglas, State of Nevada, described as follows:

A parcel of land located within a portion of Section 26, Township 14 North, Range 19 East, Mount Diablo Meridian, more particularly described as follows:

Commencing at the southwesterly corner of Adjusted Parcel 13 as shown on the Record of Survey to Support a Boundary Line Adjustment for Genoa Land Investors, LLC, Genoa Developer Associates, LLC, MDA Enterprises, Inc. and Incomparable Holding Co. et al recorded June 30, 2005 in the office of Recorder, Douglas County, Nevada as Document No. 648319, a point on the easterly right-of-way of Jacks Valley Road;

thence along said easterly right-of-way of Jacks Valley Road, North 21°17'11" East, 2092.29 feet to a point on the southerly line of a 50-foot non-exclusive private access easement as recorded December 31, 1996 in said office of Recorder in Book 1296, at Page 4911, as Document No. 403934;

thence along said southerly line of private access easement, South 57°24'21" East, 385.07 feet to a point on the boundary of Adjusted Parcel 14 as shown on said Record of Survey, Document No. 648319, the POINT OF BEGINNING:

thence along the boundary of said Adjusted Parcel 14, the following courses:

North 26°23'05" East, 1033.27 feet;
North 83°19'32" East, 94.64 feet;
South 28°22'32" East, 311.42 feet;
South 17°15'57" East, 774.92 feet;
South 37°01'19" East, 167.99 feet;
South 24°23'07" West, 315.15 feet;
South 65°36'53" East, 165.00 feet;
South 24°23'07" West, 45.00 feet;
South 65°36'53" East, 205.00 feet;
South 24°23'07" West, 305.56 feet;
North 57°20'21" West, 585.93 feet;
North 59°14'14" West, 87.21 feet;

Along the arc of a tangent curve to the right having a radius of 125.00 feet, central angle of 21°57'15", arc length of 47.90 feet, and chord bearing and distance of North 48°15'37" West, 47.60 feet;

South 68°02'52" West, 733.74 feet;
North 61°20'53" West, 110.54 feet;
North 23°52'20" East, 837.66 feet;

North 57°24'21" West, 61.94 feet to the POINT OF BEGINNING, (containing 30.48, acres, more or less).

ADJUSTED PARCEL 13 CONTAINING 213.23 acres, more or less.

The Basis of Bearing of this description is North 89°23'01" East, the north line of the Northeast one-quarter of Section 26, T.14N., R.19E., M.D.M. as shown on the Record of Survey to Support a Boundary Line Adjustment for Genoa Land Investors, LLC, Genoa Developer Associates, LLC, MDA Enterprises, Inc. and Incomparable Holding Co. et al recorded June 30, 2005 in the office of Recorder, Douglas County, Nevada as Document No. 648319.

Note: Refer this description to your title company before incorporating into any legal document.

Prepared By: R.O. ANDERSON ENGINEERING, INC.
P.O. Box 2229
Minden, Nevada 89423

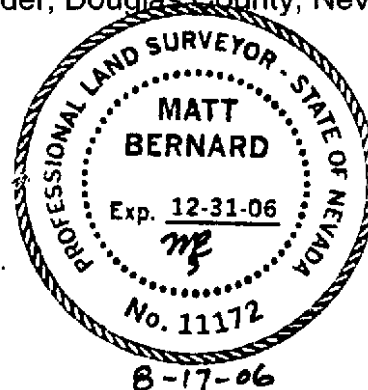

**DESCRIPTION
ADJUSTED PARCEL 16
(Adjusted APN 1419-26-001-014)**

All that real property situate in the County of Douglas, State of Nevada, described as follows:

A parcel of land located within a portion of Section 26, Township 14 North, Range 19 East, Mount Diablo Meridian, more particularly described as follows:

Commencing at the northeast corner of Section 26, T.14N., R.19E., M.D.M., a found 1985 BLM aluminum cap;

thence along the north line of the Northeast one-quarter of said Section 26, South 89°23'01" West, 2632.99 feet to the north one-quarter corner of said Section 26, a found 1985 BLM aluminum cap;

thence along the north line of the Northwest one-quarter of said Section 26, South 89°22'26" West, 1486.06 feet to a point on the easterly line of Jacks Valley Road;

thence along said easterly line of Jacks Valley Road, South 02°11'08" West, 444.77 feet;

thence continuing along said easterly line of Jacks Valley Road, along the arc of a tangent curve to the right having a radius of 2630.00 feet, central angle of 06°51'56", arc length of 315.14 feet, and chord bearing and distance of South 05°37'06" West, 314.96 feet to the POINT OF BEGINNING;

thence South 80°17'43" East, 33.62 feet;

thence along the arc of a tangent curve to the left having a radius of 170.00 feet, central angle of 58°34'24", arc length of 173.79 feet, and chord bearing and distance of North 70°25'05" East, 166.32 feet;

thence along the arc of a reverse curve to the right having a radius of 330.00 feet, central angle of 73°57'05", arc length of 425.93 feet, and chord bearing and distance of North 78°06'25" East, 396.97 feet;

thence along the arc of a compound curve to the right having a radius of 1780.00 feet, central angle of 14°23'13", arc length of 446.96 feet, and chord bearing and distance of South 57°43'26" East, 445.79 feet;

thence South 50°31'49" East, 250.00 feet;

thence along the arc of a tangent curve to the right having a radius of 480.00 feet, central angle of 33°00'00", arc length of 276.46 feet, and chord bearing and distance of South 34°01'49" East, 272.65 feet;

thence South 17°31'49" East, 85.00 feet;

thence along the arc of a tangent curve to the left having a radius of 270.00 feet,

central angle of $35^{\circ}00'00''$, arc length of 164.93 feet, and chord bearing and distance of South $35^{\circ}01'49''$ East, 162.38 feet;

thence South $52^{\circ}31'49''$ East, 48.42 feet;

thence along the arc of a tangent curve to the left having a radius of 670.00 feet, central angle of $58^{\circ}52'18''$, arc length of 688.43 feet, and chord bearing and distance of South $81^{\circ}57'58''$ East, 658.54 feet;

thence along the arc of a reverse curve to the right having a radius of 1030.00 feet, central angle of $14^{\circ}50'52''$, arc length of 266.92 feet, and chord bearing and distance of North $76^{\circ}01'19''$ East, 266.17 feet;

thence North $83^{\circ}26'45''$ East, 273.66 feet;

thence along the arc of a tangent curve to the right having a radius of 510.00 feet, central angle of $12^{\circ}45'49''$, arc length of 113.61 feet, and chord bearing and distance of North $89^{\circ}49'40''$ East, 113.37 feet to a point on the boundary of Adjusted Parcel 14 as shown on the Record of Survey to Support a Boundary Line Adjustment for Genoa Land Investors, LLC, Genoa Developer Associates, LLC, MDA Enterprises, Inc. and Incomparable Holding Co. et al recorded June 30, 2005 in the office of Recorder, Douglas County, Nevada as Document No. 648319;

thence along said boundary of Adjusted Parcel 14, the following courses:

South $32^{\circ}55'35''$ West, 260.59 feet;

North $45^{\circ}51'46''$ West, 47.88 feet;

South $85^{\circ}29'04''$ West, 31.47 feet;

South $41^{\circ}30'06''$ West, 46.05 feet;

WEST, 78.31 feet;

South $62^{\circ}20'56''$ West, 128.14 feet;

South $57^{\circ}21'00''$ West, 77.47 feet;

South $45^{\circ}00'16''$ West, 68.09 feet;

South $32^{\circ}22'17''$ West, 79.96 feet;

thence leaving said boundary of Adjusted Parcel 14, South $77^{\circ}50'28''$ West, 158.26 feet;

thence North $85^{\circ}33'15''$ West, 136.39 feet;

thence South $48^{\circ}28'01''$ West, 129.67 feet;

thence South $14^{\circ}54'09''$ West, 135.87 feet;

thence along the arc of a non-tangent curve to the left having a radius of 61.50 feet, central angle of $100^{\circ}28'05''$, arc length of 107.84 feet, and chord bearing and distance of South $18^{\circ}21'51''$ East, 94.55 feet to a point on the boundary of said Adjusted Parcel 14;

thence along said boundary of Adjusted Parcel 14, the following courses:



South 31°52'12" West, 303.36 feet;
North 78°07'48" West, 68.40 feet;
North 08°07'48" West, 601.77 feet;
Along the arc of a tangent curve to the left having a radius of 250.00 feet,
central angle of 66°43'24", arc length of 291.14 feet, and chord bearing and
distance of North 41°29'30" West, 274.96 feet;

thence leaving said boundary of Adjusted Parcel 14, North 66°58'22" West,
73.31 feet;
thence South 80°15'10" West, 87.19 feet;
thence South 63°21'49" West, 85.24 feet;
thence South 47°52'54" West, 112.46 feet;
thence South 30°30'18" West, 128.95 feet;
thence South 14°27'34" West, 175.84 feet to a point on the boundary of said
Adjusted Parcel 14;

thence along said boundary of Adjusted Parcel 14, the following courses:

South 83°57'55" West, 46.80 feet;
North 33°56'22" West, 896.96 feet;
North 36°57'04" West, 559.28 feet to a point on said easterly line of Jacks
Valley Road;

thence along said easterly line of Jacks Valley Road, along the arc of a non-
tangent curve to the left having a radius of 2630.00 feet, central angle of 03°01'34", arc
length of 138.90 feet, and chord bearing and distance of North 10°33'51" East, 138.89
feet to the POINT OF BEGINNING, containing 37.54 acres, more or less.

The Basis of Bearing of this description is North 89°23'01" East, the north line of the
Northeast one-quarter of Section 26, T.14N., R.19E., M.D.M. as shown on the Record of
Survey to Support a Boundary Line Adjustment for Genoa Land Investors, LLC, Genoa
Developer Associates, LLC, MDA Enterprises, Inc. and Incomparable Holding Co. et al
recorded June 30, 2005 in the office of Recorder, Douglas County, Nevada as Document
No. 648319.

Note: Refer this description to your title company
before incorporating into any legal document.



1163-021-06
05/22/06
Page 4 of 4
Adj Parcel 16

Prepared By: R.O. ANDERSON ENGINEERING, INC.
P.O. Box 2229
Minden, Nevada 89423



7-24-06

**DESCRIPTION
ADJUSTED PARCEL 17
(Adjusted APN 1419-26-001-013)**

All that real property situate in the County of Douglas, State of Nevada, described as follows:

A parcel of land located within a portion of Section 26, Township 14 North, Range 19 East, Mount Diablo Meridian, more particularly described as follows:

Commencing at the northeast corner of Section 26, T.14N., R.19E., M.D.M., a found 1985 BLM aluminum cap;

thence along the north line of the Northeast one-quarter of said Section 26, South 89°23'01" West, 1363.99 feet to the northeast corner of Adjusted Parcel 17 as shown on the Record of Survey to Support a Boundary Line Adjustment for Genoa Land Investors, LLC, Genoa Developer Associates, LLC, MDA Enterprises, Inc. and Incomparable Holding Co. et al recorded June 30, 2005 in the office of Recorder, Douglas County, Nevada as Document No. 648319, the POINT OF BEGINNING;

thence along the boundary of said Adjusted Parcel 17, the following courses:

Along the arc of a non-tangent curve to the right having a radius of 555.00 feet, central angle of 44°30'58", arc length of 431.21 feet, and chord bearing and distance of South 18°07'24" East, 420.44 feet;

South 02°24'49" West, 126.19 feet;
South 09°12'15" West, 37.66 feet;
South 20°35'43" West, 511.70 feet;
South 09°02'13" West, 221.05 feet;
South 15°11'12" East, 240.72 feet;

thence leaving said boundary of Adjusted Parcel 17, South 32°55'35" West, 30.99 feet;

thence along the arc of a non-tangent curve to the left having a radius of 510.00 feet, central angle of 12°45'49", arc length of 113.61 feet, and chord bearing and distance of South 89°49'40" West, 113.37 feet;

thence South 83°26'45" West, 273.66 feet;

thence along the arc of a tangent curve to the left having a radius of 1030.00 feet, central angle of 14°50'52", arc length of 266.92 feet, and chord bearing and distance of South 76°01'19" West, 266.17 feet;

thence along the arc of a reverse curve to the right having a radius of 670.00 feet, central angle of 58°52'18", arc length of 688.43 feet, and chord bearing and



distance of North 81°57'58" West, 658.54 feet;
thence North 52°31'49" West, 48.42 feet;
thence along the arc of a tangent curve to the right having a radius of 270.00 feet, central angle of 35°00'00", arc length of 164.93 feet, and chord bearing and distance of North 35°01'49" West, 162.38 feet;
thence North 17°31'49" West, 85.00 feet;
thence along the arc of a tangent curve to the left having a radius of 480.00 feet, central angle of 33°00'00", arc length of 276.46 feet, and chord bearing and distance of North 34°01'49" West, 272.65 feet;
thence North 50°31'49" West, 250.00 feet;
thence along the arc of a tangent curve to the left having a radius of 1780.00 feet, central angle of 14°23'13", arc length of 446.96 feet, and chord bearing and distance of North 57°43'26" West, 445.79 feet;
thence along the arc of a compound curve to the left having a radius of 330.00 feet, central angle of 73°57'05", arc length of 425.93 feet, and chord bearing and distance of South 78°06'25" West, 396.97 feet;
thence along the arc of a reverse curve to the right having a radius of 170.00 feet, central angle of 58°34'24", arc length of 173.79 feet, and chord bearing and distance of South 70°25'05" West, 166.32 feet;
thence North 80°17'43" West, 33.62 feet to a point on the easterly line of Jacks Valley Road;
thence along said easterly line of Jacks Valley Road, along the arc of a non-tangent curve to the left having a radius of 2630.00 feet, central angle of 06°51'56", arc length of 315.14 feet, and chord bearing and distance of North 05°37'06" East, 314.96 feet;
thence continuing along said easterly line of Jacks Valley Road, North 02°11'08" East, 444.77 feet;
thence along the north line of the Northwest one-quarter of said Section 26, North 89°22'26" East, 1486.06 feet to the north one-quarter corner of said Section 26, a found 1985 BLM aluminum cap;
thence along the north line of the Northeast one-quarter of said Section 26, North 89°23'01" East, 1269.00 feet to the POINT OF BEGINNING, containing 77.67 acres, more or less.

The Basis of Bearing of this description is North 89°23'01" East, the north line of the Northeast one-quarter of Section 26, T.14N., R.19E., M.D.M. as shown on the Record of Survey to Support a Boundary Line Adjustment for Genoa Land Investors, LLC, Genoa Developer Associates, LLC, MDA Enterprises, Inc. and Incomparable Holding Co. et al recorded June 30, 2005 in the office of Recorder, Douglas County, Nevada as Document No. 648319.

1163-021-06
05/15/06
Page 3 of 3
Adj Parcel 17

Note: Refer this description to your title company
before incorporating into any legal document.

Prepared By: R.O. ANDERSON ENGINEERING, INC.
P.O. Box 2229
Minden, Nevada 89423

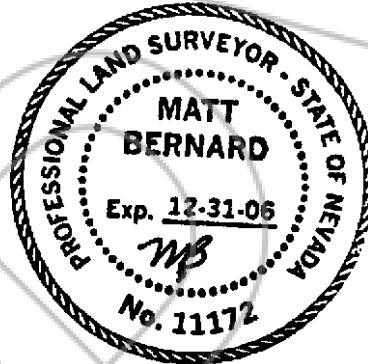

7-24-06

