

A.P.N. # 1320-32-712-021

R.P.T.T. \$ 1019.85

ESCROW NO. 070700718

RECORDING REQUESTED BY:

STEWART TITLE COMPANY

MAIL TAX STATEMENTS TO:
same as below

WHEN RECORDED MAIL TO:
Mariella Johnson
53 Blue Lagoon
Laguna Beach, CA 92651

DOC # **709185**
09/13/2007 03:02PM Deputy: EM
OFFICIAL RECORD
Requested By:
STEWART TITLE - DOUGLAS
Douglas County - NV
Werner Christen - Recorder
Page: **1** of **2** Fee: **15.00**
BK-907 PG-2745 RPTT: 1,019.85



(Space Above for Recorder's Use Only)

GRANT, BARGAIN, SALE DEED

THIS INDENTURE WITNESSETH: That **Robert Arthur McCarthy, Successor Trustee of the Robert Arthur McCarthy and Shirley Arline McCarthy Revocable Family Trust Agreement dated January 2001**

in consideration of \$10.00, the receipt of which is hereby acknowledged, does hereby Grant, Bargain Sell and Convey to **Mariella Johnson, Trustee of The Mariella Johnson Trust of October 8, 1996 as restated on October 6, 2004**

and to the heirs and assigns of such Grantee forever, all that real property situated in the County of **Douglas** State of Nevada, bounded and described as:

SEE EXHIBIT "A" ATTACHED HERETO AND MADE A PART HEREOF

Together with all and singular the tenements, hereditaments and appurtenances thereunto belonging or in anywise appertaining, and any reversions, remainders, rents, issues or profits thereof.

DATE: **August 27, 2007**

Robert Arthur McCarthy
Robert Arthur McCarthy, Trustee

STATE OF Ca }
 } ss.
COUNTY OF Tulare }



This instrument was acknowledged before me on 9/4/2007
by Robert Arthur McCarthy, Trustee

Signature *DO*
Notary Public (One inch margin on all sides of document for Recorder's Use Only)

EXHIBIT "A"

LEGAL DESCRIPTION

ESCROW NO.: 070700718

The land referred to herein is situated in the State of Nevada, County of Douglas described as follows:

Lot 21, as set forth on the Final Map of MILL CREEK ESTATES, a Planned Unit Development, filed for record in the office of the County Recorder of Douglas County, State of Nevada, on June 4, 1991, in Book 691, Page 337, as Document No. 252075.

Assessors Parcel No. 1320-32-712-021

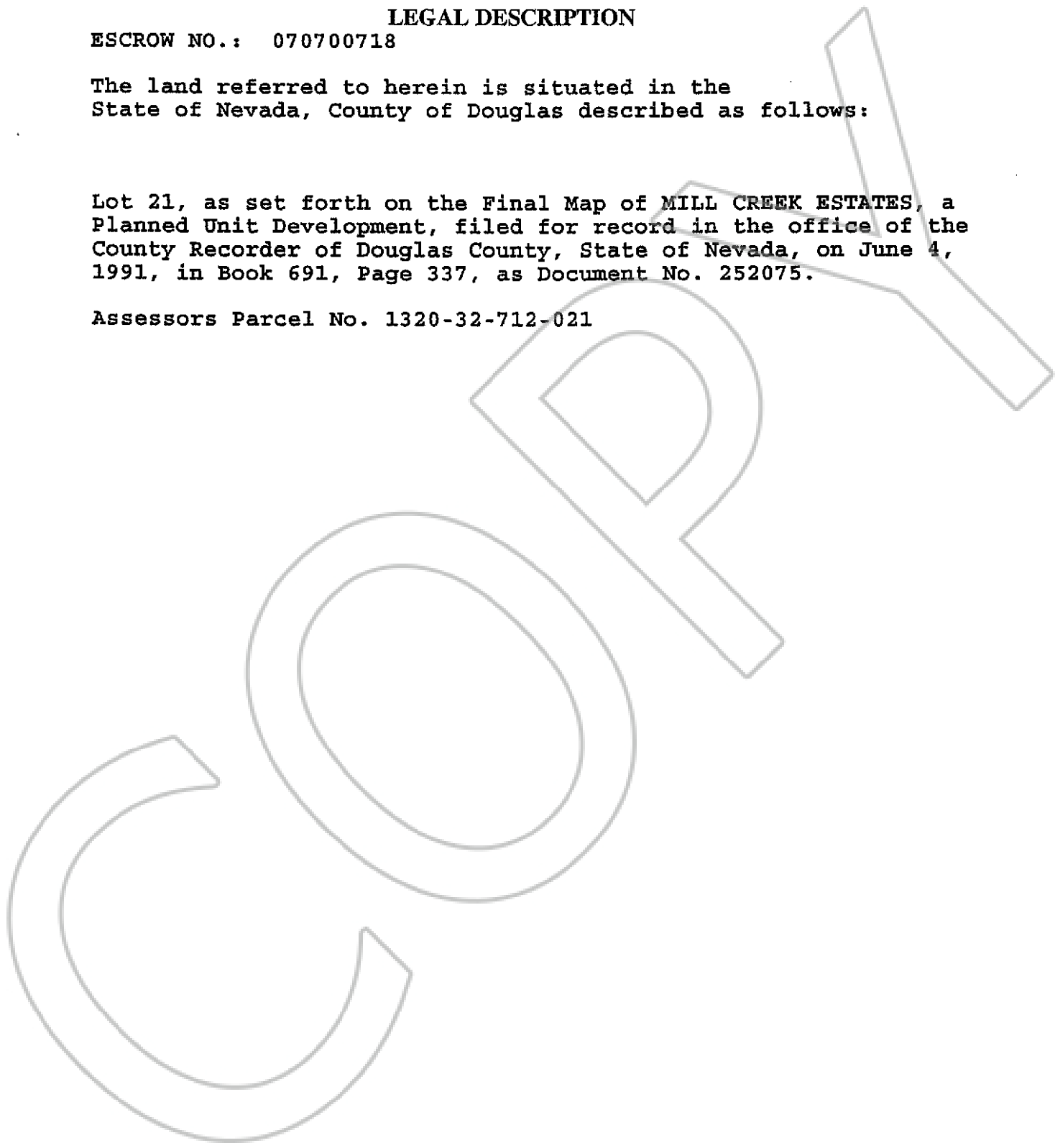

BK-907
PG-2746