

EXHIBIT "A"

LEGAL DESCRIPTION

ESCROW NO.: 070700725

The land referred to herein is situated in the State of Nevada, County of Douglas described as follows:

Lot 283 Block A as shown on the Final Map #PD99-02-08 of SARATOGA SPRINGS ESTATES UNIT 8, A PLANNED DEVELOPMENT, filed in the Office of the Douglas County Recorder on October 18, 2004, as Document No. 626992.

Assessor's Parcel No: 1420-29-612-006

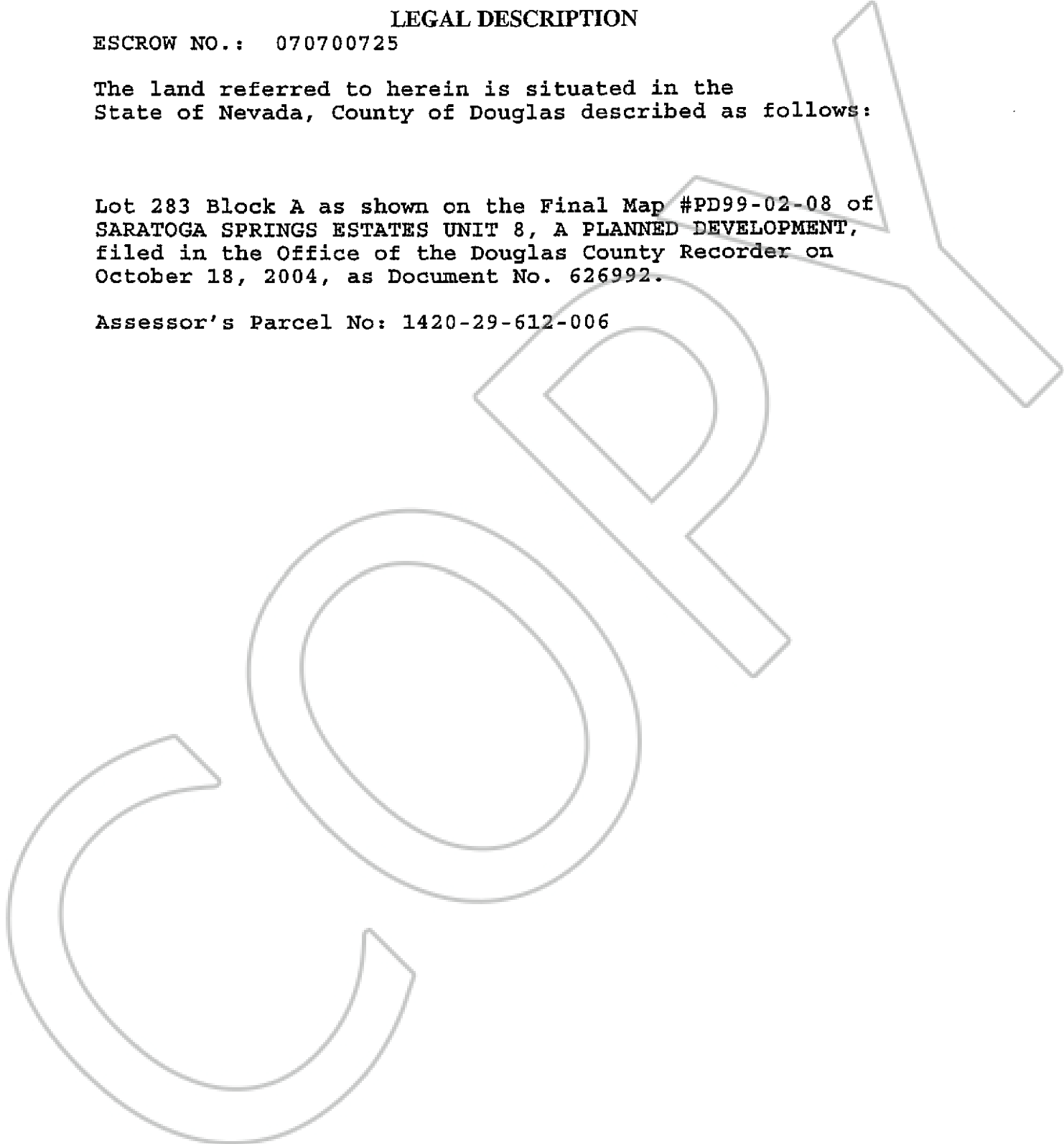

BK-907
PG-4047