

Douglas County - NV
 Werner Christen - Recorder
 Page: 1 Of 2 Fee: 15.00
 BK-1107 PG- 1415 RPTT: 1657.50



A.P.N. #	1320-31-515-001
R.P.T.T.	\$1,657.50
Escrow No.	1001001TA
Recording Requested By:	
Mail Tax Statements To:	Same as below
When Recorded Mail To:	
Melissa Emma Smith	
1650 Zaldia Drive	
Minden, NV 89423	

GRANT, BARGAIN, SALE DEED

THIS INDENTURE WITNESSETH: That ^{Mary Gonzi,} Trustee under The Mary Gonzi Trust Agreement dated July 7, 2004 for valuable consideration, the receipt of which is hereby acknowledged, does hereby Grant, Bargain Sell and Convey to **Melissa Emma Smith**, a single woman and to the heirs and assigns of such Grantee forever, all that real property situated in the County of Douglas, State of Nevada, bounded and described as follows:

See Exhibit "A" attached hereto and by reference made a part hereof for complete legal description.

Together with all and singular the tenements, hereditaments and appurtenances thereunto belonging or in anywise appertaining, and any reversions, remainders, rents, issues or profits thereof.

Dated: 10/23/07

 Mary Gonzi, Trustee

State of Nevada CA }
 El Dorado } ss.
 County of Douglas }

This instrument was acknowledged before me on 10/23/07
 by: Mary Gonzi, Trustee

Signature: Notary Public

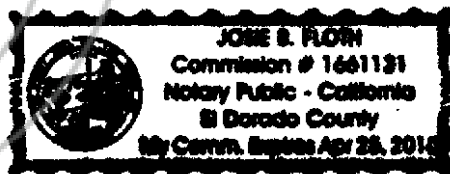
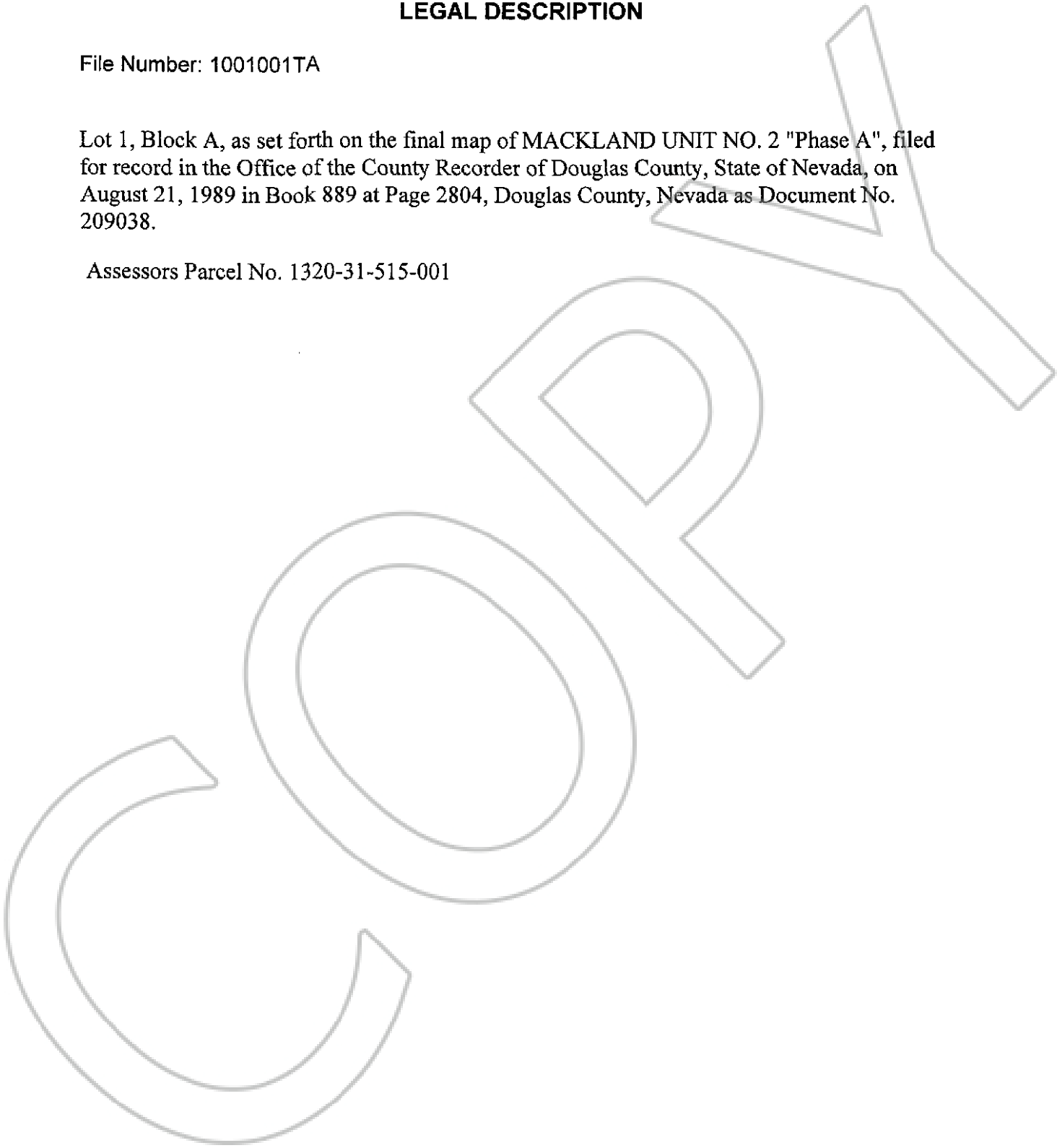

**Exhibit A
LEGAL DESCRIPTION**

File Number: 1001001TA

Lot 1, Block A, as set forth on the final map of MACKLAND UNIT NO. 2 "Phase A", filed for record in the Office of the County Recorder of Douglas County, State of Nevada, on August 21, 1989 in Book 889 at Page 2804, Douglas County, Nevada as Document No. 209038.

Assessors Parcel No. 1320-31-515-001



(One Inch Margin on all sides of Document for Recorder's use Only)

Page 2 of 2



0712609 Page: 2 Of 2 11/05/2007 BK- 1107 PG- 1416