

OFFICIAL RECORD

Requested By:

STEWART TITLE

Douglas County - NV  
Werner Christen - Recorder  
Page: 1 Of 2 Fee: 15.00  
BK-0108 PG- 5972 RPTT: # 5



A.P.N. #	1022-10-001-026
R.P.T.T.	#5
Escrow No.	1004057WD
Recording Requested By:	
Mail Tax Statements To:	Same as below
When Recorded Mail To:	
Mr. Marshall	
2043 Comstock Dr.	
Gardnerville, NV 89410	

**GRANT, BARGAIN, SALE DEED**

THIS INDENTURE WITNESSETH: That **Betty Lou Marshall, spouse of the grantee herein** for valuable consideration, the receipt of which is hereby acknowledged, does hereby Grant, Bargain Sell and Convey to James R. Marshall, a married man as his sole and separate property and to the heirs and assigns of such Grantee forever, all that real property situated in the County of Douglas, State of Nevada, bounded and described as follows:

See Exhibit "A" attached hereto and by reference made a part hereof for complete legal description.

Together with all and singular the tenements, hereditaments and appurtenances thereunto belonging or in anywise appertaining, and any reversions, remainders, rents, issues or profits thereof.

Dated: 1/24/08

Donna J. Shilinsky, legal guardian for  
Betty Lou Marshall  
By Donna J. Shilinsky, Guardian Betty Lou Marshall

State of Nevada }  
County of Washoe } ss.

This instrument was acknowledged before me on 1-24-08  
By: Donna J. Shilinsky, Guardian over the person Betty Lou Marshall

Signature: [Signature]  
Notary Public

D. SPRATT  
Notary Public - State of Nevada  
Appointment Recorded in Washoe County  
No: 94-1845-2 - Expires January 6, 2011

**Exhibit A  
LEGAL DESCRIPTION**

File Number: 1004057

Lot 142, as shown on the map of TOPAZ RANCH ESTATES UNIT NO. 2, filed in the Office of the County Recorder of Douglas County, Nevada, on February 20, 1967, as Document No. 35464.

Assessor's Parcel No. 1022-10-001-026.

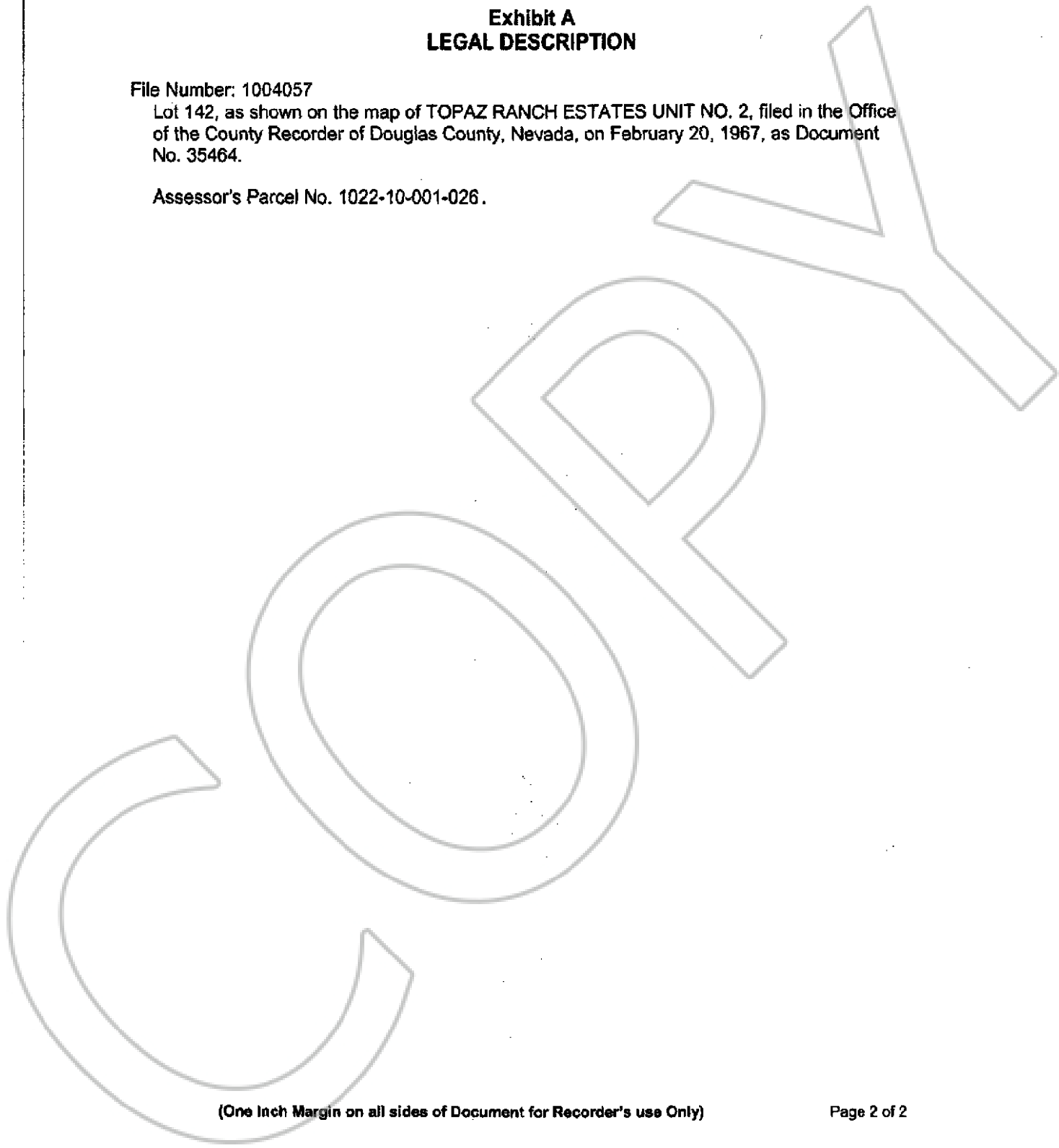

(One Inch Margin on all sides of Document for Recorder's use Only)

Page 2 of 2