

OFFICIAL RECORD

Requested By:

STEWART TITLE - DOUGLAS

Douglas County - NV

Werner Christen - Recorder

Page: 1 of 3 Fee: 16.00

BK-208 PG-2763 RPTT: 1,166.10



A.P.N. #	1320-35-002-058
R.P.T.T.	\$1,166.10
Escrow No.	1003096DS
Recording Requested By:	
	
Mail Tax Statements To:	Same as below
When Recorded Mail To:	
Mr. and Mrs. Kracher	
P.O. Box 901357	
Palmdale, Ca 93590-1357	

### GRANT, BARGAIN, SALE DEED

THIS INDENTURE WITNESSETH: That **Michael J. McGuire and Lisa R. McGuire, husband and wife, as joint tenants with right of survivorship** for valuable consideration, the receipt of which is hereby acknowledged, does hereby Grant, Bargain Sell and Convey to **Stanley G. Kracher and Thelma P. Kracher, husband and wife as Joint Tenants** and to the heirs and assigns of such Grantee forever, all that real property situated in the County of Douglas, State of Nevada, bounded and described as follows:

See Exhibit "A" attached hereto and by reference made a part hereof for complete legal description.

Together with all and singular the tenements, hereditaments and appurtenances thereunto belonging or in anywise appertaining, and any reversions, remainders, rents, issues or profits thereof.

Dated: 2-11-08

  
Michael J. McGuire

  
Lisa R. McGuire

State of CA }  
County of Douglas } ss.

This instrument was acknowledged before me on  
by: Michael J. McGuire, Lisa R. McGuire

Signature: \_\_\_\_\_  
Notary Public

**Exhibit A  
LEGAL DESCRIPTION**

File Number: 1003096

Lot 9, Block H, as shown on the final map of WILDFLOWER RIDGE UNIT 7B, filed for record in the Office of the County Recorder on October 2, 1991, in Book 1091, Page 331, Document No. 261707 Official Records of Douglas County, Nevada.

Assessors Parcel No. 1320-35-002-058

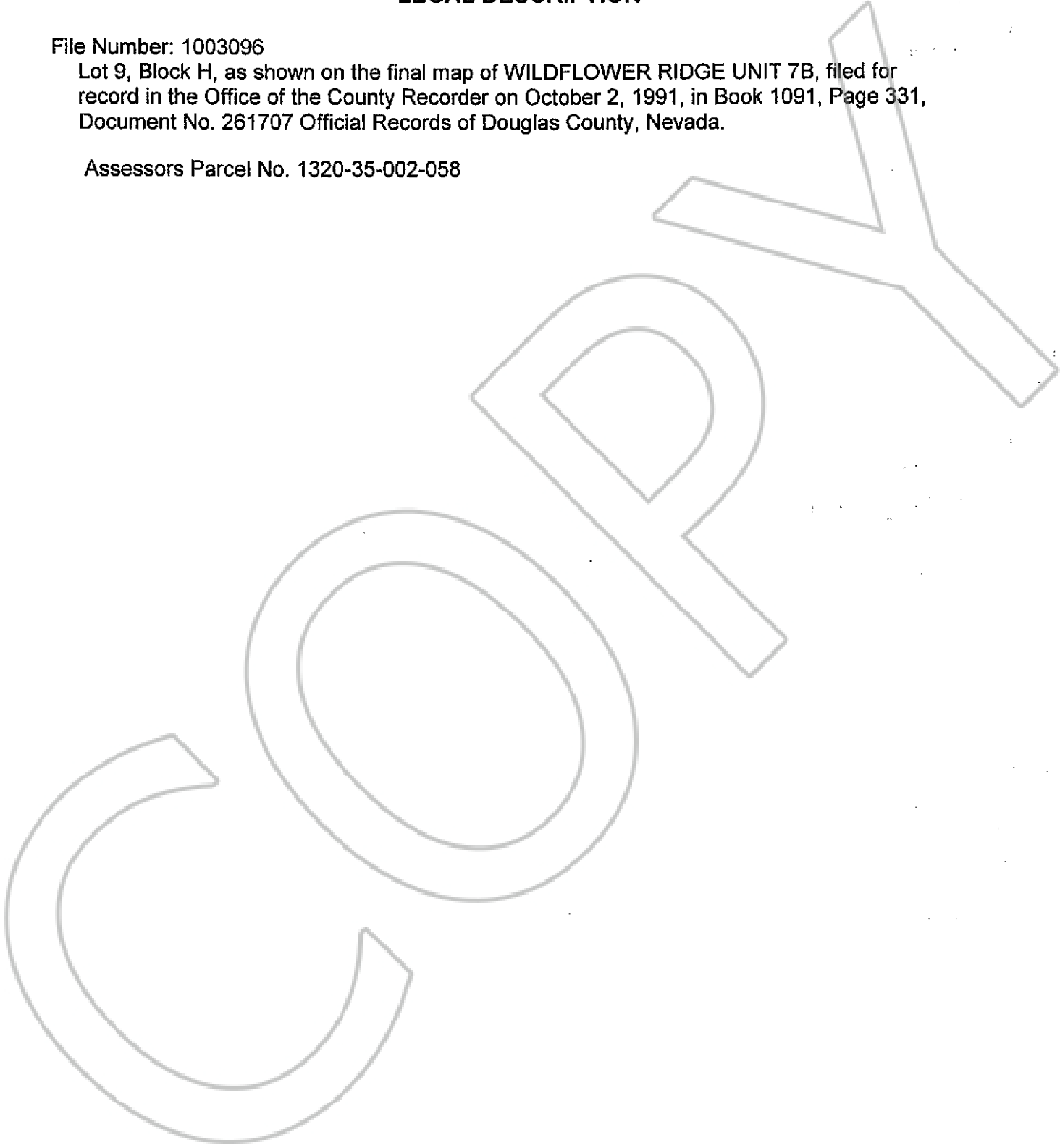

ALL-PURPOSE ACKNOWLEDGMENT

State of California

County of Alameda } SS.

On 2/11/08, before me, David Lawrence, Notary Public, personally appeared Michael J. McGuire & Lisa R. McGuire, who proved to me on the

basis of satisfactory evidence to be the person(s) whose name(s) is/are subscribed to the within instrument and acknowledged to me that he/she/they executed the same in his/her/their authorized capacity(ies), and that by his/her/their signature(s) on the instrument the person(s), or the entity upon behalf of which the person(s) acted, executed the instrument.

I certify under PENALTY OF PERJURY under the laws of the State of California that the foregoing paragraph is true and correct.

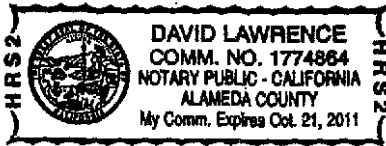

WITNESS my hand and official seal.

*[Handwritten Signature]*  
NOTARY'S SIGNATURE

PLACE NOTARY SEAL IN ABOVE SPACE

OPTIONAL INFORMATION

The information below is optional. However, it may prove valuable and could prevent fraudulent attachment of this form to an unauthorized document.

CAPACITY CLAIMED BY SIGNER (PRINCIPAL)

- INDIVIDUAL
- CORPORATE OFFICER \_\_\_\_\_ TITLE(S)
- PARTNER(S)
- ATTORNEY-IN-FACT
- TRUSTEE(S)
- GUARDIAN/CONSERVATOR
- OTHER: \_\_\_\_\_

DESCRIPTION OF ATTACHED DOCUMENT

\_\_\_\_\_  
TITLE OR TYPE OF DOCUMENT

\_\_\_\_\_  
NUMBER OF PAGES

\_\_\_\_\_  
DATE OF DOCUMENT

OTHER

SIGNER (PRINCIPAL) IS REPRESENTING:

NAME OF PERSON(S) OR ENTITY(IES)  
\_\_\_\_\_  
\_\_\_\_\_

RIGHT THUMBPRINT

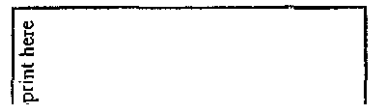

BK-208  
PG-2765

717958 Page: 3 of 3 02/12/2008