

DOC # 720232  
 03/25/2008 11:19AM Deputy: EM  
**OFFICIAL RECORD**  
 Requested By:  
**STEWART TITLE - DOUGLAS**  
 Douglas County - NV  
 Werner Christen - Recorder  
 Page: 1 of 2 Fee: 15.00  
 BK-308 PG-5772 RPTT: 0.00



A.P.N. #	1420-35-311-018
Escrow No.	1001849WD
Recording Requested By:	
	
Mail Tax Statements To:	Same as below
When Recorded Mail To:	
Skyline Ranch (II), LLC	
990 Ironwood Drive	
Minden, NV 89423	

**RELEASE OF LIEN**

OWNER: Richard and Peggy Taylor  
 THE UNDERSIGNED, CREATIVE TOUCH INTERIORS-RENO, hereby releases that certain Notice of Lien, dated 3/4/2008, and recorded 3/5/2008, in Book 0308, Document No. 0719091, Official Records of Douglas, State of Nevada, and covering the following described real property in the County of Douglas, State of Nevada:

SEE EXHIBIT "A" ATTACHED HERETO AND MADE A PART HEREOF

Dated: March 19, 2008

  
 Karen Wortham

State of Nevada }  
 County of Washoe }  
 This instrument was acknowledged before me on 19<sup>th</sup> day of March, 2008  
 By: Karen Wortham

Signature:   
 Notary Public

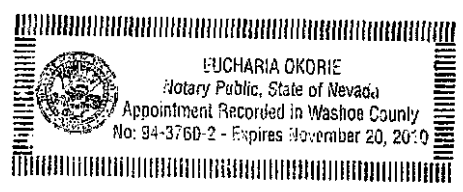

**EXHIBIT "A"**

Lot 116, as set forth on the Final Subdivision Map FSM #94-04-03 for SKYLINE RANCH PHASE 3 filed for record with the Douglas County Recorder on July 5, 2005 in Book 0705 of Official Records, Page 1491, as Document No. 648689.

ASSESSORS PARCEL NO. 1420-35-311-018

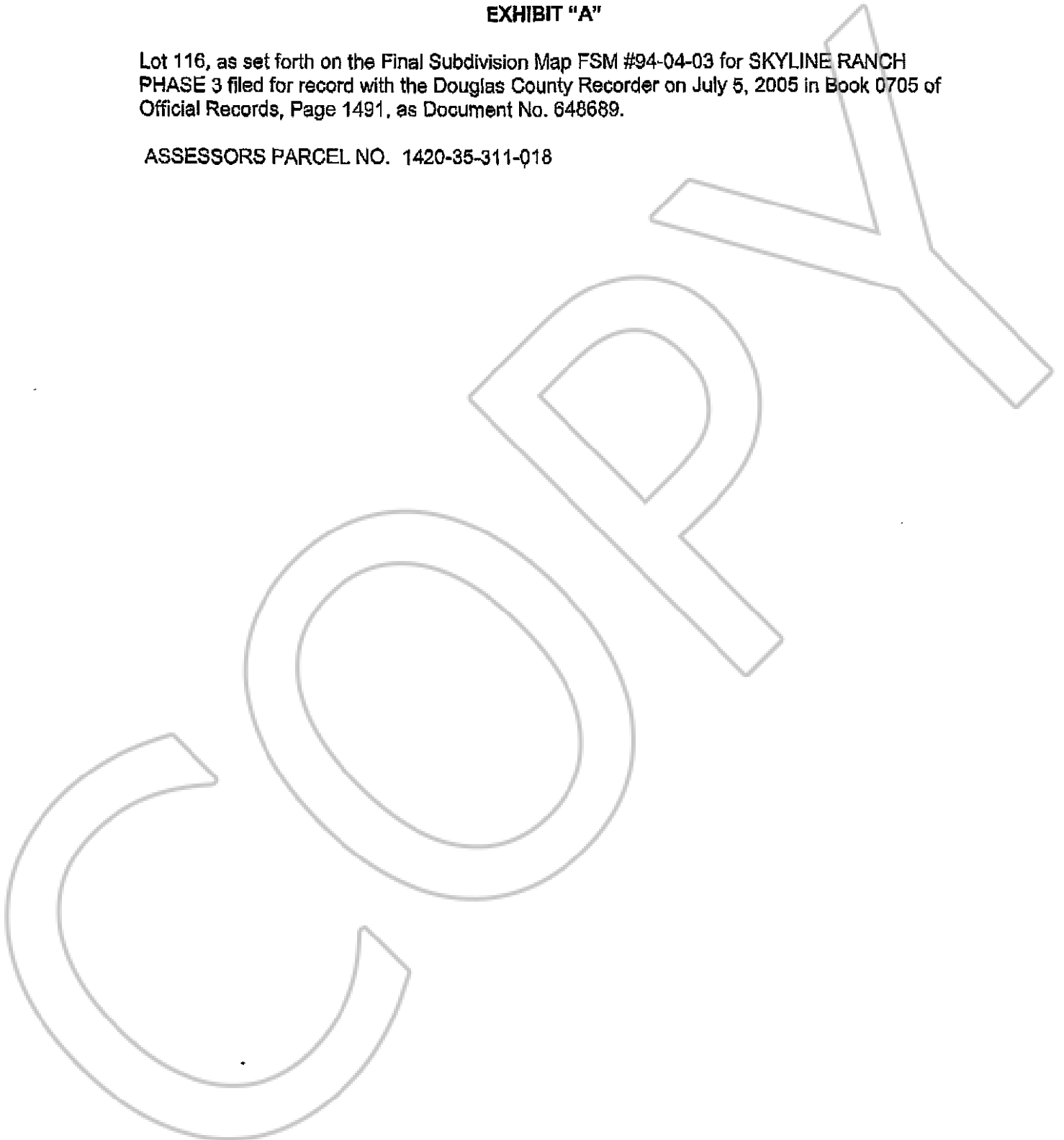

(One Inch Margin on all sides of Document for Recorder's use Only)

Page 2 of 2



BK-308  
PG-5773

720232 Page: 2 of 2 03/25/2008