

APN: 1420-33-410-049
Escrow No. 00165545 - 009-1
When Recorded Return to:
Grantee
2618 WILDRYE CT MINDEN, NV 89423
Mail Tax Statements to:
Same

Douglas County - NV
Werner Christen - Recorder
Page: 1 of 2 Fee: 15.00
BK-0308 PG- 7261 RPTT: # 5



SPACE ABOVE FOR RECORDERS USE

DEED

THIS INDENTURE WITNESSETH: That Jennifer Sclafani, spouse of the grantee herein, in consideration of the sum of Ten Dollars (\$10.00), the receipt of which is hereby acknowledged, do(es) hereby Grant, Bargain Sell and convey to Steven Sclafani, a married man, as his sole and separate property, whose address is 2618 Wildrye Court, Minden, NV, 89423 all that real property situate in the City of Minden, County of Douglas, State of Nevada, described as follows:

See Exhibit A attached hereto and made a part hereof.

It is the intent of Grantor herein to divest herself of any right, title and interest in and to the above described real property including any community property interest.

TOGETHER WITH all and singular the tenements, hereditaments and appurtenances thereunto belonging to in anywise appertaining.

DATE: March 19, 2008

Jennifer Sclafani
Jennifer Sclafani

STATE OF NEVADA
COUNTY OF Carson

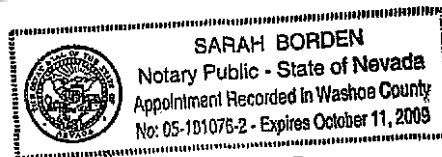

This instrument was acknowledged before me on March 27, 2008
by Jennifer Sclafani

Sarah Borden
NOTARY PUBLIC

SPACE BELOW FOR RECORDER

Exhibit A

Lot 68, for WILDHORSE ANNEX UNIT NO. 2, a Planned Unit Development, filed in the Office of the County Recorder of Douglas County, Nevada, on October 10, 1994 in Book 1094, Page 1490, Official Records of Douglas County, Nevada as Document No. 348105.

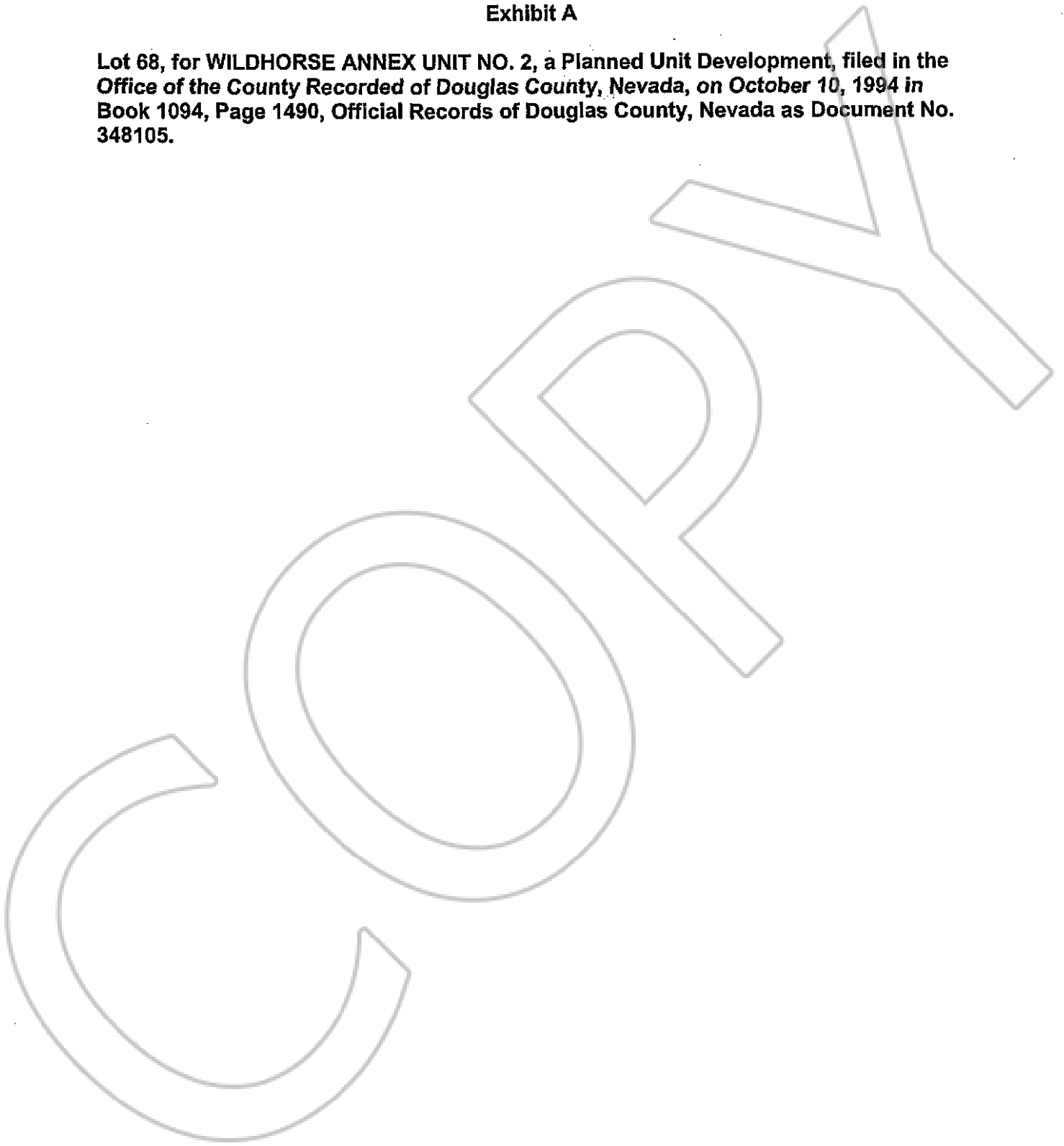

SPACE BELOW FOR RECORDER

