

APN: 1022-22-000-014 through 16
R.P.T.T. #3
ORDER NO. 1002759
Mail tax statements same as below

Douglas County - NV
Werner Christen - Recorder
Page: 1 Of 7 Fee: 20.00
BK-0408 PG- 4898 RPTT: # 3

WHEN RECORDED MAIL TO:
Evan L. Allred
913 N. Mountain St.
Carson City, NV 89701



**BOUNDARY LINE ADJUSTMENT
GRANT, BARGAIN, SALE DEED**

THIS INDENTURE WITNESSETH: EVAN L. ALLRED, in consideration of \$10.00, the receipt of which is hereby acknowledged, does hereby Grant, Bargain Sell and Convey to EVAN L. ALLRED, AND TO THE HEIRS AND ASSIGNS OF SUCH Grantee forever, all that real property situated in the County of Douglas, State of Nevada, bounded and described as follows:

SEE EXHIBIT "A" ATTACHED HERETO AND MADE A PART HEREOF
ALSO SEE EXHIBITS "B" and "C" ATTACHED HERETO AND MADE A PART HEREOF
THIS DEED IS PLACED OF RECORD FOR THE PURPOSE OF FACILITATING A BOUNDARY LINE ADJUSTMENT BETWEEN EXISTING PARCELS OF LAND, AS FURTHER DEPICTED AND SET FORTH ON THAT CERTAIN RECORD OF SURVEY IN SUPPORT OF BOUNDARY LINE ADJUSTMENT, RECORDED CONCURRENTLY HEREWITH.

Evan L. Allred

Utah
STATE OF ~~NEVADA~~ } ss.
COUNTY OF ~~DOUGLAS~~ }
Summit

This instrument was acknowledged before me on 4/17/08,
By, Evan L. Allred

Signature Natasha L. Pearce
Notary Public

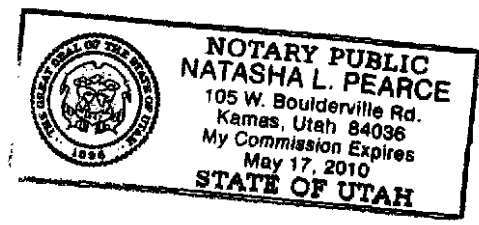

EXHIBIT A
DESCRIPTION
ADJUSTED PARCEL 1
DIVISION OF LANDS INTO LARGE PARCELS FOR EVAN L. ALLRED,
DOCUMENT No. 305536
(A.P.N. 1022-22-000-016)

All that real property situate in the County of Douglas, State of Nevada, described as follows:

A parcel of land located within portions of the Southwest one-quarter of Section 22, Township 10 North, Range 22 East, Mount Diablo Meridian, more particularly described as follows:

Commencing at the 1/4 corner for Sections 22 and 27, T.10N., R.22E., M.D.M.;
thence along the section line common to said Sections 22 and 27, South 89°54'42" West, 707.90 feet to the POINT OF BEGINNING;
thence continuing along said section line the following two courses:
South 89°54'42" West, 604.95 feet;
South 89°55'36" West, 1312.91 feet to the corner for Sections 21, 22, 27 and 28;
thence along the section line common to Sections 21 and 22, North 00°07'36" East, 1332.32 feet to the south 1/16 corner;
thence South 89°56'32" East, 1314.78 feet to the southwest 1/16 corner;
thence South 89°56'32" East, 1315.03 feet to the center south 1/16 corner;
thence along the north-south centerline of said Section 22, South 00°18'07" West, 976.10 feet;
thence South 89°54'42" West, 710.29 feet;
thence South 00°05'18" East, 349.87 feet to the POINT OF BEGINNING, containing 74.49 acres, more or less.

It is the intent of this description to call for the monuments noted on the Record of Survey to be recorded concurrently with this description.

The Basis of Bearing of this description is North 00°08'26" East, the west line of the northwest 1/4 of Section 22, T.10N., R.22E., M.D.M., as shown on the Record of Survey to Support a Boundary Line Adjustment for Evan L. Allred recorded October 18, 2001 as Document No. 525551.

Note: Refer this description to your title company before incorporating into any legal document.

Prepared by: R.O. Anderson Engineering, Inc.
P.O. Box 2229
Minden, Nevada 89423



EXP 12-31-09



EXHIBIT B
DESCRIPTION
ADJUSTED PARCEL 2
DIVISION OF LANDS INTO LARGE PARCELS FOR EVAN L. ALLRED,
DOCUMENT No. 305536
(A.P.N. 1022-22-000-015)

All that real property situate in the County of Douglas, State of Nevada, described as follows:

A parcel of land located within portions of the Southwest one-quarter and the Southeast 1/4 of Section 22, Township 10 North, Range 22 East, Mount Diablo Meridian, more particularly described as follows:

Commencing at the 1/4 corner for Sections 22 and 27, T.10N., R.22E., M.D.M., the POINT OF BEGINNING;

thence along the section line common to said Sections 22 and 27, South 89°54'42" West, 707.90 feet;
thence North 00°05'18" West, 349.87 feet;
thence North 89°54'42" East, 710.29 feet to the north-south centerline of said Section 22;
thence along said centerline, North 00°18'07" East, 191.75 feet;
thence North 89°45'22" East, 890.34 feet;
thence South 00°23'09" West, 304.82 feet;
thence North 89°45'22" East, 845.84 feet;
thence South 00°13'56" East, 236.89 feet to said section line common to Sections 22 and 27;
thence along said section line the following two courses:
South 89°46'04" West, 430.46 feet;
South 89°45'22" West, 1307.48 feet to the POINT OF BEGINNING, containing 21.37 acres, more or less.;

It is the intent of this description to call for the monuments noted on the Record of Survey to be recorded concurrently with this description.

The Basis of Bearing of this description is North 00°08'26" East, the west line of the northwest 1/4 of Section 22, T.10N., R.22E., M.D.M., as shown on the Record of Survey to Support a Boundary Line Adjustment for Evan L. Allred recorded October 18, 2001 as Document No. 525551.

Note: Refer this description to your title company before incorporating into any legal document.

Prepared by: R.O. Anderson Engineering, Inc.
P.O. Box 2229
Minden, Nevada 89423

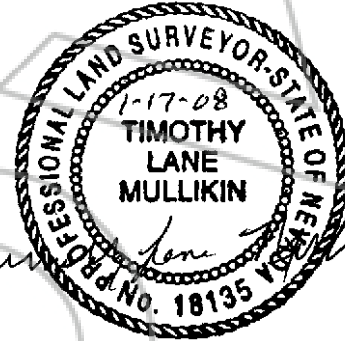

EXP 12-31-09

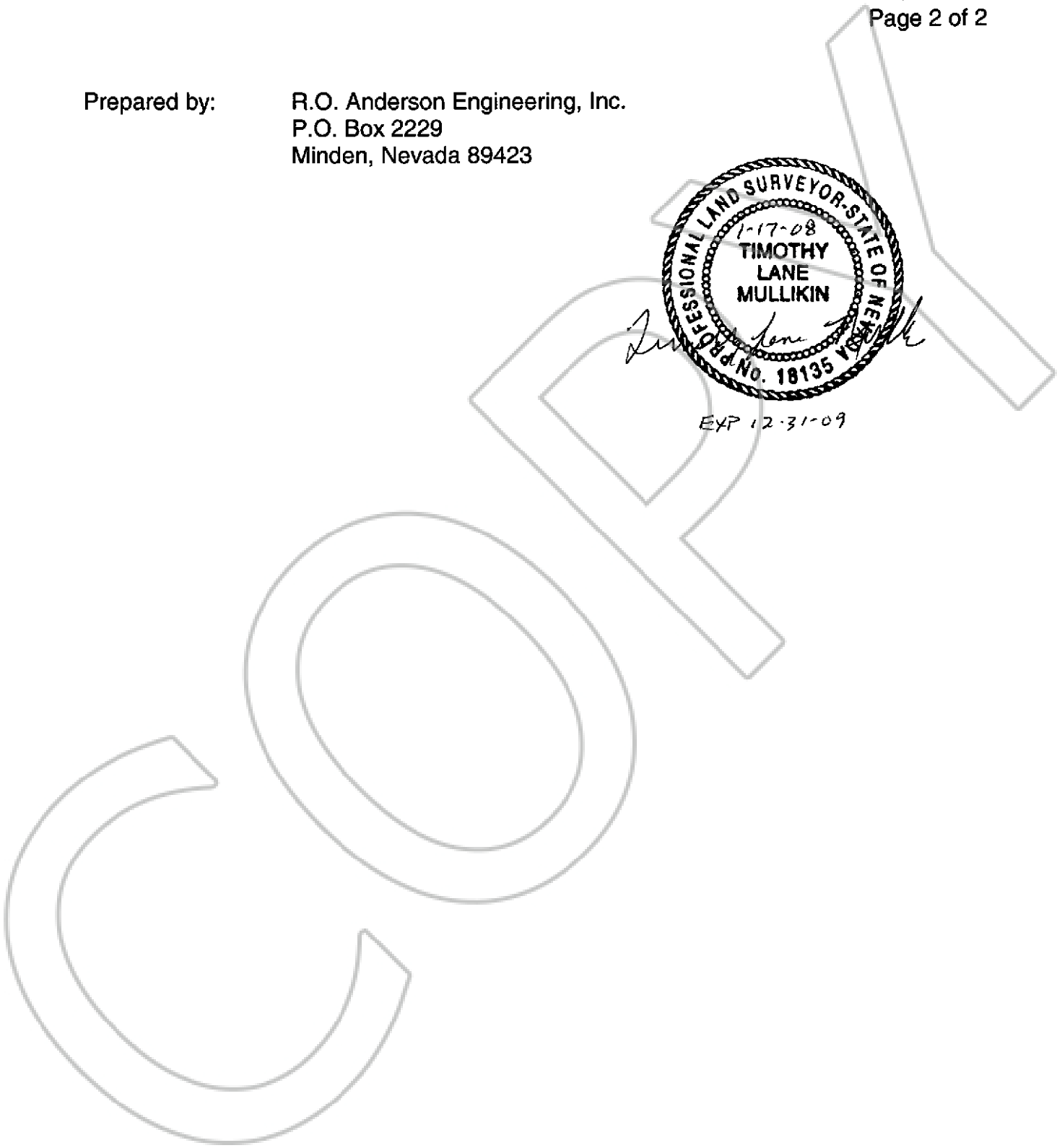

EXHIBIT C
DESCRIPTION
ADJUSTED PARCEL 3
DIVISION OF LANDS INTO LARGE PARCELS FOR EVAN L. ALLRED,
DOCUMENT No. 305536
(A.P.N. 1022-22-000-014)

All that real property situate in the County of Douglas, State of Nevada, described as follows:

A parcel of land located within portions of the Southeast one-quarter of Section 22, Township 10 North, Range 22 East, Mount Diablo Meridian, more particularly described as follows:

Commencing at the 1/4 corner for Sections 22 and 27, T.10N., R.22E., M.D.M.;
thence along the section line common to said Sections 22 and 27, South 89°54'42" West, 707.90 feet;
thence North 00°05'18" West, 349.87 feet;
thence North 89°54'42" East, 710.29 feet to the north-south centerline of said Section 22;
thence along said centerline, North 00°18'07" East, 191.75 feet to the POINT OF BEGINNING;
thence continuing along said centerline, North 00°18'07" East, 784.35 feet to the center-south 1/16 corner;
thence along the east-west centerline of the Southeast 1/4 of said Section 22, North 89°58'58" East, 478.22 feet;
thence South 55°43'02" East, 310.69 feet;
thence South 41°17'21" East, 275.00 feet;
thence South 47°26'38" East, 204.21 feet;
thence South 54°59'35" East, 195.68 feet;
thence South 30°53'03" East, 337.55 feet;
thence South 76°11'16" East, 339.10 feet;
thence South 00°13'56" East, 79.26 feet;
thence South 89°45'22" West, 845.84 feet;
thence North 00°23'09" East, 304.82 feet;
thence South 89°45'22" West, 890.34 feet, to the POINT OF BEGINNING, containing 21.23 acres, more or less.

It is the intent of this description to call for the monuments noted on the Record of Survey to be recorded concurrently with this description.

The Basis of Bearing of this description is North 00°08'26" East, the west line of the northwest 1/4 of Section 22, T.10N., R.22E., M.D.M., as shown on the Record of Survey to Support a Boundary Line Adjustment for Evan L. Allred recorded October 18, 2001 as Document No. 525551.

Note: Refer this description to your title company before incorporating into any legal document.

Prepared by: R.O. Anderson Engineering, Inc.
P.O. Box 2229
Minden, Nevada 89423

