

EXHIBIT A
DESCRIPTION
AREA ADJUSTED FROM PARCEL 5A TO PARCEL 2
RECORD OF SURVEY TO SUPPORT A BOUNDARY LINE ADJUSTMENT
FOR EVAN L. ALLRED,
DOCUMENT NO. 525551
(FROM A.P.N. 1022-22-000-018 TO A.P.N. 1022-22-000-015)

All that real property situate in the County of Douglas, State of Nevada, described as follows:

A parcel of land located within portions of the Southeast one-quarter of Section 22, Township 10 North, Range 22 East, Mount Diablo Meridian, more particularly described as follows:

Commencing at the 1/4 corner for Sections 22 and 27, T.10N., R.22E., M.D.M.;
thence along the section line common to said Sections 22 and 27, North 89°45'22" East, 1307.48 feet to the east 1/16 corner and POINT OF BEGINNING;
thence North 00°26'40" East, 236.82 feet;
thence North 89°45'22" East, 427.66 feet;
thence South 00°13'56" East, 236.89 feet to said section line common to Sections 22 and 27;
thence along said section line, South 89°46'04" West, 430.46 to the POINT OF BEGINNING, containing 101,622 square feet (2.33 acres), more or less.

The Basis of Bearing of this description is North 00°08'26" East, the west line of the northwest 1/4 of Section 22, T.10N., R.22E., M.D.M., as shown on the Record of Survey to Support a Boundary Line Adjustment for Evan L. Allred recorded October 18, 2001 as Document No. 525551.

It is the intent of this description to call for the monuments noted on the Record of Survey to be recorded concurrently with this description.

Note: Refer this description to your title company before incorporating into any legal document.

Prepared by: R.O. Anderson Engineering, Inc.
P.O. Box 2229
Minden, Nevada 89423

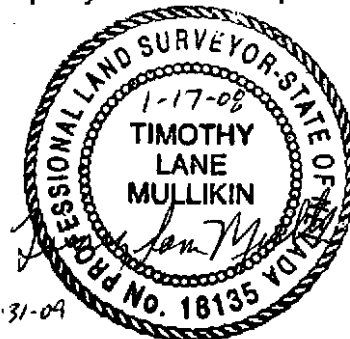

EXHIBIT B
DESCRIPTION
AREA ADJUSTED FROM PARCEL 5A TO PARCEL 3
RECORD OF SURVEY TO SUPPORT A BOUNDARY LINE ADJUSTMENT
FOR EVAN L. ALLRED,
DOCUMENT NO. 525551
(FROM A.P.N. 1022-22-000-018 TO A.P.N. 1022-22-000-014)

All that real property situate in the County of Douglas, State of Nevada, described as follows:

A parcel of land located within portions of the Southeast one-quarter of Section 22, Township 10 North, Range 22 East, Mount Diablo Meridian, more particularly described as follows:

Commencing at the 1/4 corner for Sections 22 and 27, T.10N., R.22E., M.D.M.;
thence along the section line common to said Sections 22 and 27 the following two courses:

North 89°45'22" East, 1307.48 feet;
North 89°46'04" East, 430.46 feet;
thence North 00°13'56" West, 236.89 feet to the POINT OF BEGINNING;
thence South 89°45'22" West, 427.66;
thence North 00°26'40" East, 321.78 feet;
thence South 30°53'03" East, 186.13 feet;
thence South 76°11'16" East, 339.10 feet;
thence South 00°13'56" East, 79.26 feet to the POINT OF BEGINNING,
containing 63,166 square feet (1.45 acres), more or less.

It is the intent of this description to call for the monuments noted on the Record of Survey to be recorded concurrently with this description.

The Basis of Bearing of this description is North 00°08'26" East, the west line of the northwest 1/4 of Section 22, T.10N., R.22E., M.D.M., as shown on the Record of Survey to Support a Boundary Line Adjustment for Evan L. Allred recorded October 18, 2001 as Document No. 525551.

Note: Refer this description to your title company
before incorporating into any legal document.

Prepared by: R.O. Anderson Engineering, Inc.
P.O. Box 2229
Minden, Nevada 89423

