

APN 1220-16-117-003

RECORDING REQUESTED BY
Nations Home Funding

AND WHEN RECORDED MAIL TO:
Nations Home Funding
660 Sierra Rose Drive, Suite A
Reno, NV 89511

FHA Case Number: 331-1307447/952-255
Loan Number: 3000013640
Title Order Number:
FHA Originator No:
2080018WD

Space above this line for recorder's use

CORPORATION ASSIGNMENT OF DEED OF TRUST

FOR VALUE RECEIVED, the undersigned hereby grants, sells, assigns and transfers to World Alliance Financial Corp, whose address is 3 Huntington Quadrangle 3rd Floor, Melville, NEW YORK 11747 all beneficial interest under that Certain Deed of Trust dated May 09, 2008 executed by ALENE E. DEDMON, A WIDOW, Borrower, to Nations Home Funding, a Nevada Corporation, Lender, and recorded concurrently herewith in the County Recorder's office of Douglas County, NV, describing land therein as: Legal Description attached hereto as Exhibit A and by this reference made a part hereof.

TOGETHER with the note or notes therein described or referred to, the money due and to become due thereon with interest, and all rights accrued or to accrue under said Deed of Trust.

Nations Home Funding
a Nevada Corporation

[Signature]
Title: Facilitator - Mortgage

STATE OF NV
COUNTY OF Washoe

ss:

On 11th 13 2008 before me, [Signature]
a Notary Public in and for said County and State, personally appeared [Signature] personally known to me (or proved to me on the basis of satisfactory evidence) to be the person(s) whose name(s) is/are subscribed to the within instrument and acknowledged to me that he/she/they executed the same in his/her/their authorized capacity(ies), and that by his/her/their signature(s) on the instrument the person(s), or entity upon behalf of which the person(s) acted executed the instrument.

WITNESS my hand and official seal

Signature [Signature]

Notary Public

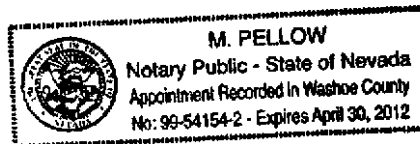
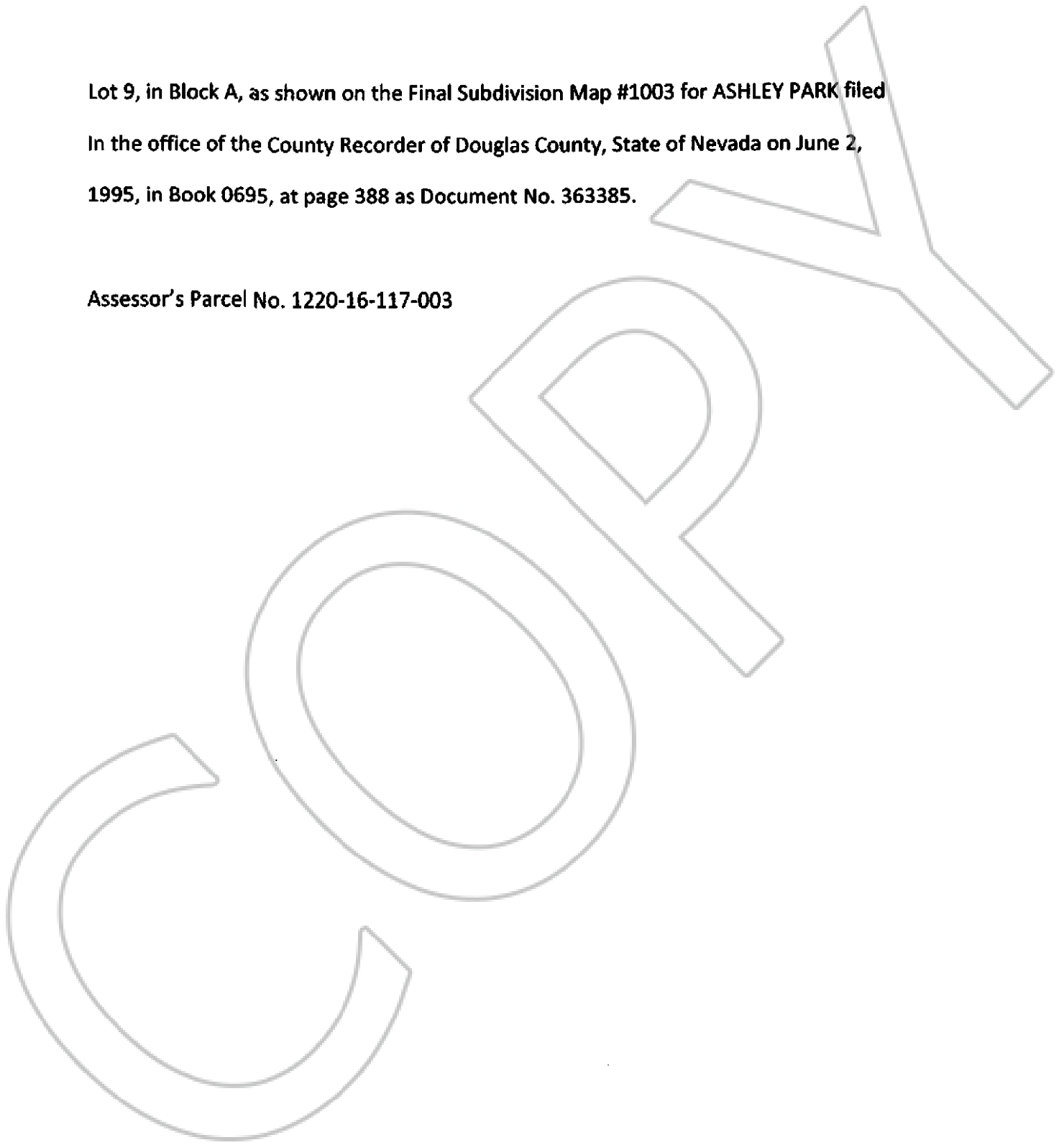

EXHIBIT "A"

Lot 9, in Block A, as shown on the Final Subdivision Map #1003 for ASHLEY PARK filed
In the office of the County Recorder of Douglas County, State of Nevada on June 2,
1995, in Book 0695, at page 388 as Document No. 363385.

Assessor's Parcel No. 1220-16-117-003



BK-508
PG-3907