

Recording Requested By  
Marquis Title & Escrow Inc.  
APN: 1420-33-601-001  
Escrow No. 280122-GVM  
R.P.T.T. \$1,267.50

DOC # 724652  
06/06/2008 02:27PM Deputy: DW  
OFFICIAL RECORD  
Requested By:  
MARQUIS TITLE  
Douglas County - NV  
Werner Christen - Recorder  
Page: 1 of 3 Fee: 16.00  
BK-608 PG-1737 RPTT: 1,267.50



**WHEN RECORDED MAIL TO:**  
**LELAND LOVE and BETHANY LOVE**

*P.O. Box 922  
Minden, NV 89423*

**MAIL TAX STATEMENT TO:**  
Same as Above

### **GRANT, BARGAIN and SALE DEED**

FOR A VALUABLE CONSIDERATION, receipt of which is hereby acknowledged,

JAY F. TURNER, a surviving joint tenant

do(es) hereby GRANT, BARGAIN and SELL to

LELAND LOVE and BETHANY LOVE, husband and wife as joint tenants with the right of survivorship

the real property situate in the County of Douglas, State of Nevada, described as follows:

**SEE EXHIBIT "A" ATTACHED HERETO AND MADE A PART HEREOF**

TOGETHER with all tenements, hereditaments and appurtenances, including easements and water rights, if any, thereto belonging or appertaining, and any reversions, remainders, rents, issues or profits thereof.

Dated: 6-4-08

Jay F. Turner  
JAY TURNER

STATE OF Nevada  
COUNTY OF Douglas

This instrument was acknowledged before me on 6-4-08 by JAY TURNER.

Vicky D. Morrison  
Notary Public

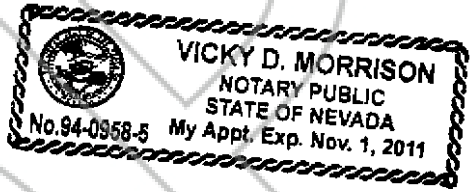

BK-608  
PG-1738

**EXHIBIT "A"**

**ALL THAT PORTION OF THE SOUTHWEST ¼ OF THE  
NORTHEAST ¼ OF SECTION 33, TOWNSHIP 14 NORTH, RANGE 20  
EAST, M.D.B.&M., BEING MORE PARTICULARLY DESCRIBED AS  
PARCEL A, AS SET FORTH ON THE PARCEL MAP OF  
STRICKLAND PARCELS, FILED IN THE OFFICE OF THE COUNTY  
RECORDER OF DOUGLAS , STATE OF NEVADA, ON MARCH 5,  
1980, IN BOOK 380, PAGE 630, AS DOCUMENT NO. 42428.**

**APN            1420-33-601-001**

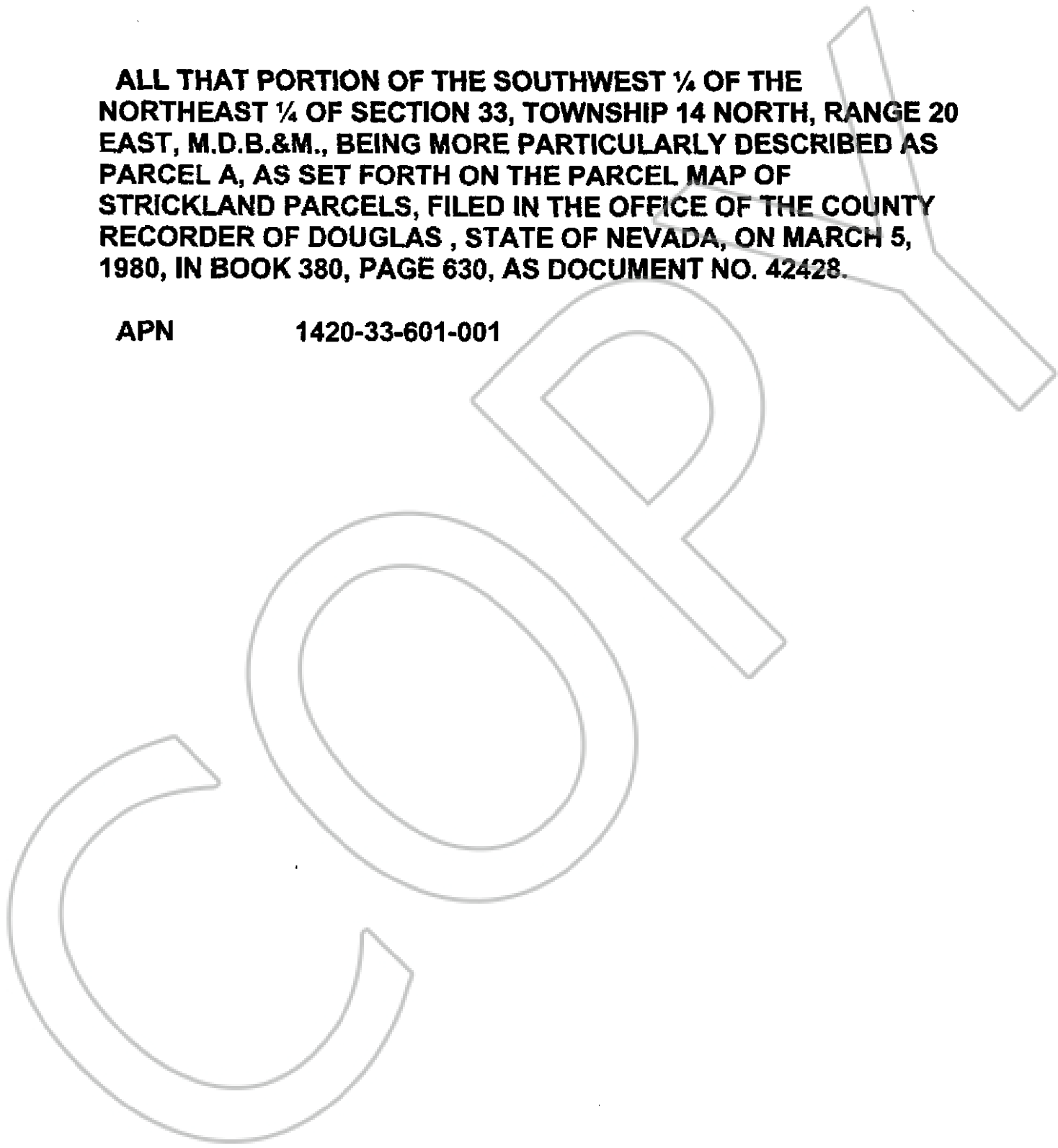

BK-608  
PG-1739