

OFFICIAL RECORD

Requested By:  
JULIE SUMMERVILLE

The undersigned hereby affirms that this document does not contain a Social Security Number.

Douglas County - NV  
Werner Christen - Recorder

Page: 1 of 2 Fee: 15.00  
BK-0708 PG- 1535 RPTT: 0.00



Print Name Under Signature: JULIE SUMMERVILLE

When Recorded Return To: JULIE SUMMERVILLE

PO 8270  
GARDNERVILLE, NV. 89460

Assessor Parcel Number: 1219-22-001-039

**DECLARATION OF HOMESTEAD**

Check One:

- Married (filing joint declaration)
- Head of Family
- By Husband (filing for joint benefit or both)
- Single, Married or Widowed
- By Wife (filing joint benefit or both)
- Multiple Single Persons
- Other: \_\_\_\_\_

A: Check One

- Regular Home Dwelling/Manufactured Home
- Condominium Unit
- Other

Name on Title of Property: JULIE K. SUMMERVILLE / CRAIG W. DUCAR

Do individually or severally certify and declare as follows: SAME

Is/are now residing on the land, premises (or manufactured home) located in the City of: GARDNERVILLE

County of: DOUGLAS, State of Nevada, and more particularly described as follows:

(Set forth legal description and commonly known street address OR manufactured home description)

SEE ATTACHED

B: WE I/We claim the land and premises hereinabove described, together with the dwelling house thereon, and its appurtenances, or the described manufactured home as a Homestead.

In Witness, Whereof, I/We have hereunto set my hand/our hands this 10th day of July 2008.

Signature: [Handwritten Signature]  
Print Name here: Julie k. Summerville

Signature: \_\_\_\_\_  
Print Name here: \_\_\_\_\_

STATE OF NEVADA \_\_\_\_\_  
COUNTY OF Douglas

This instrument was acknowledged before me on 7-10-08

Julie k. Summerville  
Person(s) appearing before notary

[Handwritten Signature]  
(Signature of notarial officer) My commission expires: 1-10-10



**EXHIBIT "A"**

**LEGAL DESCRIPTION**

ESCROW NO.: 040700709

The land referred to herein is situated in the State of Nevada, County of Douglas described as follows:

Lot 411, in Block B, as set forth on that certain Official Plat of JOB'S PEAK RANCH UNIT 4, Final Subdivision Map Planned Unit Development 2014-4, filed for record in the office of the County Recorder of Douglas County, State of Nevada, on April 12, 2004 in Book 0404 of Official Records, at Page 5560, as Document No. 610012.

A portion of ASSESSOR'S PARCEL NO. 1219-22-001-005

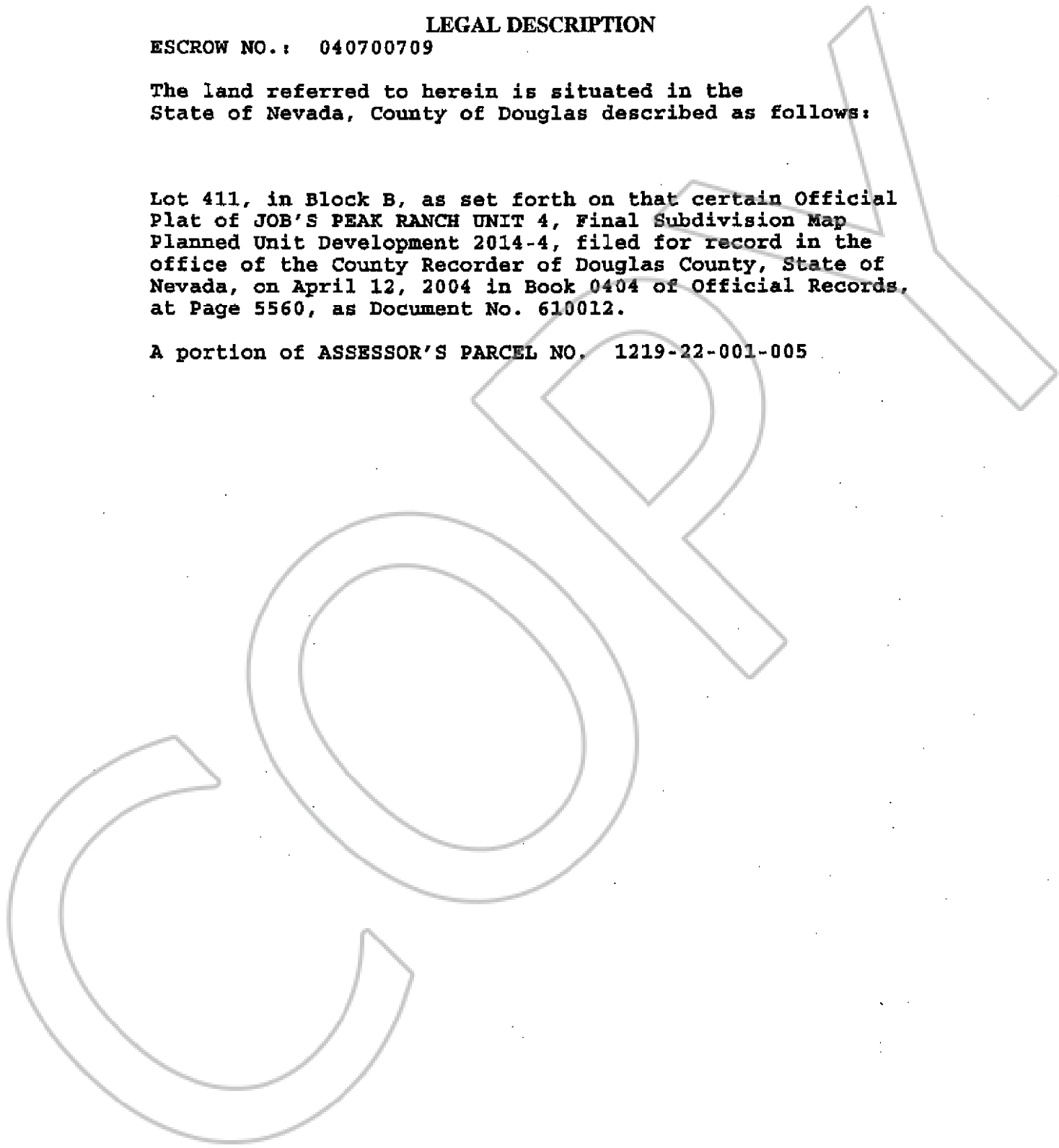

0611153

BK0404PG11918

BK- 0708  
PG- 1536

