

OFFICIAL RECORD

Requested By:
MARQUIS TITLE

Assessor's Parcel No: 1022-32-110-029

Douglas County - NV
Werner Christen - Recorder

Page: 1 of 4 Fee: 17.00
BK-0808 PG- 775 RPTT: # 3

RPTTS: 0- or Exempt No: #3

Clarification of Grantee



Recording Requested By:

MARQUIS TITLE & ESCROW, INC.
3086 Silver Sage Drive
Carson City, NV 89701

Escrow Number 283302-DVS

I hereby affirm that this document submitted for
recording does not contain a social security number

Correction
TITLE OF DOCUMENT Grant, Bargain and Sale Deed

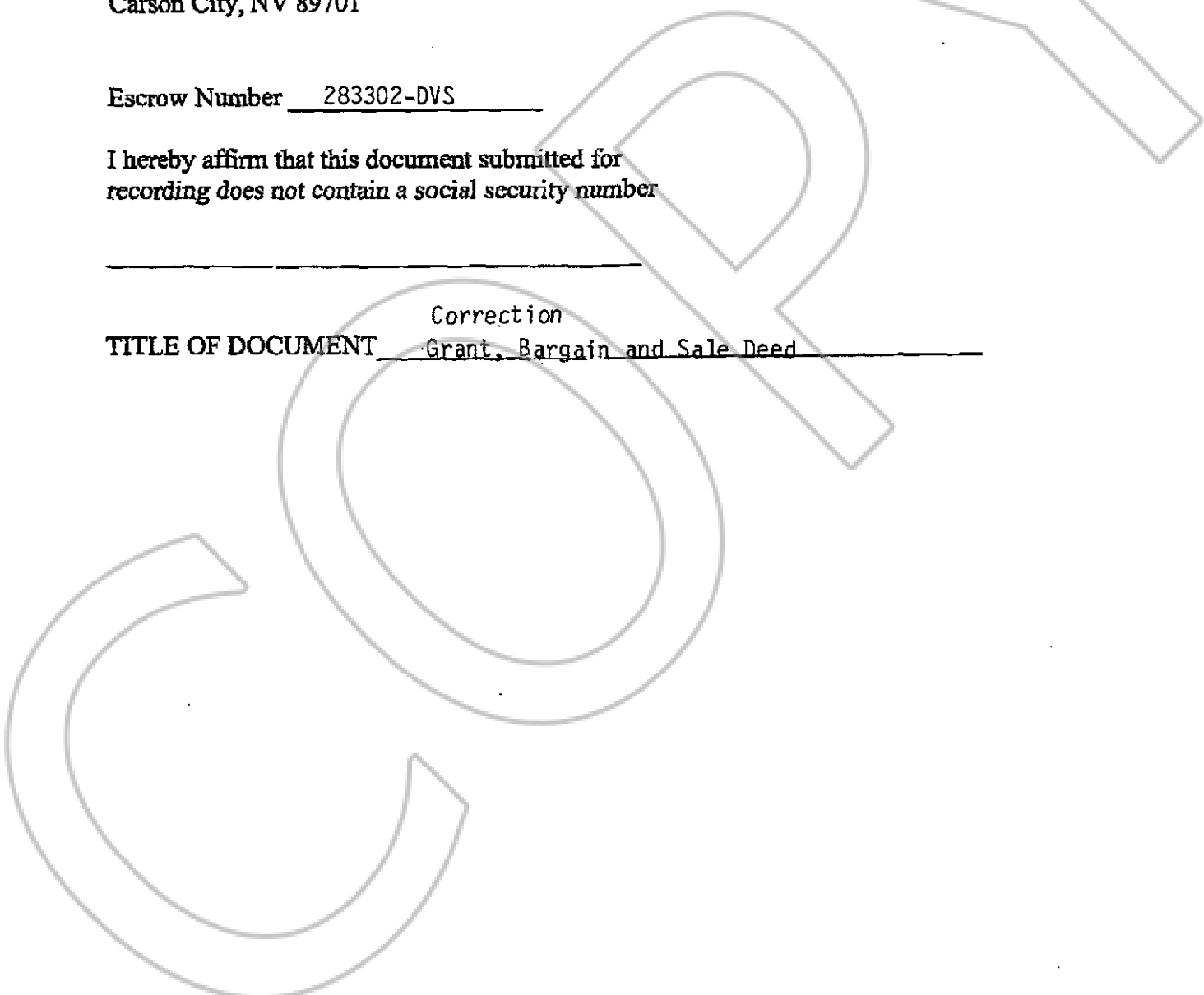

APN: 1022-32-110-029

R.P.T.T. #7

Douglas County - NV
Werner Christen - Recorder
Page: 1 Of 3 Fee: 16.00
BK-0708 PG- 3177 RPIT: # 7

✓ RETURN RECORDED DEED TO:
Phyllis Shakespeare
2020 Comstock
Gardnerville, NV 89410



GRANTEE/MAIL TAX STATEMENTS TO:
same as above

CORRECTION GRANT, BARGAIN AND SALE DEED

THIS INDENTURE, made this 16th day of July,
2008, by and between Phyllis D. Shakespeare, a widow, alas
Grantor, and Shakespeare Family Trust,
and Phyllis D. Shakespeare, as Trustee, Grantee.
Phyllis D. Shakespeare Successor Trustee of The Shakespeare Family Living
Trust Agreement dated **WITNESSETH**
September 29, 2003, Grantee

That Grantor, in consideration of the sum of Ten Dollars (\$10), lawful money of
the United States, and good and valuable consideration, paid to Grantor by Grantee, the
receipt whereof is hereby acknowledged, does by these presents grant, bargain, and
sell to Grantee and to Grantee's successors and assigns, all that certain lot, piece, or
parcel of land situated in Nevada, County of Douglas,
State of Nevada, and more particularly described as follows:

See attached exhibit "A"

TOGETHER WITH all and singular the tenements, hereditaments, and
appurtenances thereunto belonging or in anywise appertaining, and the reversion and
reversions, remainder or remainders, rents, issues, and profits thereof.



Grant, Bargain & Sale Deed

State of Nevada
County of Douglas County

This instrument was acknowledged by me on July 16, 2008, by Phyllis D. Shakespeare.

Phyllis D. Shakespeare

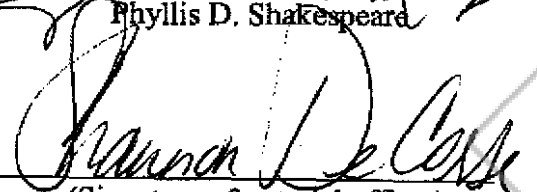

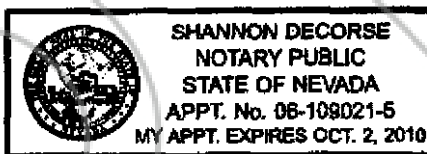
(Signature of notarial officer)



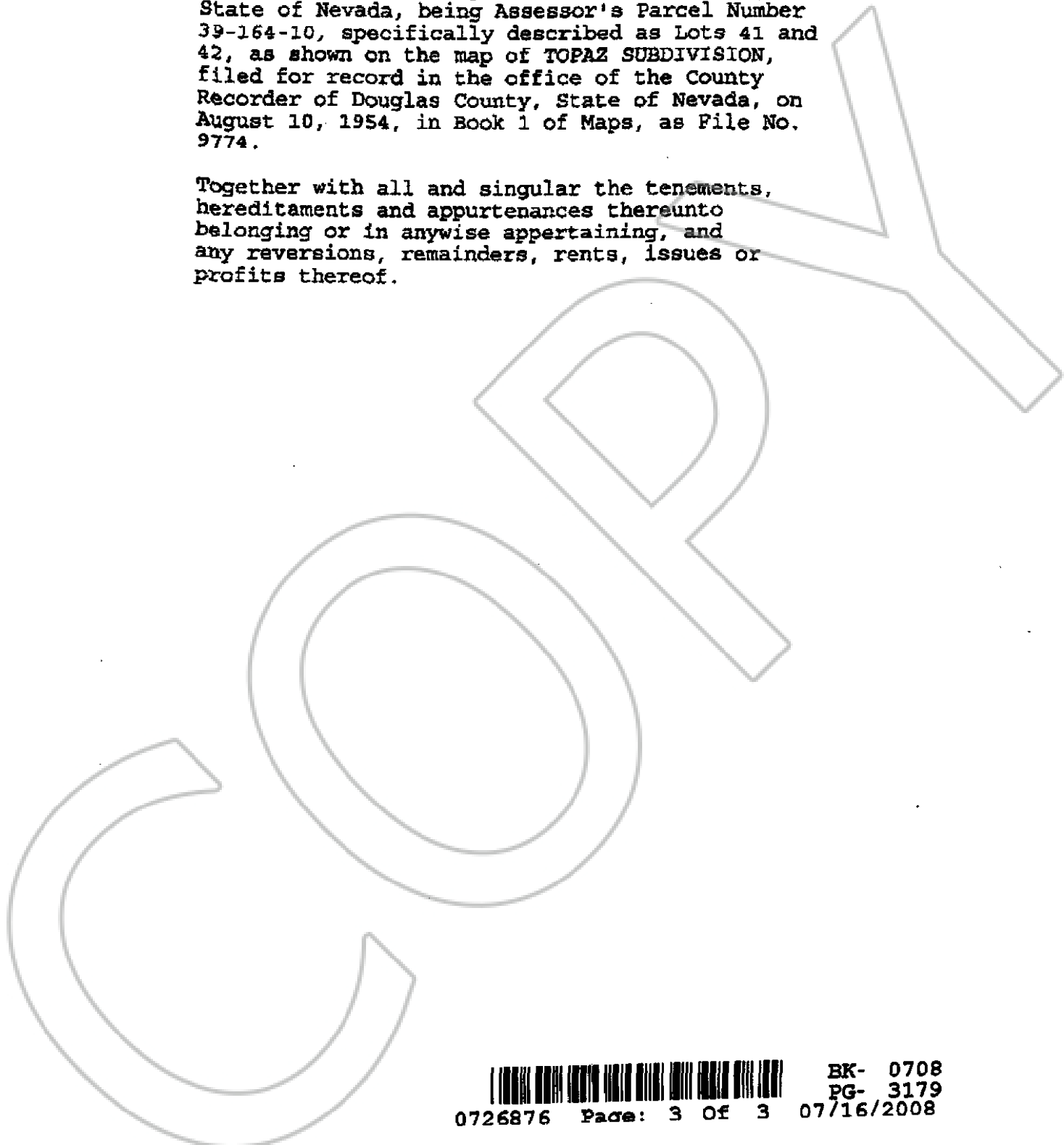

ATTACHMENT "A"

All that real property in the County of Douglas, State of Nevada, being Assessor's Parcel Number 39-164-10, specifically described as Lots 41 and 42, as shown on the map of TOPAZ SUBDIVISION, filed for record in the office of the County Recorder of Douglas County, State of Nevada, on August 10, 1954, in Book 1 of Maps, as File No. 9774.

Together with all and singular the tenements, hereditaments and appurtenances thereunto belonging or in anywise appertaining, and any reversions, remainders, rents, issues or profits thereof.



 BK- 0708
PG- 3179
0726876 Page: 3 Of 3 07/16/2008

 BK- 1106
PG- 4293
0688476 Page: 3 Of 3 11/13/2006

 BK-808
PG-778
728004 Page: 4 of 4 08/05/2008