

A.P.N. #	1220-01-001-072
R.P.T.T.	
Escrow No.	1010558-TA
Recording Requested By:	
	
Mail Tax Statements To:	Same as below
When Recorded Mail To:	
Mr. and Mrs. Francisco J. Sanchez	
1905 Janelle Ct.	
Gardnerville, NV 89410	

Douglas County - NV
 Werner Christen - Recorder
 Page: 1 of 2 Fee: 15.00
 BK-0808 PG- 3170 RPTT: # 3





GRANT, BARGAIN, SALE DEED

THIS INDENTURE WITNESSETH: That for valuable consideration, the receipt of which is hereby acknowledged, Francisco Sanchez and Marisol A. Sanchez, husband and wife does hereby Grant, Bargain Sell and Convey to Francisco J. Sanchez and Marisol A. Sanchez, husband and wife, as Joint Tenants, all that real property situated in the County of Douglas, State of Nevada, bounded and described as follows:

See Exhibit "A" attached hereto and by reference made a part hereof for complete legal description.

Together with all and singular the tenements, hereditaments and appurtenances thereunto belonging or in anywise appertaining, and any reversions, remainders, rents, issues or profits thereof.

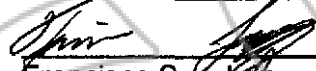
Dated: 8-14-08

 Francisco Sanchez

 Marisol A. Sanchez

State of Nevada }
 County of Douglas } ss.

This instrument was acknowledged before me on 8/14/08
 by: Francisco Sanchez and Marisol A. Sanchez

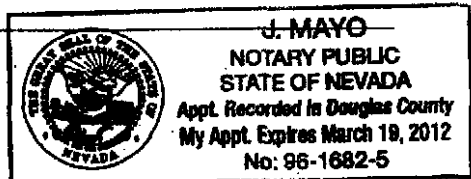
Signature: 
 Notary Public



**Exhibit A
LEGAL DESCRIPTION**

File Number: 1010558

Lot Eight (8) as shown on Final Subdivision Map PD #00-15 for **Bristlecone Pine Estates**, filed for record in the office of the County Recorder of Douglas County, State of Nevada, on January 30, 2003, in Book 0103, Page 12669 as Document No. 565599, Official Records of Douglas County, Nevada.

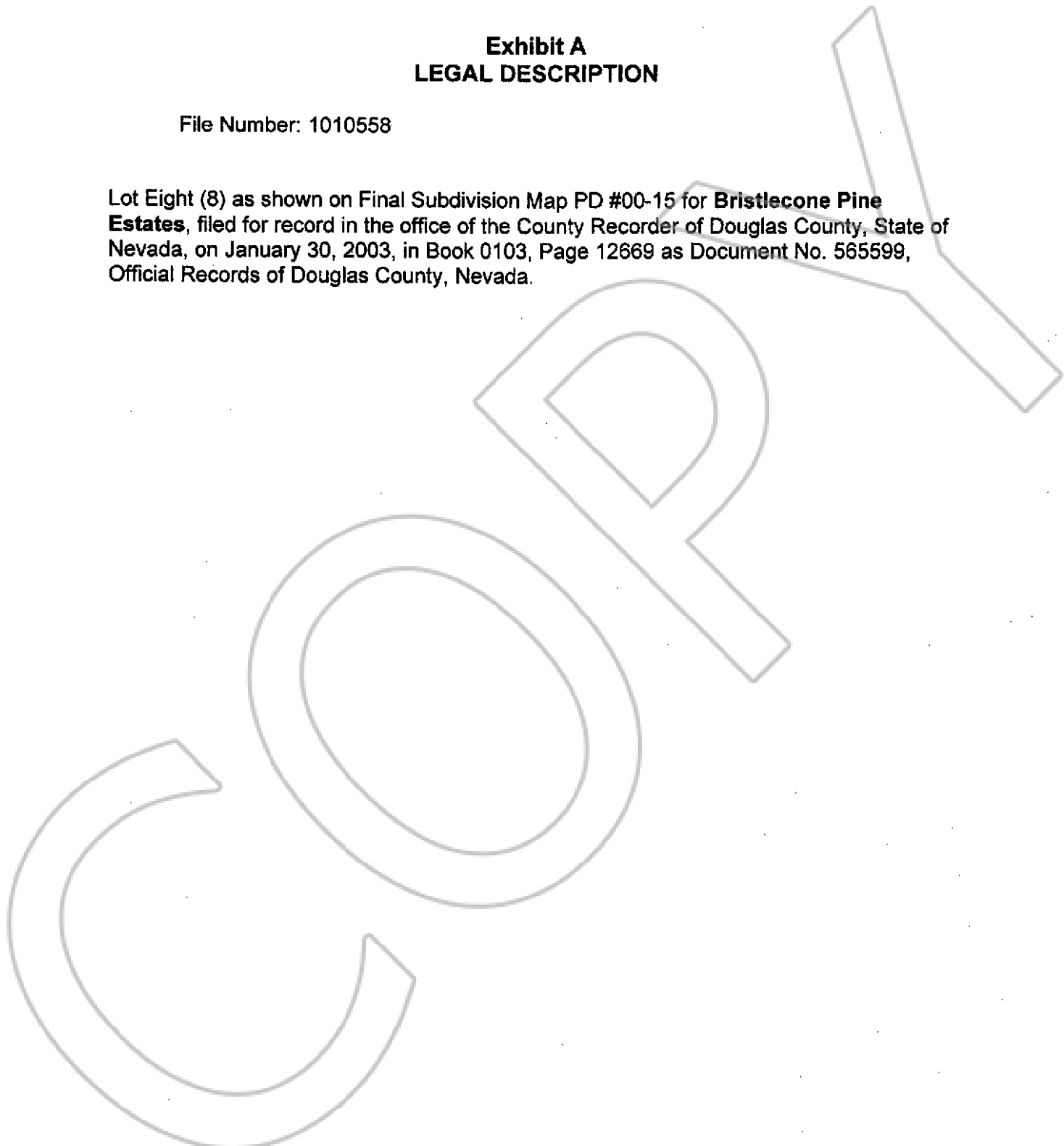

(One Inch Margin on all sides of Document for Recorder's use Only)

Page 2 of 2



BK-808
PG-3171

728635 Page: 2 of 2 08/19/2008