

DOC # 729122  
 08/29/2008 10:44AM Deputy: SD  
**OFFICIAL RECORD**  
 Requested By:  
 STEWART TITLE - DOUGLAS  
 Douglas County - NV  
 Werner Christen - Recorder  
 Page: 1 of 2 Fee: 15.00  
 BK-808 PG-5186 RPTT: 1,189.50

A.P.N. #	1420-33-312-006
R.P.T.T.	\$1,189.50
Escrow No.	1010482TA
<b>Recording Requested By:</b>	
	
Mail Tax Statements To:	Same as below
<b>When Recorded Mail To:</b>	
Tommy W. Kerns	
2686 Poncho Court	
Minden, NV 89423	



**GRANT, BARGAIN, SALE DEED**

THIS INDENTURE WITNESSETH: That Heidi R. Kramer, a married woman as her sole and separate property for valuable consideration, the receipt of which is hereby acknowledged, does hereby Grant, Bargain Sell and Convey to **Tommy W. Kerns and Jodeen A. Kerns, husband and wife as joint tenants**, all that real property situated in the County of Douglas, State of Nevada, bounded and described as follows:

See Exhibit "A" attached hereto and by reference made a part hereof for complete legal description.

Together with all and singular the tenements, hereditaments and appurtenances thereunto belonging or in anywise appertaining, and any reversions, remainders, rents, issues or profits thereof.

Dated: 8/4/2008

Heidi R. Kramer  
 Heidi R. Kramer

State of Nevada }  
 County of Douglas } ss.

This instrument was acknowledged before me on 8/8/08  
 by: Heidi R. Kramer

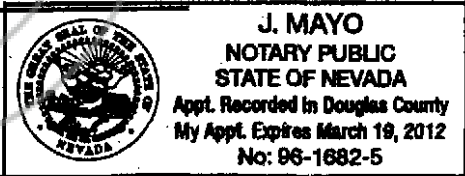

Signature: J. Mayo  
 Notary Public

**Exhibit A  
LEGAL DESCRIPTION**

File Number: 1010482

Lot 159, as shown on the Final Map of WILDHORSE UNIT 6, a planned unit development, filed for record in the Office of the County Recorder of Douglas County, State of Nevada, on March 15, 1994 in Book 394, Page 2741 as Document No. 332336.

Assessors Parcel No. 1420-33-312-006

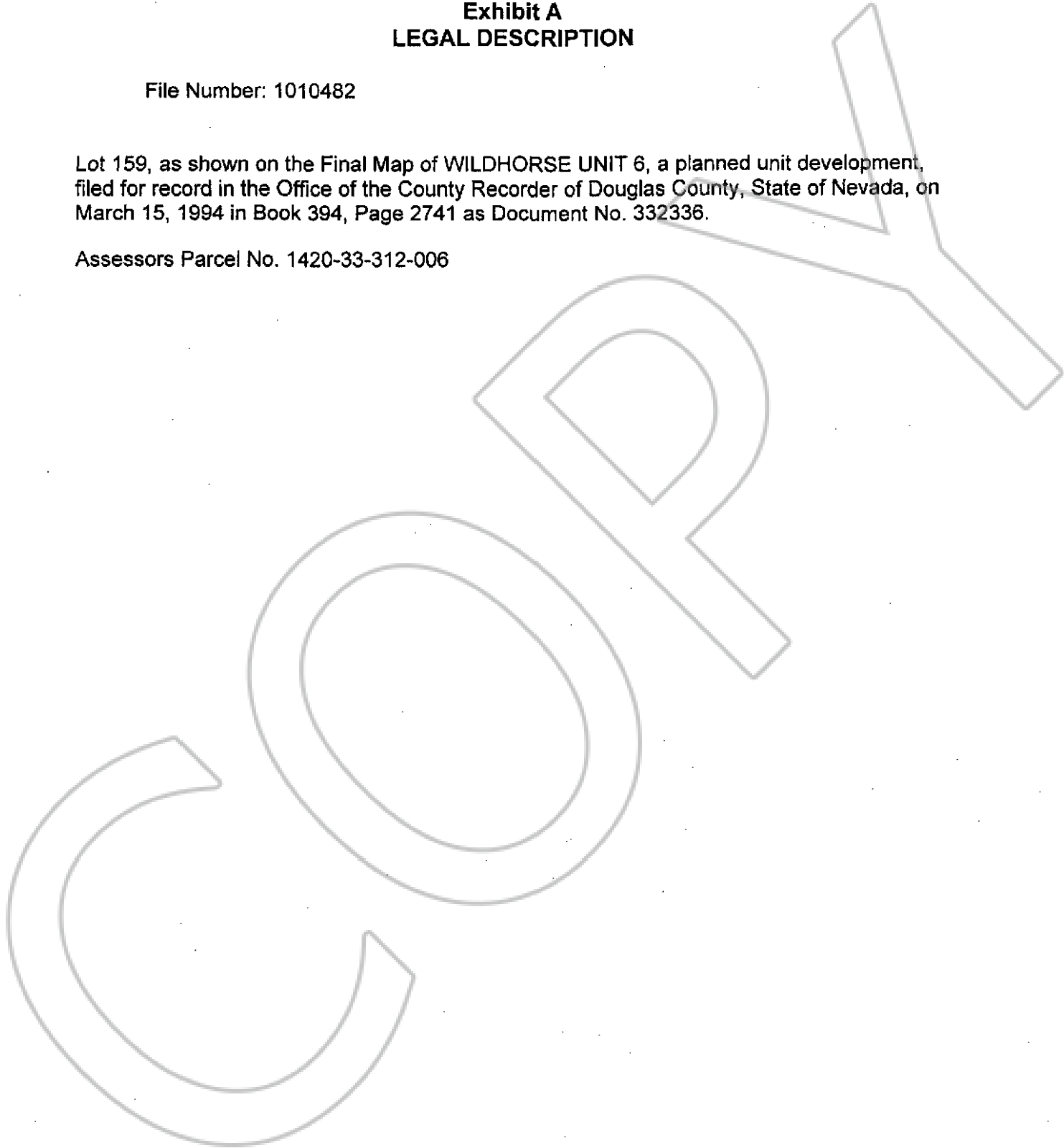

(One Inch Margin on all sides of Document for Recorder's use Only)

Page 2 of 2



BK-808  
PG-5187

729122 Page: 2 of 2 08/29/2008