



DOC # 729752
 09/10/2008 02:44PM Deputy: EM
OFFICIAL RECORD
 Requested By:
 STEWART TITLE - DOUGLAS
 Douglas County - NV
 Karen Ellison - Recorder
 Page: 1 of 2 Fee: 15.00
 BK-908 PG-1968 RPTT: 1,123.20



A.P.N. #	1220-03-201-005
R.P.T.T.	\$1,123.20
Escrow No.	1011003TA
Recording Requested By:	
 	
Mail Tax Statements To:	Same as below
When Recorded Mail To:	
Doug Maatman	
1339 Elges	
Gardnerville, NV 89410	

GRANT, BARGAIN, SALE DEED

THIS INDENTURE WITNESSETH: That James P. McGoldrick, a married man as his sole and separate property for valuable consideration, the receipt of which is hereby acknowledged, does hereby Grant, Bargain Sell and Convey to

Douglas J. Maatman, a single man

, all that real property situated in the County of Douglas, State of Nevada, bounded and described as follows:

See Exhibit "A" attached hereto and by reference made a part hereof for complete legal description.

Together with all and singular the tenements, hereditaments and appurtenances thereunto belonging or in anywise appertaining, and any reversions, remainders, rents, issues or profits thereof.

Dated: 8/27/2008



 James P. McGoldrick

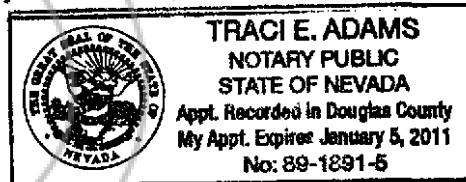

State of Nevada }
 } ss.
 County of Douglas }

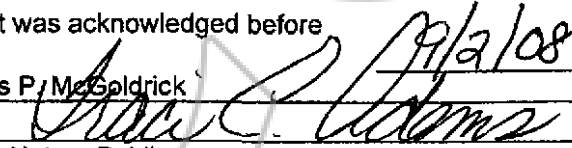
This instrument was acknowledged before me on
 by: James P. McGoldrick 8/27/08
 Signature: 

 Notary Public

**Exhibit A
LEGAL DESCRIPTION**

File Number: 1011003

A parcel of land located within a portion of the Northwest $\frac{1}{4}$ of Section 3, Township 12 North, Ranch 20 East, Mount Diablo Meridian, more particularly described as follows:

Parcel 3 of Parcel Map LDA 01-044 for Crestmore Village Apartments *Limited Partnership* filed for record September 4, 2001, in Book 0901, at Page 66, Document No. 522015, of Official Record.

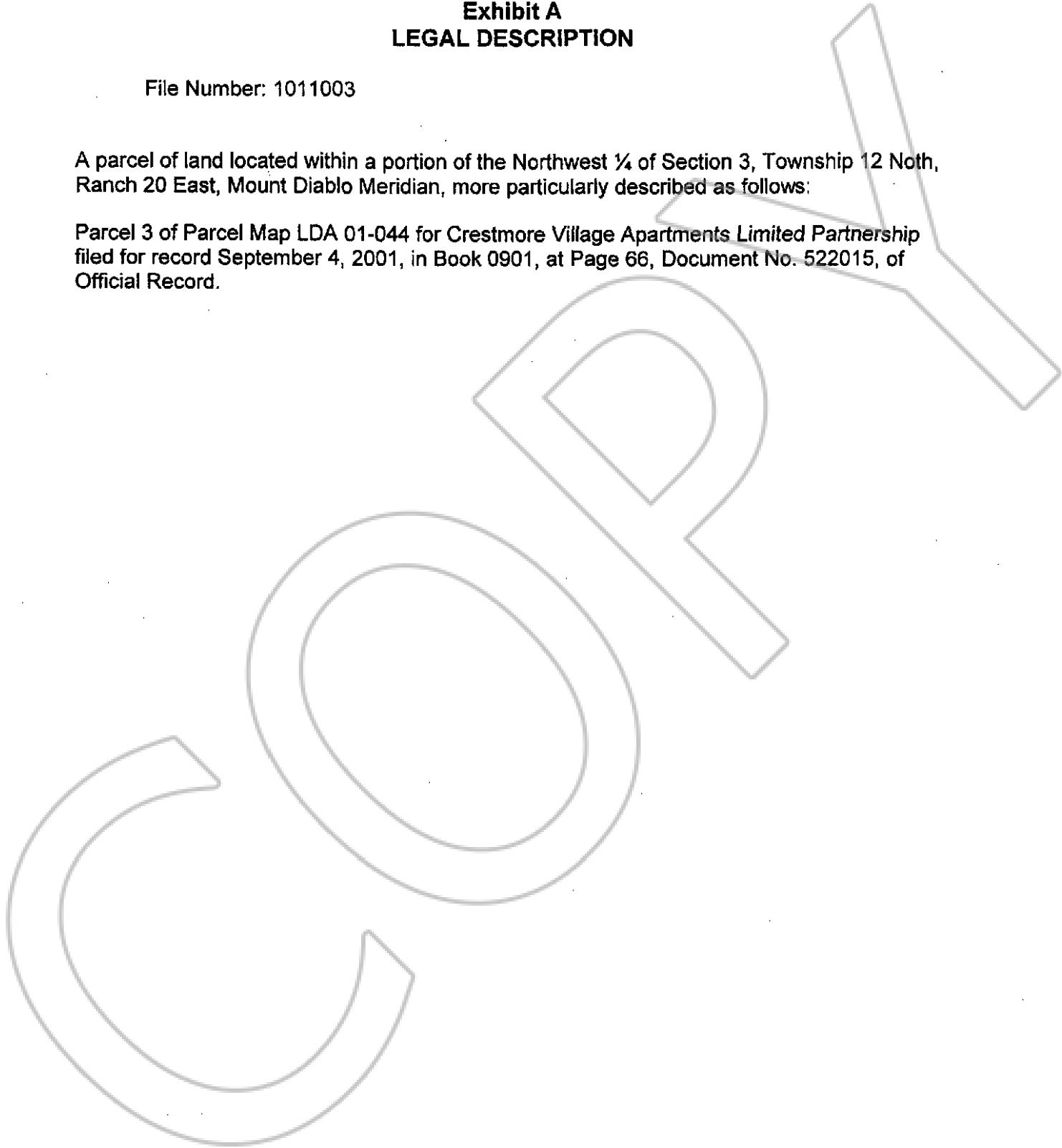

(One Inch Margin on all sides of Document for Recorder's use Only)

Page 2 of 2



BK-908
PG-1969

729752 Page: 2 of 2 09/10/2008