

DOC # 729869  
 09/11/2008 02:16PM Deputy: DW  
**OFFICIAL RECORD**  
 Requested By:  
 STEWART TITLE - DOUGLAS  
 Douglas County - NV  
 Karen Ellison - Recorder  
 Page: 1 of 2 Fee: 15.00  
 BK-908 PG-2475 RPTT: 2,160.60

A.P.N. #	1420-35-311-012
R.P.T.T.	\$2,160.60
Escrow No.	1004046WD DR
<b>Recording Requested By:</b>	
	
Mail Tax Statements To:	Same as below
<b>When Recorded Mail To:</b>	
Mr. & Mrs. Meyer	
1714 GEORGE WAY RALPHEN, NV 89423	



**GRANT, BARGAIN, SALE DEED**

THIS INDENTURE WITNESSETH: That Skyline Ranch III, LLC, a Nevada limited liability company for valuable consideration, the receipt of which is hereby acknowledged, does hereby Grant, Bargain Sell and Convey to John A. Meyer and Michelle M. Meyer, husband and wife AS JOINT TENANTS

and to the heirs and assigns of such Grantee forever, all that real property situated in the County of Douglas, State of Nevada, bounded and described as follows:

See Exhibit "A" attached hereto and by reference made a part hereof for complete legal description.

Together with all and singular the tenements, hereditaments and appurtenances thereunto belonging or in anywise appertaining, and any reversions, remainders, rents, issues or profits thereof.

Dated: March 7, 2008

Skyline Ranch III, LLC  
 a Nevada limited liability company

BY:   
 By Syncon Homes, managing member  
 Mike Lemke, President

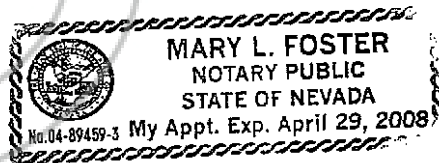

State of Nevada }  
 County of Douglas } ss.  
 This instrument was acknowledged before me on March 21, 2008  
 By: Mike Lemke  
 Signature:   
 Notary Public

**Exhibit A  
LEGAL DESCRIPTION**

File Number: 1004046

Lot 122, as set forth on the Final Subdivision Map FSM #94-04-03 for SKYLINE RANCH PHASE 3 filed for record with the Douglas County Recorder on July 5, 2005 in Book 0705 of Official Records, Page 1491, as Document No. 648689.

ASSESSORS PARCEL NO. 1420-35-311-012

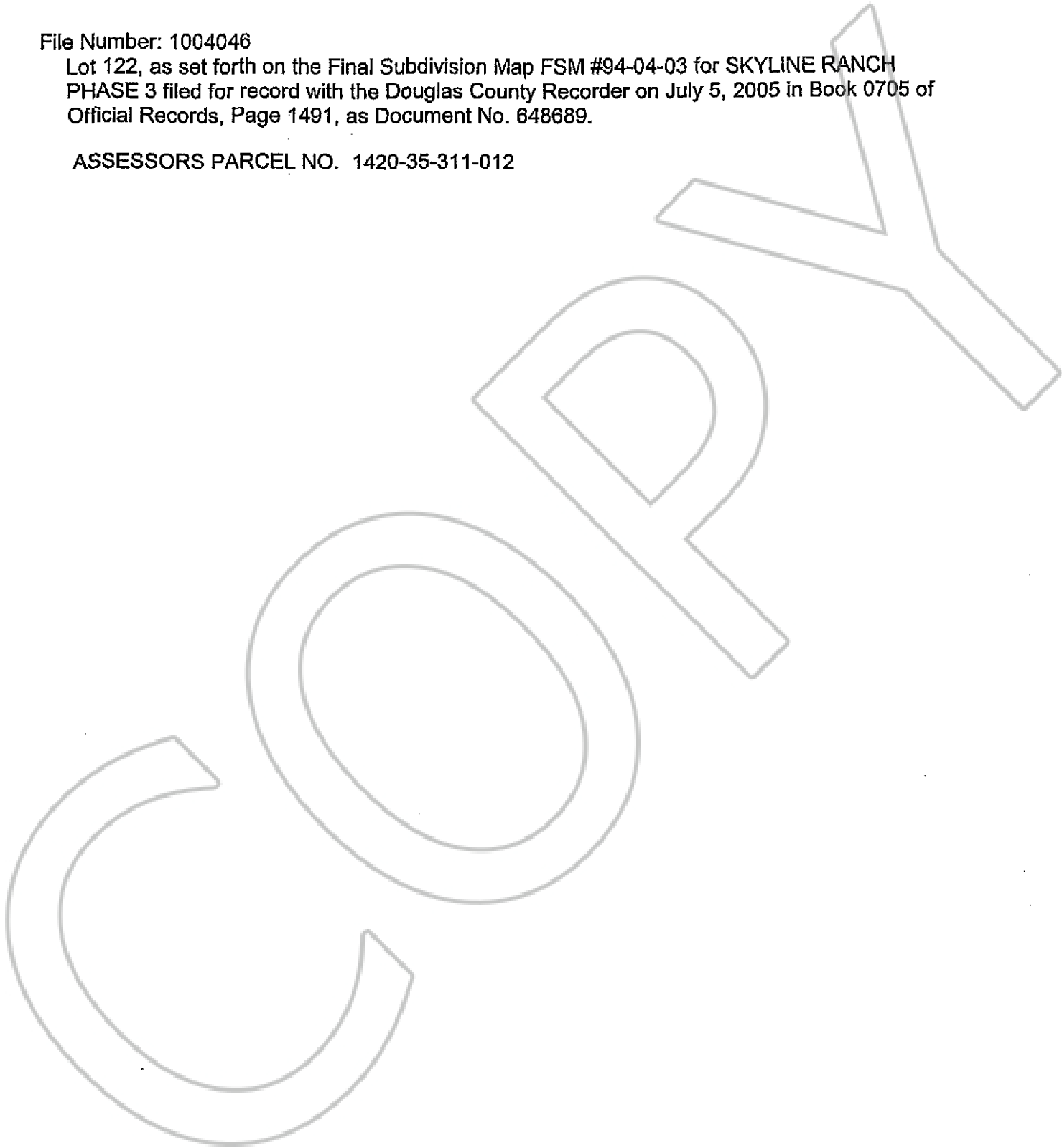

**(One Inch Margin on all sides of Document for Recorder's Use Only**

**Page 2 of 2**



729869 Page: 2 of 2 09/11/2008

BK-908  
PG-2476