

OFFICIAL RECORD

Requested By:
ANDERSON & DORN

This document does not contain a social security number.

Eden R. Thome
Eden Thome

Douglas County - NV
Karen Ellison - Recorder

Page: 1 Of 3 Fee: 16.00
BK-1008 PG- 968 RPTT: # 3



APN: 1318-10-416-027

RECORDING REQUESTED BY:

Gerald M. Dorn, Esq.
Anderson, Dorn & Rader, Ltd.
500 Damonte Ranch Parkway, Suite 860
Reno, Nevada 89521

AFTER RECORDING MAIL TO:

DAVID ALLEN EVANS and MARVELLE STARRE EVANS
P.O. Box 12297
Zephyr Cove, Nevada 89448

MAIL TAX STATEMENT TO:

DAVID ALLEN EVANS and MARVELLE STARRE EVANS
P.O. Box 12297
Zephyr Cove, Nevada 89448

RPTT: \$0.00 Exempt (3)

Exempt (3): A transfer of title recognizing true status of ownership, same to same, joint tenant to community property; made without consideration.

GRANT, BARGAIN, SALE DEED

THIS INDENTURE WITNESSETH THAT,

DAVID ALLEN EVANS and MARVELLE STARRE EVANS,
husband and wife, as joint tenants

For NO consideration, do hereby Grant, Bargain, Sell and Convey unto:

DAVID ALLEN EVANS and MARVELLE STARRE EVANS,
husband and wife, as community property

ALL that real property situated in the County of Douglas, State of Nevada, more particularly described in Exhibit "A", attached hereto and incorporated herein, together with all and singular the tenements, hereditaments, and appurtenances thereunto belonging or in anywise appertaining, and any reversions, remainders, rents, issues of profits thereof.

Subject To: 1. Taxes for the Current fiscal year, paid current
4. Restrictions, Conditions, Covenants, Rights, Rights of Way, and Easements now of record, if any.

This deed was prepared without the benefit of a title search and the description of the property was furnished by the parties. The preparer of this deed assumes no liability whatsoever either for the accuracy of the legal description or the status of the title to the property.

WITNESS our hands, this 25th day of August, 2008.

David Allen Evans

DAVID ALLEN EVANS

Marvelle Starre Evans

MARVELLE STARRE EVANS

STATE OF NEVADA }
 }
 } ss:
COUNTY OF WASHOE }

This instrument was acknowledged before me, this 25th day of August, 2008, by DAVID ALLEN EVANS and MARVELLE STARRE EVANS.

Ed R. Thome

Notary Public

 EDEN R. THOME
Notary Public - State of Nevada
Appointment Recorded in Washoe County
No: 07-2338-2 - Expires March 15, 2011

EXHIBIT "A"

Legal Description:

Lot 19, in Block 5, as shown on the Plat of the SECOND ADDITION TO ZEPHYR HEIGHTS SUBDIVISION, according to the filed map recorded in the Office of the County Recorder of Douglas County, Nevada, on July 6, 1948, in Book 1 of Maps, as File No. 6530.

APN: 1318-10-416-027

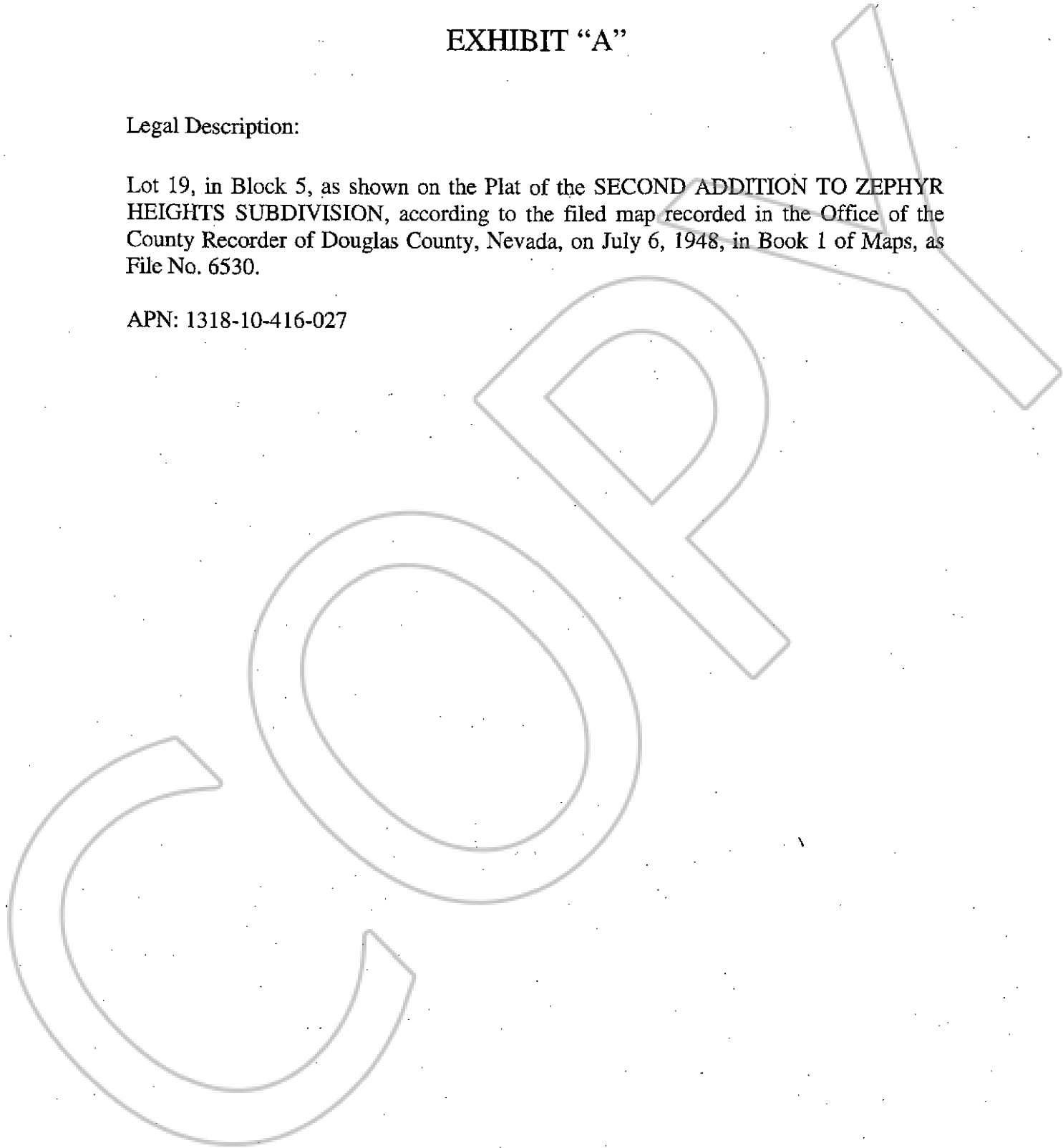

BK-1008
PG-970