



APN#: 1220-22-410-088

Recording Requested By:
Western Title Company, Inc.
Escrow No.: 021146-LMS

When Recorded Mail To:
Nanci D. Lemburg
1453 Sally Lane
Gardnerville, NV
89460

Mail Tax Statements to: (deeds only)

(space above for Recorder's use only)

I the undersigned hereby affirm that the attached document, including any exhibits, hereby submitted for recording does not contain the social security number of any person or persons.
(Per NRS 239B.030)

Signature

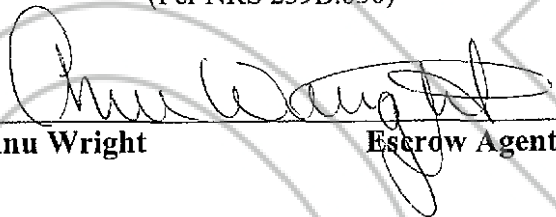

Anu Wright **Escrow Agent**

Declaration of Homestead

This document is being re-recorded to correct the legal description.

This page added to provide additional information required by NRS 111.312
(additional recording fee applies)

APN#: 1220-22-410-088

DOC # 731732
10/22/2008 09:26AM Deputy: KE
OFFICIAL RECORD
Requested By:
WESTERN TITLE INC CARSON
Douglas County - NV
Karen Ellison - Recorder
Page: 1 of 3 Fee: 16.00
BK-1008 PG-3233 RPTT: 0.00

Recording Requested By:

Western Title Company, Inc.

Escrow# 021146-LMS

When Recorded Mail To:

Nanci D. Lemburg
1453 Sally Lane
Gardnerville, NV
89460

Mail Tax Statements to: (deeds only)

(space above for Recorder's use only)

I the undersigned hereby affirm that the attached document, including any exhibits, hereby submitted for recording does not contain the social security number of any person or persons.
(Per NRS 239B.030)

Signature Nanci D. Lemburg
NANCI D. LEMBURG *owner*

Declaration of Homestead

This page added to provide additional information required by NRS 111.312
(additional recording fee applies)



BK-1108
PG-4057

APN#: 1220-22-410-088

Recording Requested By:

Western Title Company, Inc.

Escrow# 021146-LMS

When Recorded Mail To:

Nanci D. Lemburg
1453 Sally Lane
Charlottesville, VA
89460

Recorded Electronically
ID 1008-3233 731732
County Douglas
Date 10-22-08 Time 9:26
Simplifile.com 800.460.5657

Mail Tax Statements to: (deeds only)

(space above for Recorder's use only)

I the undersigned hereby affirm that the attached document, including any exhibits, hereby submitted for recording does not contain the social security number of any person or persons.

(Per NRS 239B.030)

Signature Nanci D. Lemburg
NANCI D. LEMBURG owner

Declaration of Homestead

This page added to provide additional information required by NRS 111.312
(additional recording fee applies)



BK-1108
PG-4058

DECLARATION OF HOMESTEAD

KNOW ALL MEN BY THESE PRESENTS:

That I, Nanci D Lemburg and do hereby certify and declare as follows:

That I now actually residing on the land and premises hereinafter described, consisting of the land and dwelling house thereon. That I intend to use and claim the said property hereinafter described, together with the dwelling house thereon, and it's appurtenances, as a homestead.

That the property and premises herein referred to are situate in the City of Gardnerville County of Douglas, State of NV, and are described as follows:

All that certain real property situate in the County of Douglas, State of Nevada, described as follows:

Lot 85 as shown on the map of GARDNERVILLE RANCHOS UNIT NO. 7, filed for record in the office of the County Recorder of Douglas County, Nevada, on March 27, 1974, in Book 374, Page 676 as File No. 72456.

Property Commonly known as:
1453 Sally Lane, Gardnerville NV

That we do, by these presents, hereby select and claim the said premises and its appurtenances as a homestead, and that all of the said property is necessary to the use and enjoyment as a homestead.

Dated: 10/16/2008



BK-1108
PG-4059

733424 Page: 4 of 6 11/21/2008



BK-1008
PG-3234

731732 Page: 2 of 3 10/22/2008

Nanci D Lemburg
Nanci D Lemburg

STATE OF NEVADA

COUNTY OF Douglas

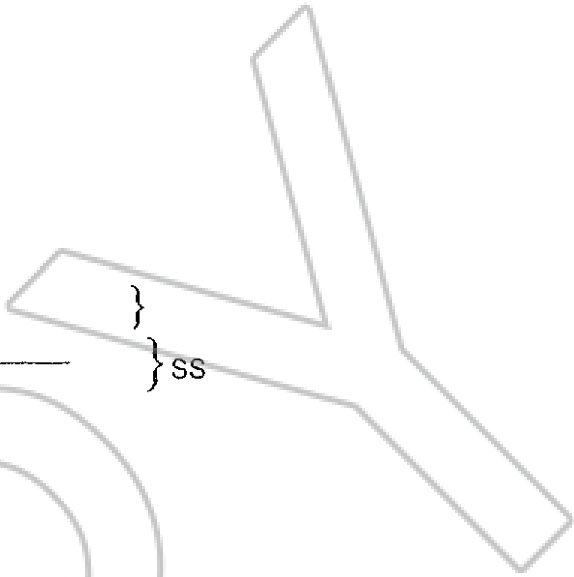

This instrument was acknowledged before me on

DEC 11 2008
by Nanci D Lemburg

Lori Mae Silva
Notary Public



BK-1108
PG-4060

733424 Page: 5 of 6 11/21/2008



BK-1008
PG-3235

731732 Page: 3 of 3 10/22/2008

EXHIBIT "A"

All that certain real property situate in the County of Douglas, State of Nevada, described as follows:

Lot 865 as shown on the map of GARDNERVILLE RANCHOS UNIT NO. 7, filed for record in the office of the County Recorder of Douglas County, Nevada, on March 27, 1974, in Book 374, Page 676 as File No. 72456.

TOGETHER WITH an easement for surface drainage over Lot 886, as shown in Easement Deed recorded February 17, 1988, in Book 288, Page 2283, as Document No. 172684.

**Assessor's Parcel Number(s):
1220-22-410-088**

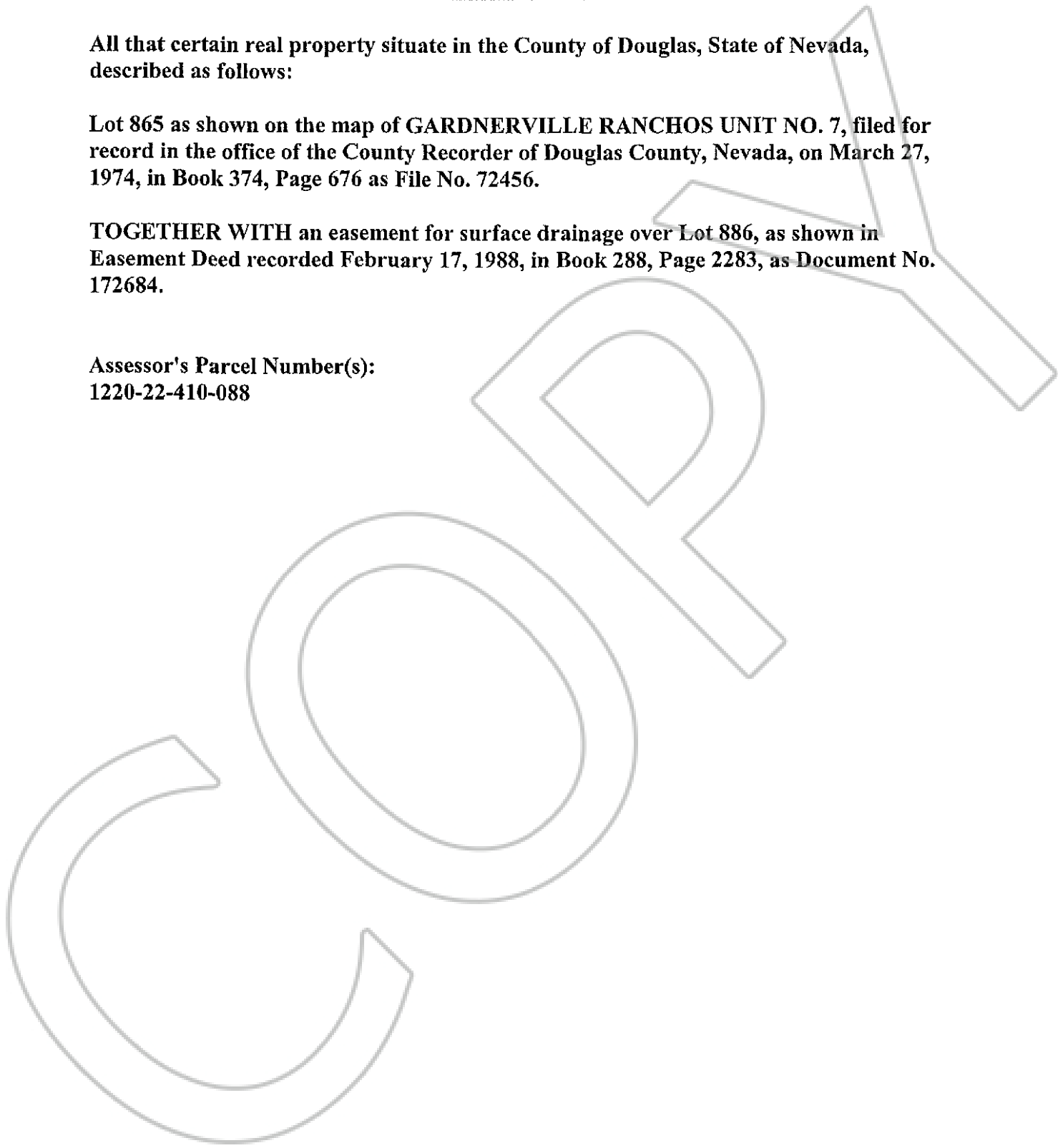

BK-1108
PG-4061