

OFFICIAL RECORD

Requested By:
SHANAE LIGGETT

A.P.N.: 1420-34-310-029

R.P.T.T. _____

Douglas County - NV
Karen Ellison - Recorder

Page: 1 Of 2 Fee: 15.00
BK-0109 PG- 3682 RPTT: # 6



When recorded Mail To:
William T. Liggett
2651 Gordon Ave.
Minden, NV 89423

GRANT, BARGAIN AND SALE DEED

THIS INDENTURE WITNESSETH: That for a valuable consideration, receipt of which is hereby acknowledged, SHANAE LIGGETT do(es) hereby GRANT, BARGAIN, SELL and CONVEY to: WILLIAM T. LIGGETT, JR

All that real property situated in the County of Douglas, State of Nevada, being Assessor's Parcel Number, 1420-34-310-029, Specifically described as follows;

See attached Exhibit A

TOGETHER with all and singular the tenements, hereditaments and appurtenances, including easements, if any, thereto belonging or in anywise appertaining, and any reversions, remainders, rents, issues of profits thereof.

Witness my hand this day: Jan - 20th 2009

Shanae Liggett
Signature Shanae Liggett

STATE OF NEVADA
COUNTY OF DOUGLAS

This instrument was acknowledged before me On 1-20-09; SHANAE LIGGETT personally appeared before me, a Notary Public,

David W. Terry
Notary Public,

My Commission expires: 2-11-11

Notary Stamp

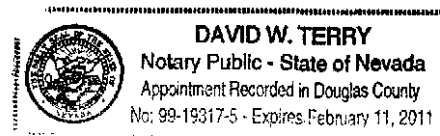

EXHIBIT "A"

LEGAL DESCRIPTION

ESCROW NO.: 020108363

Lot 15, Block 3, as shown on the Map of the ARTEMISIA
RE-SUBDIVISION, filed in the office of the County Recorder April
23, 1962, as Document No. 19909, Official Records of Douglas
County, State of Nevada.

Assessor's Parcel No. 1420-34-310-029

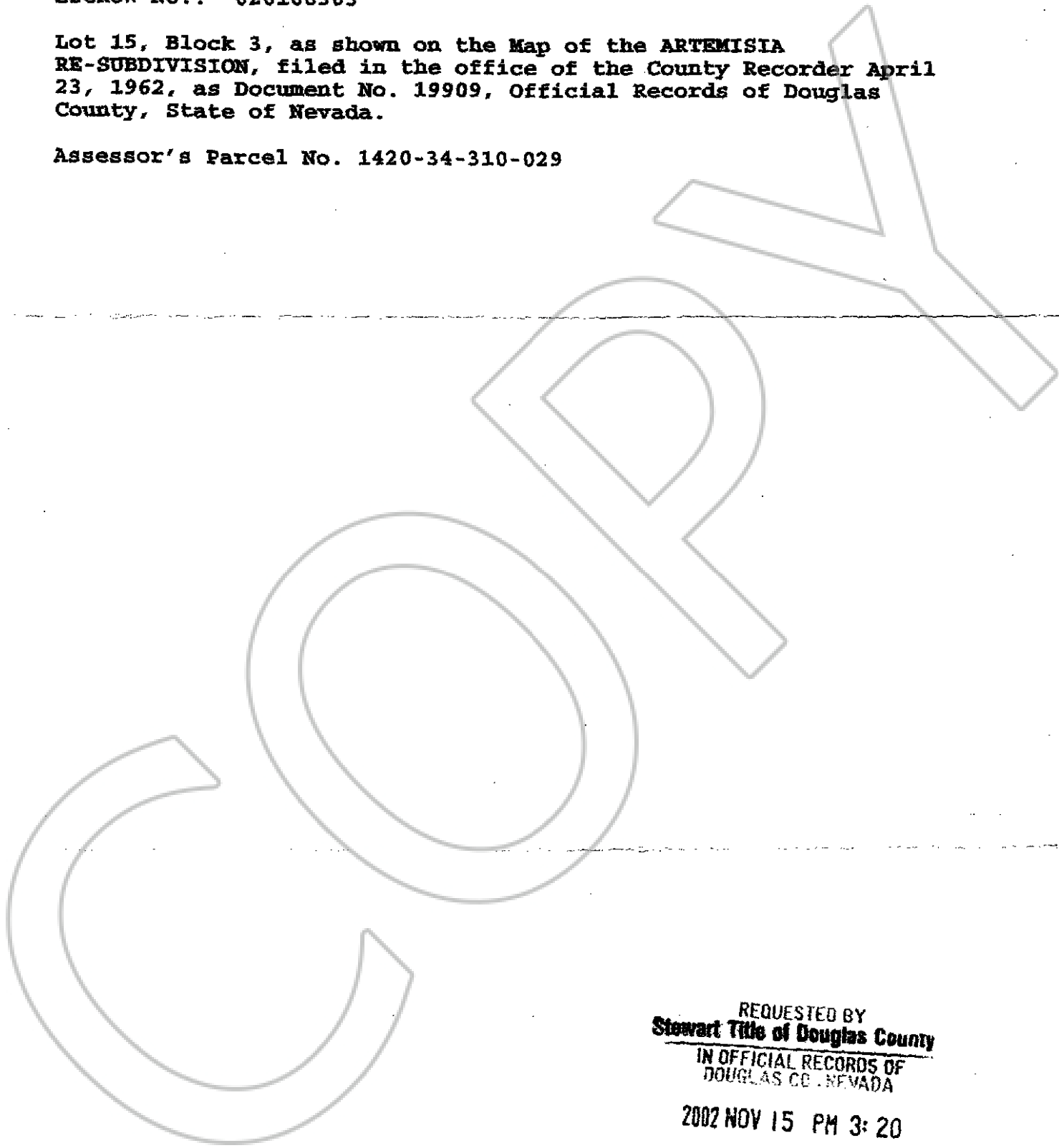

REQUESTED BY
Stewart Title of Douglas County
IN OFFICIAL RECORDS OF
DOUGLAS CO. NEVADA

2002 NOV 15 PM 3:20

LINDA SLATER
RECORDER

\$ 15⁰⁰ PAID *KJ* DEPUTY

0557940

BK- 0109
PG- 3683