

DOC # 738875
03/03/2009 09:57AM Deputy: DW
OFFICIAL RECORD
Requested By:
TICOR TITLE - RENO
Douglas County - NV
Karen Ellison - Recorder
Page: 1 of 3 Fee: 16.00
BK-309 PG-385 RPTT: 3,045.90



WHEN RECORDED MAIL TO:
Damon B. Partridge
Kristine C. Partridge
P.O. Box 1495
Zephyr Cove, Nevada 89448

MAIL TAX STATEMENTS TO:
Grantees above

Escrow No. 8008722-JN

The undersigned hereby affirms that this document submitted for recording does not contain the social security number of any person or persons.
(Pursuant to NRS 239b.030)

APN No.: 1318-15-610-034

SPACE ABOVE FOR RECORDER'S USE ONLY

R.P.T.T. \$ ~~0.00~~ ²⁰¹⁵ 15.90

GRANT, BARGAIN, SALE DEED

THIS INDENTURE WITNESSETH:

That U.S. Bank National Association as successor to Bank One, National Association, as Trustee for CSFB MORTGAGE-BACKED PASS-THROUGH CERTIFICATES, SERIES 2003-17

FOR A VALUABLE CONSIDERATION, receipt of which is hereby acknowledged, do/does hereby Grant, Bargain, Sell and Convey to

Damon B. Partridge and Kristine C. Partridge husband and wife as Joint Tenants

all that real property situated in the County of Douglas, State of Nevada, described as follows:

SEE EXHIBIT "A" ATTACHED HERETO AND BY REFERENCE MADE A PART HEREOF

Together with all and singular the tenements, hereditaments and appurtenances thereunto belonging or in anywise appertaining.

U.S. Bank, National Association as successor
to Bank One, National Association, as Trustee
for Csfb MORTGAGE-BACKED PASS-
THROUGH CERTIFICATES, SERIES 2003-17

By: [Signature]

Its: Loan Documentation

STATE OF Maryland
COUNTY OF Frederick

} ss:

This instrument was acknowledged before me on February 27, 2009

by Jennifer Presley

[Signature]
NOTARY PUBLIC

RACHAEL A. HOOVER
NOTARY PUBLIC
FREDERICK COUNTY
MARYLAND
MY COMMISSION EXPIRES JULY 26, 2011



BK-309
PG-386

Escrow No. 8008722-JN

**EXHIBIT A
LEGAL DESCRIPTION**

All that certain real property situate in the County of Douglas, State of Nevada, described as follows:

Lot 20, in Block B of ROUND HILL VILLAGE UNIT NO. 3, according to the map thereof, filed in the office of the County Recorder of Douglas County, Nevada, on November 24, 1965, as Document No. 30185.

APN: 1318-15-610-034

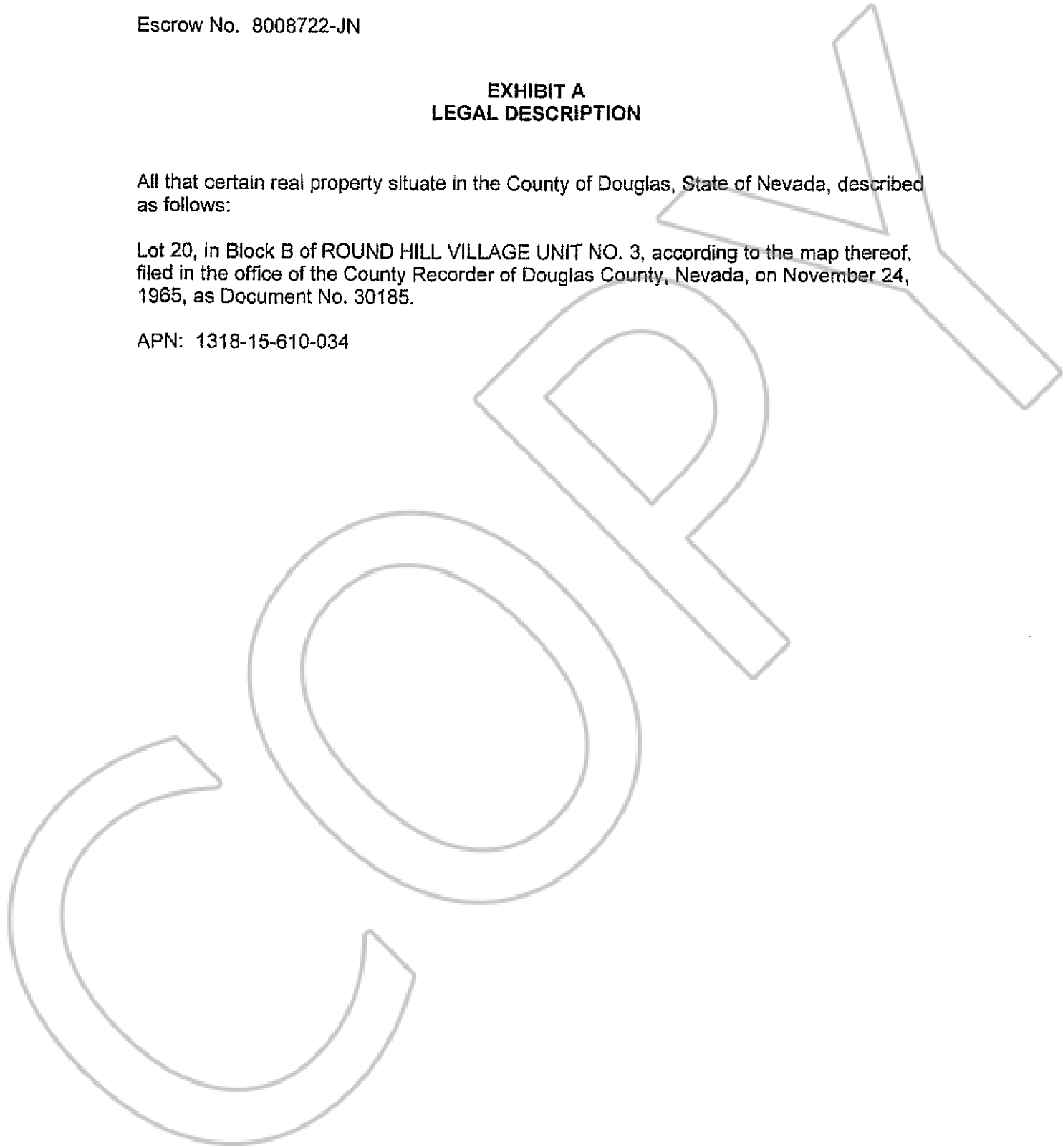

BK-309
PG-387