

DOC # 0741394  
04/15/2009 10:44 AM Deputy: SD  
OFFICIAL RECORD  
Requested By:  
NORTHERN NEVADA TITLE CC

A.P.N. 1220-13-801-011  
Escrow No.: DO-2090210-WD  
1090542

RECORDING REQUESTED BY:

MAIL TAX STATEMENTS AND WHEN  
RECORDED, MAIL TO:

Ms. Olsen  
840 Regalia Ct.

Gardnerville, NV 89410

Douglas County - NV  
Karen Ellison - Recorder  
Page: 1 Of 2 Fee: 15.00  
BK-0409 PG- 3789 RPTT: # 7



THIS SPACE FOR RECORDER'S USE ONLY

The undersigned grantor(s) declare(s): Documentary transfer tax is 0, exemption no. ~~8~~ 7

**GRANT, BARGAIN, SALE DEED**

That Beverly A. Olsen, Successor Trustee of the Olsen Family Trust in consideration of \$10.00 Dollars, the receipt of which is hereby acknowledged, do(es) hereby Grant, Bargain, Sell and Convey to Beverly Ann Olsen, Successor Trustee of the Olsen Family Trust dated August 22, 1990 all that real property in the County of Douglas, State of Nevada, bounded and described as follows:

**SEE EXHIBIT "A" ATTACHED HERETO AND MADE A PART HEREOF**

Together with all singular the tenements, hereditaments and appurtenances thereunto belonging or in anywise appertaining.

Dated: March 25, 2009

The Olsen Family Trust

Beverly A. Olsen, Trustee

STATE OF NEVADA )

COUNTY OF DOUGLAS )

On 4-10-09 personally appeared before me, a Notary Public, Beverly A. Olsen who acknowledged that she executed the above instrument.

Signature   
(Notary Public)

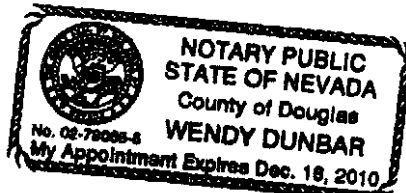

**DO-2090210-WD  
1090542**

**EXHIBIT "A"**

All that certain real property situate in the County of Douglas, State of Nevada, described as follows:

A portion of the Southeast  $\frac{1}{4}$  of Section 13, Township 12 North, Range 20 East, M.D.B.&M., further described as follows:

Parcel 4D-4A, as set forth in Parcel Map #4 for Jerry E. Tilley, filed for record in the office of the County Recorder of Douglas County, State of Nevada, on April 6, 1993, in Book 493, at Page 425, as Document No. 303898.

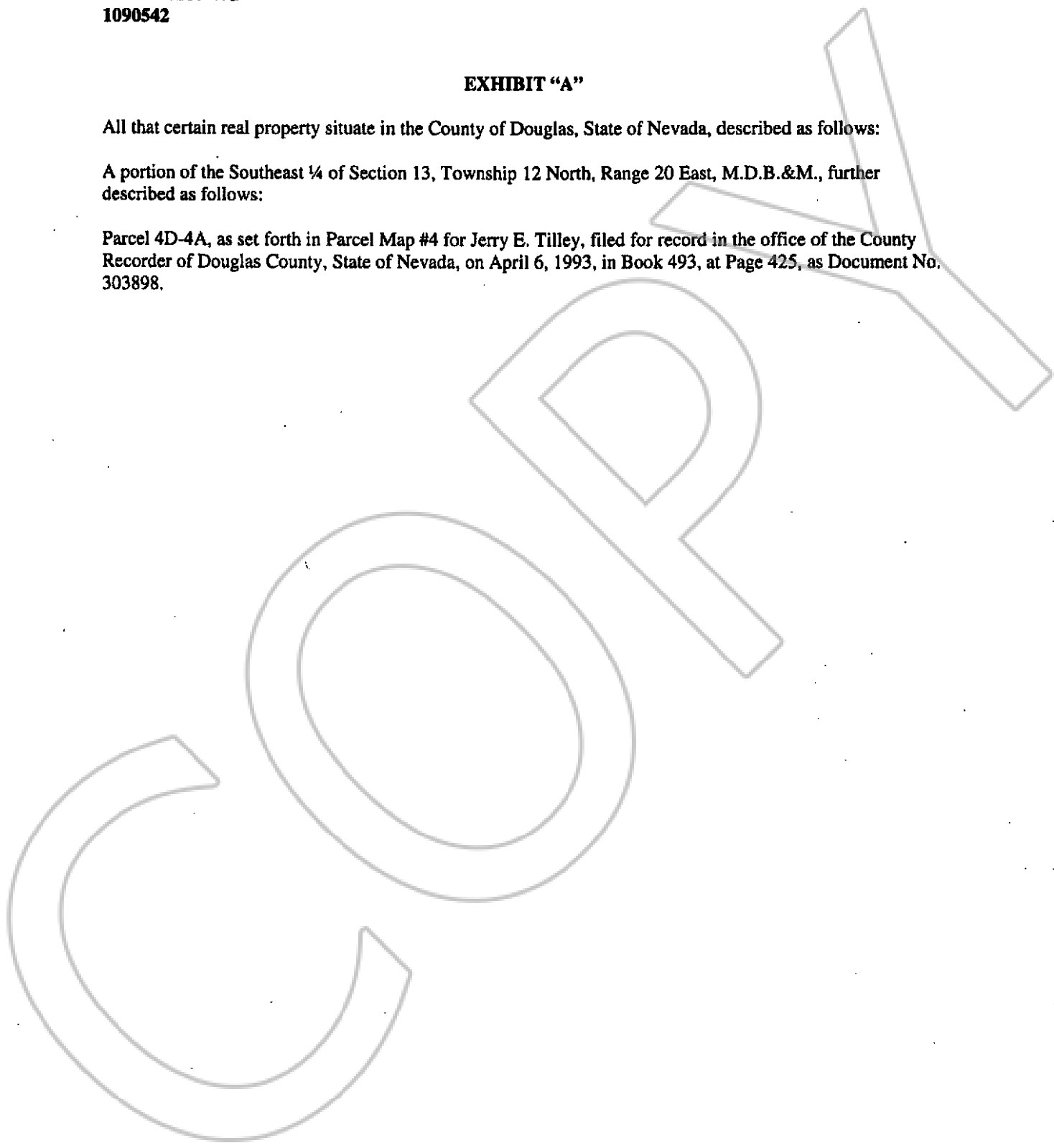

BK-409  
PG-3790