

OFFICIAL RECORD

Requested By:

JEFFREY K RAHBECK

APN: 0000-05-041-150

1318-09-212-019

Recording requested by and

When recorded mail to:

Jeffrey K. Rahbeck, Esq

P.O. Box 435

Zephyr Cove, NV 89448

Douglas County - NV  
Karen Ellison - Recorder

Page: 1 Of 3 Fee: 16.00  
BK-0509 PG-2606 RPTT: # 7



Mail Tax Statements to:

Stephen and Mary Abelow, Trustees

The Stephen and Mary Abelow 2008 Family Trust

PO Box 1451

Zephyr Cove, NV 89448

QUITCLAIM DEED

THIS INDENTURE, made this 16 day of September, 2008, by and between STEPHEN ABELOW and MARY ABELOW, party of this first part, and STEPHEN P. ABELOW and MARY J. ABELOW, Trustees of THE STEPHEN AND MARY ABELOW 2008 FAMILY TRUST dated September 16, 2008, party of the second part.

WITNESSETH:

That the said party of the first part, in consideration of the sum of TEN DOLLARS (\$10.00) lawful money of the United States of America, to him/her/them in hand paid by the said party of the second part, the receipt whereof is hereby acknowledged, hereby releases and forever quitclaims unto the said party of the second part forever, that certain piece and parcel of real property described on Exhibit "A", attached hereto.

TOGETHER WITH the tenements, hereditaments and appurtenances thereunto belonging or appertaining, and the reversion and reversions, remainder and remainders, rents, issues and profits thereof.

TO HAVE AND TO HOLD the said premises, together with the appurtenances, unto the said party of the second part, and to the survivor forever.

IN WITNESS WHEREOF, the party of the first part has executed this conveyance the day and year first written above.

Stephen Abelow  
STEPHEN ABELOW

Mary Abelow  
MARY ABELOW

**EXHIBIT "A"**

Lot 200, as shown on the map of SKYLAND SUBDIVISION NO. 3, filed in the office of the County Recorder of Douglas County, Nevada, on February 24, 1960, as Document No. 15653.

APN: 0000-05-041-150

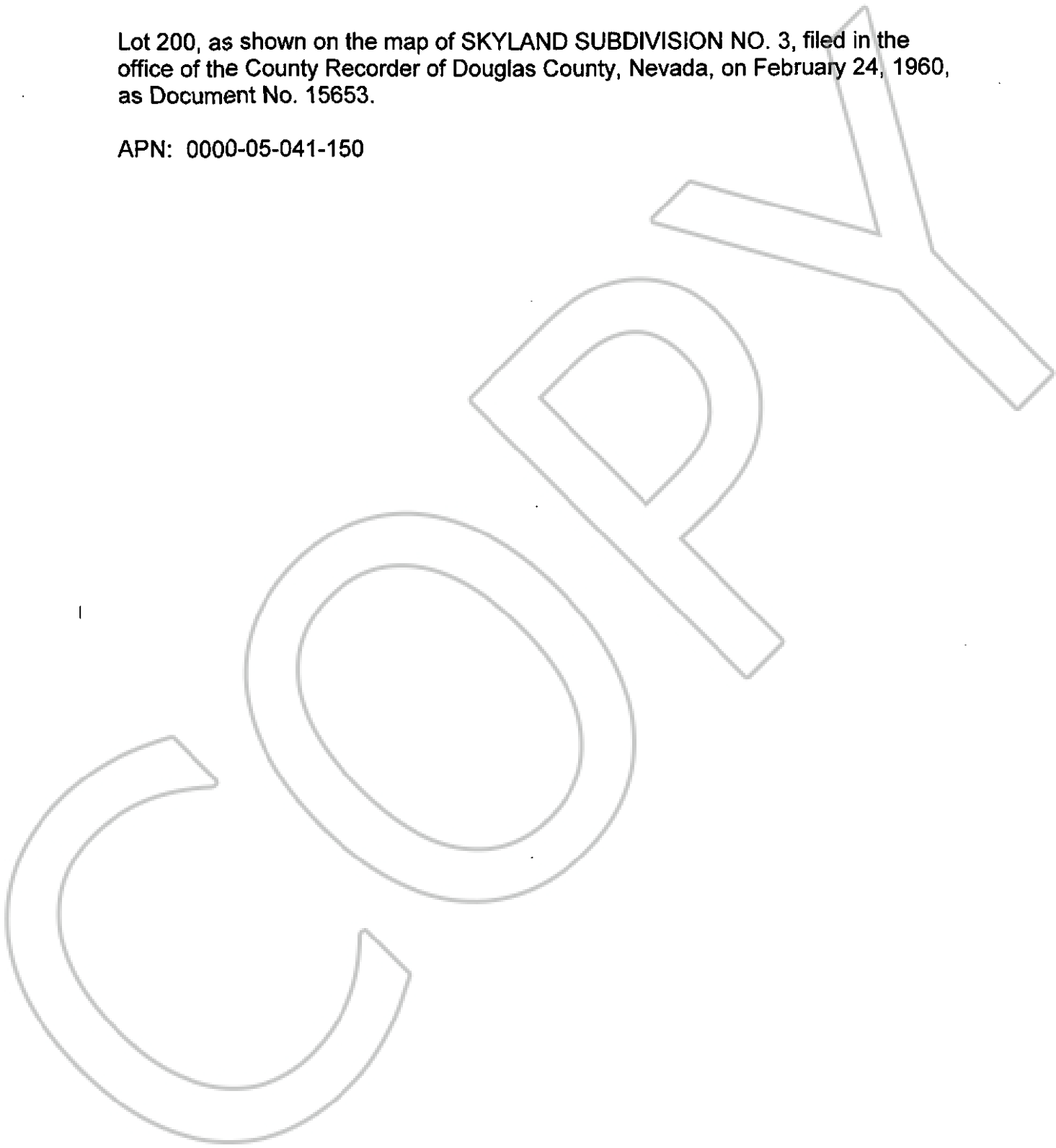

**ACKNOWLEDGEMENT**

STATE OF NEVADA        )  
                                  ) ss.  
COUNTY OF DOUGLAS    )

On the 16<sup>th</sup> day of September, 2008, personally appeared before me, a Notary Public, in and for said County and State, STEPHEN ABELOW and MARY ABELOW, known to me to be the persons described in and who executed the foregoing instrument, who acknowledged to me that they executed the same, freely and voluntarily and for the uses and purposes therein mentioned.

IN WITNESS WHEREOF, I have hereunto set my hand and affixed my official seal in the County and State above-named, the day and year in this certificate first above written.

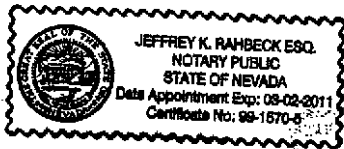

Jeffrey K. Rahbeck  
NOTARY PUBLIC

