

LOT D  
(OPEN SPACE)  
A.P.N.  
1219-16-002-001

50' WIDE PRIVATE DRIVEWAY ACCESS,  
WELL MAINTENANCE ACCESS, WATER  
TANK MAINTENANCE ACCESS AND  
WATERLINE EASEMENT PER DOCUMENT  
No. 415114

CHALET ROAD  
N 16°36'46" E 387.68'  
N 16°36'46" E (BASIS OF BEARINGS) 388.42'

LOT 19, BLOCK 4  
A.P.N.  
1219-16-002-012

LOT 38, BLOCK 4  
JOB'S PEAK RANCH UNIT 1  
DOC. No. 415114  
(A.P.N. 1219-16-002-013)  
22.68 Ac.

LINE DATA

L1	N 72°33'01" W	8.32'
L2	N 72°33'01" W	20.66'
L3	N 02°59'05" W	36.40'
L4	N 26°26'38" W	100.29'
L5	N 00°04'24" E	53.19'
L6	N 89°55'36" W	10.00'
L7	N 00°04'24" E	50.00'
L8	N 89°55'36" W	50.00'
L9	N 89°55'36" W	20.00'
L10	N 00°04'24" E	48.48'
L11	N 26°26'38" W	100.83'
L12	N 02°59'05" W	46.81'

30' WIDE WATER TANK ACCESS  
AND MAINTENANCE EASEMENT  
PER DOC. No. 415114

10' WIDE WATER UTILITY  
EASEMENT PER DOC.  
No. 415114

LOT 38, BLOCK 4  
JOB'S PEAK RANCH UNIT 1  
DOC. No. 415114  
(A.P.N. 1219-16-002-013)  
22.68 Ac.

WELL MAINTENANCE  
EASEMENT PER  
DOC. No. 415114

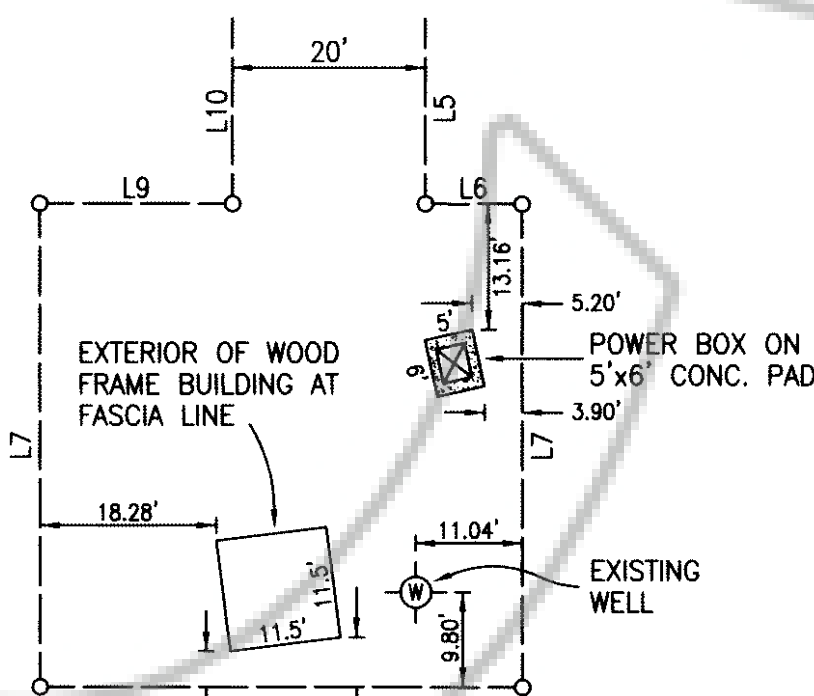

DETAIL "A"  
SCALE 1" = 20'

SITE MAP

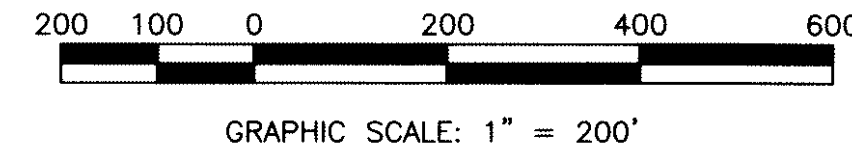

LOT 22, BLOCK 3  
A.P.N.  
1219-16-002-002

LOT 19, BLOCK 4  
A.P.N.  
1219-16-002-012

LOT D  
(OPEN SPACE)  
A.P.N.  
1219-16-002-001

LIMITS OF AREA  
SHOWN AT LEFT  
HEREON

LOT 18  
BLOCK 4

LOT 40  
BLOCK 4

LOT 4  
BLOCK 4

LOT 4  
BLOCK 4

LOT 1 (OPEN SPACE)  
A.P.N.  
1219-21-001-001

A.P.N.  
1219-21-001-002

A.P.N.  
1219-21-001-003

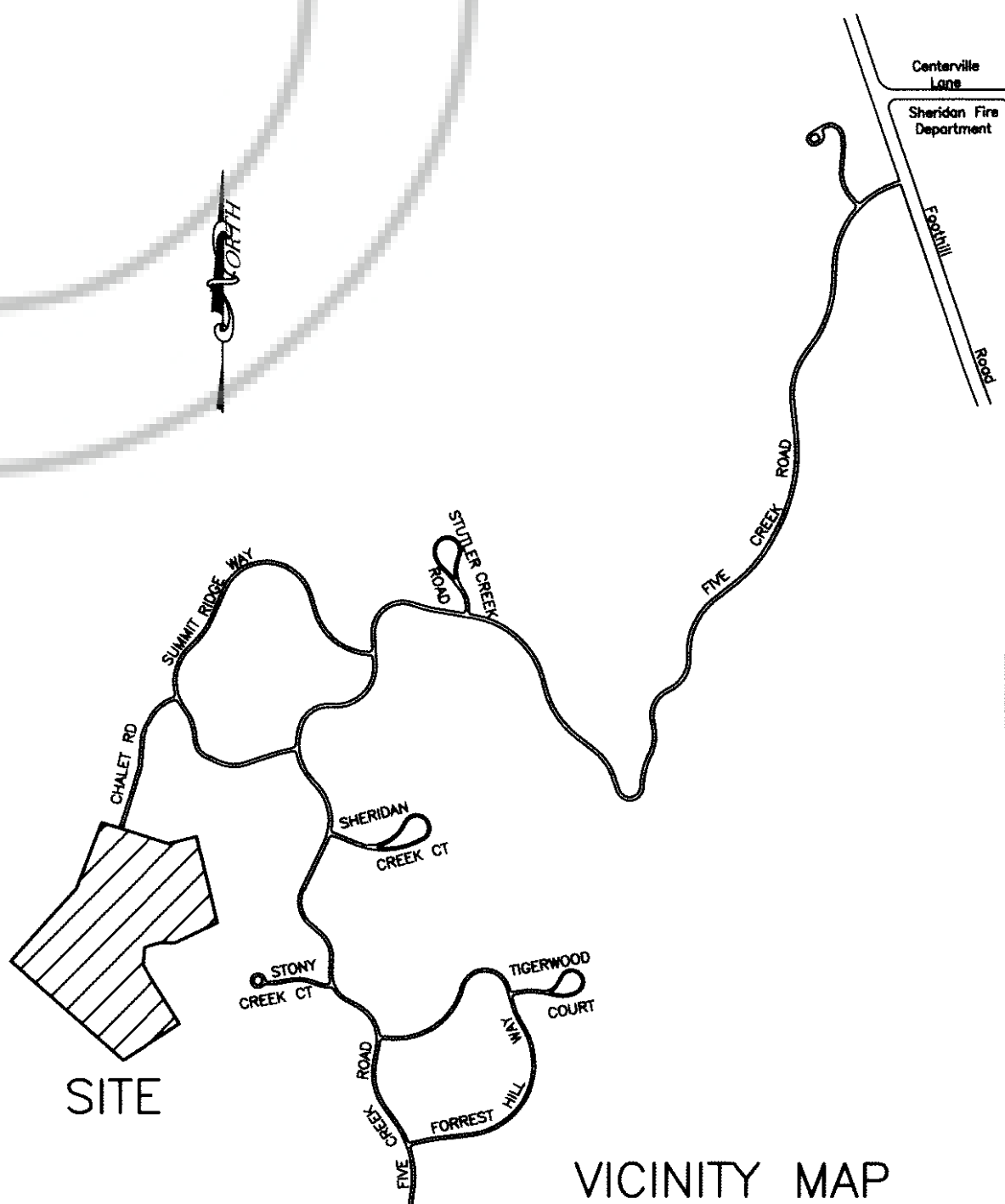

SITE

VICINITY MAP  
NOT TO SCALE

SURVEYOR'S CERTIFICATE:

I, DAVID D. WINCHELL, A PROFESSIONAL LAND SURVEYOR REGISTERED IN THE STATE OF NEVADA, CERTIFY THAT:

1. THIS PLAT REPRESENTS THE RESULTS OF A SURVEY CONDUCTED UNDER MY SUPERVISION AT THE INSTANCE OF THE MACAULEY FAMILY TRUST.
2. THE LANDS SURVEYED LIE WITHIN THE EAST 1/2 OF THE SOUTHEAST 1/4 OF SECTION 16, TOWNSHIP 12 NORTH, RANGE 19 EAST, M.D.B.&M. AND THE SURVEY WAS COMPLETED ON MAY 18, 2009.
3. THIS PLAT COMPLIES WITH APPLICABLE STATUTES OF THIS STATE AND ANY LOCAL ORDINANCES IN EFFECT ON THE DATE THAT THE SURVEY WAS CONDUCTED IN ACCORDANCE WITH CHAPTER 625 OF THE NEVADA ADMINISTRATIVE CODE.
4. THE MONUMENTS DEPICTED ON THE PLAT ARE OF THE CHARACTER SHOWN, OCCUPY THE POSITIONS INDICATED, AND ARE OF SUFFICIENT DURABILITY.

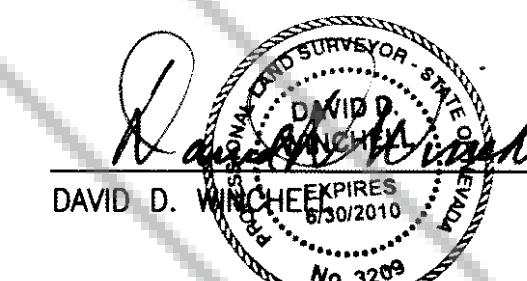

DAVID D. WINCHELL  
P.L.S. 3209  
DATE 6/02/09

REFERENCE DOCUMENT:

PLANNED UNIT DEVELOPMENT 2014-1 FOR JOB'S PEAK RANCH UNIT 1, RECORDED IN BOOK 697 AT PAGE 3042 AS DOCUMENT No. 415114 IN THE OFFICIAL RECORDS OF DOUGLAS COUNTY, NEVADA

BASIS OF BEARINGS

THE BEARING N 16°36'46" E, FOR THE EASTERLY LINE OF THE "50' WIDE PRIVATE DRIVEWAY ACCESS, WELL MAINTENANCE ACCESS, WATER TANK MAINTENANCE ACCESS AND WATERLINE EASEMENT" SHOWN ON DOCUMENT No. 415114, WAS USED AS THE BASIS OF BEARINGS FOR THIS RECORD OF SURVEY.

NOTE:

THE PURPOSE OF THIS SURVEY IS TO MONUMENT THE CORNERS AND ANGLE POINTS OF THAT PORTION OF THE "WELL MAINTENANCE EASEMENT" WHICH LIES WITHIN LOT 38, BLOCK 4, AS SAID LOT IS SHOWN ON DOCUMENT No. 415114.

LEGEND

- - INDICATES SET 5/8" REBAR AND CAP, P.L.S. 3209
- - INDICATES Fd. 5/8" REBAR AND CAP, P.L.S. 5286
- ◆ - INDICATES A CALCULATED POINT PER THE RECORD DOCUMENT, NOTHING FOUND OR SET

COUNTY RECORDER'S CERTIFICATE:

FILED THIS 3rd DAY OF JUNE, 2009, AT  
58 MINUTES PAST 2 O'CLOCK P.M. IN BOOK 0609,  
AT PAGE 976, DOCUMENT NUMBER 744374  
RECORDED AT THE REQUEST OF DAVID D. WINCHELL.

*Pamela Kronenberg, Deputy*  
DOUGLAS COUNTY RECORDER

RECORD OF SURVEY  
FOR  
MACAULEY FAMILY TRUST

BEING A SURVEY OF A PORTION OF LOT 38, BLOCK 4, JOB'S PEAK RANCH UNIT 1, RECORDED IN BOOK 697, AT PAGE 3042 AS DOC. No. 415114 IN THE OFFICIAL RECORDS OF DOUGLAS COUNTY.

LOCATED WITHIN THE EAST 1/2 OF THE SOUTHEAST 1/4 OF SECTION 16,  
TOWNSHIP 12 NORTH, RANGE 19 EAST, M.D.B. & M.

DOUGLAS COUNTY

NEVADA

SHEET 1 OF 1 SHEET

