

DOC # 745513  
 06/18/2009 03:00PM Deputy: DW  
**OFFICIAL RECORD**  
 Requested By:  
**STEWART TITLE - DOUGLAS**  
 Douglas County - NV  
 Karen Ellison - Recorder  
 Page: 1 of 2 Fee: 15.00  
 BK-609 PG-5949 RPTT: 826.80



A.P.N. #	1320-33-714-046
R.P.T.T.	\$826.80
Escrow No.	1018715DR
<b>Recording Requested By:</b>	
	
Mail Tax Statements To:	Same as below
<b>When Recorded Mail To:</b>	
Janis M. Hill	
1321 Granborough Drive	
Gardneville, NV 89410	

**GRANT, BARGAIN, SALE DEED**

THIS INDENTURE WITNESSETH: That **Richard Saiz and Bertha Saiz, Trustees of the Saiz Trust created on March 3, 1997**, for valuable consideration, the receipt of which is hereby acknowledged, does hereby Grant, Bargain Sell and Convey to Janis M. Hill, a married woman as her sole and separate property, all that real property situated in the County of Douglas, State of Nevada, bounded and described as follows:

See Exhibit "A" attached hereto and by reference made a part hereof for complete legal description.

Together with all and singular the tenements, hereditaments and appurtenances thereunto belonging or in anywise appertaining, and any reversions, remainders, rents, issues or profits thereof.

Dated: 6-10-09

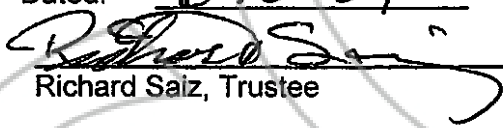
  
 Richard Saiz, Trustee

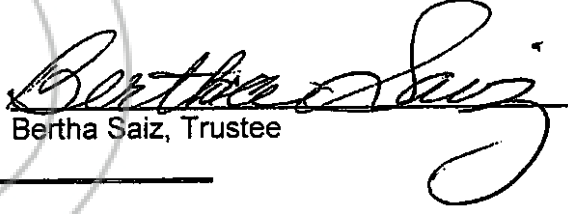
  
 Bertha Saiz, Trustee

State of NV }  
 County of Douglas } ss.

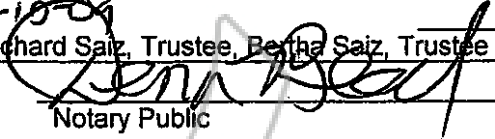
This instrument was acknowledged before me on 6-10-09  
 by: Richard Saiz, Trustee, Bertha Saiz, Trustee  
 Signature:   
 Notary Public

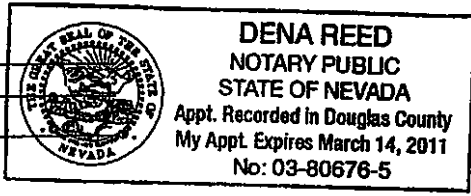
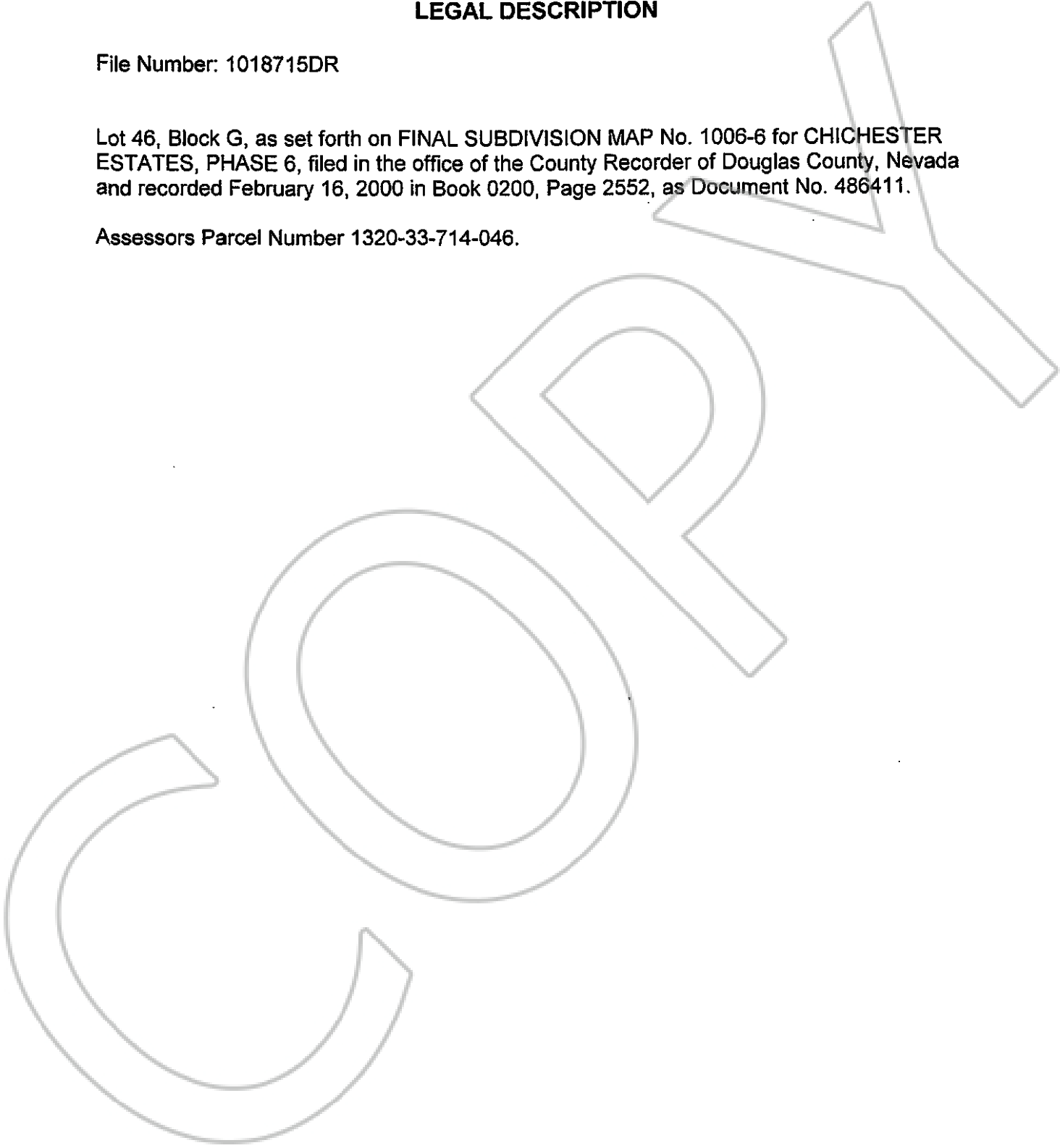

**Exhibit A  
LEGAL DESCRIPTION**

File Number: 1018715DR

Lot 46, Block G, as set forth on FINAL SUBDIVISION MAP No. 1006-6 for CHICHESTER ESTATES, PHASE 6, filed in the office of the County Recorder of Douglas County, Nevada and recorded February 16, 2000 in Book 0200, Page 2552, as Document No. 486411.

Assessors Parcel Number 1320-33-714-046.



(One Inch Margin on all sides of Document for Recorder's use Only)

Page 2 of 2



745513 Page: 2 of 2 06/18/2009

BK-609  
PG-5950