

APN: 1319-19-710-023
1319-19-710-024

Douglas County - NV
Karen Ellison - Recorder
Page: 1 Of 4 Fee: 17.00
BK-0609 PG- 7118 RPTT: 0.00

Recording requested by and

When recorded mail to:

Jeffrey K. Rahbeck, Esq
P.O. Box 435
Zephyr Cove, NV 89448

Mail Tax Statements to:

Schuss Investments, LLC
c/o Brooks, Robert MGR
1015 Beecave Woods Drive, #300B
Austin, TX 78746



**DECLARATION OF COVENANTS, CONDITIONS AND RESTRICTIONS
BEING A DEED RESTRICTION FOR LOT CONSOLIDATION**

This Declaration is made this 8th day of April, 2009, by SCHUSS INVESTMENTS, LLC, hereinafter referred to as "declarant".

RECITALS:

1. Declarant is the owner of that certain real property located in Douglas County, State of Nevada, described as follows:

(See Exhibits "A" and "B" attached hereto and incorporated herein.)

APN's: 1319-19-710-023 and 1319-19-710-024

2. The declarant desires to merge/consolidate the two (2) parcels into one (1) parcel.

3. For all purposes, the above-described parcels are to be treated as if legally merged.

DECLARATION

Declarant hereby declares that the hereinabove described parcels are and shall be deemed by Douglas County, and any other entity, to be merged/consolidated and shall constitute but one contiguous, inseparable parcel.

This Declaration shall be deemed a covenant running with the land or as an equitable servitude, as the case may be, and shall constitute benefits and burdens to the parcels described above and shall be binding on the declarant

and declarant's successors and assigns and all persons hereafter acquiring or owning any interest in the above described parcels.

This Declaration may not be revoked or modified without the prior express written and recorded consent of Douglas County, Nevada. Douglas County is deemed and agreed to be a third party beneficiary of this Declaration and, as such, can enforce the provisions of the Declaration.

IN WITNESS WHEREOF, declarant has executed this declaration on the day and year written above.

SCHUSS INVESTMENTS, LLC

[Handwritten Signature]
By: _____

Robert Brooks, Manager

STATE OF TEXAS)
) ss.
COUNTY OF Tarrant)

On this 8th day of April, in the year 2009, before me personally appeared ROBERT BROOKS, personally known to me, or proved to me, to be the person whose name is subscribed to this instrument, and acknowledge that he executed it.

Witness my hand and official seal.

[Handwritten Signature]

Notary's Signature

My Commission Expires: 4-2-12



EXHIBIT "A"

Parcel 1:

Lot 418 B as shown on the AMENDED SUBDIVISION MAP OF SUMMIT VILLAGE recorded in the Office of the County Recorder of Douglas County, State of Nevada, on January 13, 1969 as Document No. 43419 and on Second Amended Map recorded December 24, 1969 as Document No. 46671 of Official Records, Douglas County, State of Nevada.

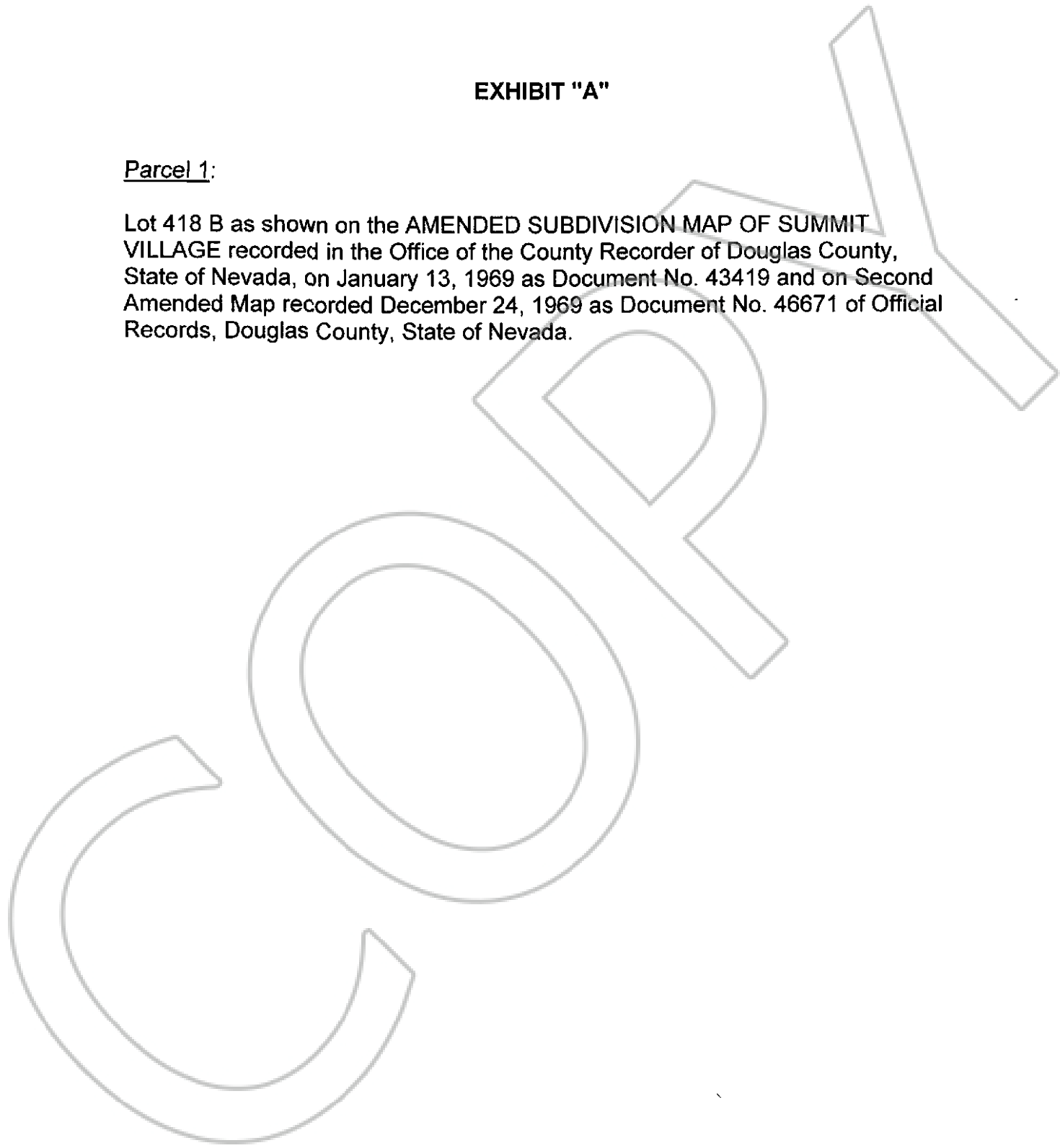

EXHIBIT "B"

Parcel 2:

Lot 418A as shown on the AMENDED SUBDIVISION MAP OF SUMMIT VILLAGE recorded in the Office of the County Recorder of Douglas County, State of Nevada, on January 13, 1969 as Document No. 43419 and on Second Amended Map recorded on December 24, 1969 as Document No. 46671 of Official Records, Douglas County, State of Nevada.