

OFFICIAL RECORD

Requested By:

JAMIE & JENNIFER HINNANT

The undersigned hereby affirms that this document does not contain a Social Security Number

[Signature]
Print Name Under Signature:

Douglas County - NV
Karen Ellison - Recorder

Page: 1 of 2 Fee: 15.00
BK-0709 PG-6275 RPTT: 0.00

When Recorded Return To:
Jennifer and James Hinnant
1155 Ladera Lane
Gardnerville, NV 89410



Assessor Parcel Number: 1220-12-110-001

DECLARATION OF HOMESTEAD

Check One:

- Married (filing joint declaration)
- Head of Family
- By Husband (filing for joint benefit or both)
- Single, Married or Widowed
- By Wife (filing joint benefit or both)
- Multiple Single Persons
- Other: _____

A: Check One

- Regular Home Dwelling/Manufactured Home
- Condominium Unit
- Other

Name on Title of Property: James and Jennifer Hinnant

Do individually or severally certify and declare as follows: _____

Is/are now residing on the land, premises (or manufactured home) located in the City of: Gardnerville

County of: Douglas, State of Nevada, and more particularly described as follows:

(Set forth legal description and commonly known street address OR manufactured home description)

see Exhibit 'A'

B: _____ I/We claim the land and premises hereinabove described, together with the dwelling house thereon, and its appurtenances, or the described manufactured home as a Homestead.

In Witness, Whereof, I/We have hereunto set my hand/our hands this 27 day of July 2009.

[Signature]
Signature
James E. Hinnant
Print Name here

[Signature]
Signature
Jennifer M. Hinnant
Print Name here

STATE OF NEVADA _____
COUNTY OF Douglas

This instrument was acknowledged before me on 7-27-2009

James E & Jennifer M Hinnant
Person(s) appearing before notary

[Signature]
(Signature of notarial officer) My commission expires: April 15, 2011

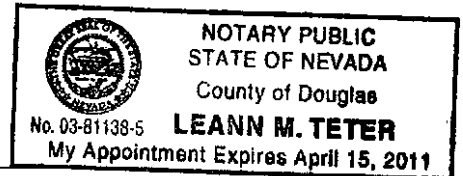

CONSULT AN ATTORNEY IF YOU DOUBT THIS FORM'S FITNESS FOR YOUR PURPOSE. This form provided as a courtesy to the taxpayer by: Douglas County Recorder's Office. The Recorder's Office assumes no liability for the completion of the Homestead Declaration. NOTE: Please leave 1" margins blank.

EXHIBIT "A"

LEGAL DESCRIPTION

ESCROW NO.: 040102146

The land referred to herein is situated in the State of Nevada, County of Douglas City of GARDNERVILLE described as follows:

Parcel 2-B as set forth on Parcel Map LDA 98-079 for Alton A. & Susan L. Anker and Harry and Billie Tedsen, filed for Record in the Office of the Douglas County Recorder April 14, 1999, in Book 499, Page 2742, as Document No. 465696 of Official Records.

ASSESSOR'S PARCEL NO. 1220-12-110-001

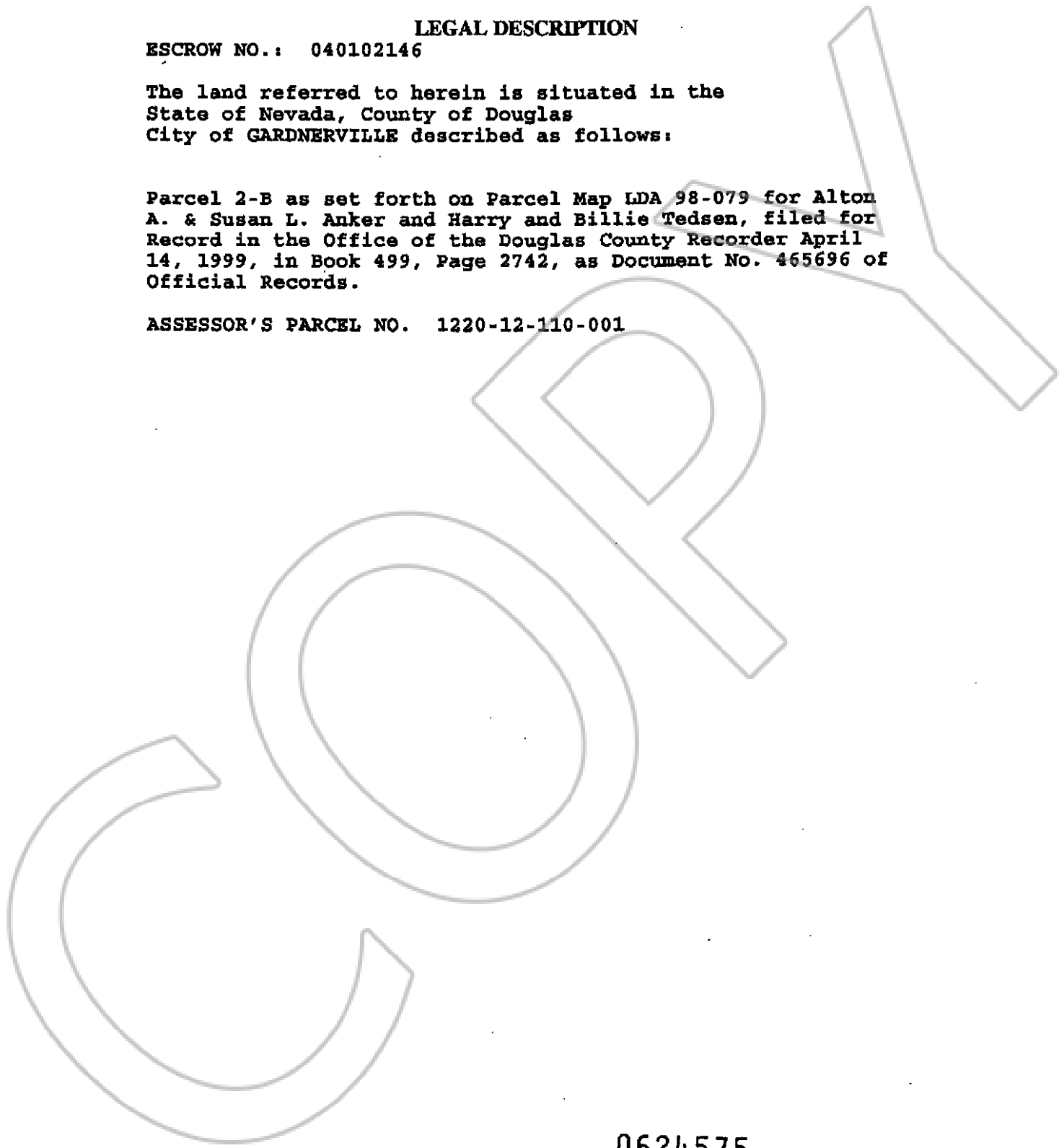

0624575

BK0904PG07612