

DOC # 750328  
09/08/2009 01:38PM Deputy: SG  
OFFICIAL RECORD  
Requested By:  
MARQUIS TITLE  
Douglas County - NV  
Karen Ellison - Recorder  
Page: 1 of 4 Fee: 17.00  
BK-909 PG-1551 RPTT. 764.40



**RECORDING REQUESTED BY.**  
Marquis Title and Escrow, Inc.  
Order No 295251 JL  
Escrow No FT090011093

**When Recorded Mail Document  
and Tax Statement To.**  
Anthony Pemberton and Jena Albertson  
1444 Edlesborough Cir  
Gardnerville, NV 89410

RPTT #764.40  
APN 1320-33-312-011

**GRANT, BARGAIN, SALE DEED**

THIS INDENTURE WITNESSETH That Deutsche Bank National Trust Company, as Indenture Trustee for the Encore Credit Receivables Trust 2005-3

FOR VALUABLE CONSIDERATION, receipt of which is hereby acknowledged, do(es) hereby Grant, Bargain, Sell and

Convey to Jena M. Albertson, a single woman and Anthony M. Pemberton, a single man as joint tenants all that real property situated in Douglas County, State of Nevada, bounded and described as follows:

See "Exhibit One" Legal See "Exhibit Two" Special Warranty Deed for Verbiage

- SUBJECT TO. 1 Taxes for the fiscal year 2009-10  
2 Covenants, Conditions, Reservations, Rights, Rights of Way and Easements now of record

Together with all and singular tenements, hereditaments and appurtenances thereunto belonging or in anywise appertaining

DATED August 4, 2009



Deutsche Bank National Trust Company, as  
Indenture Trustee for the Encore Credit  
Receivables Trust 2005-3

BY

  
CHERYL E. KRUEGER, DOC, CONTROL OFFICER

STATE OF UTAH

COUNTY OF SALT LAKE

I, JULEE METTERS a Notary Public of the  
County and State first above written, do hereby  
certify that CHERYL E. KRUEGER, DOC CONTROL OFFICER  
personally appeared before me this day and  
acknowledged the due execution of the  
foregoing instrument

Witness my hand and official seal, this the  
AUGUST 7, 2009

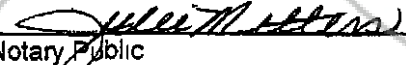
  
Notary Public

My Commission Expires  
(SEAL)

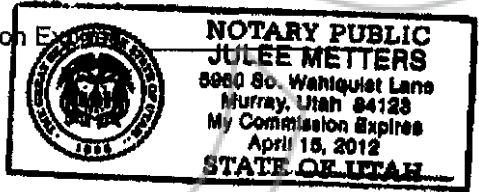



ESCROW NO FT080011093

**EXHIBIT "ONE"**

**LEGAL DESCRIPTION**

Lot 6, Block A, as set forth on Final Subdivision Map FSM-1006-3 of CHICHESTER ESTATES PHASE 3, filed for record in the Office of the County Recorder of Douglas County, State of Nevada, on September 11, 1997, in Book 997, Page 2121, as Document No. 421409, Official Records.

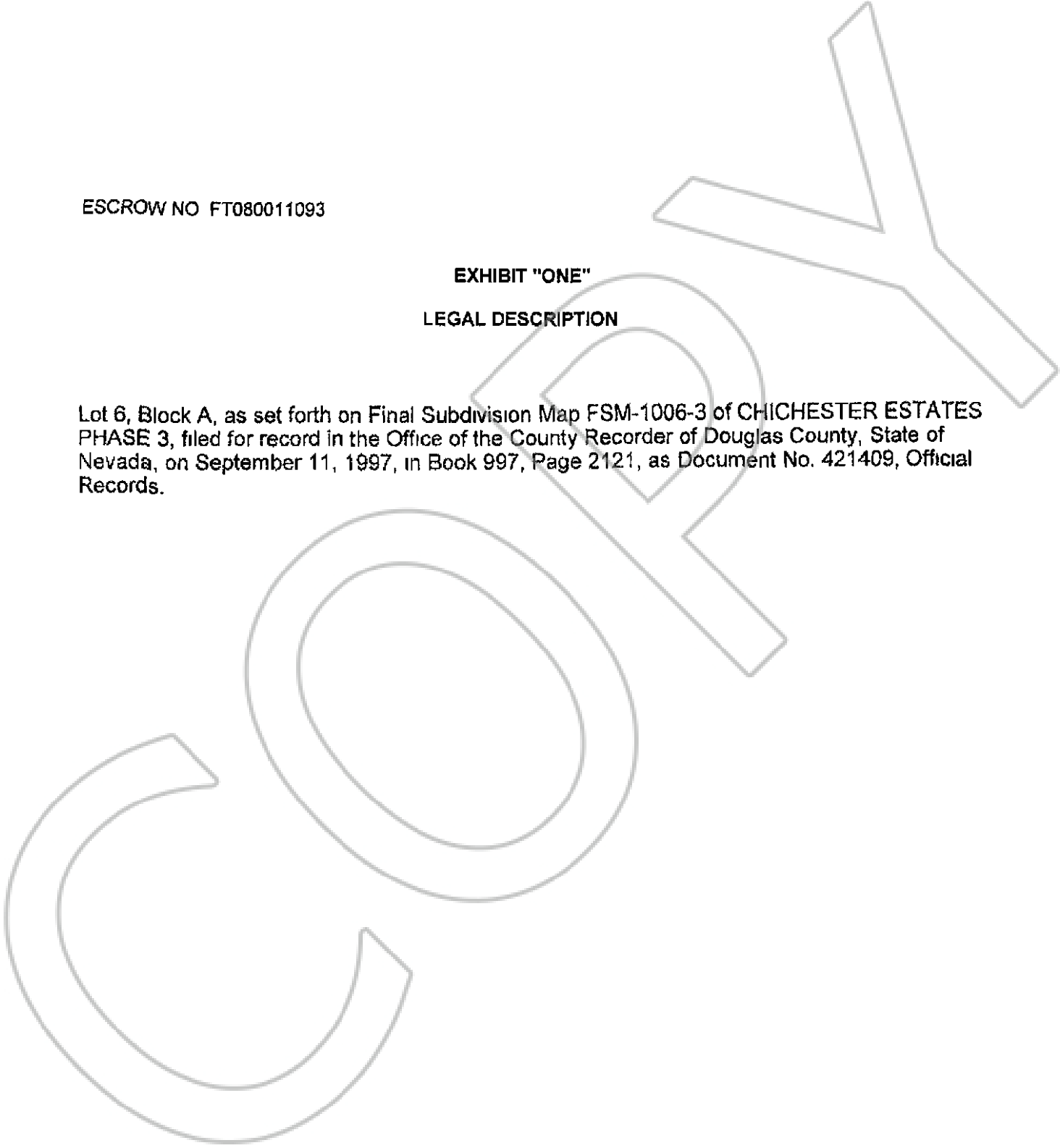



**SPECIAL WARRANTY DEED**  
Exhibit "Two"

"Grantor covenants that it is seized and possessed of the said land and has a right to convey it, and warrants the title against the lawful claims of all persons claiming by, through, and under it, but not further otherwise "

The following reservations from and exceptions to this conveyance and the warranty of title made herein shall apply

- (1) All easements, rights-of-way and prescriptive rights whether of record or not, pertaining to any portion(s) of the herein described property (hereinafter, the "Property"),
- (2) All valid oil, gas and mineral rights, interest or leases, royalty reservations, mineral interest and transfers of interest of any character, in the oil, gas or minerals of record in any county in which any portion of the Property is located,
- (3) All restrictive covenants, terms, conditions, contracts, provisions, zoning ordinances and other items of record in any county in which any portion of the Property is located pertaining to any portion(s) of the Property, but only to the extent that same are still in effect,
- (4) All presently recorded instruments (other than liens and conveyances by, through or under the Grantor) that affect the Property and any portion(s) thereof,
- (5) Ad valorem taxes, fees and assessments, if any, for the current year and all prior and subsequent years, the payment of which Grantee assumes (at the time of transfer of title), and all subsequent assessments for this and all prior years due to changes(s) in land usage (including, but not limited to, the presence or absence of improvements, if any, on the Property), ownership, or both, the payment of which Grantee assumes, and
- (6) Any conditions that would be revealed by a physical inspection and survey of the Property