

16-

OFFICIAL RECORD

Requested By:
WALTON SESKIN

ARN: 1219-12-002-006

RETURN RECORDED DEED TO:

WALTON D. SESKIN

P.O. Box 6531

GARDNERVILLE, NV 89460

Douglas County - NV
Karen Ellison - Recorder

Page: 1 Of 3 Fee: 16.00
BK-1209 PG- 0210 RPTT: # 7



GRANTEE/MAIL TAX STATEMENTS TO:

SAME AS ABOVE

QUITCLAIM DEED

THIS INDENTURE WITNESSED: That VALLEY CENTER FARM LLC,
in consideration of the sum of Ten Dollars (\$10), the receipt of which is hereby
acknowledged, do(es) hereby remise, release and forever quitclaim to
WALTON D. SESKIN TRUST NO. 1 AND JILL A. SESKIN TRUST NO. 1, all
that real property situated in GARDNERVILLE, County of
DOUGLAS, State of Nevada, and more particularly described as follows:

SEE EXHIBIT A

(Insert legal description here, or reference exhibit A attached and
incorporated by reference. Check NRS 111.312 concerning the recordation
of documents pertaining to property with metes and bounds legal
description.)

TOGETHER WITH all and singular the tenements, hereditaments, and
appurtenances thereunto belonging or in anywise appertaining.

WITNESS my/our hand(s) this _____ day of _____, 20____,

Print name _____

(ACKNOWLEDGMENT)

Note: Effective July 1, 2003, all documents (except maps) submitted for recording in
Nevada must be on 8½-inch by 11-inch paper, have a margin of 1 inch on the left and
right sides and at the bottom of each page, have a space of 3 inches by 3 inches at the
upper right corner of the first page, and have a margin of 1 inch at the top of each
succeeding page. (NRS 247.110(4))

Jill A. Seskin
Seskin, Jill A

Walton D. Seskin
Seskin, Walton D

State of Nevada
County of Douglas

This instrument was acknowledged before me on 12/2/09 by

Walton D. & Jill A Seskin

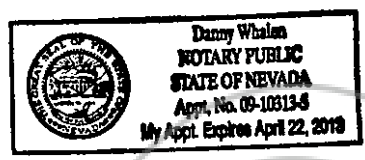

Danny Whalen
Danny Whalen (Notary)

EXHIBIT "A"

LEGAL DESCRIPTION

ESCROW NO.: 030103991

Lot 2 as shown on the final map of SHERIDAN MEADOWS SUBDIVISION, filed for record in the Office of the County Recorder on May 21, 1972, as Document No. 66349, Official Records of Douglas County, Nevada.

Assessment Parcel No. 1219-12-002-006.

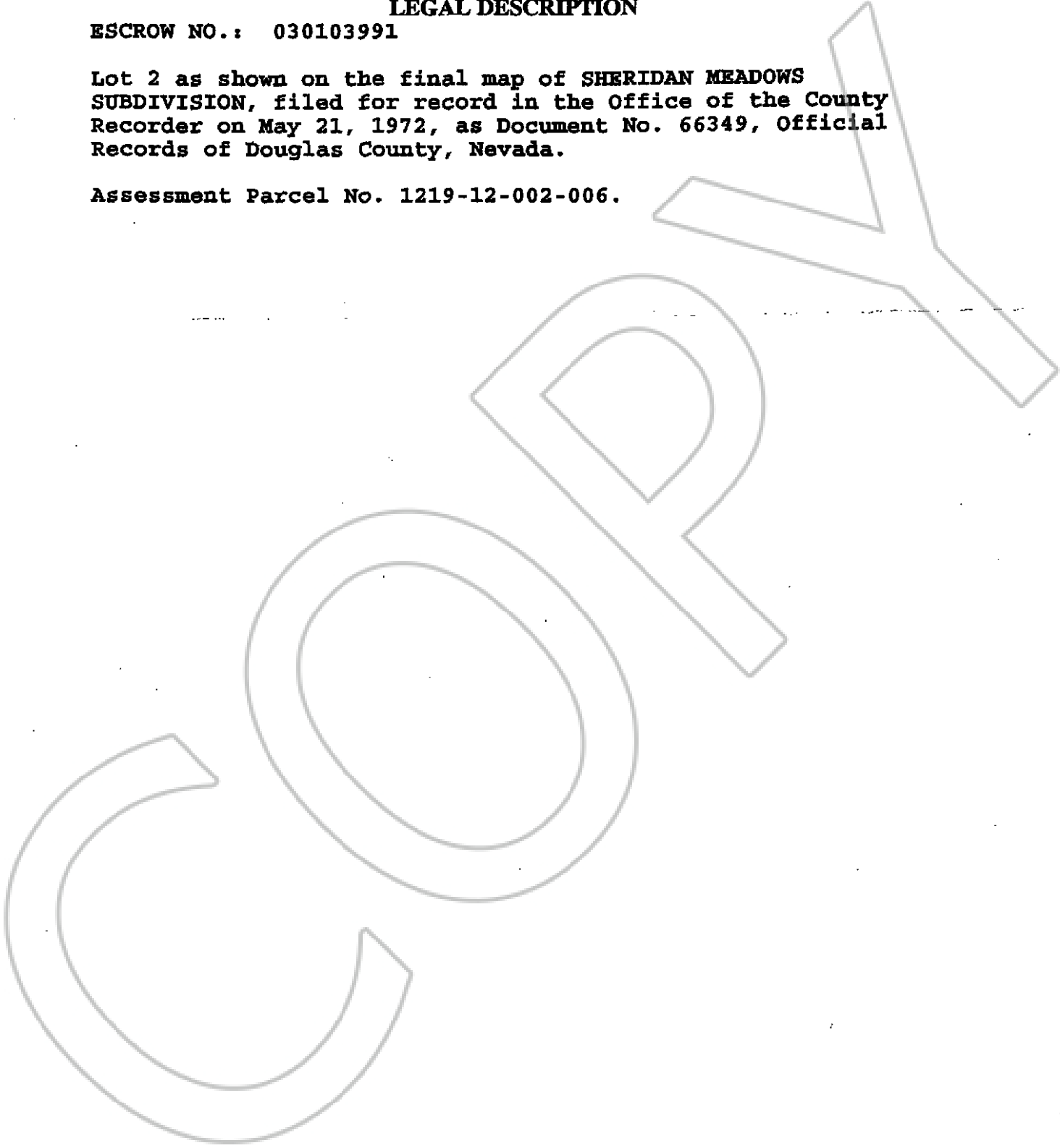

0598293

BK1203PG00447