

15-

OFFICIAL RECORD
Requested By:
MARY LAURSEN

DECLARATION OF HOMESTEAD

Assessor Parcel Number: 1220-09-412-014

OR

Assessor's Manufactured Home ID Number: _____

Douglas County - NV
Karen Ellison - Recorder

Page: 1 Of 2 Fee: 15.00
BK-0610 PG-2747 RPTT: 0.00



Recording Requested by and Mail to:

Name: Mary Laurson

Address: 1029 Ranch Rd.

City/State/Zip: Gardnerville, NV 89460

Check One:

Married (filing jointly) Married (filing individually)

Head of Family Widowed

Single Person Multiple Single Persons

By Wife (filing for joint benefit of both)

By Husband (filing for joint benefit of both)

Other (describe): _____

Check One:

Regular Home Dwelling/Manufactured Home Condominium Unit Other

Name on Title of Property

Richard E. & Mary E. Laurson as Trustees of the

do individually or severally certify and declare as follows:

Richard E. & Mary E. Laurson, Trust - 11-17-87

is/are now residing on the land, premises (or manufactured home) located in the city/town of Gardnerville
County of Douglas, State of Nevada, and more particularly described as follows:

(set forth legal description and commonly known street address OR manufactured home description)

See attached to Exhibit "A"

I/We claim the land and premises hereinabove described, together with the dwelling house thereon, and its appurtenances, or the described manufactured home as a Homestead.

In Witness, Whereof, I/we have hereunto set my hand/our hands this 15 day of June, 2010.

Mary E. Laurson
Signature

MARY E. LAURSEN
Print or type name here

Signature

Print or type name here

STATE OF NEVADA, COUNTY OF Douglas

This instrument was acknowledged before me on 6/15/10
(date)

by Mary E. Laurson
Person(s) appearing before notary

by _____
Person(s) appearing before notary

Karen Ellison
Signature of Notarial officer

CONSULT AN ATTORNEY IF YOU DOUBT THIS FORM'S FITNESS FOR YOUR PURPOSE.

Notary Seal

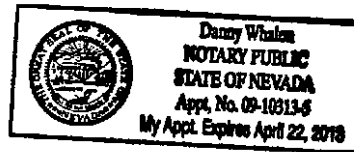

NOTE: Leave space within 1-inch margin blank on all sides.

Oct. 2009

EXHIBIT "A"

LEGAL DESCRIPTION

All that real property situate in the County of Douglas, State of Nevada, described as follows:

Lot 14, in Block C, as shown on the Final Map No. 97-008, of SILVERANCH UNIT 1-B, filed in the office of the County Recorder of Douglas County, State of Nevada, on August 14, 1997, in Book 897, Page 2529, as Document No. 419430.

Assessor's Parcel No. 1220-09-412-014

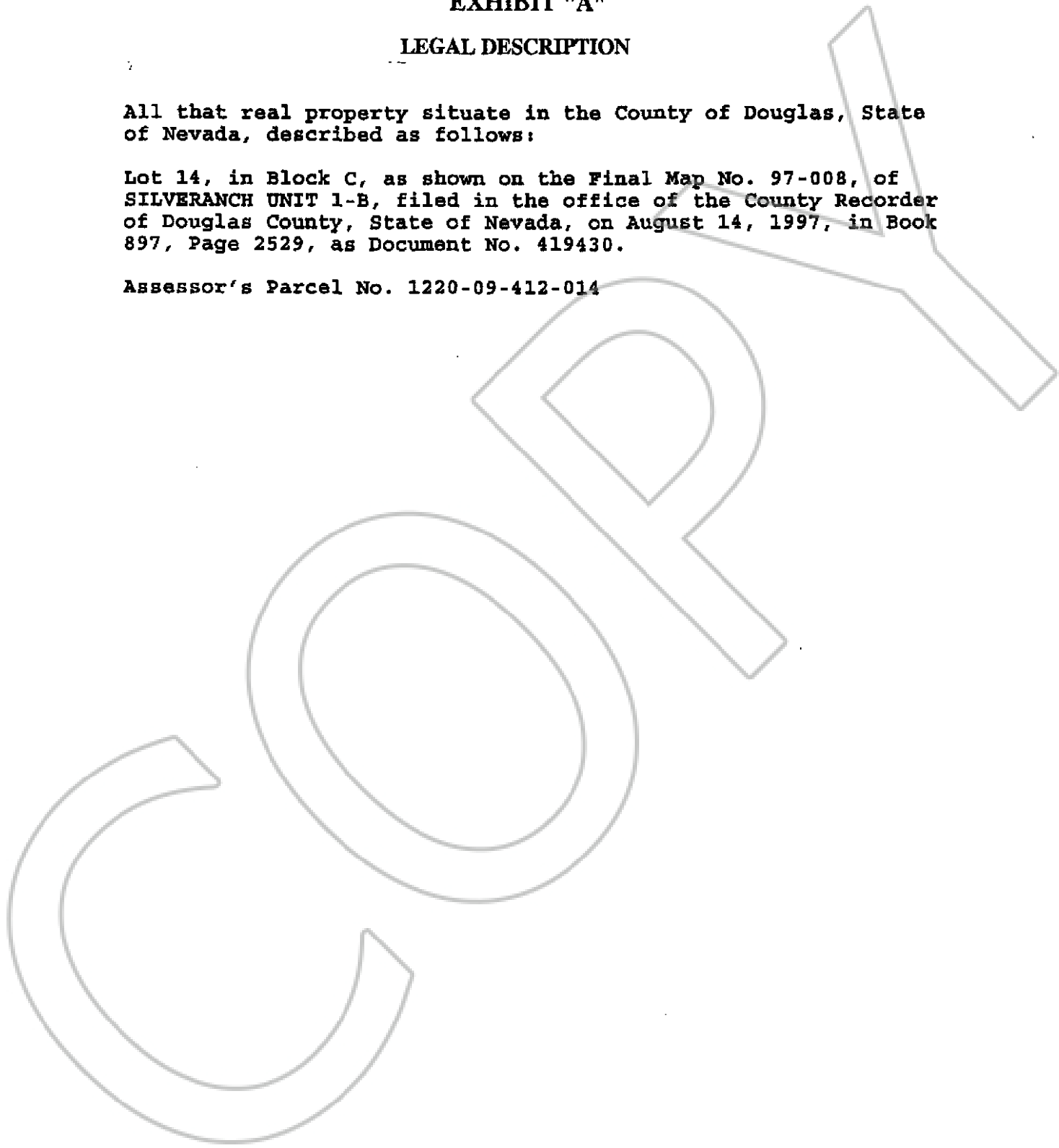

0602958

BK0104PG08879