

DOC # 768158
08/05/2010 03:10PM Deputy: SD
OFFICIAL RECORD
Requested By:
FIRST AMERICAN NATIONAL
Douglas County - NV
Karen Ellison - Recorder
Page: 1 of 4 Fee: 17.00
BK-810 PG-1240 RPTT: 0.00

RECORDING REQUESTED BY:
RECONTRUST COMPANY

AND WHEN RECORDED MAIL TO:
FEDERAL NATIONAL MORTGAGE ASSN.
C/O RECONTRUST COMPANY
400 COUNTRYWIDE WAY SV-35
SIMI VALLEY, CA 93065



Forward Tax Statements to Address listed above
TS No. 09-0132480
Title Order No. 4246057

TRUSTEE'S DEED UPON SALE NEVADA

APN# 1121-05-512-010

The amount of the unpaid debt was \$ 274,186.47
The amount paid by the Grantee was \$ 218,572.74
The property is in the city of GARDNERVILLE, County of DOUGLAS
The documentary transfer tax is \$ 0. The Grantee herein was the beneficiary.
RECONTRUST COMPANY, N.A., as the duly appointed Trustee, under a Deed of Trust referred to below,
and herein called "Trustee", does hereby grant without covenant or warranty to: FEDERAL NATIONAL
MORTGAGE ASSOCIATION herein called Grantee, the following described real property situated in
DOUGLAS County, Nevada:

SEE ATTACHED LEGAL DESCRIPTION

This conveyance is made pursuant to the powers conferred upon Trustee by the Deed of Trust executed by
VITALIY M. BOYKO AND OLHA M. BOYKO, HUSBAND AND WIFE AS JOINT TENANTS, as
Trutor, recorded on 05/30/2006, Instrument Number 0676162 (or Book 506, Page 11586) Official Records
in the Office of the County Recorder of DOUGLAS County. All requirements of law regarding the
recording and mailing of copies of the Notice of Default and Election to Sell, and the mailing, posting, and
publication of the Notice of Trustee's Sale have been complied with. Trustee, in compliance with said
Notice of Trustee's Sale and in exercise of its power under said Deed of Trust sold said real property at
public auction on 07/28/2010. Grantee, being highest bidder at said sale became the purchaser of said
property for the amount bid, which amount was \$ 218,572.74.



DATED: July 29, 2010

RECONTRUST COMPANY, N.A., Successor Trustee

State of: Texas)
County of: Tarrant)

BY: K Newland
Kathleen Newland, Authorized Signer

On 7/30/2010 before me Antonia Rodriguez, personally appeared ~~Kathleen Newland, Authorized Signer, ReconTrust Co.~~ know to me (or proved to me on the oath of _____) or through DE to be the person whose name is subscribed to the foregoing instrument and acknowledged to me that he/she executed the same for the purposes and consideration therein expressed. Witness my hand and official seal.

Antonia Rodriguez
Notary Public's Signature

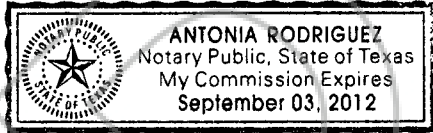

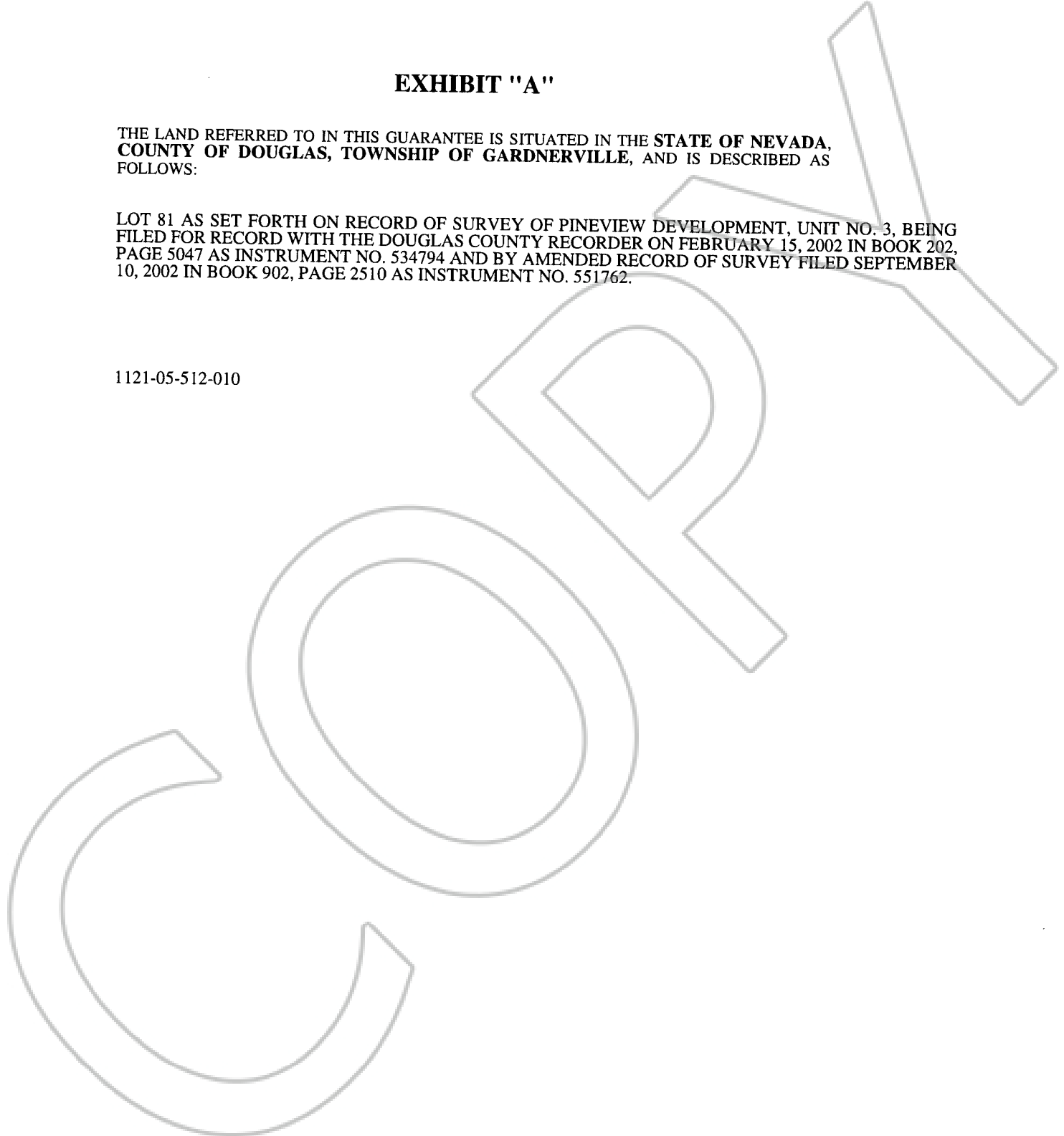

EXHIBIT "A"

THE LAND REFERRED TO IN THIS GUARANTEE IS SITUATED IN THE STATE OF NEVADA,
COUNTY OF DOUGLAS, TOWNSHIP OF GARDNERVILLE, AND IS DESCRIBED AS
FOLLOWS:

LOT 81 AS SET FORTH ON RECORD OF SURVEY OF PINEVIEW DEVELOPMENT, UNIT NO. 3, BEING
FILED FOR RECORD WITH THE DOUGLAS COUNTY RECORDER ON FEBRUARY 15, 2002 IN BOOK 202,
PAGE 5047 AS INSTRUMENT NO. 534794 AND BY AMENDED RECORD OF SURVEY FILED SEPTEMBER
10, 2002 IN BOOK 902, PAGE 2510 AS INSTRUMENT NO. 551762.

1121-05-512-010





PARCEL NO: 1121-05-512-010
ORDER NO: 4246057
TS NO.: 09-0132480

THE DEPARTMENT OF FEDERAL NATIONAL MORTGAGE ASSOCIATION PURSUANT TO THE NEVADA REVISED STATUTES 328.110 HAS HERETOFORE GIVEN PUBLIC WRITTEN NOTICE THAT THEY DO NOT SEEK EXCLUSIVE JURISDICTION OVER THE WITHIN DESCRIBED RESIDENTIAL PROPERTY.

Sandra L. Hickey

Sandra L Hickey Assistant Secretary

STATE OF TEXAS

COUNTY OF DALLAS

On 8-5-2010 before me, **Shameca L. Harrison** Notary Public, personally appeared **Sandra L. Hickey** ~~Assistant Secretary~~ personally known to me (or proved to me on the basis of satisfactory evidence) to be the person(s) whose name(s) is/are subscribed to the within instrument and acknowledged to me that he/she/they executed the same in his/her/their/ authorizes capacity(ies) and that by his/her/their signature(s) on the instrument the person(s), or the entity upon behalf of which the person(s) acted, executed the instrument..

Witness my hand and official seal.

Shameca L. Harrison

