

Assessor's Parcel Number: N/A

Date: SEPTEMBER 3, 2010

Recording Requested By:

Name: JEANE COX, COMMUNITY DEVELOPMENT

Address: \_\_\_\_\_

City/State/Zip: \_\_\_\_\_

Real Property Transfer Tax: \$ N/A

Douglas County - NV  
Karen Ellison - Recorder  
Page: 1 Of 7 Fee: 0.00  
BK-0910 PG- 1126 RPIT: 0.00



CHANGE ORDER NO 1 (#2010.218)

(Title of Document)

FILED

CHANGE ORDER

RECEIVED

NO. 2010.218

No. 1

AUG 27 2010

2010 SEP -3 AM 11:09  
PROJECT: Slurry Seal Project

DOUGLAS COUNTY  
COMMUNITY DEVELOPMENT

DATE OF ISSUANCE: August 23, 2010 EFFECTIVE DATE: August 23, 2010

OWNER: Douglas County

OWNER's Contract No. PWP# DO-2010-287

CONTRACTOR: Intermountain Slurry Seal, Inc. ENGINEER: Edward Mason, PE

You are directed to make the following changes in the Contract Documents.

Description: Add 280,772sf of Slurry as shown on attached maps, repair second layer of double chip on So. Santa Barbra in preparation of slurry

Reason for Change Order: Work necessary to repair 2009 chip seal project

Attachments: Maps showing added slurry areas, contractor's proposal.

CHANGE IN CONTRACT PRICE:	CHANGE IN CONTRACT TIMES:
Original Contract Price <u>\$112,875.00</u>	Original Contract Times Substantial Completion: <u>July 15, 2010</u> Ready for final payment: <u>August 1, 2010</u>
Net changes from previous Change Orders No. <u>N/A</u> to No. <u>N/A</u> <u>\$0</u>	Net change from previous Change Orders No. <u>N/A</u> to No. <u>N/A</u> . <u>0 days</u>
Contract Price prior to this Change Order <u>\$112,875.00</u>	Contract Times prior to this Change Order Substantial Completion: <u>July 15, 2010</u> Ready for final payment: <u>August 1, 2010</u>
Net Increase of this Change Order <u>\$48,480.86</u>	Net Increase of this Change Order <u>51days</u>
Contract Price with all approved Change Orders <u>\$161,355.86</u>	Contract Times with all approved Change Orders Substantial Completion: <u>September 24, 2010</u> Ready for final payment: <u>September 30, 2010</u>

RECOMMENDED:  
By: [Signature]  
Engineer (Authorized Signature)

APPROVED:  
By: [Signature]  
Owner (Authorized Signature)

ACCEPTED:  
By: [Signature]  
Contractor (Authorized Signature)

Date: August 23, 2010

Date: 30 Aug 2010

Date: August 26, 2010

BK- 0910  
PG- 1127  
09/07/2010  
Page: 2 Of 7  
0769945

**Mason, Ed**

---

**From:** Precourt, Robert [Robert.Precourt@gcinc.com]  
**Sent:** Friday, August 13, 2010 8:57 AM  
**To:** Mason, Ed  
**Subject:** RE: Double Chip Rehabilitation

In the larger areas, we will cut and remove the fabric to expose the first chip application. In the smaller fist size areas that the fabric is showing, we will burn the fabric off to expose the first chip application. We will then apply a leveling coarse of Type II Slurry Seal to all the areas that the fabric was removed. Yes after a 24 hour cure we could apply contract slurry.

**Robert D. Precourt**

Project Manager  
 Intermountain Slurry Seal, Inc  
 PO Box 1841  
 Sparks, NV 89432

Phone: 775-358-1355  
 Fax: 775-355-3458  
[robert.precourt@gcinc.com](mailto:robert.precourt@gcinc.com)

---

**From:** Mason, Ed [mailto:EMason@co.douglas.nv.us]  
**Sent:** Friday, August 13, 2010 8:46 AM  
**To:** Precourt, Robert  
**Subject:** RE: Double Chip Rehabilitation

I know Mark explained the process to me on the phone, but could you please put it in writing (E-mail would be ok). After the ~~19,734.00~~ repair and leveling then we would slurry the repaired surface with the contract slurry, correct?

Ed

-----Original Message-----

**From:** Precourt, Robert [mailto:Robert.Precourt@gcinc.com]  
**Sent:** Friday, August 13, 2010 8:40 AM  
**To:** Mason, Ed  
**Subject:** Double Chip Rehabilitation

Ed -

I worked up some numbers at the request of Marc to remove the exposed fabric to the first chip application and then pre-level those areas with Type II Slurry Seal. ~~The price for this work is \$19,734.00.~~  
 Call with questions. Thank you.

8/23/2010



ADD:  
SADDLE BRONC  
& SADDLE HORSE

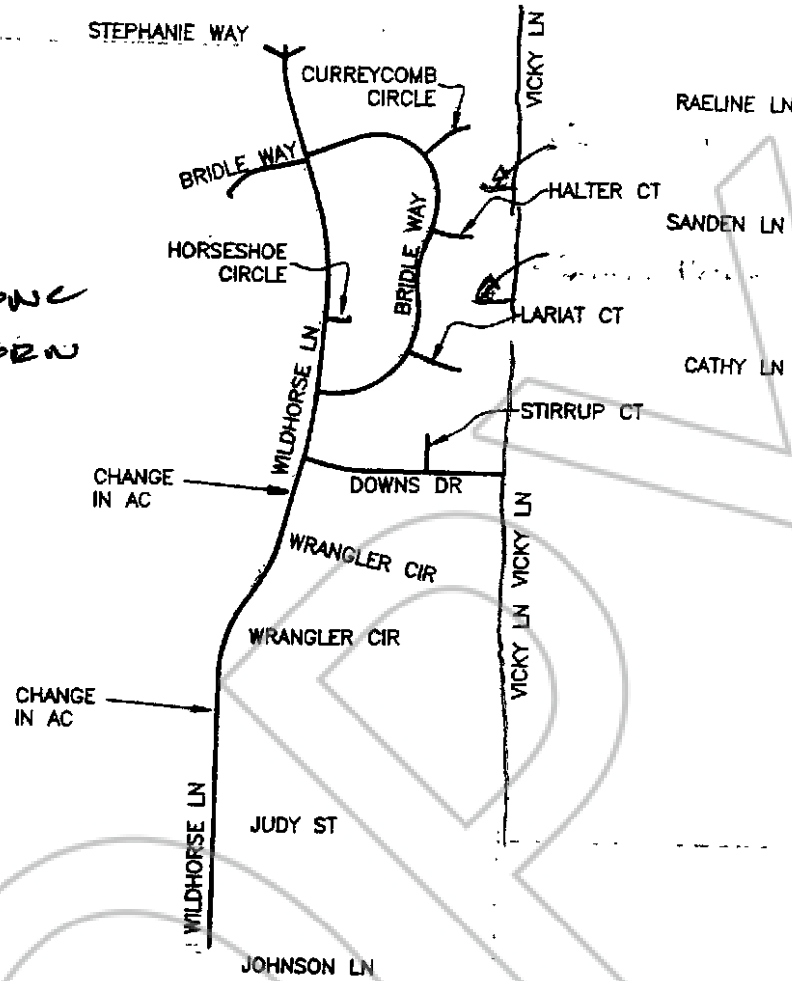

Road Name	Length in Feet	Average Width in Feet	other areas	Dia of Culsac	Total Area of Chip Seal	Stop Bars (total number)	Letters STO	Letters AHEAD	Letters 25	Crosswalk (total number)
Wildhorse Lane	5031	42	3778.00		217,098	4	4	2	2	3
Downs from Wildhorse to Vicky	1065	43	4216.00		50,446	2				
Stirrup Ct	211	38	21.00	78	10,017	1				
Bridle Way	2890	36	716.00	87	113,579	2				
Horseshoe Ct	62	38	741.38	77	7,812	1				
Lariat Ct	253	38	171.68	77	14,198					
Halter Ct	162	38	497.90	77	11,311					
Currycomb Ct	230	38	154.94	77	13,552					

P:\UTILITIES\ACAD\JLF\2010 ROAD SEAL\RS-03

SADDLE BRONC  
SADDLE HORSE

10173 #  
12331 #

ADD - 22504 #  
0.105 / 4F = 42362.92

LEGEND:

CHIP SEAL ———



2010 SLURRY SEAL PROJECT

SHEET RS-03

APRIL 25, 2010



SOUTH SANTA BARBARA FROM STEPHANIE TO DEL MESA

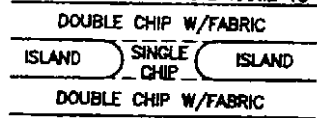

SOUTH SANTA BARBARA FROM DEL MESA TO VICKY

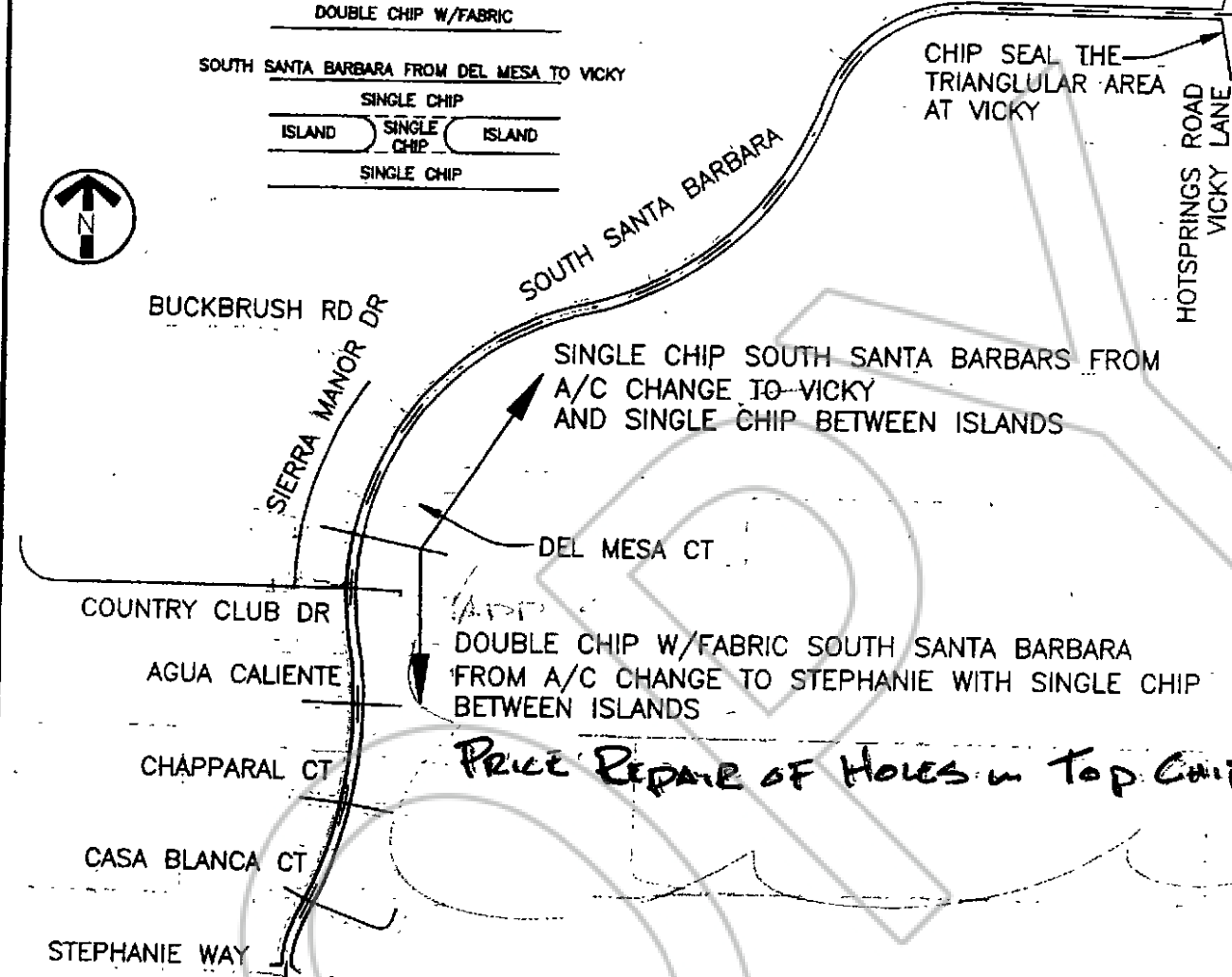
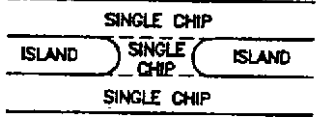

P:\UTILITIES\ACAD\JLF\2009\ROAD SEAL\RS-02

Road Name	Length in Feet	Average Width in Feet	Total Area of Chip Seal	Total Area of Double Chip Seal	Stop Bars (total number)	Crosswalk (total number)	Fog line total both sides of road (feet)	Center single dash/shoulder line Yellow (feet)
South Santa Barbara Drive - Stephanie Way to Vicky Ln	4557	65	282,038		4	1	9142	7780
Casa Blanca Ct - Both sides of South Santa Barbara	1870	52		97,240				
Chapparel Ct - Both Sides of South Santa Barbara		38	25,000		2			
Agua Caliente Ct - Both Sides of South Santa Barbara		38	17,000		2			
Country Club Dr - Portion		38	16,000		2			
Sierra Manor Dr	871	38	32,000		2			
			40,000		2			

*ADD 227240#  
D.105 = 238600#*

LEGEND:

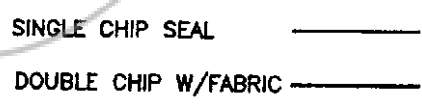

2009 CHIP SEAL PROJECT

SHEET RS-02

APRIL 25, 2009

Post-it Fax Note 7671 Date 8-11-10 # of pages 2

To: A. THORESON From: ED WILSON

Co/Dept: SLOOPY Co: De La

Phone # Phone # 690 6946

Fax # 355 3458 Fax #



FOOTHILL RD (206)

MARK ADD PARMAN CT &  
 GANSBURG CT 31028 Ⓢ  
 0.105 #/sf = 3257 94

STATE OF NEVADA  
 STATE OF CALIFORNIA

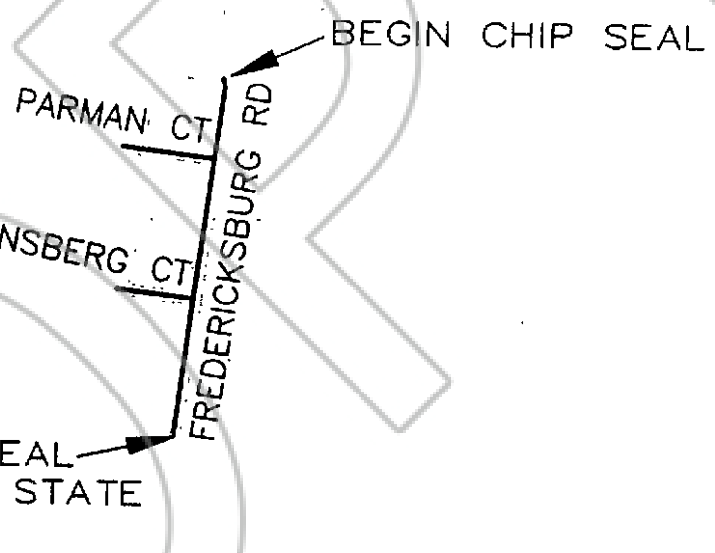

BK- 0910  
 PG- 1131  
 0769945 Page: 6 of 7 09/07/2010

P:\UTILITIES\ACAD\JLF\2009 ROAD SEAL\RS-03

Road Name	Length in Feet	Width in Feet	other areas	Dia. of Culdesac	Total Area of Chip Seal	Stop Bar
Fredercksburg Rd Southern Portion	1,581	32	908		51,500	
Parman Ct	345	24	124	100	16,258	1
Gansburg Ct	283	24	124	100	14,770	1

LEGEND:  
 CHIP SEAL ———

**2009 CHIP SEAL PROJECT**

**SHEET RS-03**  
 APRIL 25, 2009



COPY

**CERTIFIED COPY**

The document to which this certificate is attached is a full, true and correct copy of the original on file and on record in my office.

DATE: Sept 3, 2010  
TARAN Clerk of the 9th Judicial District Court  
of the State of Nevada, In and for the County of Douglas.

By Carol M. Mullock Deputy