

15-

DECLARATION OF HOMESTEAD

Assessor Parcel Number: 23-295-59
OR 1320-26-002-021
Assessor's Manufactured Home ID Number: _____

Douglas County - NV
Karen Ellison - Recorder
Page: 1 Of 2 Fee: 15.00
BK-0910 PG-1436 RPTT: 0.00



Recording Requested by and Mail to:
Name: Jan Vandermade and Genevieve Vandermade
Address: 1608 East Valley Rd.
City/State/Zip: Gardnerville NV 89410

- Check One:
- Married (filing jointly) Married (filing individually)
 - Head of Family Widowed
 - Single Person Multiple Single Persons
 - By Wife (filing for joint benefit of both)
 - By Husband (filing for joint benefit of both)
 - Other (describe): _____

- Check One:
- Regular Home Dwelling/Manufactured Home Condominium Unit Other

Name on Title of Property
Jan Vandermade and Genevieve Vandermade

do individually or severally certify and declare as follows:
Jan Vandermade and Genevieve Vandermade
is/are now residing on the land, premises (or manufactured home) located in the city/town of Gardnerville,
County of Douglas, State of Nevada, and more particularly described as follows:
(set forth legal description and commonly known street address OR manufactured home description)
1608 East Valley Rd.

I/We claim the land and premises hereinabove described, together with the dwelling house thereon, and its appurtenances, or the described manufactured home as a Homestead.

In Witness, Whereof, I/we have hereunto set my hand/our hands this 7 day of Sept, 2010.

[Signature]
Signature
JAN VANDERMADE
Print or type name here

[Signature]
Signature
GENEVIEVE VANDERMADE
Print or type name here

STATE OF NEVADA, COUNTY OF Carson

This instrument was acknowledged before me on 9/7/10 (date)

by Jan Vandermade
Person(s) appearing before notary

by Genevieve Vandermade
Person(s) appearing before notary

[Signature]
Signature of notarial officer

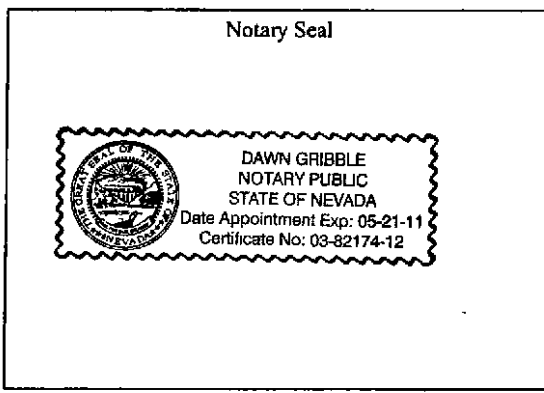

CONSULT AN ATTORNEY IF YOU DOUBT THIS FORM'S FITNESS FOR YOUR PURPOSE.

NOTE: Leave space within 1-inch margin blank on all sides.



DOUGLAS COUNTY

LEGAL DESCRIPTION

All that certain lot, piece or parcel of land situate in the County of DOUGLAS, State of Nevada, described as follows:

All that real property in the County of Douglas, State of Nevada, specifically described as: A parcel of land located within a portion of the South 1/2 of Section 26, Township 13 North, Range 20 East, M.D.B. & M., Douglas County, Nevada, being more particularly described as follows:

Parcel 3-B, as shown on Parcel Map for CHRISTI MOSHER & RENEE PRESTO, filed for record on November 18, 1991, Book 1191, page 2539, as Document No. 265151, Official Records of Douglas County, Nevada.

Assessors Parcel No. 23-295-59

1320-26-002-021

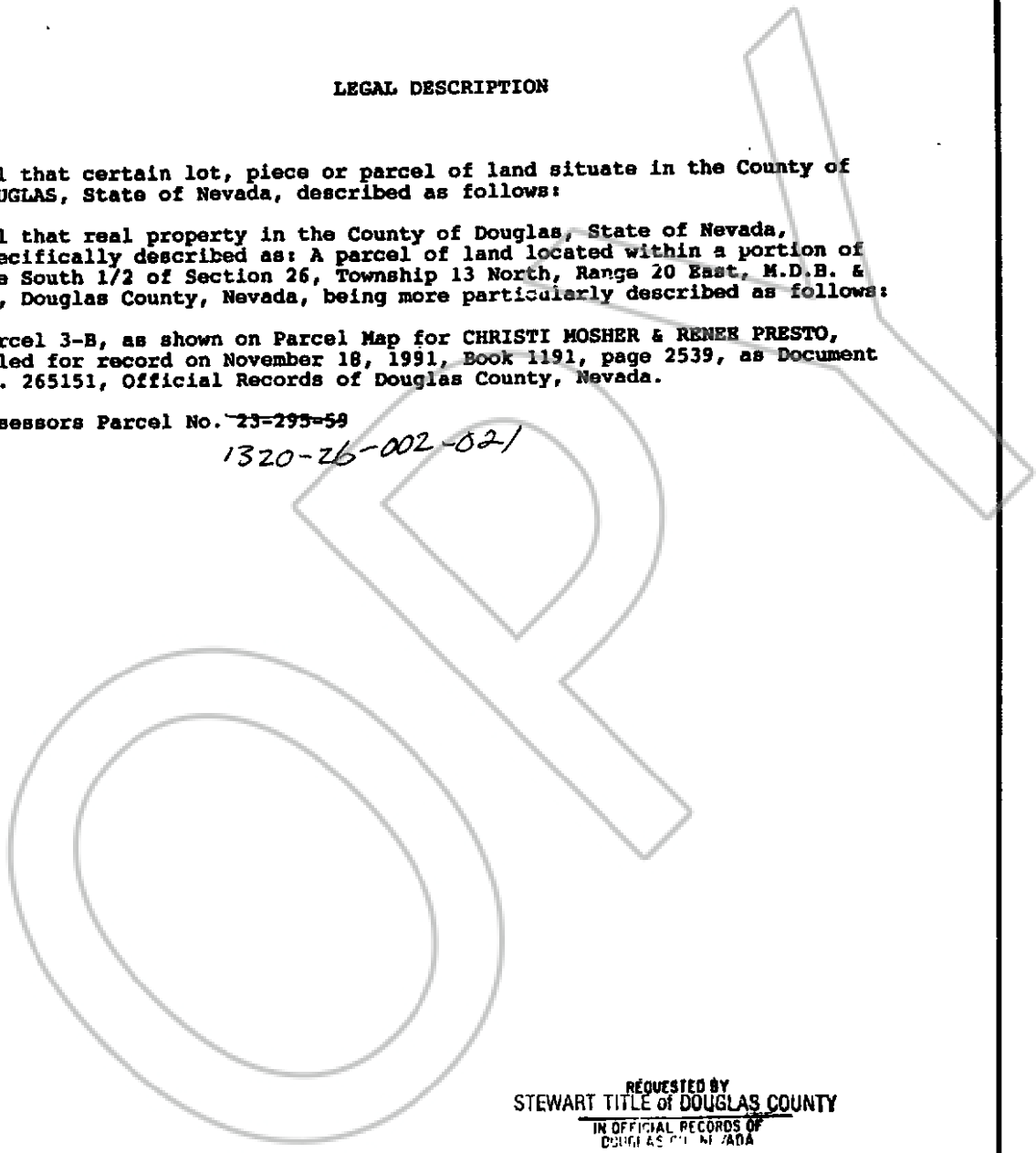

REQUESTED BY
STEWART TITLE OF DOUGLAS COUNTY
IN OFFICIAL RECORDS OF
DOUGLAS COUNTY, NEVADA

93 SEP -1 19:37

SUZANNE WINDFELT
RECORDER
\$6.00 PR. / *Bk* DEPUTY

316615
BK0993PG0015