

OFFICIAL RECORD

Requested By:

DC/MINDEN TAHOE AIRPORT

Assessor's Parcel Number: N/A

Date: DECEMBER 28, 2010

Recording Requested By:

Douglas County - NV
Karen Ellison - Recorder

Page: 1 Of 9 Fee: 0.00
BK-1210 PG- 6286 RPTT: 0.00



Name: CATHIE KITE, MINDEN-TAHOE AIRPORT

Address: _____

City/State/Zip: _____

Real Property Transfer Tax: \$ N/A

LEASE #2010.293

(Title of Document)

FILED

NO. 2010.293

2010 DEC 28 AM 10: 01

**MINDEN-TAHOE AIRPORT
ASSIGNMENT OF LEASE LL047**

TED THUAN
CLERK

This Assignment of Lease is between Minden-Tahoe Airport, by and through the Douglas County Board of Commissioners (Landlord), and Bingham Family Trust (Assignors) and Serge Serfaty (Assignees).

RECITALS

This Assignment is made with reference to and with agreement to the following facts:

- A. Douglas County, as Landlord, and C. Reade Kaley, as Tenant, entered into a lease agreement for premises located on the Minden-Tahoe Airport on January 1, 1999. This lease, LL029 is recorded as document 0456090, book 1298, and pages 2101-2131.
- B. On July 1, 2000, the lease was assigned, with Landlord's consent, from C. Reade Kaley, the successor in interest to David Bingham. This assignment is recorded as document 0494472, book 0600, and pages 4395-4421.
- C. On October 5, 2006, the Tenant's name was changed to Bingham Family Trust.
- D. That Assignors Bingham Family Trust desire to assign and Assignees Serge Serfaty desire to assume all of the rights, title and interest to the lease, LL047. The lease and amendments are attached as Exhibit A.
- E. The Landlord, Douglas County, consents to the proposed assignment on the conditions listed in this Assignment.

THEREFORE, the parties agree as follows:

1. Effective Date of Assignment.

This Assignment will take effect on November 4, 2010, and Assignors must give possession of the premises located on LL047 at the Minden-Tahoe Airport to the Assignees on that date.

2. Premises.

BK- 1210
PG- 6287
12/28/2010
0776112 Page: 2 Of 9

This Assignment is for LL047 in the name of the Serge Serfaty property as further described in Exhibit A. All prior assignments and amendments are incorporated by reference herein.

3. Assignment and Assumption.

Assignors transfer and assign all of the rights, title and interest in this lease and Assignees accept this assignment and agree to assume and perform, from the date this assignment becomes effective, as a direct obligation to the Landlord, all provisions and conditions of the lease. Lease LL047 will be renumbered to LL098 upon approval of the assignment.

4. Release.

Upon execution of this assignment by all parties, the Landlord will release Assignors from any obligation under this lease on assignment to Assignees.

5. Notice.

Any and all notices or correspondence regarding this Assignment shall be delivered to the following addresses:

Landlord

Minden-Tahoe Airport
Attn: Airport Manager
P.O. Box 218
Minden, NV 89423

Assignors

Mr. David Bingham
3493 Alpine View Court
Carson City, NV 89705

Assignees

Mr. Serge Serfaty
1471 Cardiff Drive
Gardnerville, NV 89410

6. Landlord's Consent

Landlord Consents to this Assignment without waiving the restriction concerning further assignment.

On behalf of Douglas County, Nevada.

Michael A. Olson 11/4/10

Michael A. Olson, Chairman (date)

Douglas County Board of Commissioners

Attest: Ted Thran 11/4/10

Ted Thran, Douglas County Clerk (date)

BY: Lawrence Bede
Clerk to the Board

On behalf of Bingham Family Trust.

David Bingham (date)

David Bingham 12-22-10

On behalf of Mr. Serge Serfaty

Serge Serfaty 12/01/2010
Serge Serfaty (date)

EXHIBIT "A" - Legal Descriptions

See attached exhibit A-4.

COPY

EXHIBIT A-4

**PROPERTY DESCRIPTION
FOR
AIRPORT LEASE (Kaley Building Parcel-4)**

A parcel of land located within the NE1/4 of Section 17, Township 13 North, Range 20 East, M.D.B.&M., and more particularly described as follows:

Commencing at Airport Control Monument #4 as shown on the Amended Record of Survey #14 for Douglas County, as recorded April 4, 1988 in Book 488, Page 239 as Document Number #175533; thence S02°28'54"E a distance of 749.09 feet to the TRUE POINT OF BEGINNING; thence S44°29'24"E a distance of 36.25 feet; thence S45°30'36"W a distance of 42.25 feet; thence N44°29'24"W a distance of 36.25 feet; thence N45°30'36"E a distance of 42.25 feet to the TRUE POINT OF BEGINNING.

Said Parcel contains 1,531.56 square feet, more or less.

The basis of bearings for the above description is the south line of the SW1/4 of Section 8, Township 13 North, Range 20 East, M.D.B.&M. which bears N89°38'08"W per the Amended Record of Survey #14 for Douglas County as described above.



0494472

BK0600PG4419

LEGEND
 ↑ AIRPORT RUNWAY
 ↑ EXISTING FIRM BUILDING

Subject parcels

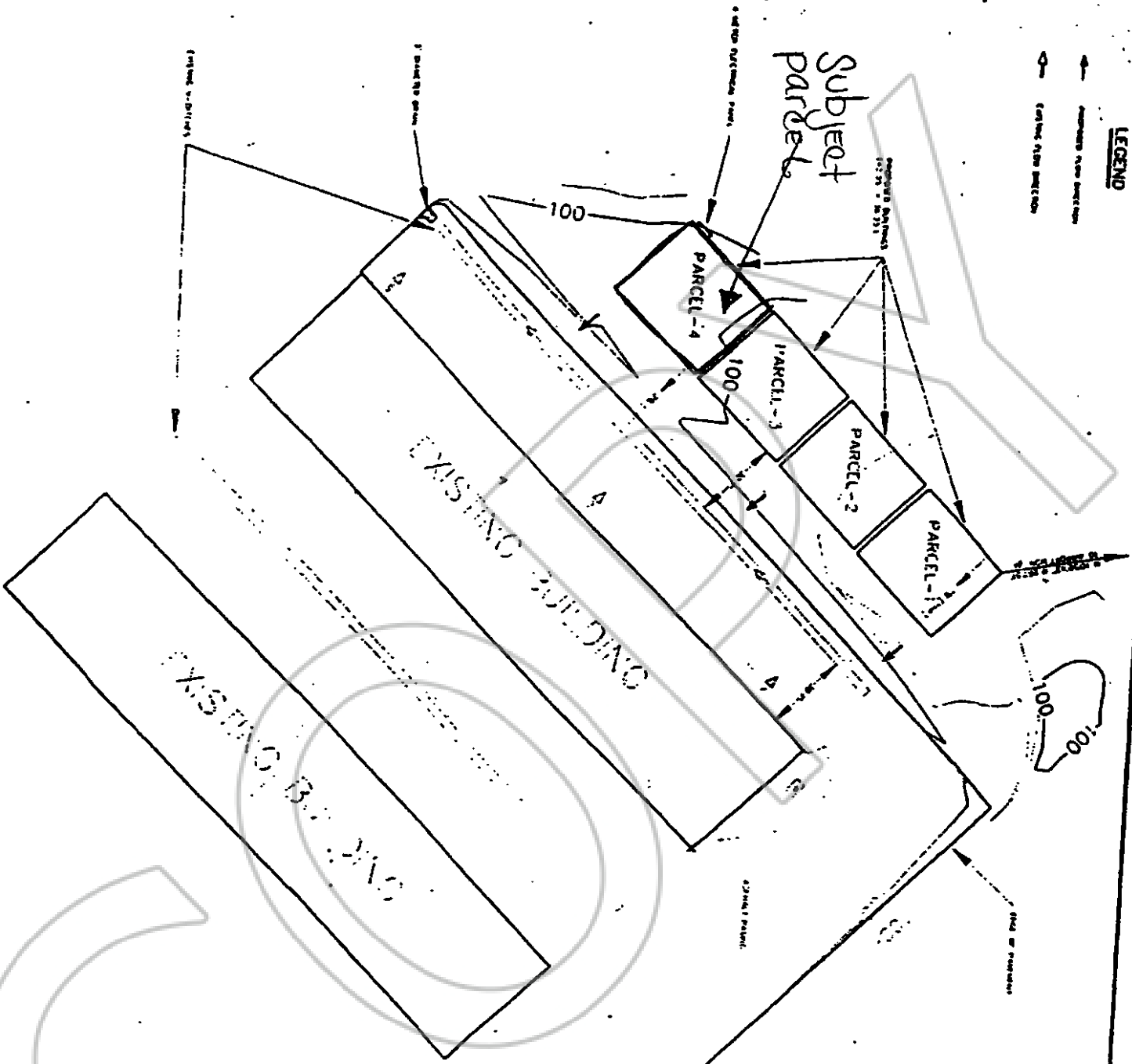

NOTES

- 1. OWNER SHALL BE AT ALL TIMES RESPONSIBLE FOR THE ACCURACY OF THE INFORMATION PROVIDED TO THE COUNTY PLANNING DEPARTMENT.
- 2. THE COUNTY PLANNING DEPARTMENT SHALL NOT BE RESPONSIBLE FOR THE ACCURACY OF THE INFORMATION PROVIDED BY THE OWNER.

TOPO MAP
 FOR
 C. READE KALEY
 WITHIN THE DOUGLAS COUNTY AIRPORT

0494472

BK0600PG4420



66

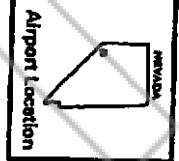
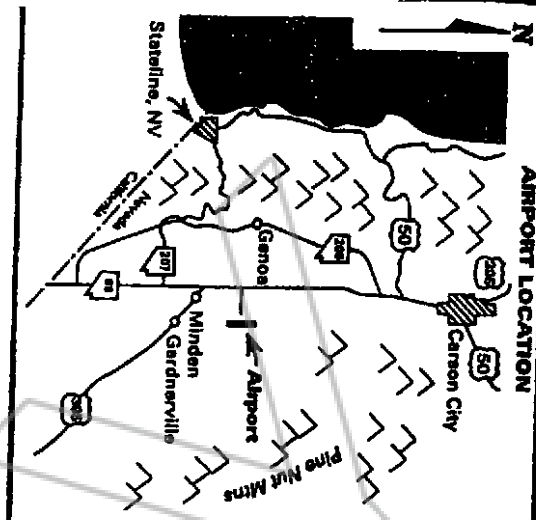

REMARKS: Taxiways 30' wide, asphalt
NOTE: Not to Scale
Distances and Heights
are Approximate

COORDINATES: 39° 00' 02" N (Est.)
119° 45' 10" W (Est.)

SITE NO. 13091.A
ACRES 915.0
ELEVATION 4,781

MINDEN-TAHOE AIRPORT (MEV) MINDEN, NEVADA

FOR DETAILED INFORMATION CONTACT
NDOT - PLANNING AVIATION (775) 888-7354

MAG VAR
15° 49'E
1985



Revised April 2000 VR

AIRPORT LAYOUT

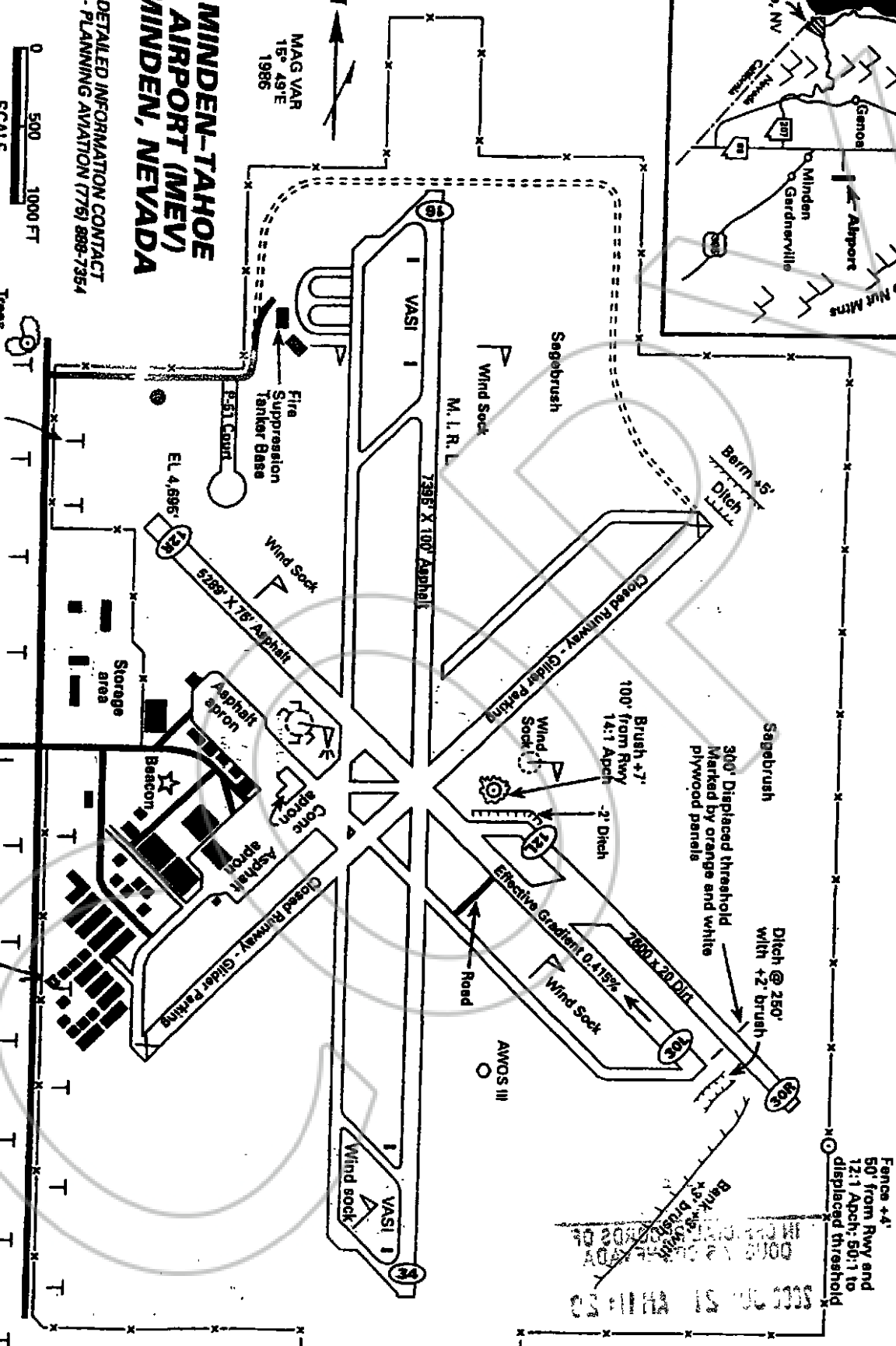

subject
PARCEL



0494472 STAIR

BK0600P584210000000

COPY

CERTIFIED COPY

The document to which this certificate is attached is a full, true and correct copy of the original on file and on record in my office.

DATE: Dec 28, 2010
Tracy Clerk of the 9th Judicial District Court
of the State of Nevada, in and for the County of Douglas.

By David M. Hubbs Deputy