



APN: 1219-10-002-015

Recording Requested by and
When Recorded Mail To:
Robert E. Armstrong, Esq.
McDonald Carano Wilson, LLP
Post Office Box 2670
Reno, Nevada 89505

Send Tax Statements to:
James L. Herd, Trustee
Jennifer E. Ware, Trustee
1103 Sierra Country Court
Gardnerville, Nevada 89460

The undersigned hereby affirms that this document submitted for recording does not contain the personal information of any person or persons per N.R.S. 239B.030.



Signature of Declarant or Agent

GRANT, BARGAIN AND SALE DEED

JAMES HERD and JENNIFER WARE, husband and wife, do hereby grant, bargain, sell, and convey unto JAMES L. HERD and JENNIFER E. WARE, as Trustees of THE HERD-WARE FAMILY TRUST (u/d/t: June 7, 2011), and to their successors and assigns, all their right, title and interest in and to that certain real property situate in the County of Douglas, State of Nevada, commonly known as 1103 Sierra Country Court, Gardnerville, Nevada, and more particularly described on Exhibit "A" attached hereto and incorporated herein by this reference.

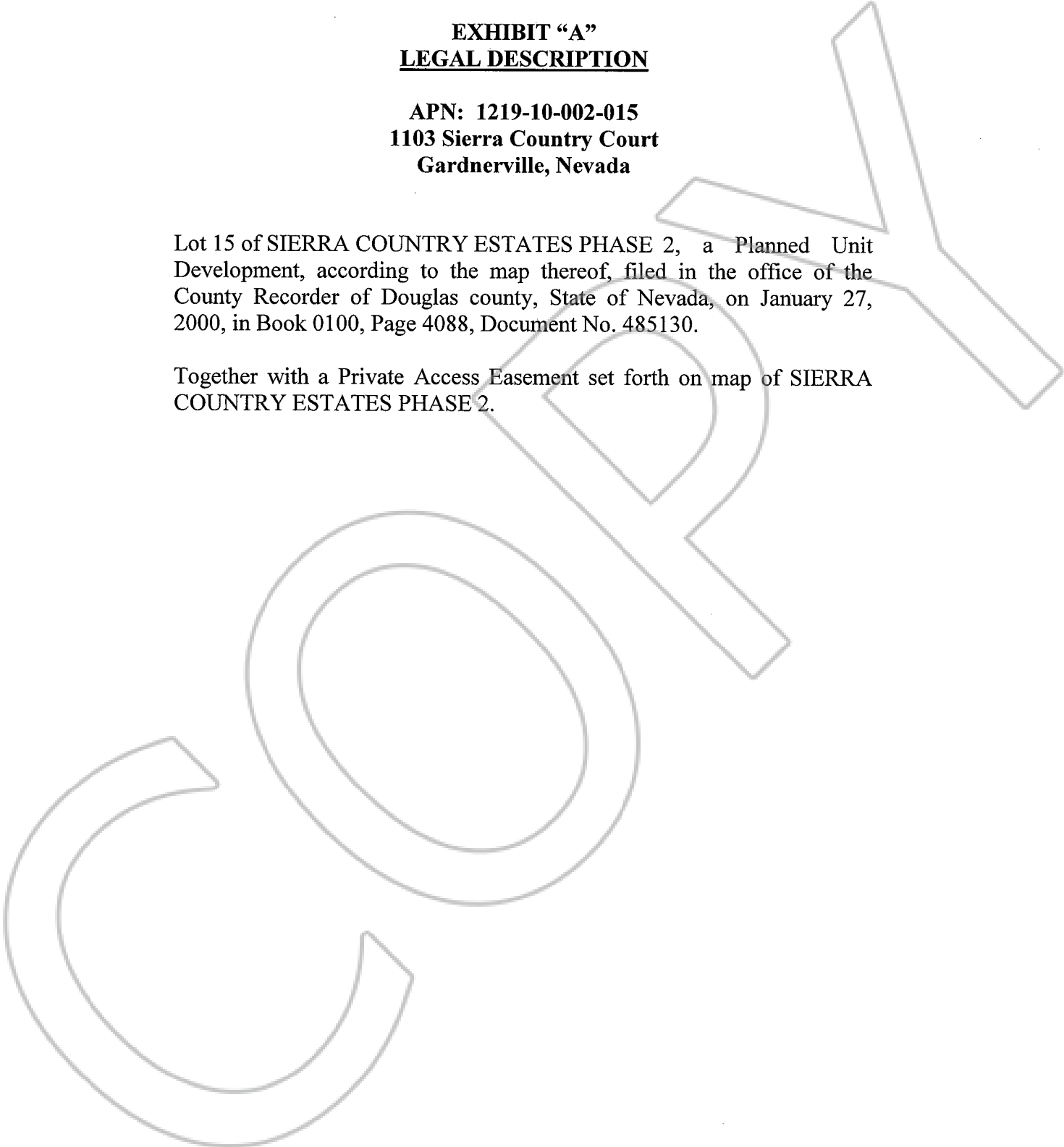

EXHIBIT "A"
LEGAL DESCRIPTION

APN: 1219-10-002-015
1103 Sierra Country Court
Gardnerville, Nevada

Lot 15 of SIERRA COUNTRY ESTATES PHASE 2, a Planned Unit Development, according to the map thereof, filed in the office of the County Recorder of Douglas county, State of Nevada, on January 27, 2000, in Book 0100, Page 4088, Document No. 485130.

Together with a Private Access Easement set forth on map of SIERRA COUNTRY ESTATES PHASE 2.





TOGETHER WITH all and singular the tenements, hereditaments and appurtenances thereunto belonging or in anywise appertaining, and any reversions, remainders, rents, issues or profits thereof.

DATED: This 7th day of June, 2011.

JAMES L. HERD

JENNIFER E. WARE

STATE OF NEVADA)
 : ss.
COUNTY OF WASHOE)

On the 7th day of June, 2011, before me, a notary public in and for said State, personally appeared JAMES L. HERD and JENNIFER E. WARE husband and wife, personally known to me (or proved to me on the basis of satisfactory evidence) to be the person whose names are subscribed to the within instrument and acknowledged to me that they executed the same in their capacity, and that by their signature on the instrument the persons, or the entity upon behalf of which the persons acted, executed the instrument.

WITNESS my hand and official seal.

NOTARY PUBLIC

